

T8N, R6W & T8N, R5W  
T7N, R6W & T7N, R5W  
W.M.

CLATSOP & COLUMBIA COUNTIES

APPLICATION FOR A PERMIT TO USE SURFACE WATER  
UNDER

Application S-87713 Permit \_\_\_\_\_

IN THE NAME OF

**Westport Water Association**

NOTE: This map is not intended to provide legal dimensions or locations of property ownership lines.

March 25, 2011  
SCALE: 1" = 1320'



Graphic Scale

THE COMBINED BOUNDARIES OF THE WESTPORT WATER ASSOCIATION AND THE WAUNA WATER DISTRICT



RENEWAL DATE: 12-31-2011

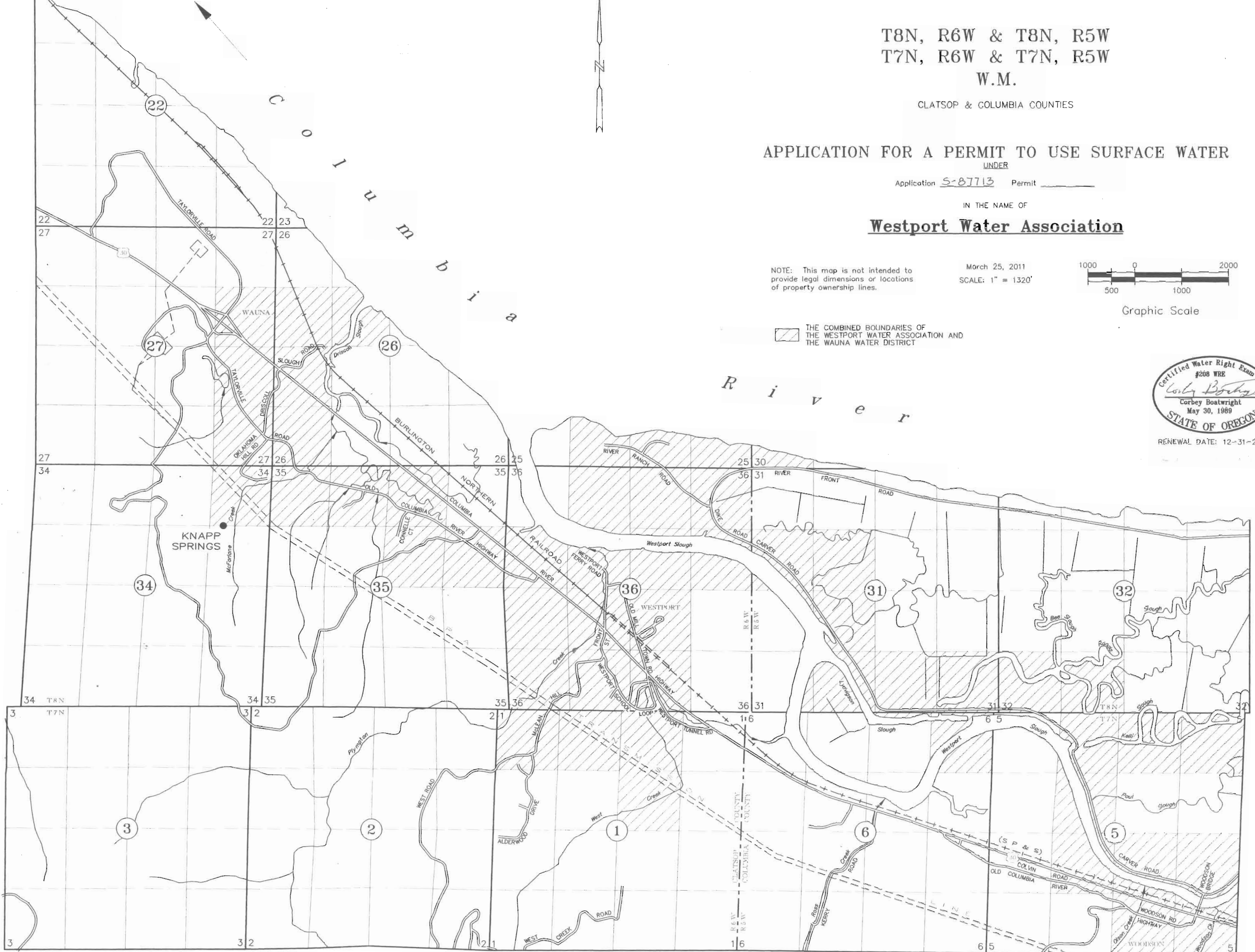

T8N, R6W & T8N, R5W  
 T7N, R6W & T7N, R5W  
 W.M.

CLATSOP & COLUMBIA COUNTIES

APPLICATION FOR A PERMIT TO USE SURFACE WATER  
 UNDER

Application \_\_\_\_\_ Permit \_\_\_\_\_

IN THE NAME OF

**Westport Water Association**

March 25, 2011  
 SCALE: 1" = 1320'

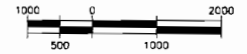

Graphic Scale

NOTE: This map is not intended to provide legal dimensions or locations of property ownership lines.

THE COMBINED BOUNDARIES OF THE WESTPORT WATER ASSOCIATION AND THE WALNA WATER DISTRICT



RENEWAL DATE: 12-31-2011

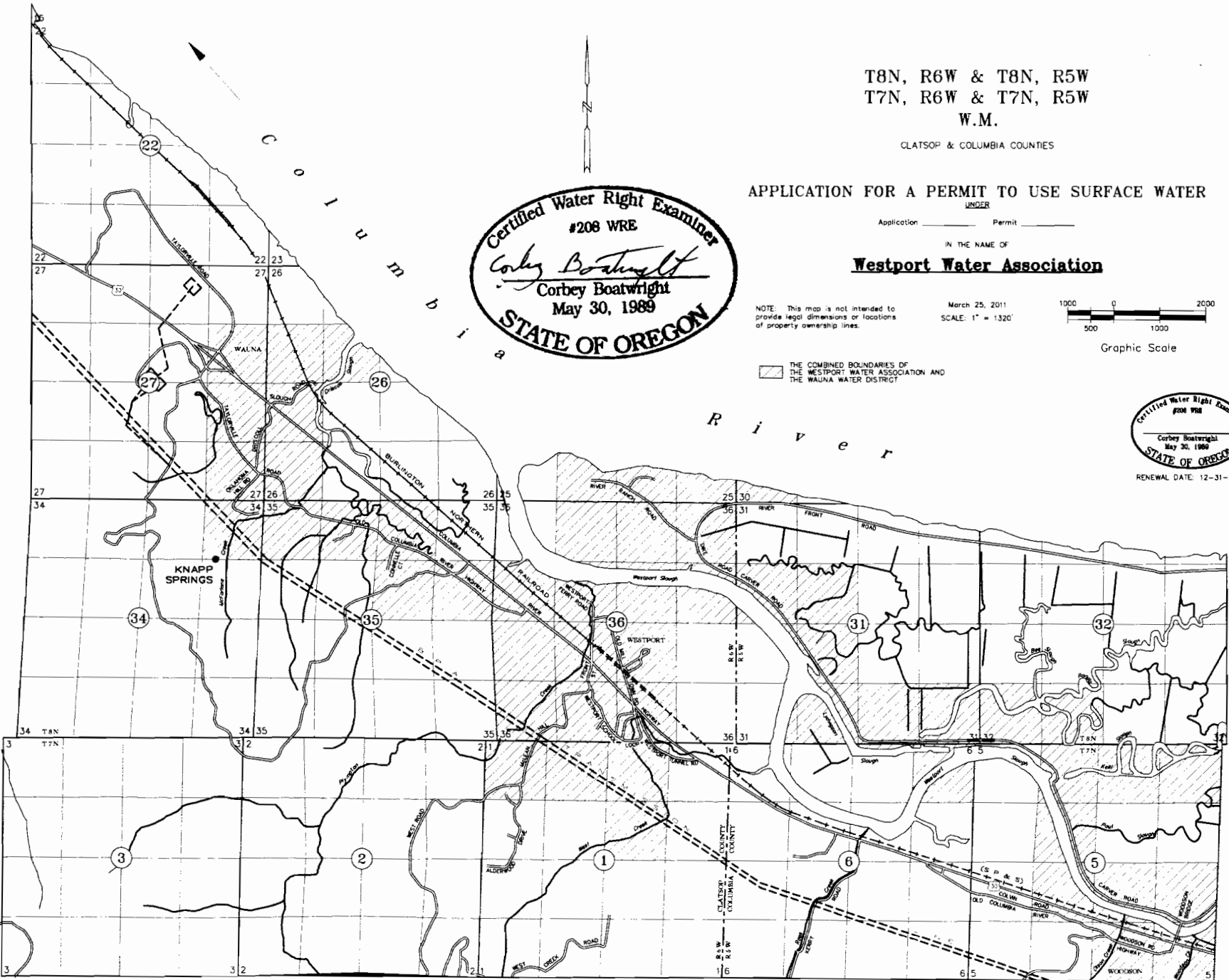

KNAPP SPRINGS 1050' W & 1285' S, NE COR SEC 34, T 8 N, R 6 W, WM

S-87715