

LEGEND

- CLASS 1 Good soil, nearly level, deep fertile, well drained, good texture.
- CLASS 2 Contains some gravel or sand and is not uniform in topography.
- CLASS 3 Sandy, gravelly or shallow, rough or somewhat alkaline
- CLASS 4 Rough or alkaline soil of little value, undeveloped.
- CLASS 6 High, alkali or rock, non-productive

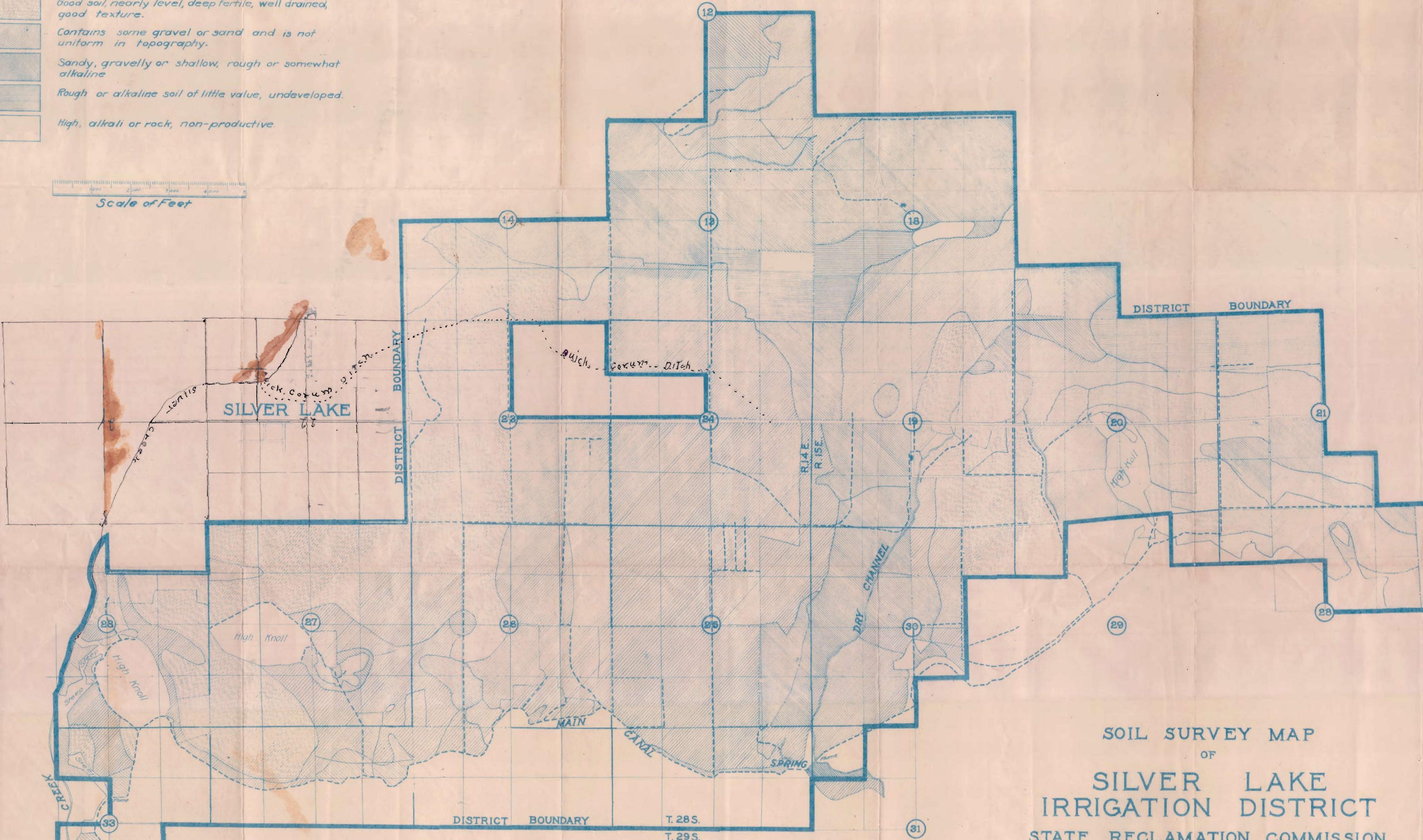
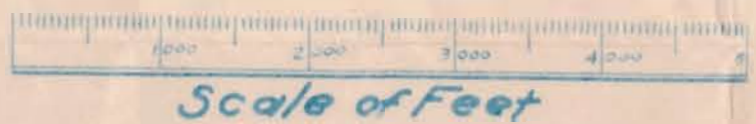

SOIL SURVEY MAP
 OF
SILVER LAKE
IRRIGATION DISTRICT
 STATE RECLAMATION COMMISSION
 SURVEY UNDER DIRECTION OF
OREGON STATE COLLEGE
 EXPERIMENT STATION
 BY
 DR. W.L. POWERS
 DR. R.E. STEPHENSON
 DRAWN BY
OFFICE OF STATE ENGINEER
STATE OF OREGON
 1928