

ROBERT L. and LEANN R. MCKEE
 SURFACE WATER RIGHT, GROUND WATER RIGHT,
 and RESERVOIR APPLICATION MAP

RECEIVED

JUL 06 2011
 WATER RESOURCES DEPT
 SALEM, OREGON

Yamhill County
 Tax Lot 5431-300

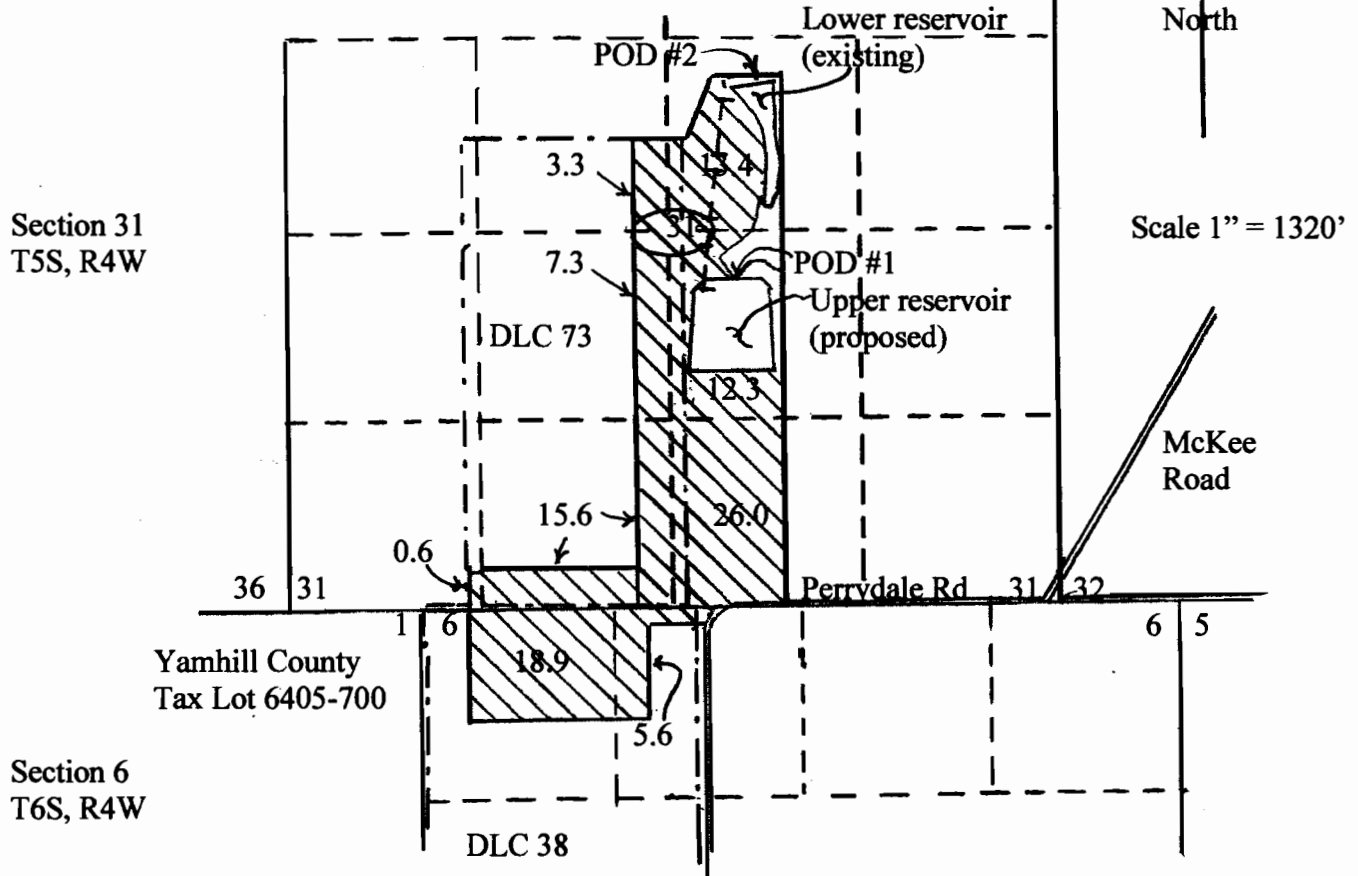

POD #1 for upper reservoir is located 400' east and 350' south from the center of Section 31, T5S, R4W
 POD #2 for lower reservoir is located 550' east and 1000' north from the center of Section 31, T5S, R4W (existing reservoir P-77020)

-  Area (103.4 acres) to be irrigated
- - - DLC boundary
- + - + - Pipeline

Note: The 1/4 1/4 lines have been projected using tax lot maps, government land survey maps, an aerial photograph and best professional judgment.

This map was prepared fore the purpose of identifying the location of a water right only and is not intended to provide legal dimensions or location of property ownership lines.

Certified Water Rights Examiner
 #449WRE
Leland A. Hardy
 Leland A. Hardy
 June 11, 1998
 STATE OF OREGON

RENEWAL DATE: 6/30/2013

OWRD Basic Web Mapping Application (beta)

Locate a place on the map ▶ Use Advanced Map ▶ Help ▶ Links ▶

Zoom In Zoom Out Pan Full Extent Identify

OWRD Data
 Base Data
 Imagery

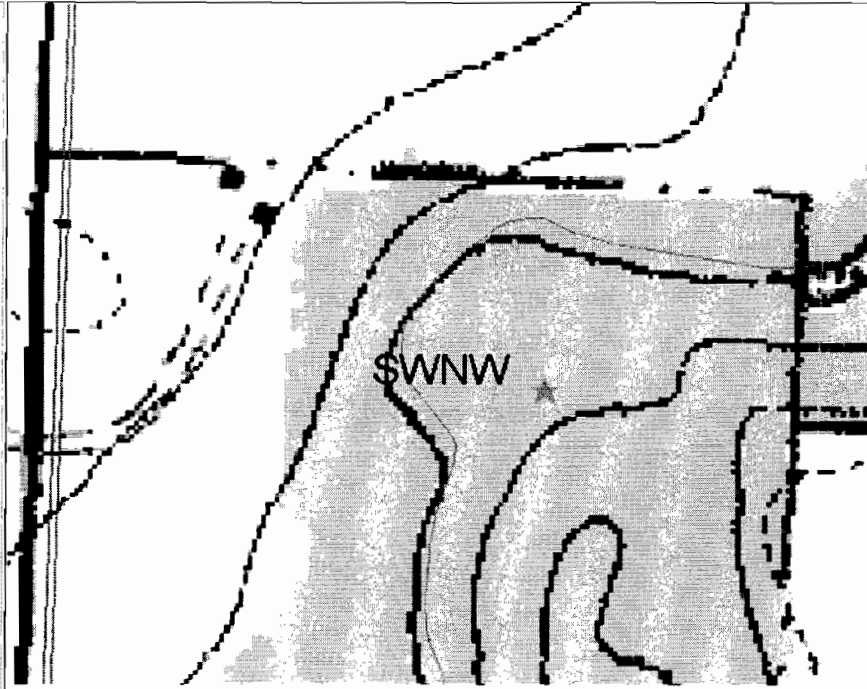

Selected Point
Latitude: 45.095217 , Longitude: -123.234904
Oregon Lambert Coordinate: 606255.27, 1231116.22
Perform a peak discharge estimate at this point
This point is located in the following TRSQQ:

TRSQQ: 05.00S-04.00W-31-SWNW
County: Yamhill
Basin: Willamette
WM District: 16
WM Region: NW
Withdrawn Area:
WAB: SALT CR > S YAMHILL R - AT MOUTH (73562)
Priority WAB:
Rule 4D: Rules apply
Groundwater Restricted:
Scenic Water Way:
Division 33: LOWER COLUMBIA
Water Quality Limited: Yes
Water Rights: See Water Rights in this section (Platcard)
Well Logs: See Well Logs in this section

RECEIVED
JUL 06 2011
WATER RESOURCES DEPT
SALEM, OREGON

OWRD Basic Web Mapping Application (beta)

Zoom In Zoom Out Pan Full Extent Identify

- OWRD Data
 - Rule Boundaries
 - Scenic Waterwa
 - Withdrawn Area
 - Deschutes Mitig
 - GW restricted a
 - NMFS Rule 4D
 - Division 33
 - Political Boundaries
 - Water Availability
 - Priority WABS
 - Water Availabili
 - Water Rights
 - Ground water
 - Surface water
 - Storage Water
 - Surface water
- Base Data
- Imagery

Locate a place on the map ▶ Use Advanced Map ▶ Help ▶ Links ▶

Selected Point

Latitude: 45.095663 , Longitude: -123.231926
 Oregon Lambert Coordinate: 607029.19, 1231253.17
 Perform a peak discharge estimate at this point
 This point is located in the following TRSQQ:

TRSQQ: 05.00S-04.00W-31-SENW

County: Yamhill
 Basin: Willamette
 WM District: 16
 WM Region: NW
 Withdrawn Area:
 WAB: SALT CR > S YAMHILL R - AT MOUTH (73562)
 Priority WAB:
 Rule 4D: Rules apply
 Groundwater Restricted:
 Scenic Water Way:
 Division 33: LOWER COLUMBIA
 Water Quality Limited: Yes
 Water Rights: See Water Rights in this section (Platcard)
 Well Logs: See Well Logs in this section

RECEIVED
 JUL 06 2011
 WATER RESOURCES DEPT
 SALEM, OREGON

OWRD Basic Web Mapping Application (beta)

Locate a place on the map ▶ Use Advanced Map ▶ Help ▶ Links ▶

Zoom InZoom OutPanFull ExtentIdentify

OWRD Data

- Rule Boundaries
 - Scenic Waterwa
 - Withdrawn Area
 - Deschutes Mitig
 - GW restricted a
 - NMFS Rule 4D
 - Division 33
- Political Boundaries
- Water Availability
 - Priority WABS
 - Water Availabili
- Water Rights
 - Ground water
 - Surface water
 - Storage Water
- Surface water
- Base Data
- Imagery

The map displays various water rights boundaries and availability zones. A star indicates the selected point. Large numbers 69, 31, and 73 are visible on the map. The map also shows various water rights boundaries and availability zones.

Selected Point

Latitude: 45.092362 , Longitude: -123.230039
Oregon Lambert Coordinate: 607476.25, 1230034.35
Perform a peak discharge estimate at this point
This point is located in the following TRSQQ:

TRSQQ: 05.00S-04.00W-31-NESW

County: Yamhill
Basin: Willamette
WM District: 16
WM Region: NW
Withdrawn Area:
WAB: SALT CR > S YAMHILL R - AT MOUTH (73562)
Priority WAB:
Rule 4D: Rules apply
Groundwater Restricted:
Scenic Water Way:
Division 33: LOWER COLUMBIA
Water Quality Limited:
Water Rights: See Water Rights in this section (Platcard)
Well Logs: See Well Logs in this section

RECEIVED
JUL 06 2011
WATER RESOURCES DEPT
SALEM, OREGON

OWRD Basic Web Mapping Application (beta)

Locate a place on the map ▶ Use Advanced Map ▶ Help ▶ Links ▶

Zoom In Zoom Out Pan Full Extent Identify

OWRD Data

- Rule Boundaries
 - Scenic Waterwa
 - Withdrawn Area
 - Deschutes Mitig
 - GW restricted a
 - NMFS Rule 4D
 - Division 33
- Political Boundaries
- Water Availability
 - Priority WABS
 - Water Availabili
- Water Rights
 - Ground water
 - Surface water
 - Storage Water
- Surface water
- Base Data
- Imagery

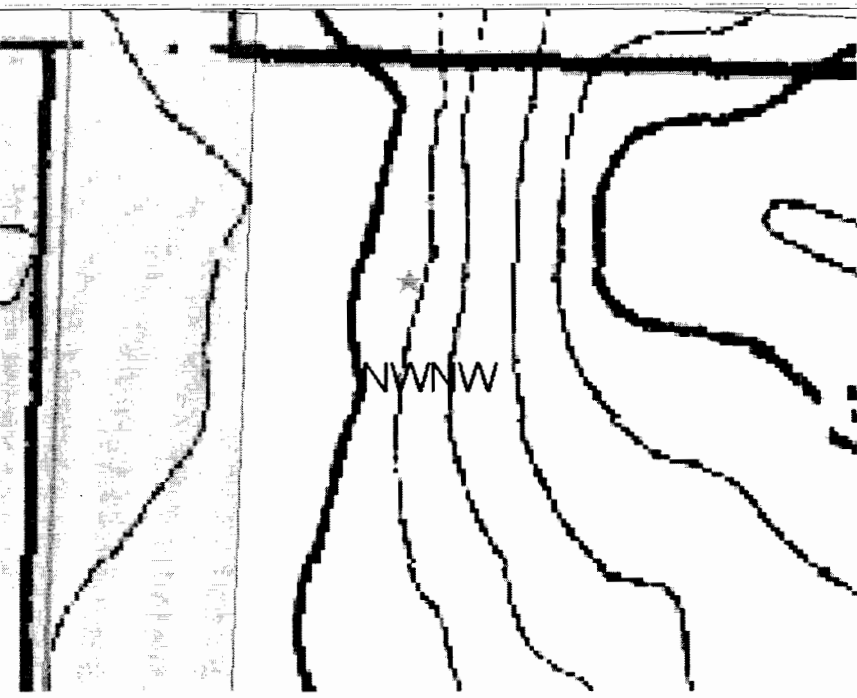

Selected Point

Latitude: 45.085080 , Longitude: -123.232182
Oregon Lambert Coordinate: 606834.81, 1227399.50
[Perform a peak discharge estimate at this point](#)
This point is located in the following TRSQQ:

TRSQQ: 06.00S-04.00W-06-NWNW

County: Yamhill
Basin: Willamette
WM District: 16
WM Region: NW
Withdrawn Area:
WAB: [SALT CR > S YAMHILL R - AT MOUTH \(73562\)](#)
Priority WAB:
Rule 4D: Rules apply
Groundwater Restricted:
Scenic Water Way:
Division 33: LOWER COLUMBIA
Water Quality Limited:
Water Rights: [See Water Rights in this section \(Platcard\)](#)
Well Logs: [See Well Logs in this section](#)

RECEIVED
JUL 06 2011
WATER RESOURCES DEPT
SALEM, OREGON