

WATER RIGHT MAP

WALLOWA COMMUNITY SERVICE TRAINING CENTER, INC.

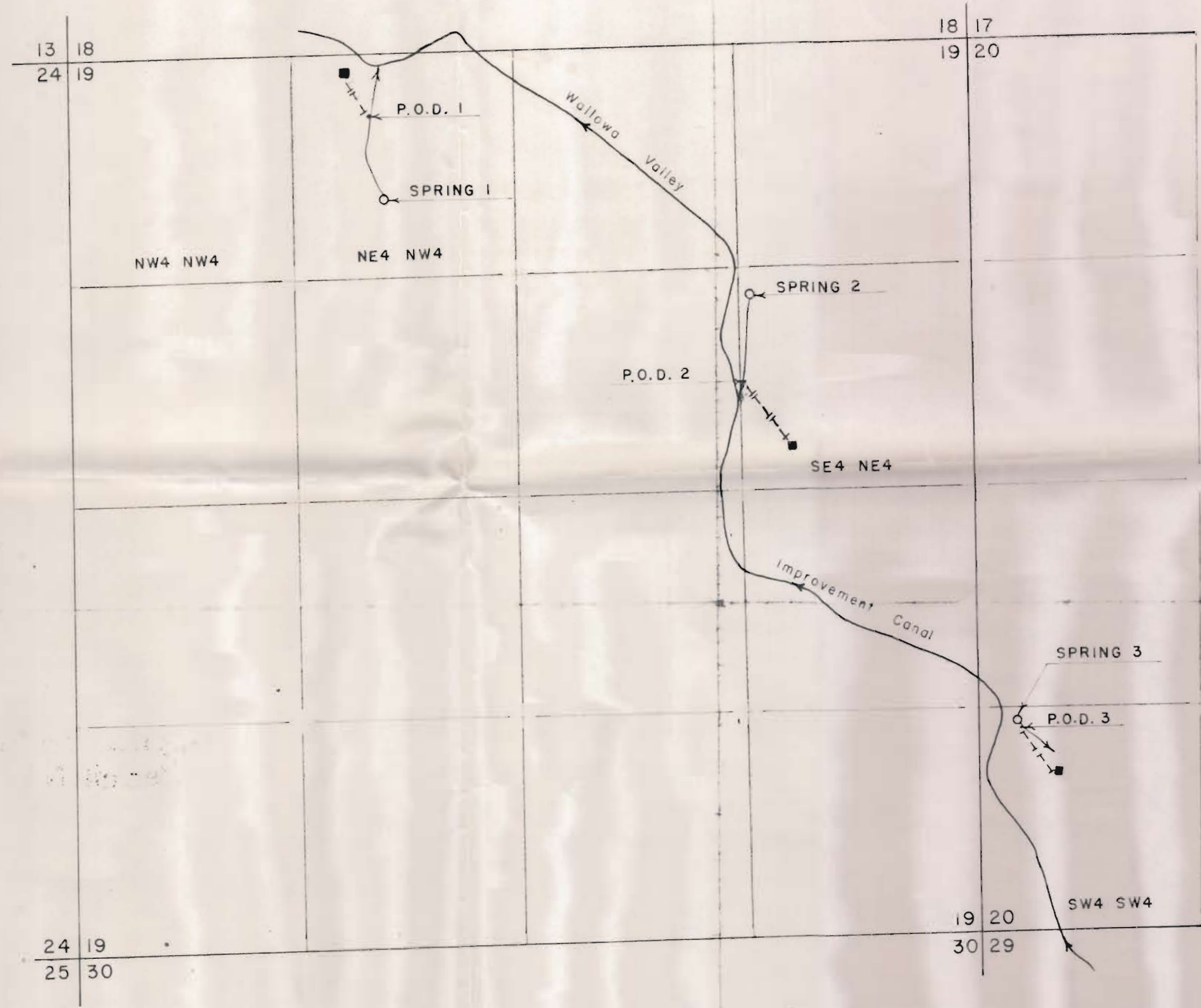

MAP LEGEND

- SPRING 1 - 840'S and 1830'E of the NW corner of Sec. 19.
- P.O.D. 1 - 370'S and 1770'E of the NW corner of Sec. 19. Diversion from spring through pipeline for domestic use in house within NE4NW4, Sec. 19, T. 35, R. 46E.
- SPRING 2 - 1450'S and 1290'W of the NE corner of Sec. 19.
- P.O.D. 2 - 1985'S and 1365'W of the NE corner of Sec. 19. Diversion from spring through pipe ~~to stock watering trough~~ for domestic use in house within SE4NE4, Sec. 19, T. 35, R. 46E.
- SPRING 3 - 1220'N and 200'E of the SW corner of Sec. 20.
- P.O.D. 3 - 1200'N and 240'E of the SW corner of Sec. 20. Diversion from spring through pipeline for domestic use in cabin within SW4SW4, Sec. 20, T. 35, R. 46E.

- Spring
- Proposed pipeline
- Proposed watering trough
- Building

SCALE 1" = 660'



Application No. 51286
Permit No. 38730

FILE COPY

T. 35 R. 46E W.M.

WATER RIGHT MAP

WALLOWA COMMUNITY SERVICE TRAINING CENTER, INC.

RECEIVED
 OCT 3 1973
 STATE ENGINEER
 SALEM, OREGON

RECEIVED
 APR 16 1974
 STATE ENGINEER
 SALEM, OREGON

RECEIVED
 OCT 14 1974
 STATE ENGINEER
 SALEM, OREGON

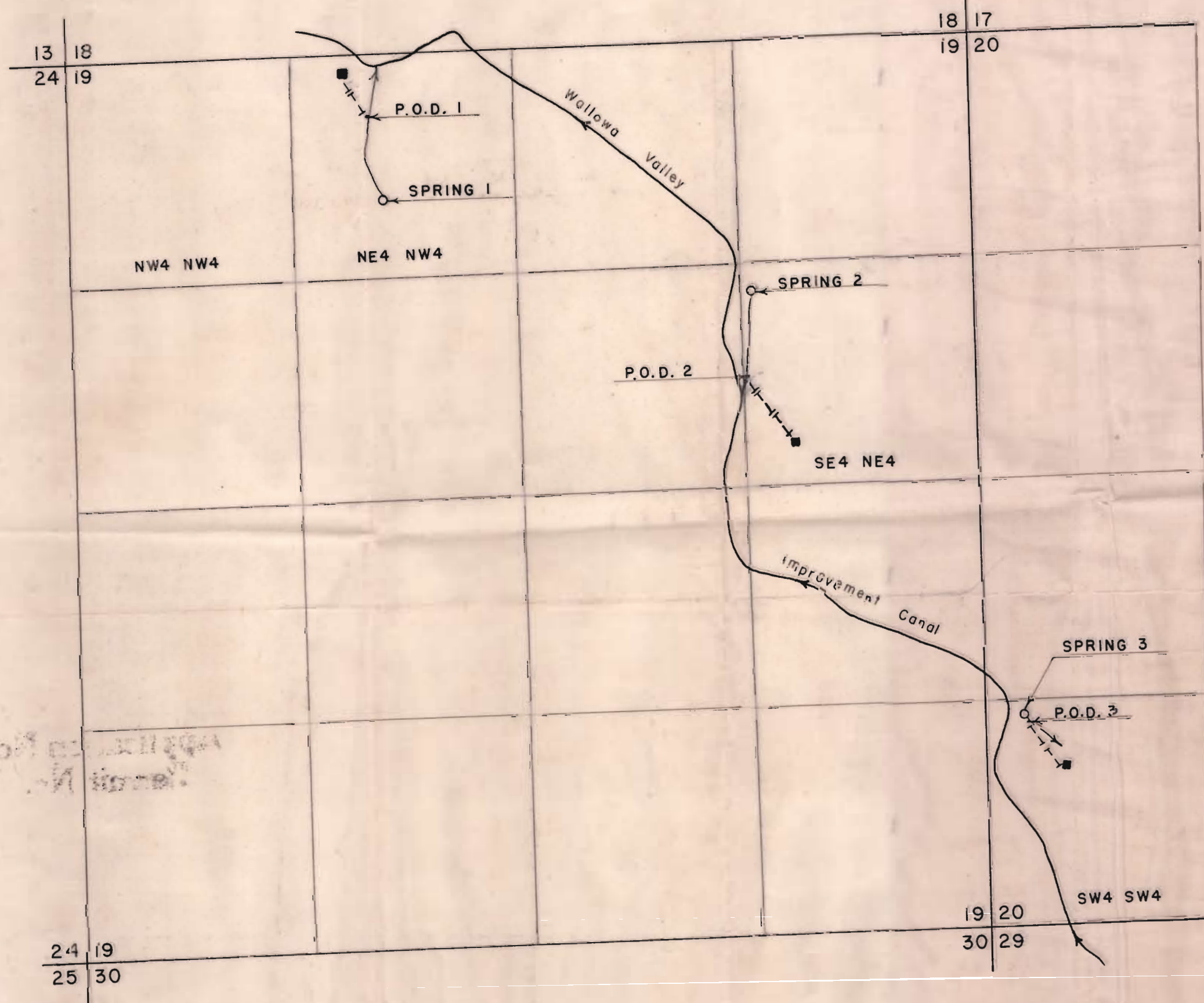

MAP LEGEND

- SPRING 1 - 840' S and 1830' E of the NW corner of Sec. 19.
- P.O.D. 1 - 370' S and 1770' E of the NW corner of Sec. 19. Diversion from spring through pipeline for domestic use in house within NE4NW4, Sec. 19, T. 3S, R. 46E.
- SPRING 2 - 1450' S and 1290' W of the NE corner of Sec. 19.
- P.O.D. 2 - 1985' S and 1365' W of the NE corner of Sec. 19. Diversion from spring through pipe ~~to stock watering trough~~ ^{for domestic use in house} within SE4NE4, Sec. 19, T. 3S, R. 46E.
- SPRING 3 - 1220' N and 200' E of the SW corner of Sec. 20.
- P.O.D. 3 - 1200' N and 240' E of the SW corner of Sec. 20. Diversion from spring through pipeline for domestic use in cabin within SW4SW4, Sec. 20, T. 3S, R. 46E.

- Spring
- Proposed pipeline
- Proposed watering trough
- Building

SCALE: 1" = 66'

Application No. 51286
 Permit No. 38730



WATER RIGHT MAP

WALLOWA COMMUNITY SERVICE TRAINING CENTER, INC.

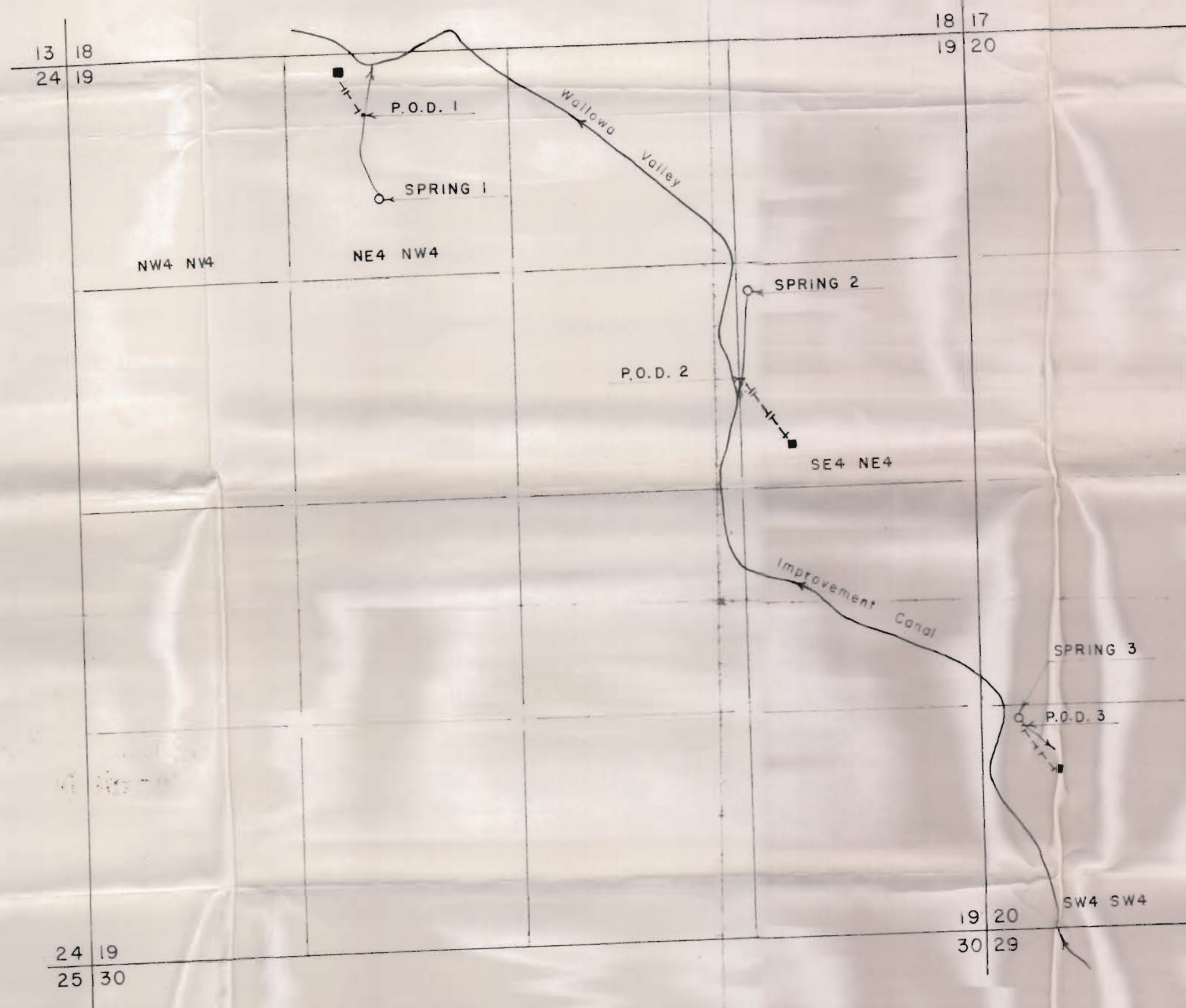

MAP LEGEND

- SPRING 1 - 840' S and 1830' E of the NW corner of Sec. 19
- P.O.D. 1 - 370' S and 1770' E of the NW corner of Sec. 19. Diversion from spring through pipeline for domestic use in house within NE4NW4, Sec. 19, T. 3S, R. 46E.
- SPRING 2 - 1450' S and 1290' W of the NE corner of Sec. 19
- P.O.D. 2 - 1985' S and 1365' W of the NE corner of Sec. 19. Diversion from spring through pipe ~~to stock watering trough~~ for domestic use in house within SE4NE4, Sec. 19, T. 3S, R. 46E.
- SPRING 3 - 1220' N and 200' E of the SW corner of Sec. 20
- P.O.D. 3 - 1200' N and 240' E of the SW corner of Sec. 20. Diversion from spring through pipeline for domestic use in cabin within SW4SW4, Sec. 20, T. 3S, R. 46E.

- Spring
- Proposed pipeline
- Proposed watering trough
- Building

SCALE: 1" = 660'

Application No. 51286
Permit No. 38730

N



T. 3S R. 46E W.M.