

# PLAT SHOWING PROPOSED EXTENSION OF THE NEWT YOUNG DITCH

Tp. 9 South 46 East Willamette Mer. Ore.

I, V. W. Plummer  
Of New Bridge Ore. do hereby certify  
that this map was made from notes  
taken during an actual survey made  
by me MAY 24 to 27-1912 and that  
it correctly represents the works described  
in the accompanying application together  
with the location of streams and other  
ditches in the immediate vicinity, and  
has written thereon the area in each  
smallest legal subdivision which it  
is proposed to irrigate.

V. W. Plummer Surveyor.

SCALE 1000 Ft. = ONE INCH

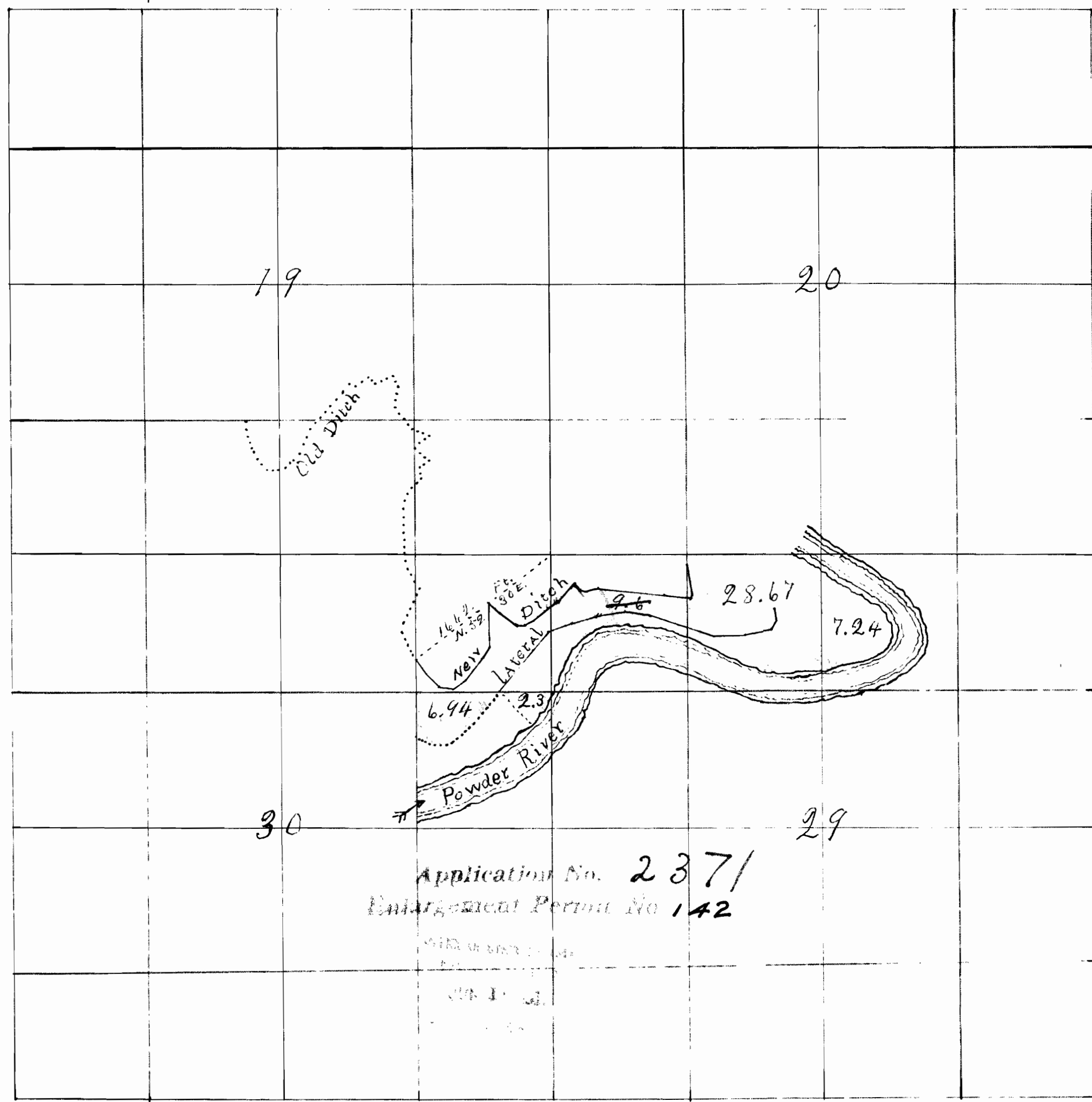

Application No. 2371  
Enlargement Permit No 142

PLAT SHOWING PROPOSED EXTENSION OF THE  
NEWT YOUNG DITCH

Tp. 9 South 46 East Willamette Mer. Ore.

2371

I, V. W. Plummer  
of New Bridge Ore. do hereby certify  
that this map was made from notes  
taken during an actual survey made  
by me May 24 to 27-1912 and that  
it correctly represents the works described  
in the accompanying application together  
with the location of streams and other  
ditches in the immediate vicinity, and  
has written thereon the area in each  
smallest legal subdivision which it  
is proposed to irrigate.

V. W. Plummer Surveyor.

2371

SCALE 1000 Ft. = ONE INCH

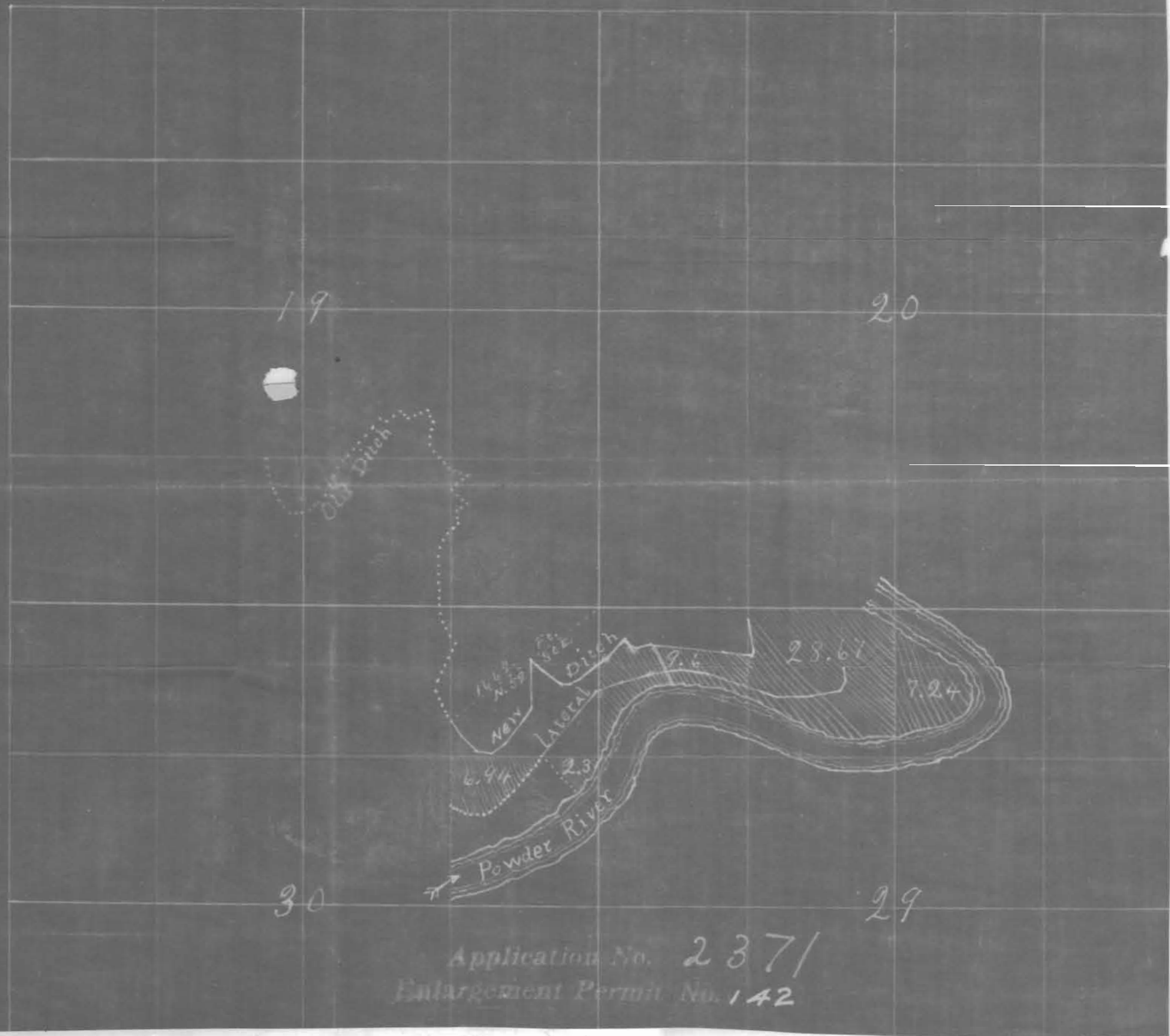

Application No. 2371  
Enlargement Permit No. 142