

**Water Right Conditions
Tracking Slip**

Groundwater/Hydrology Section

FILE ## G-17493

ROUTED TO: Water Rights - Kerry

TOWNSHIP/

RANGE-SECTION: 6S/39E-15 bc

CONDITIONS ATTACHED? yes no

REMARKS OR FURTHER INSTRUCTIONS:

Reviewer: Mike Zwart

WATER RESOURCES DEPARTMENT

MEMO

November 8, 2001

TO: Application G-17493
FROM: GW: Mike Zwart (Reviewer's Name)
SUBJECT: Scenic Waterway Interference Evaluation

YES

NO

The source of appropriation is within or above a Scenic Waterway

YES

NO

Use the Scenic Waterway condition (Condition 7J)

Per ORS 390.835, the Ground Water Section is able to calculate ground water interference with surface water that contributes to a Scenic Waterway. The calculated interference is distributed below.

Per ORS 390.835, the Ground Water Section is unable to calculate ground water interference with surface water that contributes to a scenic waterway; therefore, the Department is unable to find that there is a preponderance of evidence that the proposed use will measurably reduce the surface water flows necessary to maintain the free-flowing character of a scenic waterway.

DISTRIBUTION OF INTERFERENCE

Calculate the percentage of consumptive use by month and fill in the table below. If interference cannot be calculated, per criteria in 390.835, do not fill in the table but check the "unable" option above, thus informing Water Rights that the Department is unable to make a Preponderance of Evidence finding.

Exercise of this permit is calculated to reduce monthly flows in Scenic Waterway by the following amounts expressed as a proportion of the consumptive use by which surface water flow is reduced.

Table with 12 columns: Jan, Feb, Mar, Apr, May, Jun, Jul, Aug, Sep, Oct, Nov, Dec

PUBLIC INTEREST REVIEW FOR GROUND WATER APPLICATIONS

TO: Water Rights Section Date November 8, 2011

FROM: Ground Water/Hydrology Section Michael Zwart
Reviewer's Name

SUBJECT: Application G- 17493 Supersedes review of _____
Date of Review(s)

PUBLIC INTEREST PRESUMPTION; GROUNDWATER

OAR 690-310-130 (1) *The Department shall presume that a proposed groundwater use will ensure the preservation of the public welfare, safety and health as described in ORS 537.525.* Department staff review ground water applications under OAR 690-310-140 to determine whether the presumption is established. OAR 690-310-140 allows the proposed use be modified or conditioned to meet the presumption criteria. **This review is based upon available information and agency policies in place at the time of evaluation.**

A. GENERAL INFORMATION: Applicant's Name: Blaine D. Allen County: Union

A1. Applicant(s) seek(s) 2.23 cfs from one well(s) in the Powder Basin,
North Powder River/Wolf Creek subbasin Quad Map: North Powder

A2. Proposed use: Irrigation, 261 acres Seasonality: April 1 to October 31
 A3. Well and aquifer data (attach and number logs for existing wells; mark proposed wells as such under logid):

Well	Logid	Applicant's Well #	Proposed Aquifer*	Proposed Rate(cfs)	Location (T/R-S QQ-Q)	Location, metes and bounds, e.g. 2250' N, 1200' E fr NW cor S 36
1	Proposed	1	Basin Fill	2.23	6S/39E-15 SW-NW	660' N, 248' E fr W ¼ cor S 15
2						
3						
4						
5						

* Alluvium, CRB, Bedrock

Well	Well Elev ft msl	First Water ft bls	SWL ft bls	SWL Date	Well Depth (ft)	Seal Interval (ft)	Casing Intervals (ft)	Liner Intervals (ft)	Perforations Or Screens (ft)	Well Yield (gpm)	Draw Down (ft)	Test Type
1	3288				500	0-100	0-500	None	101-500			

Use data from application for proposed wells.

A4. **Comments: The proposed construction is based closely on that for UNIO 1537, owned by the City of North Powder. The city well penetrates a confined aquifer and flows at land surface. Determination of the top of the confined aquifer is problematic, however. This city well reports flowing conditions at only 59 feet, but another (UNIO 1539) does not report flow until a depth of 211 feet and this log suggests that the head increases with depth. The proposed well here may need to be cased and sealed deeper, depending on the local lithology. See additional comments on this proposal at B3.**

A5. **Provisions of the Powder** Basin rules relative to the development, classification and/or management of ground water hydraulically connected to surface water are, or are not, activated by this application. (Not all basin rules contain such provisions.)
 Comments: _____

A6. **Well(s) #** _____, _____, _____, _____, _____, tap(s) an aquifer limited by an administrative restriction.
 Name of administrative area: _____
 Comments: _____

B. GROUND WATER AVAILABILITY CONSIDERATIONS, OAR 690-310-130, 400-010, 410-0070

B1. **Based upon available data**, I have determined that ground water* for the proposed use:

- a. is over appropriated, is not over appropriated, or **cannot be determined to be** over appropriated during any period of the proposed use. * This finding is limited to the ground water portion of the over-appropriation determination as prescribed in OAR 690-310-130;
- b. will not or will likely be available in the amounts requested without injury to prior water rights. * This finding is limited to the ground water portion of the injury determination as prescribed in OAR 690-310-130;
- c. will not or will likely to be available within the capacity of the ground water resource; or
- d. **will, if properly conditioned**, avoid injury to existing ground water rights or to the ground water resource:
 - i. The permit should contain condition #(s) 7N, 7K: 130 / an unconfined aquifer*;
 - ii. The permit should be conditioned as indicated in item 2 below.
 - iii. The permit should contain special condition(s) as indicated in item 3 below;

- B2. a. **Condition** to allow ground water production from no deeper than _____ ft. below land surface;
- b. **Condition** to allow ground water production from no shallower than _____ ft. below land surface;
- c. **Condition** to allow ground water production only from the confined ground water reservoir between approximately 100± ft. and 500 ft. below land surface;
- d. **Well reconstruction** is necessary to accomplish one or more of the above conditions. The problems that are likely to occur with this use and without reconstructing are cited below. Without reconstruction, I recommend withholding issuance of the permit until evidence of well reconstruction is filed with the Department and approved by the Ground Water Section.

Describe injury –as related to water availability– that is likely to occur without well reconstruction (interference w/ senior water rights, not within the capacity of the resource, etc): _____

B3. **Ground water availability remarks:** There is one local well (SOW 871, UNIO 1536) with a long-term water level record. Groundwater is not intensely developed for irrigation in the area, but the proposed well may cause some interference with the City of North Powder's deep wells.

* The recommendation to case and seal to 130 feet is based on the lithologic descriptions of reasonably thick clay beds with no or minimal sand reported in wells UNIO 1537 and UNIO 1539. The top of the clay is reported to be at a depth of 125 and 126 feet below land surface, respectively.

C. GROUND WATER/SURFACE WATER CONSIDERATIONS, OAR 690-09-040

C1. **690-09-040 (1):** Evaluation of aquifer confinement:

Well	Aquifer or Proposed Aquifer	Confined	Unconfined
1	Interbedded clay, sand and gravel	<input checked="" type="checkbox"/>	<input type="checkbox"/>
		<input type="checkbox"/>	<input type="checkbox"/>
		<input type="checkbox"/>	<input type="checkbox"/>
		<input type="checkbox"/>	<input type="checkbox"/>
		<input type="checkbox"/>	<input type="checkbox"/>

Basis for aquifer confinement evaluation: Local well logs indicate that deeper water-bearing zones are confined, with flowing wells common in the area.

C2. **690-09-040 (2) (3):** Evaluation of distance to, and hydraulic connection with, surface water sources. All wells located a horizontal distance less than ¼ mile from a surface water source that produce water from an unconfined aquifer shall be assumed to be hydraulically connected to the surface water source. Include in this table any streams located beyond one mile that are evaluated for PSI.

Well	SW #	Surface Water Name	GW Elev ft msl	SW Elev ft msl	Distance (ft)	Hydraulically Connected?			Potential for Subst. Interfer. Assumed?	
						YES	NO	ASSUMED	YES	NO
1	1	Wolf Creek	3300±	3280	850	<input type="checkbox"/>	<input checked="" type="checkbox"/>	<input type="checkbox"/>	<input type="checkbox"/>	<input checked="" type="checkbox"/>
1	2	North Powder River	3300±	3240	7900	<input type="checkbox"/>	<input checked="" type="checkbox"/>	<input type="checkbox"/>	<input type="checkbox"/>	<input checked="" type="checkbox"/>
1	3	Powder River	3300±	3200	9200	<input checked="" type="checkbox"/>	<input type="checkbox"/>	<input type="checkbox"/>	<input type="checkbox"/>	<input checked="" type="checkbox"/>
						<input type="checkbox"/>	<input type="checkbox"/>	<input type="checkbox"/>	<input type="checkbox"/>	<input type="checkbox"/>
						<input type="checkbox"/>	<input type="checkbox"/>	<input type="checkbox"/>	<input type="checkbox"/>	<input type="checkbox"/>
						<input type="checkbox"/>	<input type="checkbox"/>	<input type="checkbox"/>	<input type="checkbox"/>	<input type="checkbox"/>
						<input type="checkbox"/>	<input type="checkbox"/>	<input type="checkbox"/>	<input type="checkbox"/>	<input type="checkbox"/>
						<input type="checkbox"/>	<input type="checkbox"/>	<input type="checkbox"/>	<input type="checkbox"/>	<input type="checkbox"/>
						<input type="checkbox"/>	<input type="checkbox"/>	<input type="checkbox"/>	<input type="checkbox"/>	<input type="checkbox"/>

Basis for aquifer hydraulic connection evaluation: The nearby stream reaches are not incised to the confined aquifer. However, it is likely that the confined aquifer discharges to the Powder River above the confluence with Jimmy Creek where the valley narrows. The mechanism for this is more likely by upward movement of groundwater, providing recharge to the overlying unconfined aquifer, which has a more efficient hydraulic connection with the river. Therefore, the hydraulic connection with the mainstem Powder River is judged to be indirect and inefficient.
 Water Availability Basin the well(s) are located within: 72163: WOLF CR> POWDER R- AT MOUTH;
72191: POWDER R> SNAKE R- AB UNN STR

C3a. **690-09-040 (4):** Evaluation of stream impacts for each well that has been determined or assumed to be hydraulically connected and less than 1 mile from a surface water source. Limit evaluation to instream rights and minimum stream flows that are pertinent to that surface water source, and not lower SW sources to which the stream under evaluation is tributary. Compare the requested rate against the 1% of 80% natural flow for the pertinent Water Availability Basin (WAB). If Q is not distributed by well, use full rate for each well. Any checked box indicates the well is assumed to have the potential to cause PSI.

Well	SW #	Well < ¼ mile?	Qw > 5 cfs?	Instream Water Right ID	Instream Water Right Q (cfs)	Qw > 1% ISWR?	80% Natural Flow (cfs)	Qw > 1% of 80% Natural Flow?	Interference @ 30 days (%)	Potential for Subst. Interfer. Assumed?
		<input type="checkbox"/>	<input type="checkbox"/>			<input type="checkbox"/>		<input type="checkbox"/>		<input type="checkbox"/>
		<input type="checkbox"/>	<input type="checkbox"/>			<input type="checkbox"/>		<input type="checkbox"/>		<input type="checkbox"/>
		<input type="checkbox"/>	<input type="checkbox"/>			<input type="checkbox"/>		<input type="checkbox"/>		<input type="checkbox"/>
		<input type="checkbox"/>	<input type="checkbox"/>			<input type="checkbox"/>		<input type="checkbox"/>		<input type="checkbox"/>
		<input type="checkbox"/>	<input type="checkbox"/>			<input type="checkbox"/>		<input type="checkbox"/>		<input type="checkbox"/>
		<input type="checkbox"/>	<input type="checkbox"/>			<input type="checkbox"/>		<input type="checkbox"/>		<input type="checkbox"/>
		<input type="checkbox"/>	<input type="checkbox"/>			<input type="checkbox"/>		<input type="checkbox"/>		<input type="checkbox"/>
		<input type="checkbox"/>	<input type="checkbox"/>			<input type="checkbox"/>		<input type="checkbox"/>		<input type="checkbox"/>
		<input type="checkbox"/>	<input type="checkbox"/>			<input type="checkbox"/>		<input type="checkbox"/>		<input type="checkbox"/>

C3b. **690-09-040 (4):** Evaluation of stream impacts by total appropriation for all wells determined or assumed to be **hydraulically connected and less than 1 mile** from a surface water source. **Complete only if Q is distributed among wells.** Otherwise same evaluation and limitations apply as in C3a above.

SW #	Qw > 5 cfs?	Instream Water Right ID	Instream Water Right Q (cfs)	Qw > 1% ISWR?	80% Natural Flow (cfs)	Qw > 1% of 80% Natural Flow?	Interference @ 30 days (%)	Potential for Subst. Interfer. Assumed?
	<input type="checkbox"/>			<input type="checkbox"/>		<input type="checkbox"/>		<input type="checkbox"/>
	<input type="checkbox"/>			<input type="checkbox"/>		<input type="checkbox"/>		<input type="checkbox"/>
	<input type="checkbox"/>			<input type="checkbox"/>		<input type="checkbox"/>		<input type="checkbox"/>
	<input type="checkbox"/>			<input type="checkbox"/>		<input type="checkbox"/>		<input type="checkbox"/>

Comments: This section does not apply.

C4a. **690-09-040 (5):** Estimated impacts on **hydraulically connected surface water sources greater than one mile** as a percentage of the proposed pumping rate. Limit evaluation to the effects that will occur up to one year after pumping begins. This table encompasses the considerations required by 09-040 (5)(a), (b), (c) and (d), which are not included on this form. Use additional sheets if calculated flows from more than one WAB are required.

Non-Distributed Wells													
Well	SW#	Jan	Feb	Mar	Apr	May	Jun	Jul	Aug	Sep	Oct	Nov	Dec
		%	%	%	%	%	%	%	%	%	%	%	%
Well Q as CFS													
Interference CFS													
Distributed Wells													
Well	SW#	Jan	Feb	Mar	Apr	May	Jun	Jul	Aug	Sep	Oct	Nov	Dec
		%	%	%	%	%	%	%	%	%	%	%	%
Well Q as CFS													
Interference CFS													
		%	%	%	%	%	%	%	%	%	%	%	%
Well Q as CFS													
Interference CFS													
		%	%	%	%	%	%	%	%	%	%	%	%
Well Q as CFS													
Interference CFS													
		%	%	%	%	%	%	%	%	%	%	%	%
Well Q as CFS													
Interference CFS													
		%	%	%	%	%	%	%	%	%	%	%	%
Well Q as CFS													
Interference CFS													
(A) = Total Interf.													
(B) = 80 % Nat. Q													
(C) = 1 % Nat. Q													
(D) = (A) > (C)		✓	✓	✓	✓	✓	✓	✓	✓	✓	✓	✓	✓
(E) = (A / B) x 100		%	%	%	%	%	%	%	%	%	%	%	%

(A) = total interference as CFS; (B) = WAB calculated natural flow at 80% exceed. as CFS; (C) = 1% of calculated natural flow at 80% exceed. as CFS; (D) = highlight the checkmark for each month where (A) is greater than (C); (E) = total interference divided by 80% flow as percentage.

D. WELL CONSTRUCTION, OAR 690-200

D1. Well #: _____ Logid: _____

D2. **THE WELL does not meet current well construction standards based upon:**

- a. review of the well log;
- b. field inspection by _____;
- c. report of CWRE _____;
- d. other: (specify) _____

D3. **THE WELL construction deficiency:**

- a. constitutes a health threat under Division 200 rules;
- b. commingles water from more than one ground water reservoir;
- c. permits the loss of artesian head;
- d. permits the de-watering of one or more ground water reservoirs;
- e. other: (specify) _____

D4. **THE WELL construction deficiency is described as follows:** _____

- D5. **THE WELL** a. was, or was not constructed according to the standards in effect at the time of original construction or most recent modification.
- b. I don't know if it met standards at the time of construction.

D6. **Route to the Enforcement Section.** I recommend withholding issuance of the permit until evidence of well reconstruction is filed with the Department and approved by the Enforcement Section and the Ground Water Section.

THIS SECTION TO BE COMPLETED BY ENFORCEMENT PERSONNEL

D7. Well construction deficiency has been corrected by the following actions: _____

_____, 200_____
(Enforcement Section Signature)

D8. **Route to Water Rights Section (attach well reconstruction logs to this page).**

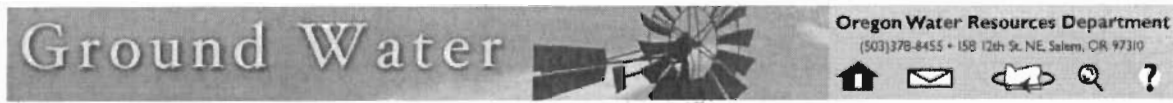

Oregon Water Resources Department Hydrograph for State Well UNIO 1536, State Observation Well # 871

Oregon Water Resources Department Well Location	6.00S/39.00E-20BAC
Oregon Water Resources Department Logid	UNIO 1536
Oregon Water Resources Department Well Tag (Well ID)	----
Oregon Water Resources Department State Observation Well Number	871
Total well depth (feet below land surface)	564
Land surface elevation (feet above mean sea level)	----
Primary use of well	----
Primary aquifer system	----

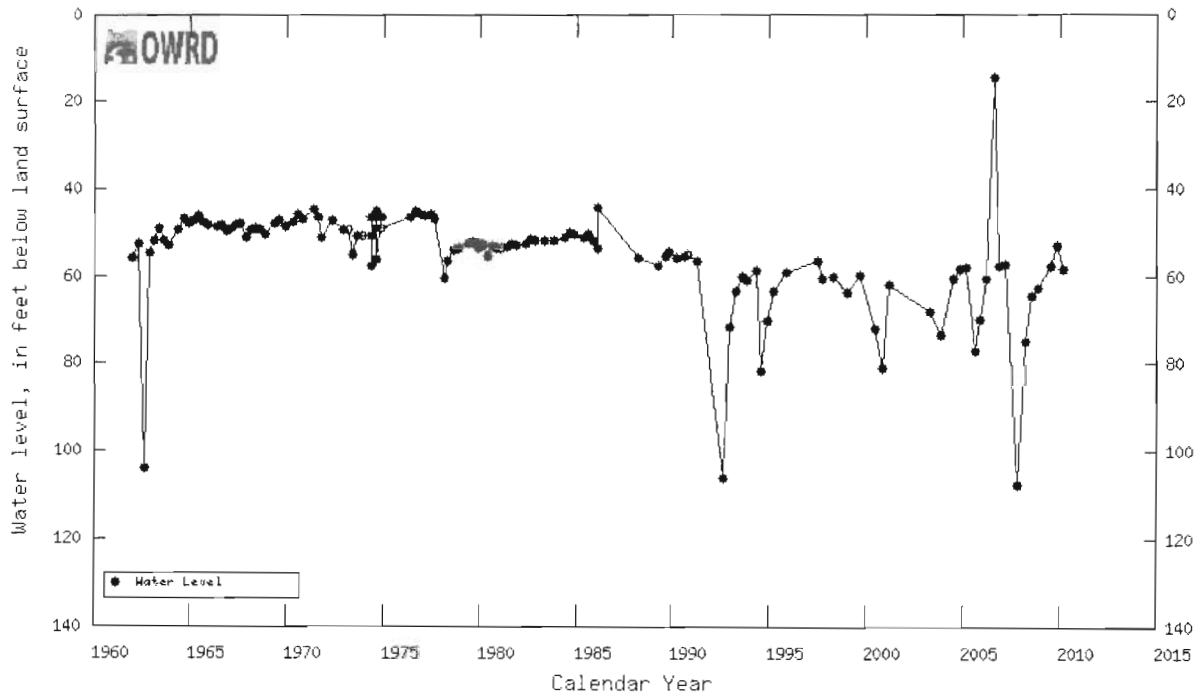
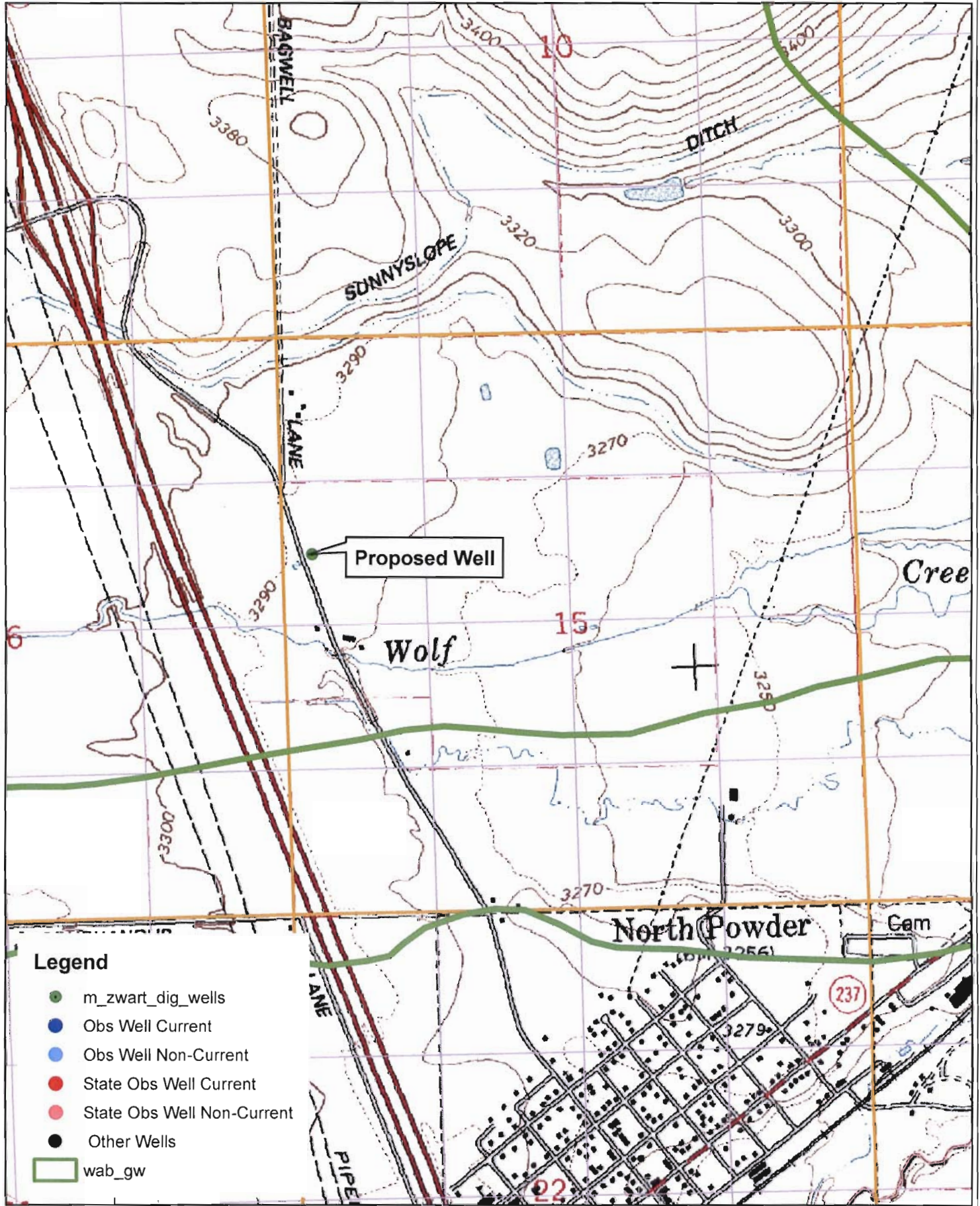

Table showing water-level data for State Well UNIO 1536, State Observation Well # 871

Application G-17493, Blaine D. Allen



Legend

- m_zwart_dig_wells
- Obs Well Current
- Obs Well Non-Current
- State Obs Well Current
- State Obs Well Non-Current
- Other Wells
- ▭ wab_gw

