

T6N, R33E, WM - UMATILLA COUNTY

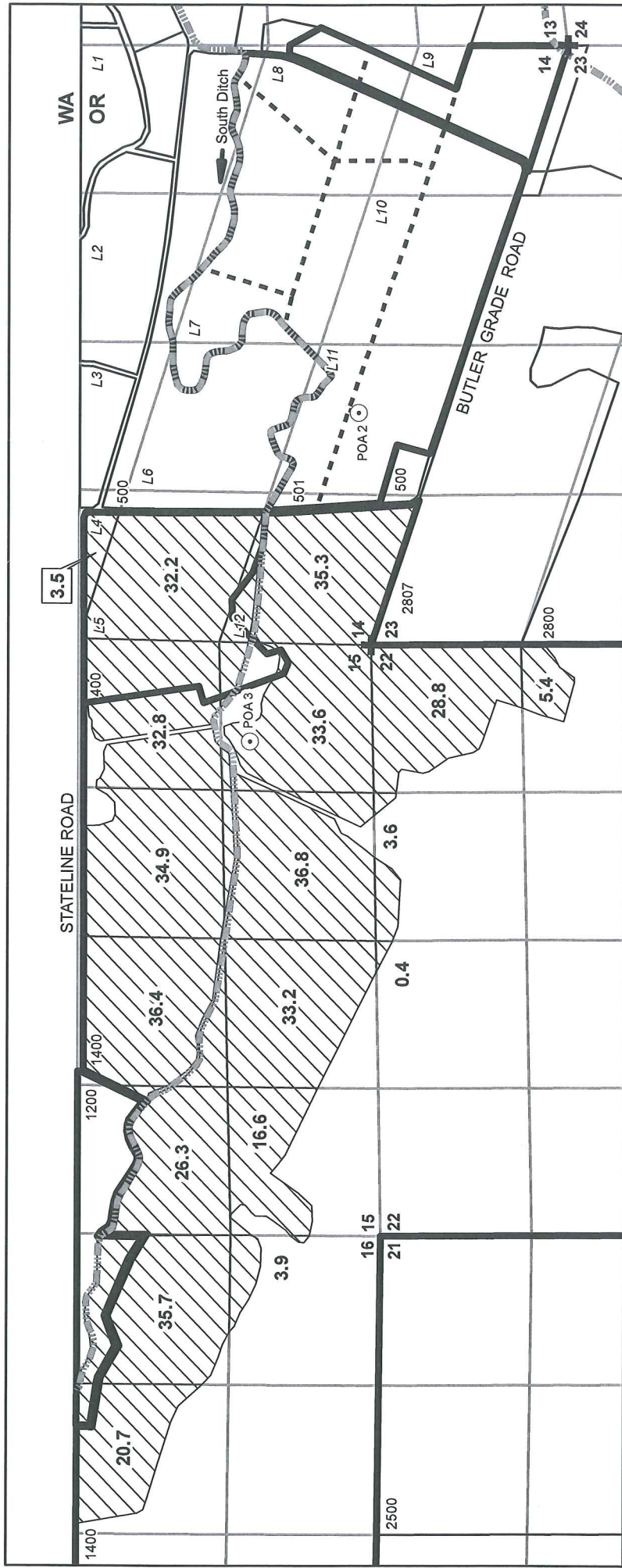

⊙ **Point of Appropriation (POA)**

POA 2 is proposed groundwater well in alluvial (gravel) aquifer located in SE/4, SW/4, Section 14 at a distance 160 feet N and 2040 feet E from SW Corner of Section 14 (TL 501). Well does not currently exist.

POA 3 is proposed groundwater well in alluvial (gravel) aquifer located in SE/4, SE/4, Section 15 at a distance 1045 feet N and 870 feet W from SE Corner of Section 15 (TL 1400). Well does not currently exist.

- - - - **Conveyance**

Existing buried mainline will connect all three wells and convey water throughout place of use. Water will be applied with sprinklers on aluminum hand-lines.



Place of Use

420.1 acres in Tax Lots 400, 1200 and 1400.

The purpose of this map is to identify the location of a water right. It is not intended to provide information regarding the location of property ownership boundary lines.

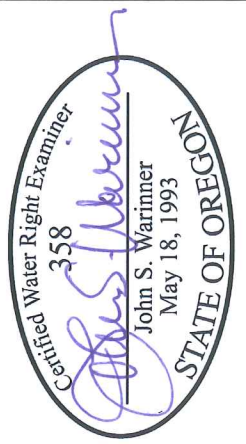
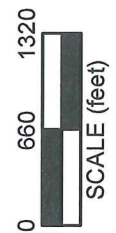

APPLICATION MAP
Permit to Use Groundwater
Application G-17434

in the name of
 KREGGER FARMING ENTERPRISES, LLC
 Revised 21 NOV 2011

RECEIVED
 NOV 23 2011
 WATER RESOURCES DEPT
 SALEM, OREGON