

R. 44 E. 13 18 R. 45 E.

CLAIM OF BENEFICIAL USE & SITE MAP

T-8339

PERMIT G-4405

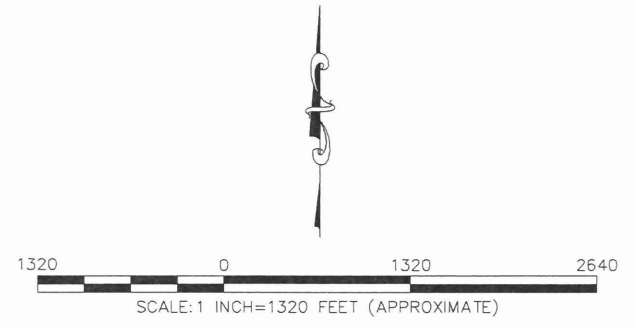
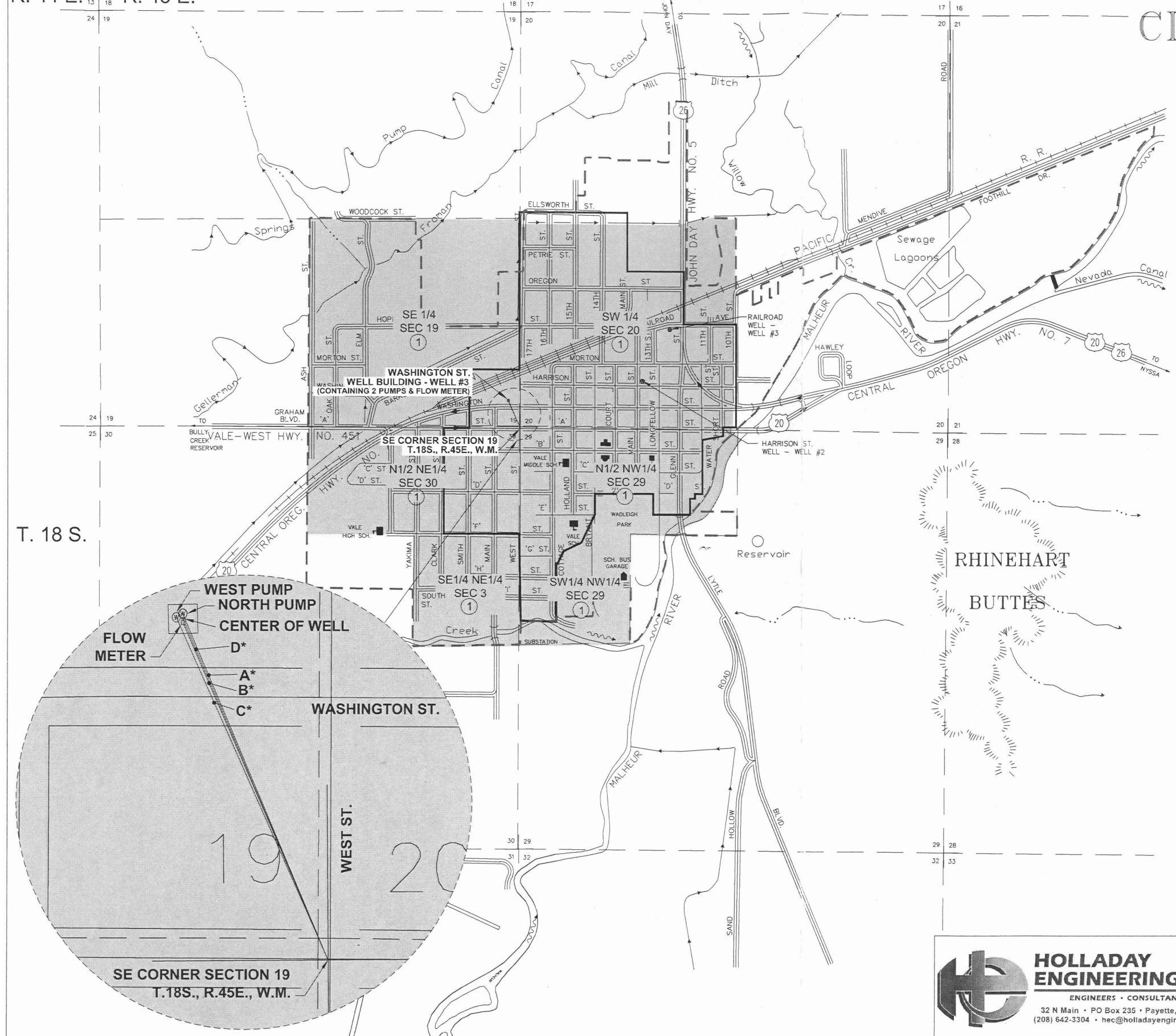

CITY OF VALE

LEGEND:

- CURRENT CITY LIMITS
- CITY BOUNDARY DURING 1927 ADJUDICATION
- ~ RIVER FLOW DIRECTION
- IRRIGATION DITCH FLOW DIRECTION
- ① PERMIT NO G-4405
- A* (NORTH PUMP) N22°48'57"W 387.50'
- B* (FLOW METER) N23°19'51"W 378.76'
- C* (WEST PUMP) N23°56'53"W 386.69'
- D* (CENTER OF WELL) N23°05'59"W 382.60'

Certified Water Right Examiner
#069
DRAFT
Michael E. Holladay
Nov. 19, 1987
STATE OF OREGON

T. 18 S.

REVISED: DECEMBER 14, 2011



HOLLADAY ENGINEERING CO.
ENGINEERS • CONSULTANTS
32 N Main • PO Box 235 • Payette, ID 83661
(208) 642-3304 • hec@holladayengineering.com

WATER RIGHTS MAP
CITY OF VALE, OREGON