

T.14S.R.16E.W.M

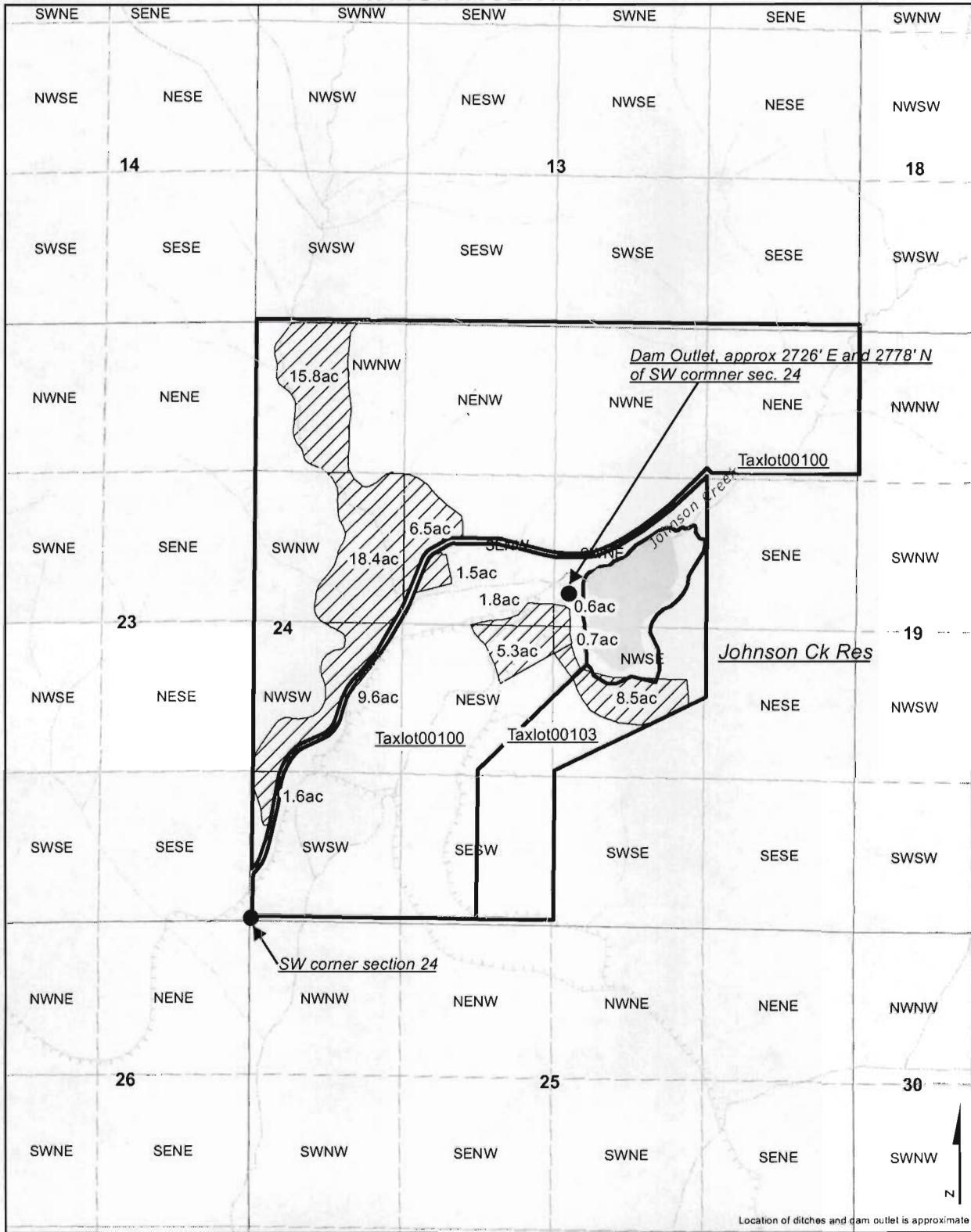

**Application to Use Stored Water from Johnson Ck Res
for Primary Irrigation of 70.0 Acres**

Map Disclaimer:
This product is for informational purposes and may not have been prepared for, or be suitable for legal, engineering, or surveying purposes. Users of this information should review or consult the primary data and information sources to ascertain the usability of the information.
This map is not intended to display property lines

Disclaimer: This listing is the result of a manual search of the records of the Watermaster's Plat Cards and the WRIS database. The listing has not been field checked. That a right is of record is no guarantee that it has not been abandoned under the provisions of ORS 540.610. The plat card records of listed by the 40.0 acre quarter-quarter within a section. If the water right listed within a quarter-quarter is on more than one tax lot, this office has not itemized that water rights for each tax lot - only a survey could accurately depict how much of the water rights are on each tax lot.

RECEIVED

FEB 7 2012

WATER RESOURCES DEPT
SALEM, OREGON

Legend

- Proposed Irrigation From Reservoir
- Seals Property Outline (approx)
- Sections
- Quarter quarters
- Water bodies
- Glaciers/snow fields
- Islands
- Wet areas
- Ditches, canals, flumes
- Pipelines, etc.
- Perennial
- Intermittent or seasonal
- Ephemeral

1 inch equals 1,320 feet

0 325 650 Feet

Map made by David Bates, Assistant W.M. Dist 11, Bend OR 1/3/2012
C:\Data\gis\Johnson Creek\Johnson Creek Water Rights.mxd

T.14S.R.16E.W.M

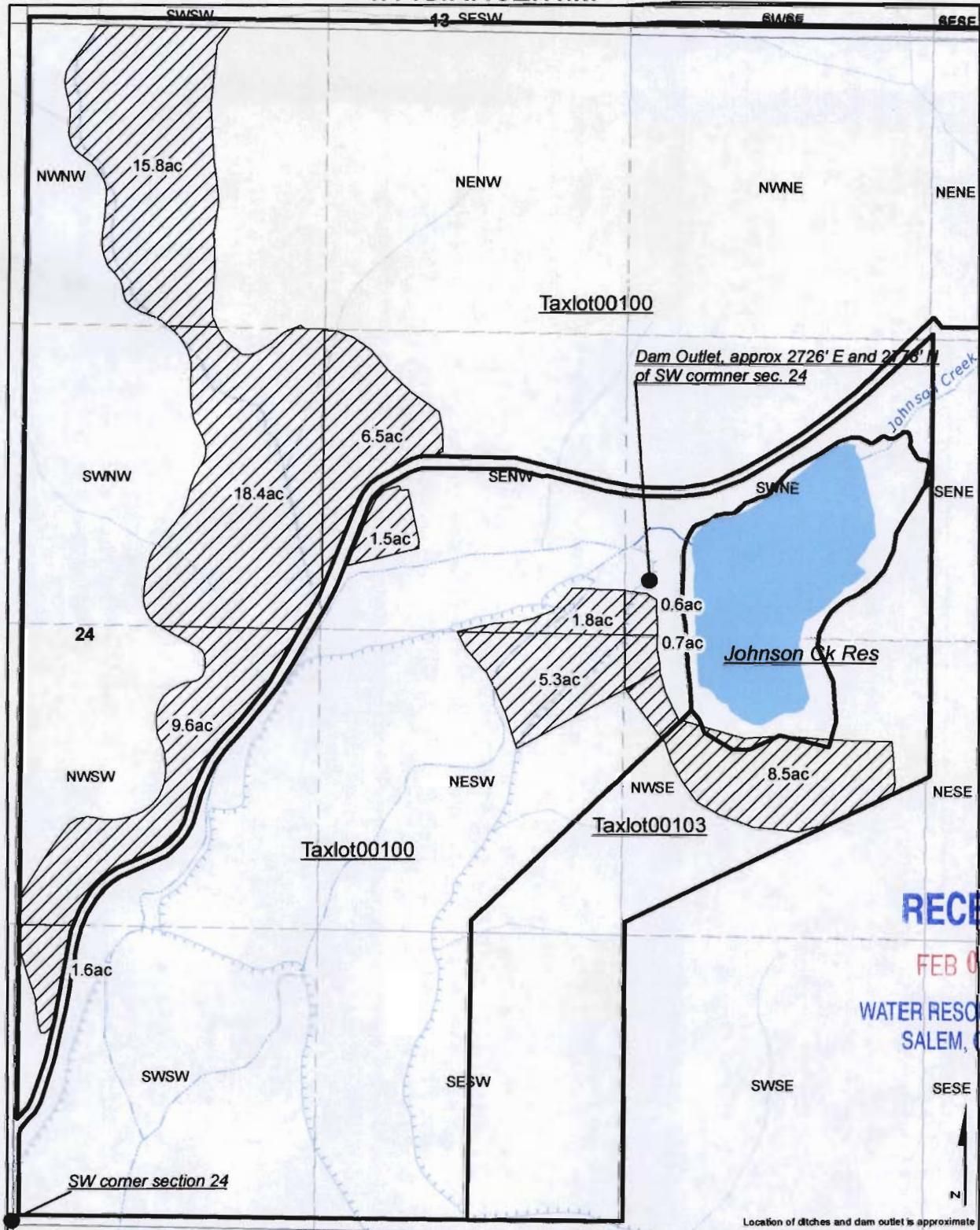

RECEIVED

FEB 06 2012

WATER RESOURCES DEPT
SALEM, OREGON

Application to Use Stored Water from Johnson Ck Res for Primary Irrigation of 70.0 Acres

Map Disclaimer:
This product is for informational purposes and may not have been prepared for, or be suitable for legal, engineering, or surveying purposes. Users of this information should review or consult the primary data and information sources to ascertain the usability of the information. This map is not intended to display property lines

Disclaimer: This listing is the result of a manual search of the records of the Watermaster's Plat Cards and the WRIS database. The listing has not been field checked. That a right is of record is no guarantee that it has not been abandoned under the conditions of ORS 540.610. The plat card records of listed by the 40.0 acre quarter-quarter within a section. If the water right listed within a quarter-quarter is on more than one tax lot, this office has not remitized that water rights for each tax lot - only a survey could accurately depict how much of the water rights are on each tax lot.

Legend

- Proposed Irrigation From Reservoir
- Seals Property Outline (approx)
- Sections
- Quarter quarters
- Water bodies
- Glaciers/snow fields
- Islands
- Wet areas
- Ditches, canals, flumes
- Pipelines, etc.
- Perennial
- Intermittent or seasonal
- Ephemeral

1:7,920

0 300 600 Feet

Map made by David Bates, Assistant W.M. Dist 11, Bend OR 1/3/2012
C:\Data\db_gis\Johnson Creek\Johnson Creek Water Rights.mxd

S-87782