

# Application for a Permit to Use Ground Water



Oregon Water Resources Department  
725 Summer Street NE, Suite A  
Salem, Oregon 97301-1266  
(503) 986-0900  
www.wrd.state.or.us

## SECTION 1: APPLICANT INFORMATION AND SIGNATURE

### Applicant Information

NAME HOMER & JEANNETTE HARRISON		PHONE (HM) 541-932-4718	
PHONE (WK)	CELL 541-620-1218	FAX	
ADDRESS P.O. BOX 551			
CITY MOUNT VERNON	STATE OREGON	ZIP 97865	MAIL* HARRHJTS@ORTELCO.NET

### Organization Information

NAME NA		PHONE	FAX
ADDRESS			CELL
CITY	STATE	ZIP	E-MAIL*

**Agent Information** – The agent is authorized to represent the applicant in all matters relating to this application.

AGENT / BUSINESS NAME NA		PHONE	FAX
ADDRESS			CELL
CITY	STATE	ZIP	E-MAIL*

**RECEIVED**  
FEB 15 2012

WATER RESOURCES DEPT  
SALEM, OREGON

**RECEIVED**  
FEB 15 2012

WATER RESOURCES DEPT  
SALEM, OREGON

Note: Attach multiple copies as needed

\* By providing an e-mail address, consent is given to receive all correspondence from the department electronically. (paper copies of the final order documents will also be mailed.)

By my signature below I confirm that I understand:

- I am asking to use water specifically as described in this application.
- Evaluation of this application will be based on information provided in the application.
- I cannot use water legally until the Water Resources Department issues a permit.
- Oregon law requires that a permit be issued before beginning construction of any proposed well, unless the use is exempt. Acceptance of this application does not guarantee a permit will be issued.
- If I get a permit, I must not waste water.
- If development of the water use is not according to the terms of the permit, the permit can be cancelled.
- The water use must be compatible with local comprehensive land-use plans.
- Even if the Department issues a permit, I may have to stop using water to allow senior water-right holders to get water to which they are entitled.

I (we) affirm that the information contained in this application is true and accurate.

  
Homer L Harrison      Homer L Harrison      2-13-12  
 Applicant Signature      Print Name and title if applicable      Date  
Jeannette Harrison      Jeannette Harrison      2-13-12  
 Applicant Signature      Print Name and title if applicable      Date

For Department Use		
App. No. <u>617536</u>	Permit No. _____	Date _____

**SECTION 2: PROPERTY OWNERSHIP**

Please indicate if you own all the lands associated with the project from which the water is to be diverted, conveyed, and used.

Yes

There are no encumbrances.

This land is encumbered by easements, rights of way, roads or other encumbrances.

No

I have a recorded easement or written authorization permitting access.

I do not currently have written authorization or easement permitting access.

Written authorization or an easement is not necessary, because the only affected lands I do not own are state-owned submersible lands, and this application is for irrigation and/or domestic use only (ORS 274.040).

Water is to be diverted, conveyed, and/or used only on federal lands.

List the names and mailing addresses of all affected landowners (*attach additional sheets if necessary*).

\_\_\_\_\_

**SECTION 3: WELL DEVELOPMENT**

WELL NO.	NAME OF NEAREST SURFACE WATER	IF LESS THAN 1 MILE:	
		DISTANCE TO NEAREST SURFACE WATER	ELEVATION CHANGE BETWEEN NEAREST SURFACE WATER AND WELL HEAD
1	Dry creek > John Day River	415 +/- To Dry creek	2894' +/-
2	John Day River > Columbia River Dry Creek > John Day River	56 +/-	2835' +/-

Please provide any information for your existing or proposed well(s) that you believe may be helpful in evaluating your application. For existing wells, describe any previous alteration(s) or repair(s) not documented in the attached well log or other materials (*attach additional sheets if necessary*).

\_\_\_\_\_

**RECEIVED**  
 FEB 15 2012  
 WATER RESOURCES DEPT  
 SALEM, OREGON

G-7536

**SECTION 3: WELL DEVELOPMENT, CONTINUED**

Source (aquifer), if known: Brown Clay w/ gravel-existing well #2 / Hoping for basalt or other confined aquifer on well #1

Total maximum rate requested: 0.97 cfs +/- (each well will be evaluated at the maximum rate unless you indicate well-specific rates and annual volumes in the table below).

Complete the table below. If this is an existing well, the following information may be found on the applicable well log. *(If a well log is available, please submit it in addition to completing the table.)* If this is a proposed well, or well-modification, consider consulting with a licensed well driller, geologist, or certified water right examiner.

G-17526

OWNER'S WELL NAME OR NO.	PROPOSED	EXISTING	WELL ID (WELL TAG) NO.* OR WELL LOG ID**	FLOWING ARTESIAN	CASING DIAMETER	CASING INTERVALS (IN FEET)	PERFORATED OR SCREENED INTERVALS (IN FEET)	SEAL INTERVALS (IN FEET)	MOST RECENT STATIC WATER LEVEL & DATE (IN FEET)	PROPOSED USE			
										SOURCE AQUIFER***	TOTAL WELL DEPTH	WELL-SPECIFIC RATE (GPM)	ANNUAL VOLUME (ACRE-FEET)
#2	<input type="checkbox"/>	<input checked="" type="checkbox"/>	8535	<input type="checkbox"/>	6"	135	0	135	65	Brown Clay w/ Gravel	154	50	233.7 AF +/-
#1	<input checked="" type="checkbox"/>	<input type="checkbox"/>		<input type="checkbox"/>	Proposed 6" or 8"	300 ft +/-	As Needed	As Needed	Unknown	Looking for basalt or other confined aquifer	300 ft +/- as needed	387 gpm +/-	233.7 AF +/-
	<input type="checkbox"/>	<input type="checkbox"/>		<input type="checkbox"/>									
	<input type="checkbox"/>	<input type="checkbox"/>		<input type="checkbox"/>									
	<input type="checkbox"/>	<input type="checkbox"/>		<input type="checkbox"/>									
	<input type="checkbox"/>	<input type="checkbox"/>		<input type="checkbox"/>									
	<input type="checkbox"/>	<input type="checkbox"/>		<input type="checkbox"/>									
	<input type="checkbox"/>	<input type="checkbox"/>		<input type="checkbox"/>									

**RECEIVED**  
 FEB 15 2012  
 WATER RESOURCES DEPT  
 SALEM, OREGON

\* Licensed drillers are required to attach a Department-supplied Well Tag, with a unique Well ID or Well Tag Number to all new or newly altered wells. Landowners can request a Well ID for existing wells that do not have one. The Well ID is intended to serve as a unique identification number for each well.  
 \*\* A well log ID (e.g. MARI 1234) is assigned by the Department to each log in the agency's well log database. A separate well log is required for each subsequent alteration of the well.

\*\*\* Source aquifer examples: Troutdale Formation, gravel and sand, alluvium, basalt, bedrock, etc.

**RECEIVED**

FEB 15 2012

WATER RESOURCES DEPT  
SALEM, OREGON

G-17536



If you would like to store ground water in a reservoir, complete this section (*if more than one reservoir, reproduce this section for each reservoir*).

Reservoir name: \_\_\_\_\_ Acreage inundated by reservoir: \_\_\_\_\_

Use(s): \_\_\_\_\_

Volume of Reservoir (acre-feet): \_\_\_\_\_ Dam height (feet, if excavated, write "zero"): \_\_\_\_\_

*Note: If the dam height is greater than or equal to 10.0' above land surface AND the reservoir will store 9.2 acre feet or more, engineered plans and specifications must be approved prior to storage of water.*

**SECTION 7: USE OF STORED GROUND WATER FROM THE RESERVOIR**

If you would like to use stored ground water from the reservoir, complete this section (*if more than one reservoir, reproduce this section for each reservoir*).

Annual volume (acre-feet): \_\_\_\_\_

USE OF STORED GROUND WATER	PERIOD OF USE

**SECTION 8: PROJECT SCHEDULE**

Date construction will begin: as soon as permit is issued – proposed spring 2013

Date construction will be completed: proposed fall 2018

Date beneficial water use will begin: proposed fall 2018

**RECEIVED**  
 FEB 15 2012  
 WATER RESOURCES DEPT  
 SALEM, OREGON

**SECTION 9: WITHIN A DISTRICT**

Check here if the point of diversion or place of use are located within or served by an irrigation or other water district.

Irrigation District Name	Address	
City	State	Zip

**SECTION 10: REMARKS**

Use this space to clarify any information you have provided in the application (*attach additional sheets if necessary*).

G-17536

WRD's water rights process and provide additional comment opportunities. You will have 30 days from the date of the notice to complete the land-use form and return it to the WRD. If no land-use information is received from you within that 30-day period, the WRD may presume the land use associated with the proposed water right is compatible with your comprehensive plan. Your attention to this request for information is greatly appreciated by the Water Resources Department. If you have any questions concerning this form, please contact the WRD's Customer Service Group at 503-986-0801.

**RECEIVED**

FEB 15 2012

WATER RESOURCES DEPT  
SALEM, OREGON

G-7536

# Land Use

# Information Form



**Oregon Water Resources Department**  
 725 Summer Street NE, Suite A  
 Salem, Oregon 97301-1266  
 (503) 986-0900  
 www.wrd.state.or.us

Applicant: Homer and Jeanette  
First

Harrison  
Last

Mailing Address: P.O. Box 551

Mount Vernon  
City

Oregon  
State

97865  
Zip

Daytime Phone: 541-932-4718

### A. Land and Location

Please include the following information for all tax lots where water will be diverted (taken from its source), conveyed (transported), and/or used or developed. Applicants for municipal use, or irrigation uses within irrigation districts may substitute existing and proposed service-area boundaries for the tax-lot information requested below.

Township	Range	Section	¼ ¼	Tax Lot #	Plan Designation (e.g., Rural Residential/RR-5)	Water to be:			Proposed Land Use:
13 S	29 E	23		2600	EFU	<input checked="" type="checkbox"/> Diverted	<input checked="" type="checkbox"/> Conveyed	<input checked="" type="checkbox"/> Used	
13 S	29 E	26		2600	EFU	<input type="checkbox"/> Diverted	<input checked="" type="checkbox"/> Conveyed	<input checked="" type="checkbox"/> Used	
						<input type="checkbox"/> Diverted	<input type="checkbox"/> Conveyed	<input type="checkbox"/> Used	
						<input type="checkbox"/> Diverted	<input type="checkbox"/> Conveyed	<input type="checkbox"/> Used	

List all counties and cities where water is proposed to be diverted, conveyed, and/or used or developed:

Grant County, Oregon	<div style="border: 2px solid black; padding: 5px; font-weight: bold; font-size: 1.2em;">RECEIVED</div> <div style="font-weight: bold; font-size: 1.1em;">FEB 15 2012</div>
----------------------	---

### B. Description of Proposed Use

**WATER RESOURCES DEPT  
 SALEM, OREGON**

Type of application to be filed with the Water Resources Department:

- Permit to Use or Store Water   
  Water Right Transfer   
  Permit Amendment or Ground Water Registration Modification  
 Limited Water Use License   
  Allocation of Conserved Water   
  Exchange of Water

Source of water:  Reservoir/Pond   
 Ground Water   
 Surface Water (name) \_\_\_\_\_

Estimated quantity of water needed: 437   
 cubic feet per second   
 gallons per minute   
 acre-feet

Intended use of water:  Irrigation   
 Commercial   
 Industrial   
 Domestic for \_\_\_\_\_ household(s)  
 Municipal   
 Quasi-Municipal   
 Instream   
 Other \_\_\_\_\_

Briefly describe:

A permit for irrigation from ground water to irrigate a commercial garden and supplemental irrigation of hay and alfalfa and other crops.

**Note to applicant:** If the Land Use Information Form cannot be completed while you wait, please have a local government representative sign the receipt at the bottom of the next page and include it with the application filed with the Water Resources Department.

677536



Harrison  
13-29 + L 2600

## For Local Government Use Only

The following section must be completed by a planning official from each county and city listed unless the project will be located entirely within the city limits. In that case, only the city planning agency must complete this form. This deals only with the local land-use plan. Do not include approval for activities such as building or grading permits.

### Please check the appropriate box below and provide the requested information

- Land uses to be served by the proposed water uses (including proposed construction) are allowed outright or are not regulated by your comprehensive plan. Cite applicable ordinance section(s): Article 14 Grant Co Land Use Code
- Land uses to be served by the proposed water uses (including proposed construction) involve discretionary land-use approvals as listed in the table below. (Please attach documentation of applicable land-use approvals which have already been obtained. Record of Action/land-use decision and accompanying findings are sufficient.) **If approvals have been obtained but all appeal periods have not ended, check "Being pursued."**

Type of Land-Use Approval Needed (e.g., plan amendments, rezones, conditional-use permits, etc.)	Cite Most Significant, Applicable Plan Policies & Ordinance Section References	Land-Use Approval:	
		<input type="checkbox"/> Obtained <input type="checkbox"/> Denied	<input type="checkbox"/> Being Pursued <input type="checkbox"/> Not Being Pursued
		<input type="checkbox"/> Obtained <input type="checkbox"/> Denied	<input type="checkbox"/> Being Pursued <input type="checkbox"/> Not Being Pursued
	<b>RECEIVED</b>	<input type="checkbox"/> Obtained <input type="checkbox"/> Denied	<input type="checkbox"/> Being Pursued <input type="checkbox"/> Not Being Pursued
	FEB 15 2012	<input type="checkbox"/> Obtained <input type="checkbox"/> Denied	<input type="checkbox"/> Being Pursued <input type="checkbox"/> Not Being Pursued
	WATER RESOURCES DEPT SALEM, OREGON	<input type="checkbox"/> Obtained <input type="checkbox"/> Denied	<input type="checkbox"/> Being Pursued <input type="checkbox"/> Not Being Pursued

Local governments are invited to express special land-use concerns or make recommendations to the Water Resources Department regarding this proposed use of water below, or on a separate sheet.

Irrigation is allowed outright use  
in the EFU zone.

Name: \_\_\_\_\_ Title: Shannon Springer Assistant Planner

Signature: Shannon Springer Phone: \_\_\_\_\_ Date: 2/13/12

Government Entity: Grant County Planning 541-575-1519

**Note to local government representative:** Please complete this form or sign the receipt below and return it to the applicant. If you sign the receipt, you will have 30 days from the Water Resources Department's notice date to return the completed Land Use Information Form or WRD may presume the land use associated with the proposed use of water is compatible with local comprehensive plans.

### Receipt for Request for Land Use Information

Applicant name: \_\_\_\_\_

City or County: \_\_\_\_\_ Staff contact: \_\_\_\_\_

Signature: \_\_\_\_\_ Phone: \_\_\_\_\_ Date: \_\_\_\_\_

G-17536



## EXHIBIT A

Land in Grant County, Oregon, as follows:

In Twp. 13 S., R. 29 E., W.M.:

Sec. 23: SE $\frac{1}{4}$ .

Sec. 26: E $\frac{1}{2}$ , SAVE & EXCEPT the following:

(a) That portion conveyed to Grant County, Oregon, by Deed dated July 12, 1923, recorded Feb. 2, 1925 in Book 35, Page 570, Deed Records of Grant County, Oregon, for highway right of way.

(b) That portion conveyed to the State of Oregon, by and through its State Highway Commission, by Deeds dated July 30, 1953, recorded Aug. 5, 1953 in Book 68, Page 263, Deed Records of Grant County, Oregon; dated Feb. 25, 1954, recorded March 4, 1954 in Book 69, Page 486, said Deed Records, for highway right of way.

TOGETHER WITH an easement for two irrigation ditches for the purpose of transportation of water, described as follows:

Commencing at a common diversion point on Dry Creek, situated 660 feet South and 495 feet West from the center of Sec. 23, Twp. 13 S., R. 29 E., W.M.; and from which point one irrigation ditch bears Southeasterly approximately 360 feet; and from which point one ditch bears Easterly approximately 675 feet.

Provided: That said ditches shall not be used to abridge or in any manner curtail the existing rights of the grantors herein, to the use of the waters of and from said Dry Creek; that grantee may at all reasonable times go upon the lands of the grantors for the purpose of maintaining said ditches; that grantee shall be responsible for the containment of waters within said ditches, and shall be liable for any damage sustained by the grantors, as the direct or indirect result of any escapement of waters from said ditches.

## SUBJECT TO AND EXCEPTING:

1. Water and Ditch Agreement between Blue Mountain Ditch Company, a private corp., and George Clark, et al, dated Oct. 20, 1916, recorded Jan. 27, 1921 in Book E, page 60, Leases & Agreement Records.
2. Agreement between Tennie Carsner and W. A. Pope, dated April 2, 1925, recorded April 3, 1925 in Book 36, page 4, Deeds, granting a right of way over and across the N $\frac{1}{2}$ NE $\frac{1}{4}$  of Sec. 26, Twp. 13 S., R. 29 E., W.M., for the extension of an irrigation ditch.
3. Private right of way and tree trimming permit to the West Coast Power Co., a Delaware corp., dated Aug. 10, 1936, recorded Aug. 11, 1936 in Book 41, page 307, Deeds, for electric power line.
4. Mineral rights owned by Sanford Lowengart, Jr., on 20 acres of the described property LESS the NE $\frac{1}{4}$ SE $\frac{1}{4}$ NE $\frac{1}{4}$ , SE $\frac{1}{4}$ NE $\frac{1}{4}$ NE $\frac{1}{4}$  of Sec. 26, Twp. 13 S., R. 29 E., W.M., as shown by instruments of record dated Dec. 16, 1938, recorded Jan. 16, 1939 in Book 43, page 108 and

87673

121-1151

MICROFILM

re-recorded March 13, 1944 in Book 46, page 479; dated Feb. 21, 1949, recorded March 26, 1949 in Book 56, page 498; dated Feb. 8, 1950, recorded Feb. 14, 1950 in Book 59, page 217; dated June 10, 1954, recorded June 25, 1954 in Book 70, page 304; dated Nov. 30, 1954, recorded Dec. 23, 1954 in Book 71, page 385; dated Sept. 20, 1955, recorded March 16, 1967 in Book 96, page 332; dated Sept. 12, 1961, recorded Nov. 29, 1961, in Book 86, page 90; and dated July 21, 1978, recorded July 31, 1978, in Book 119, page 479, Deeds, Grant County, Oregon.

5. Access Restrictions and burdens imposed, with certain limited access granted, in Deeds to the State of Oregon, by and through its State Highway Commission, dated July 30, 1953, recorded Aug. 5, 1953 in Book 68, page 266, Deeds; dated Feb. 25, 1954, recorded **March 4, 1954**, in Book 69, page 486, Deeds; TOGETHER with those **certain INDENTURE OF ACCESS, dated Aug. 9, 1954**, recorded Aug. 18, 1954 in Book 70, page 497, Deeds; dated Aug. 10, 1955, recorded Oct. 11, 1955 in Book 73, page 178, Deeds.

6. Right of way Easement to California-Pacific Utilities Company, a corp., dated Oct. 19, 1960, recorded Oct. 19, 1960 in Book 83, page 649, Deeds, for electric power lines.

7. Right of way Easement to Oregon Telephone Corporation, an Oregon corp., dated July 20, 1973, recorded April 12, 1974 in Book 111, page 329, Deeds, for a telephone line or system.

8. The property described has been zoned and classified for farm use and at any time it is disqualified for such use, the property will be subject to additional taxes or penalties and interest, which Grantees agree to pay.

9. The right of way of the County Road across the SE 1/4 of Sec. 23, Twp. 13 S., R. 29 E., W.M.

10. Mortgage from Perry E. Jones and Carrie A. Jones, husband and wife, to the State of Oregon, represented and acting by the Director of Veterans' Affairs, dated July 21, 1978, recorded July 21, 1978, in Book 48, page 227, Mortgages, which Grantees assume and agree to pay.

RECEIVED  
FEB 15 2012  
WATER RESOURCES DEPT  
SALEM OREGON

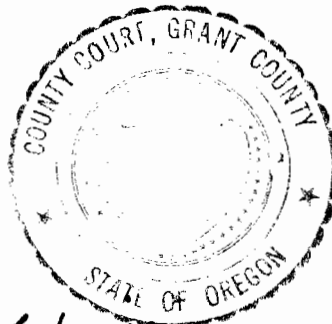

Return to: Mr. & Mrs. Homer L. Hansen  
STAR ROUTE WEST  
Mt. Vernon, Or 97865

State of OREGON }  
County of Grant } ss.  
I hereby certify that the within instrument  
was filed in my office on this 2nd  
day of August 1979 at 3:32  
o'clock P.M., and is duly recorded in Book 121  
of Deeds at pages 57 to 459 inclusive.

Witness my hand and official seal  
John Liveira, County Clerk  
By Paralel Veiga Deputy  
Date 10 50

INDEXED

STATE OF OREGON  
COUNTY OF GRANT  
CERTIFICATE OF WATER RIGHT

THIS CERTIFICATE ISSUED TO

HOMER HARRISON  
ROUTE 1, BOX 130  
MT. VERNON, OREGON 97865

confirms the right to use the waters of JOHN DAY RIVER, a tributary of COLUMBIA RIVER, for the purpose of IRRIGATING 38.5 ACRES.

This right has been perfected under Permit 47357. The date of priority is OCTOBER 8, 1981. The right is limited to 0.96 CUBIC FOOT PER SECOND or its equivalent in case of rotation, measured at the point of diversion from the source.

The point of diversion is located as follows:

NE 1/4 NE 1/4, SECTION 26, T 13 S, R 29 E, W.M.; 760 FEET SOUTH AND 1290 FEET WEST FROM NE CORNER SECTION 26.

The amount of water used for irrigation, together with the amount secured under any other right existing for the same lands, shall be limited to ONE-FORTIETH of one cubic foot per second per acre, or its equivalent for each acre irrigated and shall be further limited to a diversion of not to exceed 5.0 acre-feet per acre for each acre irrigated during the irrigation season of each year.

The right shall conform to such reasonable rotation system as may be ordered by the proper state officer.

A description of the place of use under the right, and to which such right is appurtenant, is as follows:

NE 1/4 SE 1/4	4.2 ACRES
SW 1/4 SE 1/4	5.6 ACRES
SE 1/4 SE 1/4	10.5 ACRES
SECTION 23	

NE 1/4 NE 1/4	3.5 ACRES
NW 1/4 NE 1/4	14.7 ACRES
SECTION 26	

TOWNSHIP 13 SOUTH, RANGE 29 EAST, W.M.

**RECEIVED**

FEB 15 2012

WATER RESOURCES DEPT  
SALEM, OREGON

This right to the use of the water for the above purpose is restricted to beneficial use on the lands or place of use described. The right is subject to minimum flows established by the Water Resources Commission with an effective date prior to this right.

WITNESS the signature of the Water Resources Director, affixed FEBRUARY 12, 1991.

/s/ WILLIAM H. YOUNG

William H. Young

Recorded in State Record of Water Right Certificates numbered 65216.

62956.BWB

G1-7536

5-178

STATE OF OREGON  
COUNTY OF GRANT  
CERTIFICATE OF WATER RIGHT

THIS CERTIFICATE ISSUED TO

HOMER L. AND JEANETTE E. HARRISON  
ROUTE 1, BOX 130  
MT. VERNON, OREGON 97865

confirms the right to use the waters of JOHN DAY RIVER, a tributary of COLUMBIA RIVER, for the purpose of IRRIGATING 65.0 ACRES.

This right has been perfected under Permit 41655. The date of priority is MARCH 30, 1977. The right is limited to 1.28 CUBIC FEET PER SECOND or its equivalent in case of rotation, measured at the point of diversion from the source.

The point of diversion is located as follows:

NE 1/4 NE 1/4, SECTION 26, T 13 S, R 29 E, W.M.; 760 FEET SOUTH AND 1290 FEET WEST FROM NE CORNER SECTION 26.

The amount of water used for irrigation, together with the amount secured under any other right existing for the same lands, shall be limited to ONE-FORTIETH of one cubic foot per second per acre, or its equivalent for each acre irrigated and shall be further limited to a diversion of not to exceed 5.0 acre-feet per acre for each acre irrigated during the irrigation season of each year.

This right shall conform to such reasonable rotation system as may be ordered by the proper state officer.

A description of the place of use under the right, and to which such right is appurtenant, is as follows:

NE 1/4 SE 1/4	2.0 ACRES
NW 1/4 SE 1/4	3.0 ACRES
SW 1/4 SE 1/4	32.6 ACRES
SE 1/4 SE 1/4	17.8 ACRES
SECTION 23	

NW 1/4 NE 1/4	9.6 ACRES
SECTION 26	
TOWNSHIP 13 SOUTH, RANGE 29 EAST, W.M.	

RECEIVED

FEB 15 2012

WATER RESOURCES DEPT  
SALEM, OREGON

This right to the use of the water for the above purpose is restricted to beneficial use on the lands or place of use described. The right is subject to minimum flows established by the Water Resources Commission with an effective date prior to this right.

WITNESS the signature of the Water Resources Director, affixed FEBRUARY 12, 1991.

/s/ WILLIAM H. YOUNG

William H. Young

Recorded in State Record of Water Right Certificates numbered 65198.

55580.BWB

G77536

T.13S., R. 29E., W.M.

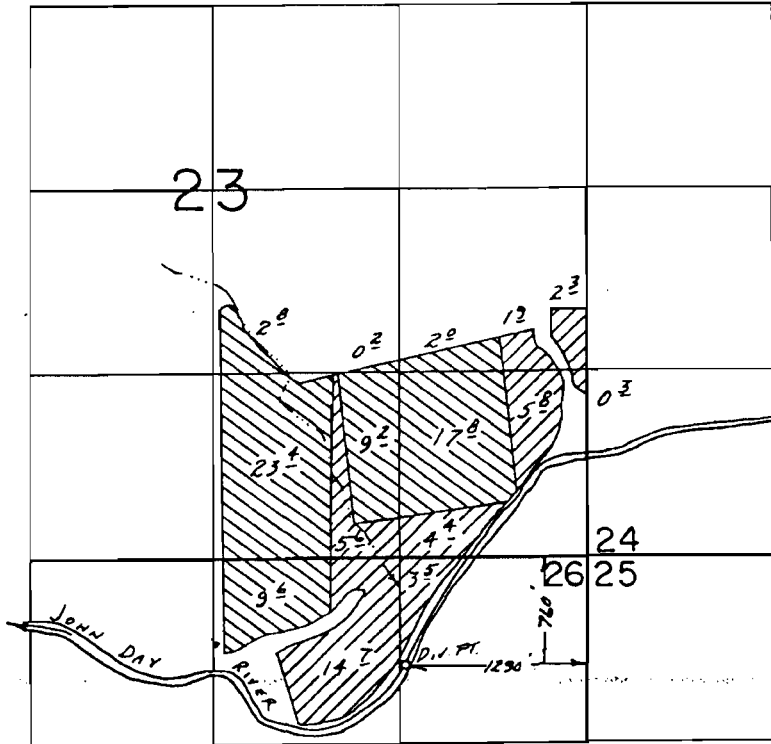

SCALE: 1" = 1320'

**FINAL PROOF SURVEY**  
UNDER

55580                      41655

Application No. 62956... Permit No. 47357.....

IN NAME OF



HOMER L. & JEANETTE E. HARRISON

Surveyed June 20, 1988, by V.L. CHURCH.....

**RECEIVED**

FEB 15 2012

WATER RESOURCES DEPT  
SALEM, OREGON

GI-17536

4/13/89 JWB  
41023-179-235R

# Minimum Requirements Checklist

Minimum Requirements (OAR 690-310-0040, OAR 690-310-0050 & ORS 537.615)

## Include this checklist with the application

Check that each of the following items is included. The application will be returned if all required items are not included. If you have questions, please call the Water Rights Customer Service Group at (503) 986-0900.

- SECTION 1: applicant information and signature
- SECTION 2: property ownership
- SECTION 3: well development
- SECTION 4: water use
- SECTION 5: water management
- SECTION 6: storage of groundwater in a reservoir
- SECTION 7: use of stored groundwater from the reservoir
- SECTION 8: project schedule
- SECTION 9: within a district
- SECTION 10: remarks) - NONE

*Eric W. Julsrud*  
*Watermaster Dist. 4*  
*2/13/2012*

**RECEIVED**

FEB 15 2012

WATER RESOURCES DEPT  
SALEM, OREGON

### Attachments:

- Land Use Information Form with approval and signature (*must be an original*) or signed receipt
- Provide the legal description of: (1) the property from which the water is to be diverted, (2) any property crossed by the proposed ditch, canal or other work, and (3) any property on which the water is to be used as depicted on the map. Example: A copy of the deed, land sales contract or title insurance policy.
- Fees - Amount enclosed: \$ 1500<sup>00</sup> + 400<sup>00</sup> / etc.  
See the Department's Fee Schedule at [www.oregon.gov/owrd](http://www.oregon.gov/owrd) or call (503) 986-0900.

### Provide a map and check that each of the following items is included:

- Permanent quality and drawn in ink
- Even map scale not less than 4" = 1 mile (example: 1" = 400 ft, 1" = 1320 ft, etc.)
- North Directional Symbol
- Township, Range, Section, Quarter/Quarter, Tax Lots
- Reference corner on map
- Location of each well, and/or dam if applicable, by reference to a recognized public land survey corner (distances north/south and east/west). Each well must be identified by a unique name and/or number.
- Indicate the area of use by Quarter/Quarter and tax lot clearly identified
- Number of acres per Quarter/Quarter and hatching to indicate area of use if for primary irrigation, supplemental irrigation, or nursery
- Location of main canals, ditches, pipelines or flumes (if well is outside of the area of use)
- Other \_\_\_\_\_

G-17536



Existing well #2 is in place as arc lines and sprinklers to utilize water from the existing well. We are proposing to construct a second well to irrigate a total of approximately 67.2 acres of land from either proposed well #1 and/or existing well #2. We are proposing to irrigate a commercial garden, alfalfa, grass hay, grain crops and other cover crops rotating crops as needed to build soil and conserve water. Planned irrigation methods include: drip, overhead sprinklers, rainbird type impact sprinklers and other methods as needed to suit the type of crop.

Dry creek flow-dry creek on this property only runs after a snow melt/or spring rains. It only runs for a short period of time, generally the end of July or 1<sup>st</sup> of August. There have been some years when it has not run at all.

## Land Use Information Form

RECEIVED

FEB 15 2012

WATER RESOURCES DEPT  
SALEM, OREGON



Oregon Water Resources Department  
725 Summer Street NE, Suite A  
Salem, Oregon 97301-1266  
(503) 986-0900  
www.wrd.state.or.us

### NOTE TO APPLICANTS

In order for your application to be processed by the Water Resources Department (WRD), this Land Use Information Form must be completed by a local government planning official in the jurisdiction(s) where your water right will be used and developed. The planning official may choose to complete the form while you wait, or return the receipt stub to you. Applications received by WRD without the Land Use Form or the receipt stub will be returned to you. Please be aware that your application will not be approved without land use approval.

**This form is NOT required if:**

- 1) Water is to be diverted, conveyed, and/or used only on federal lands; **OR**
- 2) The application is for a water right transfer, allocation of conserved water, exchange, permit amendment, or ground water registration modification, and **all** of the following apply:
  - a) The existing and proposed water use is located entirely within lands zoned for exclusive farm-use or within an irrigation district;
  - b) The application involves a change in place of use only;
  - c) The change does not involve the placement or modification of structures, including but not limited to water diversion, impoundment, distribution facilities, water wells and well houses; **and**
  - d) The application involves irrigation water uses only.

### NOTE TO LOCAL GOVERNMENTS

The person presenting the attached Land Use Information Form is applying for or modifying a water right. The Water Resources Department (WRD) requires its applicants to obtain land-use information to be sure the water rights do not result in land uses that are incompatible with your comprehensive plan. Please complete the form or detach the receipt stub and return it to the applicant for inclusion in their water right application. You will receive notice once the applicant formally submits his or her request to the WRD. The notice will give more information about

G-7536

**ATTENTION:**

Dear Customer Service Group,

The Staff off the Watermaster's Office in District 4 has assisted with the preparation of this application or map.

If there are any questions or problems with this application ~~or map~~ please contact the following staff person Eric Johnson at 541-575-0119 for additional information.

Thank you for your assistance,

Sincerely,

 Date: 2/13/2012

Watermaster Office, District 4  
201 South Humbolt St., Ste 180  
Canyon City, Or 97820  
Voice: 541-575-0119  
Fax: 541-575-0641

**RECEIVED**

FEB 15 2012

WATER RESOURCES DEPT  
SALEM, OREGON