

T.4S., R.2E., W.M.

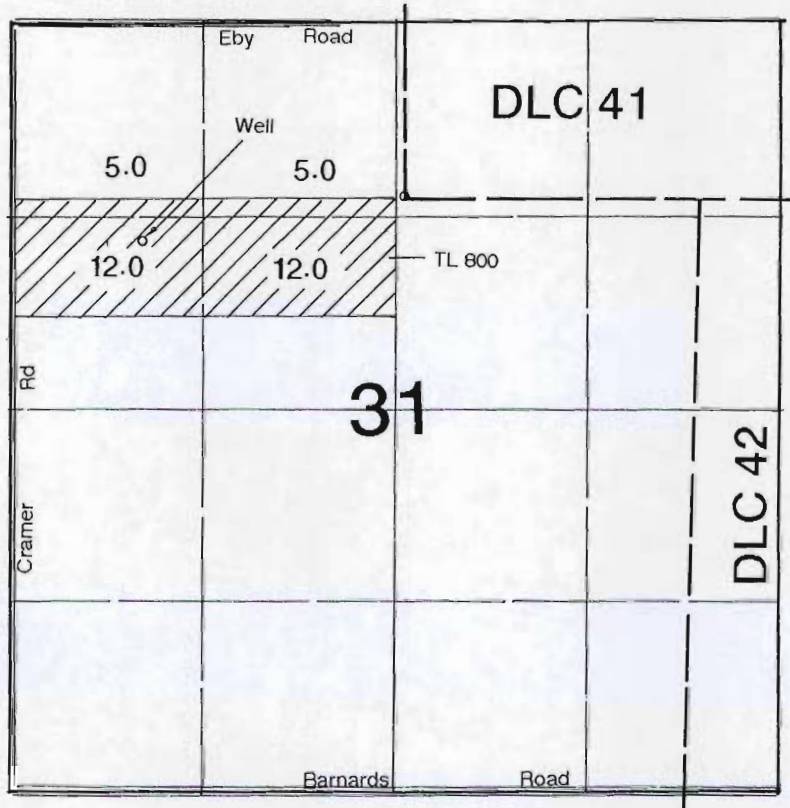

Well is located 280' S & 1770' W from the SW corner of DLC 41.

RECEIVED

APR 13 2012

WATER RESOURCES DEPT
SALEM, OREGON

Application Map

Marlys Parr

Application #: G-17550

Permit #: G-

This Map was Prepared for the Purpose of Identifying the Location of a Water Right Only and is Not Intended to Provide Legal Dimensions or Location of Property Ownership Lines.

G-17550

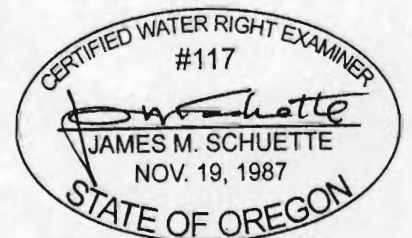

EXPIRES: 6/30/2012

