

CLAIM OF BENEFICIAL USE

MAP G-13362

Located in Sections 3, 4, 8, 9, 17, 18, and 20,
Township 14 South, Range 12 East, Willamette Meridian
Deschutes County, Oregon

NOTES

1. This map was prepared for the purpose of identifying the location of water rights only and is not intended to provide legal dimensions or locations of property ownership lines.
2. This map is based on Final Proof Map submitted with the COBU prepared by Anderson Engineering, Sept. 14, 2001.
3. Tax lot lines are based on Deschutes County Assessor Maps dated Feb. 2, 2010.
4. Authorized Points of Appropriation under Permit G-13362 are Wells #1, #3, #4, and #7.
5. Acres irrigated are identified in each 1/4-1/4 by total acres and by Tax Lot.

COBU MAP # 680

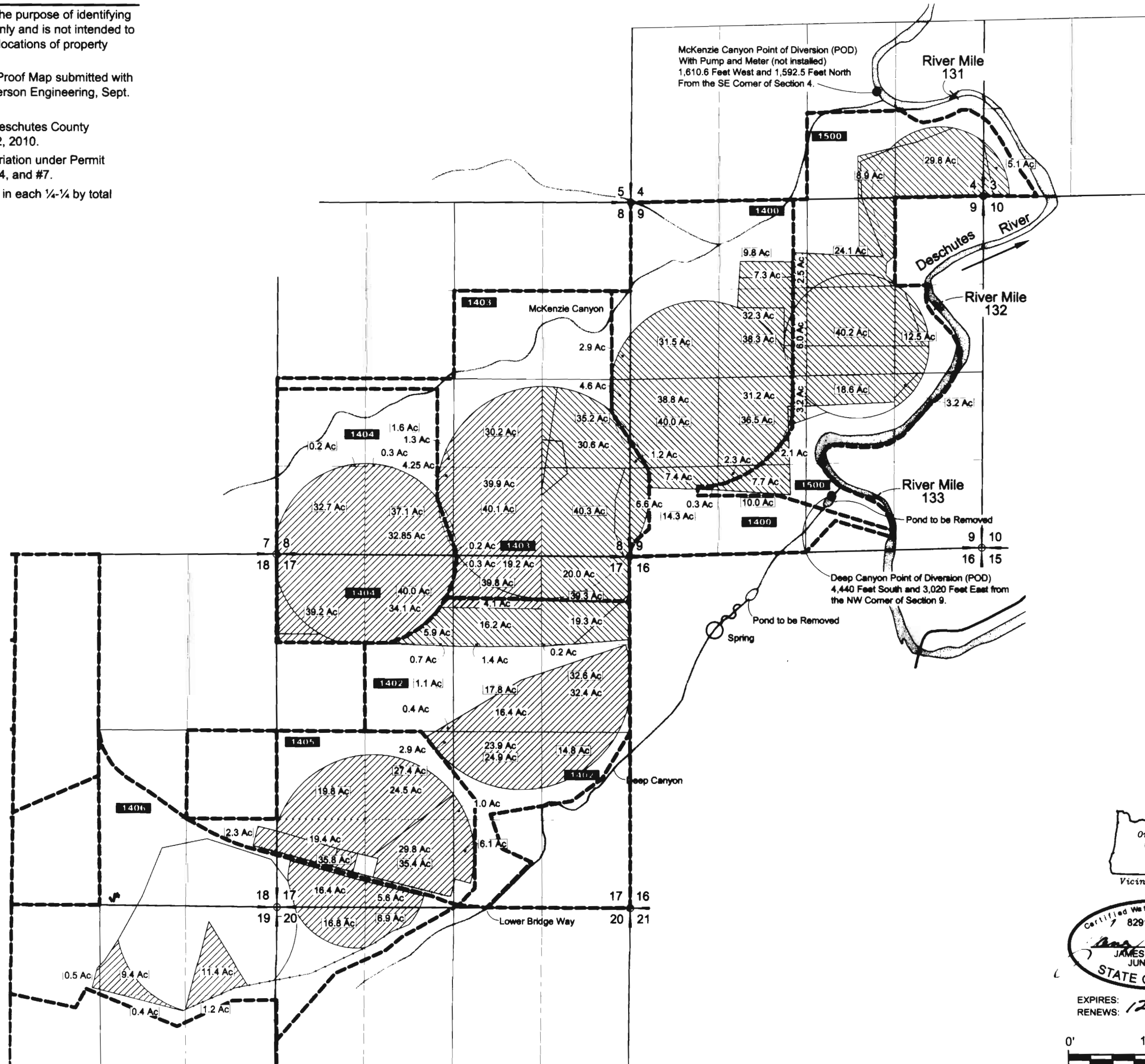

LEGEND

- Primary Certificate G-13362
(501.1 Ac Total)
- Supplemental Certificate G-13362
(464.9 Ac Total)
- Tax Lot Boundary Line
- Tax Lot ID Number
- Total Number of Acres Irrigated
in 1/4-1/4

RECEIVED

APR 26 2012

WATER RESOURCES DEPT
SALES CENTER

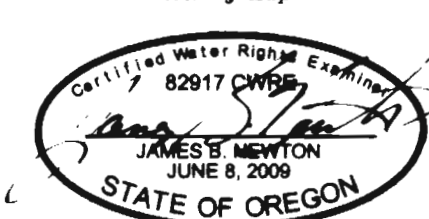

EXPIRES: 12-31-2012
RENEWS:

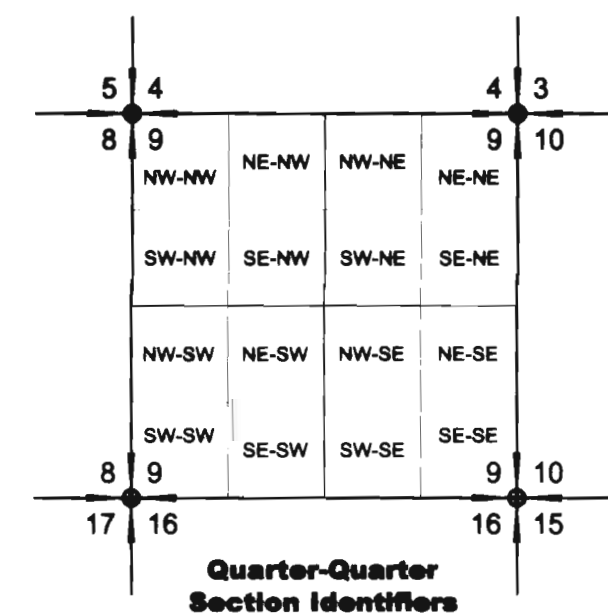
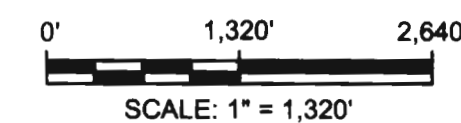

NO.	DATE	BY	REVISIONS
PATH: G:\0500\556\102\Cad\Water\W556102_F2_COBU_G13362 13:32 04/24/2012 SS			

NEWTON
CONSULTANTS INC.
Earth, Water and Rock Specialists
Ph: 541 504-9960 Fax: 541 504-9961



Claim of Beneficial Use Map for G-13362
Big Falls Ranch Co.
Deschutes County, Oregon

PROJECT NO:	556-102	DATE:	APRIL 2012	FIGURE	2
DESIGNED BY:	J. Newton	DRAWN BY:	S. Schenck		