

# Application Map for Nancy Kidder-West

**SEC. 16 T. 26S. R. 4W. W.M.**  
**Douglas County**  
**Scale 1" = 400'**

RECEIVED BY OWRD

JUL 23 2012

SALEM, OR

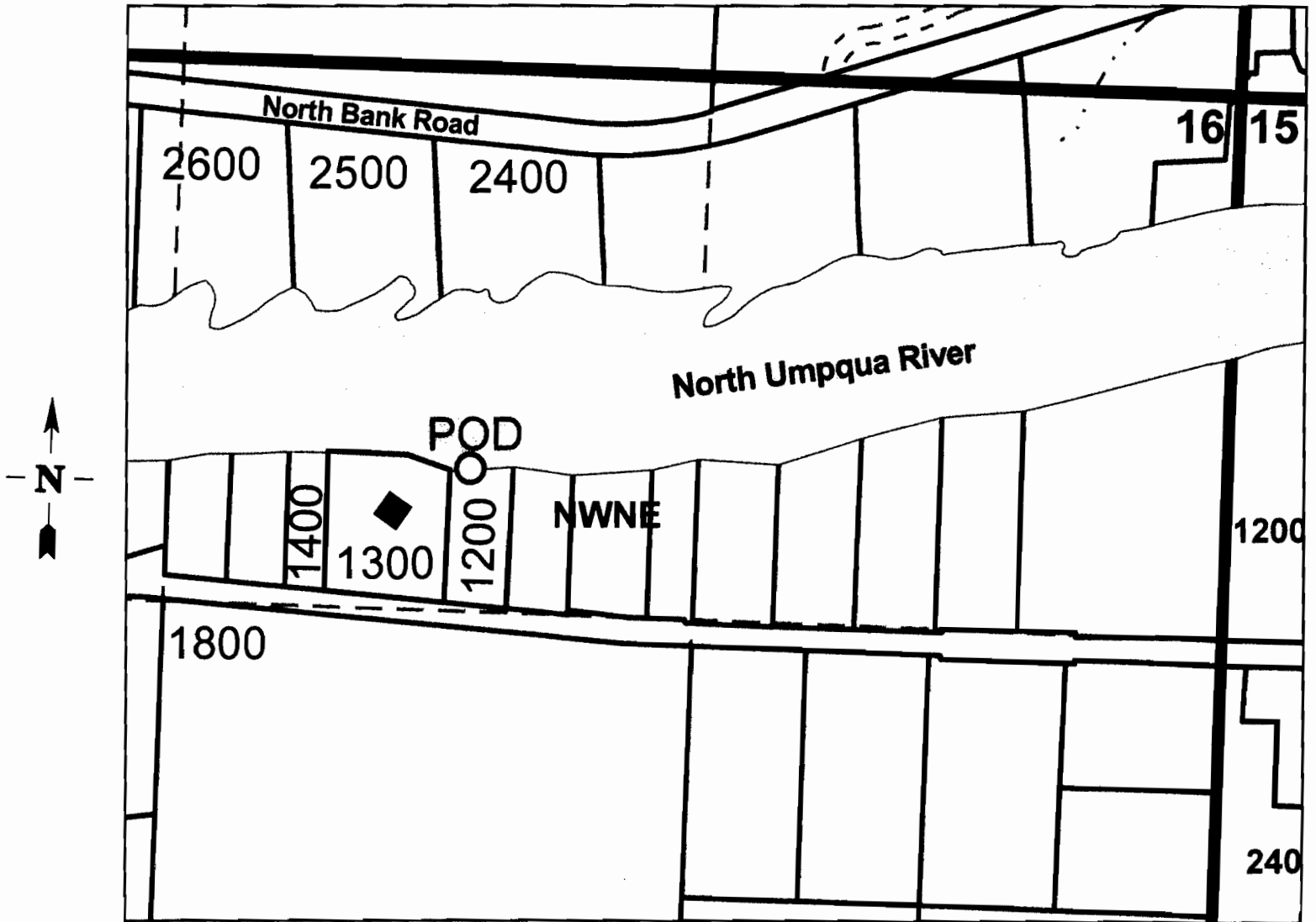

**POD is 940 ft. south and 1875 ft. West from the  
Northeast Quarter Corner of Section 16.**

RECEIVED BY OWRD

AUG 16 2012

SALEM, OR

S-87931