

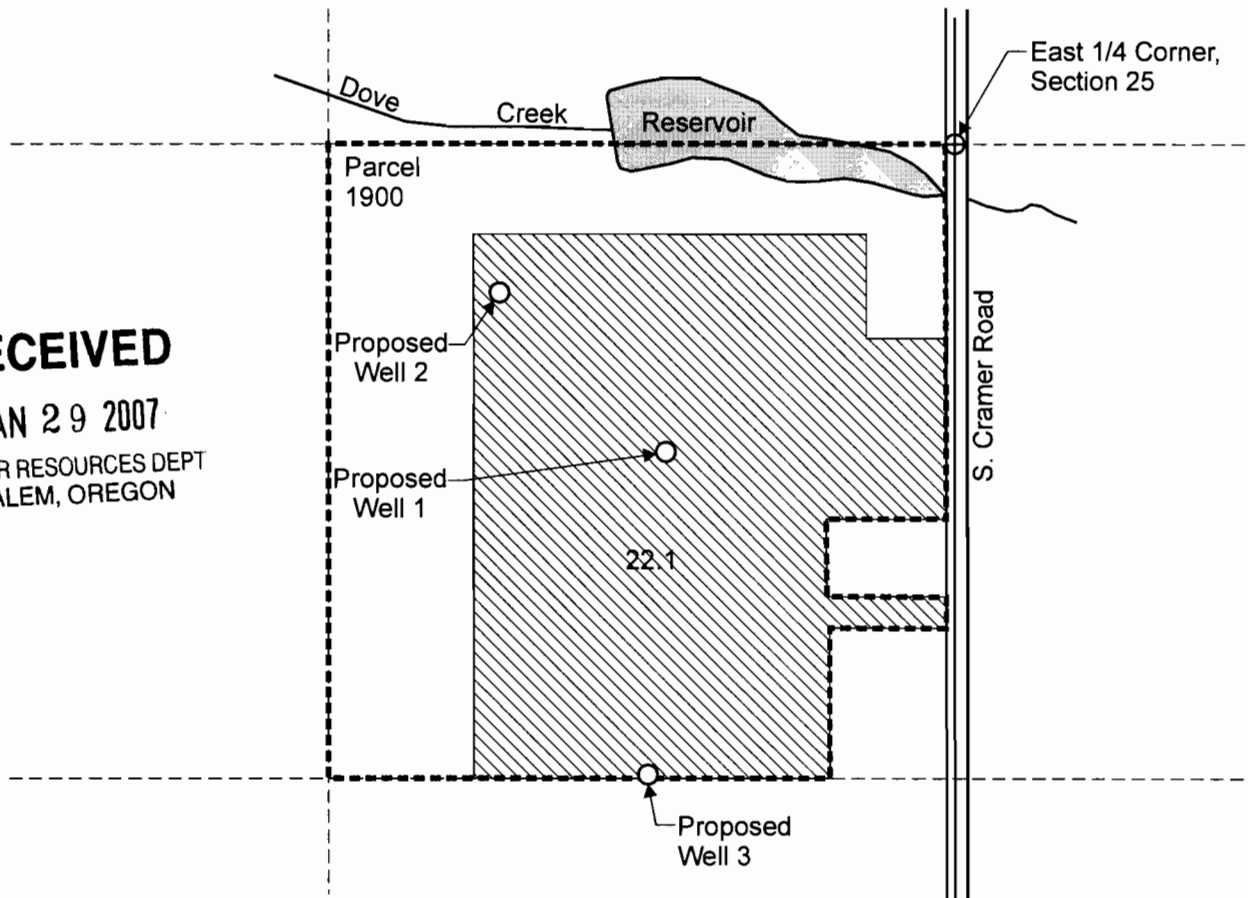

# T.4S. R.1E. Section 25, W.M.

**RECEIVED**

JAN 29 2007  
 WATER RESOURCES DEPT  
 SALEM, OREGON



Proposed Well 1 is located 640 feet south and 600 feet west from the E 1/4 corner, Section 25.  
 Proposed Well 2 is located 310 feet south and 950 feet west from the E 1/4 corner, Section 25.  
 Proposed Well 3 is located 1,310 feet south and 640 feet west from the E 1/4 corner, Section 25.

 Area (22.1 Acres) to be covered for nursery operations.

----- Tax lot boundary

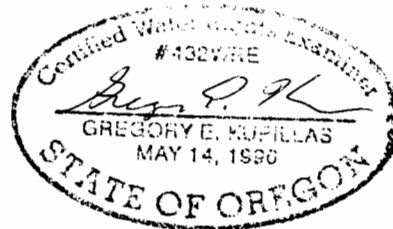

EXPIRATION DATE: 6/30/07

Scale: 1" = 400'

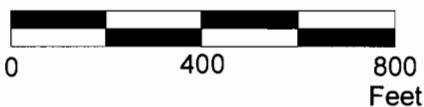

This map was prepared for the purpose of identifying the location of a water right only and is not intended to provide legal dimensions or location of property ownership lines.



## Water Right Application Map

Lawrence and Marjorie Walch  
 Tax Lot 4 1E 25 1900

Pacific Hydro-Geology Inc.

1/2007