

RECEIVED

REVISED

JAN 13 1999

ADJUDICATION CLAIMS MAP

WATER RESOURCES DEPT.
SALEM, OREGON

FOR

RICHARD NICHOLSON, ROGER NICHOLSON AND DOROTHY NICHOLSON TRUST

LOCATED IN THE SW 1/4 SE 1/4, SE 1/4 SW 1/4 SEC. 35, T.33S., R.07 1/2E., W.M.

KLAMATH COUNTY, OREGON

KLAMATH ADJUDICATION

CLAIM # **46** PAGE # **088**

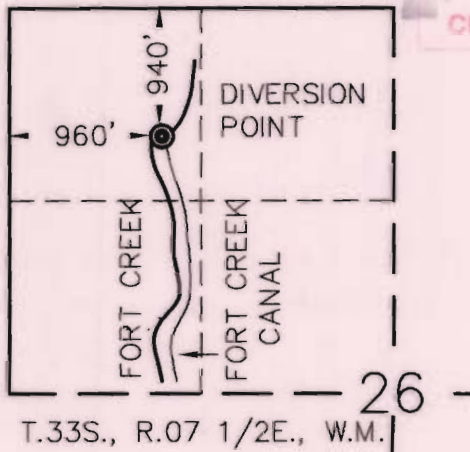

SCALE
1" = 1320'

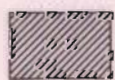
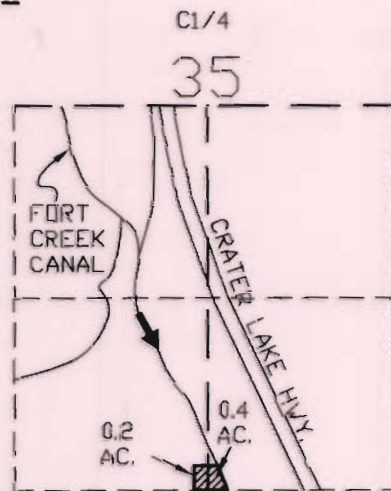
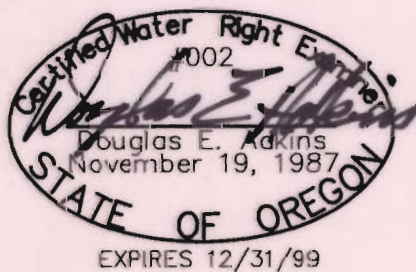

AREA IRRIGATED

THIS MAP IS FOR THE PURPOSE OF IDENTIFYING THE LOCATION OF THE WATER RIGHT ONLY AND HAS NO INTENT TO PROVIDE DIMENSIONS OR LOCATION OF PROPERTY LINES.

ADKINS



Engineers ▲ Planners ▲ Surveyors

2950 Shasta Way • Klamath Falls, Oregon 97603 • (541) 884-4666 • FAX (541) 884-5335

Klamath Falls, OR • Medford, OR • Alturas, CA

June, 1991

JOB No. 1266-02