

ADJUDICATION CLAIMS MAP

RECEIVED
JUN 26
JUN 20 1991

FOR

ROGER NICHOLSON

WATER REG. DIV.
WATER RESOURCES
SALEM, ORE.

DEPT.

LOCATED IN THE SW 1/4 SEC. 2, T.34S., R07 1/2E., W.M.
KLAMATH COUNTY, OREGON

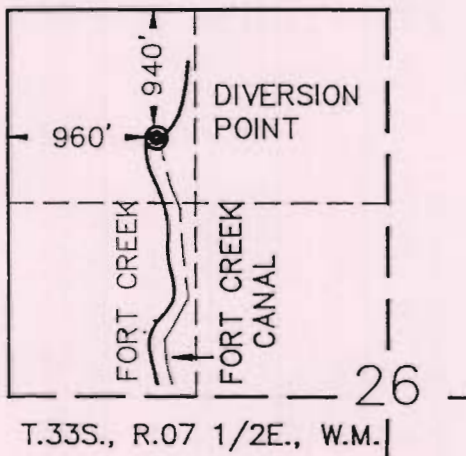

KLAMATH ADJUDICATION
 CLAIM # **63** PAGE # **79**

082



SCALE
1" = 1320'

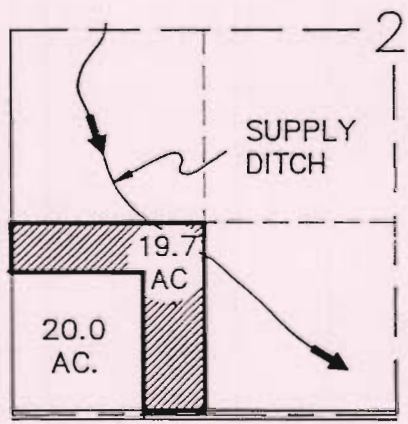

NOTE:

WARRANTY DEED IN VOL. M75
 PAGE 7141 WITHHELD 20.0
 ACRES FROM THE SW 1/4, THIS
 INCLUDED A PORTION OF WEED
 ROAD. THE 19.7 ACRES
 EXCLUDES THE ROAD RIGHT OF
 WAY.

 AREA IRRIGATED
 CERTIFICATES -
 44089 & 35153

THIS MAP IS FOR THE PURPOSE OF
 IDENTIFYING THE LOCATION OF THE
 WATER RIGHT ONLY AND HAS NO
 INTENT TO PROVIDE DIMENSIONS OR
 LOCATION OF PROPERTY LINES.

Certified Water Right Examiner
 #002
Douglas E. Adkins
 Douglas E. Adkins
 November 19, 1987
 STATE OF OREGON

MAP PREPARED BY: ADKINS CONSULTING ENGINEERS INC.
 1453 ESPLANADE AVE.
 KLAMATH FALLS, OREGON 97601
 PHONE: (503) 884-4666

JUNE 1991

JOB NO: 1266-01