

KLAMATH ADJUDICATION

036

T. 40 S.
T. 41 S.

R. 4 E.

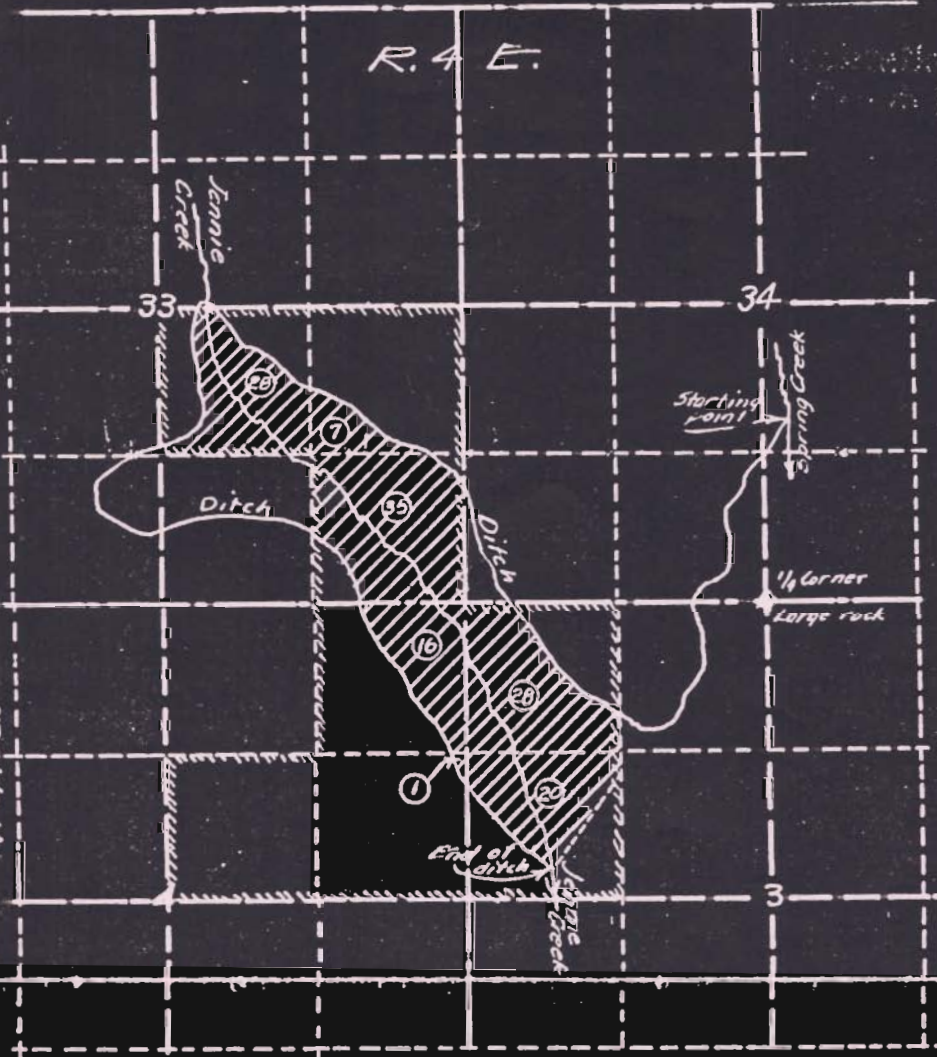

For more
map

CERTIFICATE

I, Frank Z. Howard, civil engineer, do hereby certify that the annexed map was made by me, from notes taken during an actual survey made under my supervision on April 7 and 8, 1951; that the monument shown on this map as "Starting point", is North 1665 feet and east 189 feet from the one quarter corner on the south side of Section 34, T. 40 S., R. 4 E., W. M.



26435

LANDS TO BE IRRIGATED



ACREAGE



Frank Z. Howard

PORTIONS SEC. 33 & 34, T. 40 S., R. 4 E., & OF
SECS. 3 & 4, T. 41 S., R. 4 E., W.M.

WATER RIGHT APPLICATION NO.

" " PERMIT NO.

SURVEYED FOR	ROD FRAIN ESTATE	
SURVEYED BY	B.W. ZOLLMAN	4/10/51
DRAWN BY	FRANK Z. HOWARD	4/21/51
SCALE	1 inch = 20 chains	
APPROVED		

STATE ENGINEER
SALMON DIVISION