

Golden Rule Farms Inc.
PO Box 255
Christmas Valley, OR 97641
(541) 576-2273

October 19, 2012

RECEIVED BY OWRD

Oregon Water Resources
725 Summer Street NE, Suite A
Salem, OR 97301-1266

OCT 24 2012

SALEM, OR

Please allow Glender's Hydro Tech Services act as a 2nd agent in our application process.

If you have any questions, please contact me at 541-480-9752.

Sincerely,

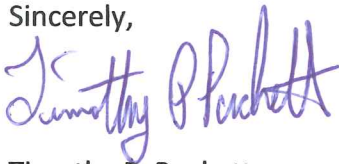

Timothy P. Puckett
Owner/President
Golden Rule Farms Inc.

"Revised" JF

SECTION 2: PROPERTY OWNERSHIP

Please indicate if you own all the lands associated with the project from which the water is to be diverted, conveyed, and used.

Yes

There are no encumbrances.

This land is encumbered by easements, rights of way, roads or other encumbrances.

No

I have a recorded easement or written authorization permitting access.

I do not currently have written authorization or easement permitting access.

Written authorization or an easement is not necessary, because the only affected lands I do not own are state-owned submersible lands, and this application is for irrigation and/or domestic use only (ORS 274.040).

Water is to be diverted, conveyed, and/or used only on federal lands.

List the names and mailing addresses of all affected landowners (*attach additional sheets if necessary*).

Timothy Puckett

PO Box 255

Christmas Valley, Oregon 97641

SECTION 3: WELL DEVELOPMENT

WELL NO.	NAME OF NEAREST SURFACE WATER	IF LESS THAN 1 MILE:	
		DISTANCE TO NEAREST SURFACE WATER	ELEVATION CHANGE BETWEEN NEAREST SURFACE WATER AND WELL HEAD
3	Malhuer Lake		N/A
1	Malhuer Lake		N/A

Please provide any information for your existing or proposed well(s) that you believe may be helpful in evaluating your application. For existing wells, describe any previous alteration(s) or repair(s) not documented in the attached well log or other materials (*attach additional sheets if necessary*).

Well logs attached.

RECEIVED BY OWRD

OCT 24 2012

SALEM, OR

SECTION 3: WELL DEVELOPMENT, CONTINUED

"Revised" *JP*

Source (aquifer), if known: See well logs Harn 1494 (well 1) & Harn 51851 (well 3)

Total maximum rate requested: 1200 gpm any combination of well 3 or 1 (each well will be evaluated at the maximum rate unless you indicate well-specific rates and annual volumes in the table below).

Complete the table below. If this is an existing well, the following information may be found on the applicable well log. *(If a well log is available, please submit it in addition to completing the table.)* If this is a proposed well, or well-modification, consider consulting with a licensed well driller, geologist, or certified water right examiner.

OWNER'S WELL NAME OR NO.	PROPOSED	EXISTING	WELL ID (WELL TAG) NO.* OR WELL LOG ID**	FLOWING ARTESIAN	CASING DIAMETER	CASING INTERVALS (IN FEET)	PERFORATED OR SCREENED INTERVALS (IN FEET)	SEAL INTERVALS (IN FEET)	MOST RECENT STATIC WATER LEVEL & DATE (IN FEET)	PROPOSED USE			
										SOURCE AQUIFER***	TOTAL WELL DEPTH	WELL-SPECIFIC RATE (GPM)	ANNUAL VOLUME (ACRE-FEET)
3	<input type="checkbox"/>	<input type="checkbox"/>	Harn 51851	<input type="checkbox"/>	14"		n/a	0-44'	36'	Alluvial volcanics	230'	1200	240
1	<input type="checkbox"/>	<input type="checkbox"/>	Harn 1494	<input type="checkbox"/>	14"		n/a	0-25'	25'	same	125'	1200	240
	<input type="checkbox"/>	<input type="checkbox"/>		<input type="checkbox"/>									
	<input type="checkbox"/>	<input type="checkbox"/>		<input type="checkbox"/>									
	<input type="checkbox"/>	<input type="checkbox"/>		<input type="checkbox"/>									
	<input type="checkbox"/>	<input type="checkbox"/>		<input type="checkbox"/>									
	<input type="checkbox"/>	<input type="checkbox"/>		<input type="checkbox"/>									
	<input type="checkbox"/>	<input type="checkbox"/>		<input type="checkbox"/>									

RECEIVED BY OWRD

OCT 24 2012

SALEM, OR

* Licensed drillers are required to attach a Department-supplied Well Tag, with a unique Well ID or Well Tag Number to all new or newly altered wells. Landowners can request a Well ID for existing wells that do not have one. The Well ID is intended to serve as a unique identification number for each well.
 ** A well log ID (e.g. MARI 1234) is assigned by the Department to each log in the agency's well log database. A separate well log is required for each subsequent alteration of the well.
 *** Source aquifer examples: Troutdale Formation, gravel and sand, alluvium, basalt, bedrock, etc.

NOTICE TO WATER WELL CONTRACTOR
The original and first copy of this report
are to be filed with the

WATER WELL REPORT

Application # 6-9017

WATER RESOURCES DEPARTMENT,
SALEM, OREGON 97310
within 30 days from the date
of well completion.

STATE OF OREGON

State Well No. 275/34E-96d

(Please type or print)

State Permit No.

(Do not write above this line)

1494
Harney

(1) OWNER:

Name D.V. DOMAN
Address Princeton, Oregon

(2) TYPE OF WORK (check):

New Well Deepening Reconditioning Abandon
If abandonment, describe material and procedure in Item 12.

(3) TYPE OF WELL:

Rotary Driven
Cable Jetted
Dug Bored

(4) PROPOSED USE (check):

Domestic Industrial Municipal
Irrigation Test Well Other

(5) CASING INSTALLED:

Threaded Welded
14" Diam. from 0 ft. to 60 ft. Gage 250
" Diam. from ft. to ft. Gage
" Diam. from ft. to ft. Gage

PERFORATIONS:

Perforated? Yes No.

Type of perforator used

Size of perforations in. by in.
perforations from ft. to ft.
perforations from ft. to ft.
perforations from ft. to ft.

(7) SCREENS:

Well screen installed? Yes No

Manufacturer's Name
Type Model No.
Diam. Slot size Set from ft. to ft.
Diam. Slot size Set from ft. to ft.

(8) WELL TESTS:

Drawdown is amount water level is lowered below static level

Was a pump test made? Yes No If yes, by whom?
Yield: 1200 gal./min. with 37 ft. drawdown after 5 hrs.
" " " " " "
" " " " " "
Bailer test gal./min. with ft. drawdown after hrs.
Artesian flow g.p.m.
Temperature of water Depth artesian flow encountered ft.

(9) CONSTRUCTION:

Well seal—Material used Cement
Well sealed from land surface to 25 ft.
Diameter of well bore to bottom of seal 16 in.
Diameter of well bore below seal 14 in.
Number of sacks of cement used in well seal 11 sacks
How was cement grout placed? poured
Was a drive shoe used? Yes No Plugs Size: location ft.
Did any strata contain unusable water? Yes No
Type of water? depth of strata
Method of sealing strata off
Was well gravel packed? Yes No Size of gravel:
Gravel placed from ft. to ft.

(10) LOCATION OF WELL:

County Harney Driller's well number
SE 1/4 NW 1/4 Section 9 T. 275 R. 34E W.M.

Bearing and distance from section or subdivision corner
0°N 1320' W from center of Sec 9 T275 R34E

(11) WATER LEVEL: Completed well.

Depth at which water was first found 37 ft.
Static level 25 ft. below land surface. Date March 30, 79
Artesian pressure lbs. per square inch. Date

(12) WELL LOG:

Diameter of well below casing 14

Depth drilled 125 ft. Depth of completed well 125 ft.

Formation: Describe color, texture, grain size and structure of materials; and show thickness and nature of each stratum and aquifer penetrated, with at least one entry for each change of formation. Report each change in position of Static Water Level and indicate principal water-bearing strata.

MATERIAL	From	To	SWL
Top Soil	0	2	
Top Soil	2	5	
Brown Clay	5	20	
Blue Clay	20	50	25'
Clay-gravel mix	50	70	25'
Coarse Sand	70	75	25'
Clay-gravel mix	75	120	25'
Coarse Sand	120	125	25'

RECEIVED

RECEIVED BY OWRD

JUN 15 1979

OCT 24 2012

WATER RESOURCES DEPT
SALEM, OREGON

SALEM, OR

Work started March 15 1979 Completed March 25 1979

Date well drilling machine moved off of well March 30 1979

Drilling Machine Operator's Certification:

This well was constructed under my direct supervision. Materials used and information reported above are true to my best knowledge and belief.

[Signed] D.V. Doman Date June 1, 1979
(Drilling Machine Operator)

Drilling Machine Operator's License No. Land owner

Water Well Contractor's Certification:

This well was drilled under my jurisdiction and this report is true to the best of my knowledge and belief.

Name D.V. Doman (Type or print)
(Person, firm or corporation)

Address D.V. Doman
[Signed] (Water Well Contractor)

Contractor's License No. Date June 1979

STATE OF OREGON
WATER SUPPLY WELL REPORT
(as required by ORS 537.765 & OAR 690-205-0210)

HARN 51851
6/2/2012

WELL I.D. LABEL# L 105480
START CARD # 1016695
ORIGINAL LOG #

(1) LAND OWNER
Owner Well I.D. _____
First Name ABRAHAM Last Name PUCKETT
Company GOLDEN RULE FARMS
Address PO BOX 255
City CHRISTMAS VALLEY State OR Zip 97641

(2) TYPE OF WORK New Well Deepening Conversion
 Alteration (complete 2a & 10) Abandonment (complete 5a)

(2a) PRE-ALTERATION
Dia + From To Gauge Stl Plstc Wld Thrd
Casing: _____
Material From To Amt sacks/lbs
Seal: _____

(3) DRILL METHOD
 Rotary Air Rotary Mud Cable Auger Cable Mud
 Reverse Rotary Other _____

(4) PROPOSED USE Domestic Irrigation Community
 Industrial/ Commercial Livestock Dewatering
 Thermal Injection Other _____

(5) BORE HOLE CONSTRUCTION Special Standard (Attach copy)
Depth of Completed Well 230.00 ft.
BORE HOLE SEAL
Dia From To Material From To Amt sacks/lbs

Dia	From	To	Material	From	To	Amt	sacks/lbs
18	0	44	Bentonite Chips	0	36	22	S
14	44	230					

How was seal placed: Method A B C D E
 Other POURED DRY
Backfill placed from _____ ft. to _____ ft. Material _____
Filter pack from _____ ft. to _____ ft. Material _____ Size _____
Explosives used: Yes Type _____ Amount _____

(5a) ABANDONMENT USING UNHYDRATED BENTONITE
Proposed Amount _____ Actual Amount _____

(6) CASING/LINER
Casing Liner Dia + From To Gauge Stl Plstc Wld Thrd
Shoe Inside Outside Other Location of shoe(s) _____
Temp casing Yes Dia _____ From _____ To _____

(7) PERFORATIONS/SCREENS
Perforations Method _____
Screens Type _____ Material _____
Perf/ Casing/ Screen Scm/slot Slot # of Tele/
Screen Liner Dia From To width length slots pipe size

(8) WELL TESTS: Minimum testing time is 1 hour
 Pump Bailer Air Flowing Artesian
Yield gal/min Drawdown Drill stem/Pump depth Duration (hr)
1000 _____ 230 1
Temperature 50 °F Lab analysis Yes By _____
Water quality concerns? Yes (describe below) TDS amount
From To Description Amount Units

(9) LOCATION OF WELL (legal description)
County HARNEY Twp 27.00 S N/S Range 34.00 E E/W WM
Sec 9 SW 1/4 of the NE 1/4 Tax Lot 400
Tax Map Number _____ Lot _____
Lat _____ " or _____ DMS or DD
Long _____ " or _____ DMS or DD
 Street address of well Nearest address
NA

(10) STATIC WATER LEVEL
Date SWL(psi) + SWL(ft)
Existing Well / Pre-Alteration _____
Completed Well 5/24/2012 _____ 36
Flowing Artesian? Dry Hole?
WATER BEARING ZONES Depth water was first found 40.00
SWL Date From To Est Flow SWL(psi) + SWL(ft)

SWL Date	From	To	Est Flow	SWL(psi)	+ SWL(ft)
5/24/2012	40	230	1000		36

(11) WELL LOG
Ground Elevation _____
Material From To
top soil with brown clay 0 15
brown sand 15 27
dark brown clay 27 40
grey clay with brown sand 40 134
broken rock congl. with pumice 134 230
RECEIVED BY OWRD
OCT 24 2012
SALEM, OR

Date Started 5/23/2012 Complete 5/24/2012

(unbonded) Water Well Constructor Certification
I certify that the work I performed on the construction, deepening, alteration, or abandonment of this well is in compliance with Oregon water supply well construction standards. Materials used and information reported above are true to the best of my knowledge and belief.
License Number _____ Date _____
Signed _____

(bonded) Water Well Constructor Certification
I accept responsibility for the construction, deepening, alteration, or abandonment work performed on this well during the construction dates reported above. All work performed during this time is in compliance with Oregon water supply well construction standards. This report is true to the best of my knowledge and belief.
License Number 1568 Date 6/2/2012
Signed DAVID KUHN (E-filed)
Contact Info (optional) _____

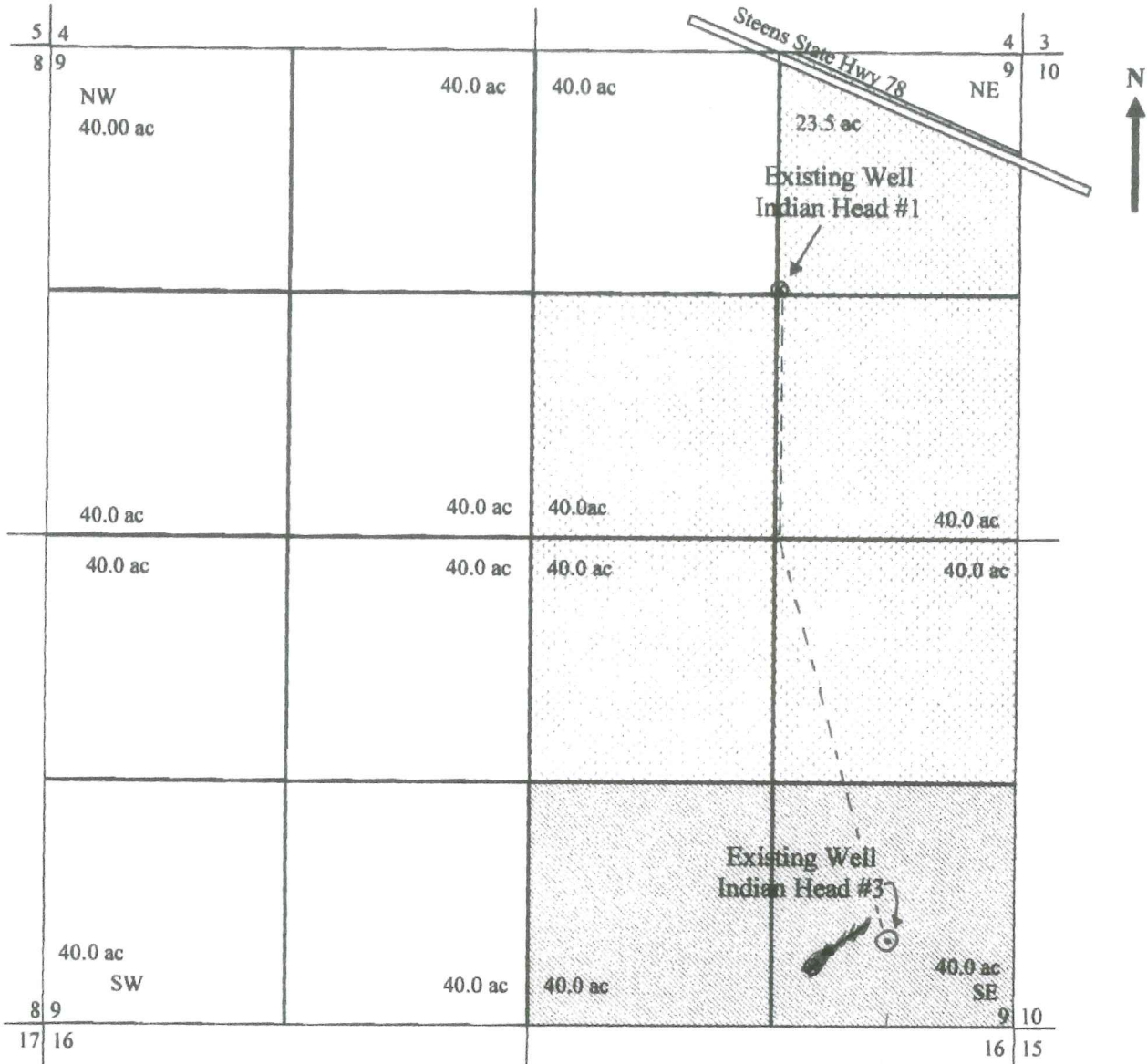

Indian Head #1

Well is located ~~1300~~¹³⁰² feet South and ~~1300~~¹³⁰² feet West of the NE corner of Section 9

1302'

Indian Head #3 (ID #105480)

Well is located ~~1300~~⁵⁰⁵ feet North and ~~300~~⁷⁵⁰ feet West of the SE corner of Section 9

750'

S1/2 SE1/4 Section 9 in T27S R34E W.M.

Tax Lot 400: 80.0 acres (requested)
1" = 880 feet

Current Water Rights =

Proposed Water Rights =

RECEIVED BY OWRD

SEP 17 2012

SALEM, OR

RECEIVED BY OWRD

SEP 27 2012

SALEM, OR

RECEIVED BY OWRD

OCT 24 2012

SALEM, OR

"Revised" *JP*

Application for a Permit to Use Ground Water



Oregon Water Resources Department
725 Summer Street NE, Suite A
Salem, Oregon 97301-1266
(503) 986-0900
www.wrd.state.or.us

RECEIVED BY OWRD

Water-Use Permit Application Processing

SEP 17 2012

1. Completeness Determination

SALEM, OR

The Department evaluates whether the application and accompanying map contain all of the information required under OAR 690-310-0040 and OAR 690-310-0050 (www.oregon.gov/owrd/law). The Department also determines whether the proposed use is prohibited by statute. If the Department determines that the application is incomplete, all fees have not been paid, or the use is prohibited by statute, the application and all fees submitted are returned to the applicant.

2. Initial Review

The Department reviews the application to determine whether water is available during the period requested, whether the proposed use is restricted or limited by rule or statute, and whether other issues may preclude approval of or restrict the proposed use. An Initial Review (IR) containing preliminary determinations is mailed to the applicant. The applicant has 14 days from the mailing date to withdraw the application from further processing and receive a refund of all fees paid minus \$200. The applicant may put the application on hold for up to 180 days and may request additional time if necessary.

3. Public Notice

Within 7 days of the mailing of the initial review, the Department gives public notice of the application in the weekly notice published by the Department at www.oregon.gov/owrd. The public comment period is 30 days from publication in the weekly notice.

4. Proposed Final Order Issued

The Department reviews any comments received, including comments from other state agencies related to the protection of sensitive, threatened or endangered fish species. Within 60 days of completion of the IR, the Department issues a Proposed Final Order (PFO) explaining the proposed decision to deny or approve the application. A PFO proposing approval of an application will include a draft permit, and may request additional information or outstanding fees required prior to permit issuance.

5. Public Notice

Within 7 days of issuing the PFO, the Department gives public notice in the weekly notice. Notice includes information about the application and the PFO. Protest must be received by the Department within 45 days after publication of the PFO in the weekly notice. Anyone may file a protest. The protest filing fee is \$300.00 for the applicant and \$600.00 for non-applicants. Protests are filed on approximately 10% of Proposed Final Orders. If a protest is filed, the Department will attempt to settle the protest but will schedule a contested case hearing if necessary.

6. Final Order Issued

If no protests are filed, the Department issues a Final Order consistent with the PFO. If the application is approved, a permit is issued that specifies the details of the authorized use and any terms, limitations or conditions that the Department deems appropriate.

RECEIVED BY OWRD

G-17587

SEP 27 2012

Minimum Requirements Checklist

Minimum Requirements (OAR 690-310-0040, OAR 690-310-0050 & ORS 537.615)

Include this checklist with the application

Check that each of the following items is included. The application will be returned if all required items are not included. If you have questions, please call the Water Rights Customer Service Group at (503) 986-0900.

- SECTION 1: applicant information and signature
- SECTION 2: property ownership
- SECTION 3: well development
- SECTION 4: water use
- SECTION 5: water management
- SECTION 6: storage of groundwater in a reservoir
- SECTION 7: use of stored groundwater from the reservoir
- SECTION 8: project schedule
- SECTION 9: within a district
- SECTION 10: remarks

RECEIVED BY OWRD

SEP 17 2012

SALEM, OR

Attachments:

- Land Use Information Form with approval and signature (*must be an original*) or signed receipt
- Provide the legal description of: (1) the property from which the water is to be diverted, (2) any property crossed by the proposed ditch, canal or other work, and (3) any property on which the water is to be used as depicted on the map. Example: A copy of the deed, land sales contract or title insurance policy.
- Fees - Amount enclosed: \$ _____
See the Department's Fee Schedule at www.oregon.gov/owrd or call (503) 986-0900.

Provide a map and check that each of the following items is included:

- Permanent quality and drawn in ink
- Even map scale not less than 4" = 1 mile (example: 1" = 400 ft, 1" = 1320 ft, etc.)
- North Directional Symbol
- Township, Range, Section, Quarter/Quarter, Tax Lots
- Reference corner on map
- Location of each well, and/or dam if applicable, by reference to a recognized public land survey corner (distances north/south and east/west). Each well must be identified by a unique name and/or number.
- Indicate the area of use by Quarter/Quarter and tax lot clearly identified
- Number of acres per Quarter/Quarter and hatching to indicate area of use if for primary irrigation, supplemental irrigation, or nursery
- Location of main canals, ditches, pipelines or flumes (if well is outside of the area of use)
- Other _____

RECEIVED BY OWRD

SEP 27 2012

SALEM, OR

Application for a Permit to Use Ground Water



Oregon Water Resources Department
725 Summer Street NE, Suite A
Salem, Oregon 97301-1266
(503) 986-0900
www.wrd.state.or.us

SECTION 1: APPLICANT INFORMATION AND SIGNATURE

Applicant Information

NAME GOLDEN RULE FARMS, INC		PHONE (HM) N/A	
PHONE (WK) 541-576-2273	CELL 541-480-9752	FAX 541-576-2273	
ADDRESS PO BOX 255			
CITY CHRISTMAS VALLEY	STATE OR	ZIP 97641	E-MAIL* GOLDENRULEFARMS@GMAIL.COM

Organization Information

NAME		PHONE	FAX
ADDRESS		CELL	
CITY	STATE	ZIP	E-MAIL*

RECEIVED BY OWRL
SEP 27 2012
SALEM, OR

Agent Information – The agent is authorized to represent the applicant in all matters relating to this application.

AGENT / BUSINESS NAME STACEY PUCKETT		PHONE 541-573-2755	FAX 541-573-2755
ADDRESS PO BOX 1425 / 701 TULE AVE.		CELL 541-480-8475	
CITY HINES	STATE OR	ZIP 97641	E-MAIL* PUCKETTANDSON@GMAIL.COM

RECEIVED BY OWRL
SEP 17 2012
SALEM, OR

Note: Attach multiple copies as needed

* By providing an e-mail address, consent is given to receive all correspondence from the department electronically. (paper copies of the final order documents will also be mailed.)

By my signature below I confirm that I understand:

- I am asking to use water specifically as described in this application.
- Evaluation of this application will be based on information provided in the application.
- I cannot use water legally until the Water Resources Department issues a permit.
- Oregon law requires that a permit be issued before beginning construction of any proposed well, unless the use is exempt. Acceptance of this application does not guarantee a permit will be issued.
- If I get a permit, I must not waste water.
- If development of the water use is not according to the terms of the permit, the permit can be cancelled.
- The water use must be compatible with local comprehensive land-use plans.
- Even if the Department issues a permit, I may have to stop using water to allow senior water-right holders to get water to which they are entitled.

I (we) affirm that the information contained in this application is true and accurate.

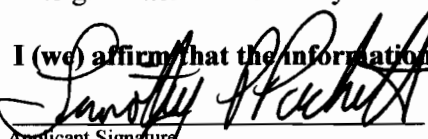
Applicant Signature

Applicant Signature

Timothy Puckett
Print Name and title if applicable
President / Owner - Golden Rule Farms Inc.
Print Name and title if applicable

8-29-12
Date
Date

For Department Use		
App. No. <u>07-17587</u>	Permit No. _____	Date _____

SECTION 2: PROPERTY OWNERSHIP

Please indicate if you own all the lands associated with the project from which the water is to be diverted, conveyed, and used.

Yes

There are no encumbrances.

This land is encumbered by easements, rights of way, roads or other encumbrances.

No

I have a recorded easement or written authorization permitting access.

I do not currently have written authorization or easement permitting access.

Written authorization or an easement is not necessary, because the only affected lands I do not own are state-owned submersible lands, and this application is for irrigation and/or domestic use only (ORS 274.040).

Water is to be diverted, conveyed, and/or used only on federal lands.

List the names and mailing addresses of all affected landowners (*attach additional sheets if necessary*).

_____ Timothy Puckett
 PO Box 255
 Christmas Valley, OR 97641

SECTION 3: WELL DEVELOPMENT

WELL NO.	NAME OF NEAREST SURFACE WATER	IF LESS THAN 1 MILE:	
		DISTANCE TO NEAREST SURFACE WATER	ELEVATION CHANGE BETWEEN NEAREST SURFACE WATER AND WELL HEAD
3	Malheur Lake		N/A

Please provide any information for your existing or proposed well(s) that you believe may be helpful in evaluating your application. For existing wells, describe any previous alteration(s) or repair(s) not documented in the attached well log or other materials (*attach additional sheets if necessary*).

RECEIVED BY OWRD

SEP 27 2012

SALEM, OR

G47587

RECEIVED BY OWRD

SEP 17 2012

SALEM, OR

SECTION 3: WELL DEVELOPMENT, CONTINUED

Source (aquifer), if known: Alluvial / Volcanics

Total maximum rate requested: 1,200 gpm (each well will be evaluated at the maximum rate unless you indicate well-specific rates and annual volumes in the table below).

Complete the table below. If this is an existing well, the following information may be found on the applicable well log. (If a well log is available, please submit it in addition to completing the table.) If this is a proposed well, or well-modification, consider consulting with a licensed well driller, geologist, or certified water right examiner.

OWNER'S WELL NAME OR NO.	PROPOSED	EXISTING	WELL ID (WELL TAG) NO.* OR WELL LOG ID**	FLOWING ARTESIAN	CASING DIAMETER	CASING INTERVALS (IN FEET)	PERFORATED OR SCREENED INTERVALS (IN FEET)	SEAL INTERVALS (IN FEET)	MOST RECENT STATIC WATER LEVEL & DATE (IN FEET)	PROPOSED USE			
										SOURCE AQUIFER***	TOTAL WELL DEPTH	WELL-SPECIFIC RATE (GPM)	ANNUAL VOLUME (ACRE-FEET)
3	<input type="checkbox"/>	<input checked="" type="checkbox"/>	105480	<input type="checkbox"/>	14"		n/a	min. 0-18'	36' 5/24/12	Alluvial Volcanics	230'	1200	240
	<input type="checkbox"/>	<input type="checkbox"/>		<input type="checkbox"/>									
	<input type="checkbox"/>	<input type="checkbox"/>		<input type="checkbox"/>									
	<input type="checkbox"/>	<input type="checkbox"/>		<input type="checkbox"/>									
	<input type="checkbox"/>	<input type="checkbox"/>		<input type="checkbox"/>									
	<input type="checkbox"/>	<input type="checkbox"/>		<input type="checkbox"/>									
	<input type="checkbox"/>	<input type="checkbox"/>		<input type="checkbox"/>									
	<input type="checkbox"/>	<input type="checkbox"/>		<input type="checkbox"/>									

RECEIVED BY OWRD

SEP 27 2012

SALEM, OR

RECEIVED BY OWRD

SEP 17 2012

SALEM, OR

G-17587

* Licensed drillers are required to attach a Department-supplied Well Tag, with a unique Well ID or Well Tag Number to all new or newly altered wells. Landowners can request a Well ID for existing wells that do not have one. The Well ID is intended to serve as a unique identification number for each well.
 ** A well log ID (e.g. MARI 1234) is assigned by the Department to each log in the agency's well log database. A separate well log is required for each subsequent alteration of the well.
 *** Source aquifer examples: Troutdale Formation, gravel and sand, alluvium, basalt, bedrock, etc.

SECTION 4: WATER USE

USE	PERIOD OF USE	ANNUAL VOLUME (ACRE-FEET)
IRRIGATION	APRIL 1 ST – OCTOBER 31 ST	240

Exempt Uses: Please note that 15,000 gallons per day for single or group **domestic** purposes and 5,000 gallons per day for a single **industrial or commercial** purpose are exempt from permitting requirements.

For irrigation use only:

Please indicate the number of primary and supplemental acres to be irrigated (*must match map*).

Primary: 80 Acres Supplemental: Acres

List the Permit or Certificate number of the underlying primary water right(s):

Indicate the maximum total number of acre-feet you expect to use in an irrigation season:

- If the use is **municipal or quasi-municipal**, attach **Form M**
- If the use is **domestic**, indicate the number of households: N/A
If the use is **mining**, describe what is being mined and the method(s) of extraction: N/A

RECEIVED BY OWRD
SEP 27 2012
SALEM, OR

SECTION 5: WATER MANAGEMENT

A. Diversion and Conveyance

What equipment will you use to pump water from your well(s)?

Pump (give horsepower and type): 50-150 hp turbine

Other means (describe):

Provide a description of the proposed means of diversion, construction, and operation of the diversion works and conveyance of water. WE WILL USE 10" PVC PIPE DIRECT FROM THE PUMP TO THE WHEEL LINES

RECEIVED BY OWRD
SEP 17 2012
SALEM, OR

B. Application Method

What equipment and method of application will be used? (e.g., drip, wheel line, high-pressure sprinkler)
WHEEL LINES

C. Conservation

Please describe why the amount of water requested is needed and measures you propose to: prevent waste; measure the amount of water diverted; prevent damage to aquatic life and riparian habitat; prevent the discharge of contaminated water to a surface stream; prevent adverse impact to public uses of affected surface waters.

I CHOSE WHEEL LINES BECAUSE FOR ME IT IS THE MOST COST-EFFECTIVE AND MANAGABLE MEANS TO DO AN EFFICIENT JOB FOR THIS OPERATION

SECTION 6: STORAGE OF GROUND WATER IN A RESERVOIR

If you would like to store ground water in a reservoir, complete this section (*if more than one reservoir, reproduce this section for each reservoir*).

G1-17587

Reservoir name: N/A Acreage inundated by reservoir: N/A

Use(s): N/A

Volume of Reservoir (acre-feet): N/A Dam height (feet, if excavated, write "zero"): N/A

Note: If the dam height is greater than or equal to 10.0' above land surface AND the reservoir will store 9.2 acre feet or more, engineered plans and specifications must be approved prior to storage of water.

SECTION 7: USE OF STORED GROUND WATER FROM THE RESERVOIR

If you would like to use stored ground water from the reservoir, complete this section (if more than one reservoir, reproduce this section for each reservoir).

Annual volume (acre-feet): _____

USE OF STORED GROUND WATER	PERIOD OF USE
N/A	

RECEIVED BY OWRD

SEP 27 2012

SECTION 8: PROJECT SCHEDULE

Date construction will begin: ~~SEPTEMBER~~ As soon as permit is issued.

SALEM, OR

Date construction will be completed: ~~SEPTEMBER~~

RECEIVED BY OWRD

Date beneficial water use will begin: APRIL 2018

SEP 17 2012

SECTION 9: WITHIN A DISTRICT

SALEM, OR

Check here if the point of diversion or place of use are located within or served by an irrigation or other water district.

Irrigation District Name	Address	
City	State	Zip

SECTION 10: REMARKS

Use this space to clarify any information you have provided in the application (attach additional sheets if necessary).

Rate of Water requested is necessary for peak crop production.

G-17587

Land Use Information Form



Oregon Water Resources Department
 725 Summer Street NE, Suite A
 Salem, Oregon 97301-1266
 (503) 986-0900
 www.wrd.state.or.us

Applicant: Timothy Puckett
First Last

Mailing Address: PO Box 255

Christmas Valley OR 97641 Daytime Phone: 541-480-9752
City State Zip

A. Land and Location

Please include the following information for all tax lots where water will be diverted (taken from its source), conveyed (transported), and/or used or developed. Applicants for municipal use, or irrigation uses within irrigation districts may substitute existing and proposed service-area boundaries for the tax-lot information requested below.

Township	Range	Section	¼ ¼	Tax Lot #	Plan Designation (e.g., Rural Residential/RR-5)	Water to be:			Proposed Land Use:
27S	34E	9		400		<input type="checkbox"/> Diverted	<input type="checkbox"/> Conveyed	<input checked="" type="checkbox"/> Used	
						<input type="checkbox"/> Diverted	<input type="checkbox"/> Conveyed	<input type="checkbox"/> Used	
						<input type="checkbox"/> Diverted	<input type="checkbox"/> Conveyed	<input type="checkbox"/> Used	
						<input type="checkbox"/> Diverted	<input type="checkbox"/> Conveyed	<input type="checkbox"/> Used	

List all counties and cities where water is proposed to be diverted, conveyed, and/or used or developed:

RECEIVED BY OWRD RECEIVED BY OWRD

 SEP 27 2012 SEP 17 2012

B. Description of Proposed Use

Type of application to be filed with the Water Resources Department:

- Permit to Use or Store Water Water Right Transfer Permit Amendment or Ground Water Registration Modification
 Limited Water Use License Allocation of Conserved Water Exchange of Water

Source of water: Reservoir/Pond Ground Water Surface Water (name) _____

Estimated quantity of water needed: _____ cubic feet per second gallons per minute acre-feet

Intended use of water: Irrigation Commercial Industrial Domestic for _____ household(s)
 Municipal Quasi-Municipal Instream Other _____

Briefly describe:

Note to applicant: If the Land Use Information Form cannot be completed while you wait, please have a local government representative sign the receipt at the bottom of the next page and include it with the application filed with the Water Resources Department.

See bottom of Page 3. →

For Local Government Use Only

The following section must be completed by a planning official from each county and city listed unless the project will be located entirely within the city limits. In that case, only the city planning agency must complete this form. This deals only with the local land-use plan. Do not include approval for activities such as building or grading permits.

Please check the appropriate box below and provide the requested information

- Land uses to be served by the proposed water uses (including proposed construction) are allowed outright or are not regulated by your comprehensive plan. Cite applicable ordinance section(s): EF20-1 Article 3.90
- Land uses to be served by the proposed water uses (including proposed construction) involve discretionary land-use approvals as listed in the table below. (Please attach documentation of applicable land-use approvals which have already been obtained. Record of Action/land-use decision and accompanying findings are sufficient.) **If approvals have been obtained but all appeal periods have not ended, check "Being pursued."**

Type of Land-Use Approval Needed (e.g., plan amendments, rezones, conditional-use permits, etc.)	Cite Most Significant, Applicable Plan Policies & Ordinance Section References	Land-Use Approval:	
		<input type="checkbox"/> Obtained <input type="checkbox"/> Denied	<input type="checkbox"/> Being Pursued <input type="checkbox"/> Not Being Pursued
		<input type="checkbox"/> Obtained <input type="checkbox"/> Denied	<input type="checkbox"/> Being Pursued <input type="checkbox"/> Not Being Pursued
		<input type="checkbox"/> Obtained <input type="checkbox"/> Denied	<input type="checkbox"/> Being Pursued <input type="checkbox"/> Not Being Pursued
		<input type="checkbox"/> Obtained <input type="checkbox"/> Denied	<input type="checkbox"/> Being Pursued <input type="checkbox"/> Not Being Pursued
		<input type="checkbox"/> Obtained <input type="checkbox"/> Denied	<input type="checkbox"/> Being Pursued <input type="checkbox"/> Not Being Pursued

Local governments are invited to express special land-use concerns or make recommendations to the Water Resources Department regarding this proposed use of water below, or on a separate sheet.

RECEIVED BY OWRD

SEP 27 2012

SALEM, OR

RECEIVED BY OWRD

SEP 17 2012

SALEM, OR

Name: Brandon M. Miller Title: Planning Director
 Signature: [Signature] Phone: (503) 573-6655 Date: 8/30/2012
 Government Entity: Harney County

Note to local government representative: Please complete this form or sign the receipt below and return it to the applicant. If you sign the receipt, you will have 30 days from the Water Resources Department's notice date to return the completed Land Use Information Form or WRD may presume the land use associated with the proposed use of water is compatible with local comprehensive plans.

Receipt for Request for Land Use Information

Applicant name: _____
 City or County: _____ Staff contact: _____
 Signature: _____ Phone: _____ Date: _____

Date _____

(For staff use only)



Oregon Water Resources Department
725 Summer Street NE, Suite A
Salem, Oregon 97301-1266
(503) 986-0900
www.wrd.state.or.us

WE ARE RETURNING YOUR APPLICATION FOR THE FOLLOWING REASON(S):

- SECTION 1: _____
- SECTION 2: _____
- SECTION 3: _____
- SECTION 4: _____
- SECTION 5: _____
- SECTION 6: _____
- SECTION 7: _____
- SECTION 8: _____
- SECTION 9: _____

RECEIVED BY OWRD

SEP 17 2012

SALEM, OR

- Land Use Information Form _____
- Provide the legal description of: (1) the property from which the water is to be diverted, (2) any property crossed by the proposed ditch, canal or other work, and (3) any property on which the water is to be used as depicted on the map.
- Fees _____

RECEIVED BY OWRD

SEP 27 2012

SALEM, OR

MAP

- Permanent quality and drawn in ink
- Even map scale not less than 4" = 1 mile (example: 1" = 400 ft, 1" = 1320 ft, etc.)
- North Directional Symbol
- Township, Range, Section, Quarter/Quarter, Tax Lots
- Reference corner on map
- Location of each well, and/or dam if applicable, by reference to a recognized public land survey corner (distances north/south and east/west). Each well must be identified by a unique name and/or number.
- Indicate the area of use by Quarter/Quarter and tax lot clearly identified
- Number of acres per Quarter/Quarter and hatching to indicate area of use if for primary irrigation, supplemental irrigation, or nursery
- Location of main canals, ditches, pipelines or flumes (if well is outside of the area of use)
- Other _____

G-17587

After recording return to:
GOLDEN RULE FARMS, INC.
P.O. BOX 255
CHRISTMAS VALLEY, OR 97641

HARNEY COUNTY, OR 2012-0796
DEEDWD 06/21/2012 09:44 AM
Cnt=1 Pgs=1 Total:\$36.00



1. Maria Iturriga, County Clerk for Harney County, Oregon certifies that the instrument identified herein was recorded in the Clerk records.
Maria Iturriga, CCC, Harney County Clerk

Until a change is requested all tax statements shall be sent to the following address:
GOLDEN RULE FARMS, INC.
P.O. BOX 255
CHRISTMAS VALLEY, OR 97641

Escrow No. BU0020495
Title No. 0020495
SWDI r.020212

STATUTORY WARRANTY DEED

GALE A. NELSON and NOLA L. KAZEBEE, as to an undivided one-half interest each,

Grantor(s), hereby convey and warrant to
GOLDEN RULE FARMS, INC.,

Grantee(s), the following described real property in the County of HARNEY and State of Oregon free of encumbrances except as specifically set forth herein:

A parcel of land located in Sections 4, 9 and 10, Twp. 27 S., R. 34 E., W.M., Harney County, Oregon, more particularly described as follows:

Parcel No. 3 of Partition Plat No. 07-06-203, recorded June 21, 2007, Instrument No. 20071419, Harney County Records.

Land in Harney County, Oregon, as follows:

In Twp. 27 S., R. 34 E., W.M.:
Sec. 9: S1/2SE1/4, NW1/4SE1/4, SW1/4NE1/4.

FOR INFORMATION PURPOSES ONLY, THE MAP/TAX ACCT #(S) ARE REFERENCED HERE:
ACCT# 10840; CODE# 4-2 MAP 27S 34E TL 400

The true and actual consideration for this conveyance is PURSUANT TO AN IRC 1031 TAX DEFERRED EXCHANGE ON BEHALF OF GRANTOR/GRANTEE.

The above-described property is free of encumbrances except all those items of record, if any, as of the date of this deed and those shown below, if any:

BEFORE SIGNING OR ACCEPTING THIS INSTRUMENT, THE PERSON TRANSFERRING FEE TITLE SHOULD INQUIRE ABOUT THE PERSON'S RIGHTS, IF ANY, UNDER ORS 195.300, 195.301 AND 195.305 TO 195.336 AND SECTIONS 5 TO 11, CHAPTER 424, OREGON LAWS 2007, SECTIONS 2 TO 9 AND 17, CHAPTER 855, OREGON LAWS 2009, AND SECTIONS 2 TO 7, CHAPTER 8, OREGON LAWS 2010. THIS INSTRUMENT DOES NOT ALLOW USE OF THE PROPERTY DESCRIBED IN THIS INSTRUMENT IN VIOLATION OF APPLICABLE LAND USE LAWS AND REGULATIONS. BEFORE SIGNING OR ACCEPTING THIS INSTRUMENT, THE PERSON ACQUIRING FEE TITLE TO THE PROPERTY SHOULD CHECK WITH THE APPROPRIATE CITY OR COUNTY PLANNING DEPARTMENT TO VERIFY THAT THE UNIT OF LAND BEING TRANSFERRED IS A LAWFULLY ESTABLISHED LOT OR PARCEL, AS DEFINED IN ORS 92.010 OR 215.010, TO VERIFY THE APPROVED USES OF THE LOT OR PARCEL, TO DETERMINE ANY LIMITS ON LAWSUITS AGAINST FARMING OR FOREST PRACTICES, AS DEFINED IN ORS 30.930, AND TO INQUIRE ABOUT THE RIGHTS OF NEIGHBORING PROPERTY OWNERS, IF ANY, UNDER ORS 195.300, 195.301 AND 195.305 TO 195.336 AND SECTIONS 5 TO 11, CHAPTER 424, OREGON LAWS 2007, SECTIONS 2 TO 9 AND 17, CHAPTER 855, OREGON LAWS 2009, AND SECTIONS 2 TO 7, CHAPTER 8, OREGON LAWS 2010.

Dated this 15 day of MAY, 2012

Gale A. Nelson
GALE A. NELSON

Nola L. Kazbee
NOLA L. KAZEBEE

State of Oregon
County of Clackamas

This instrument was acknowledged before me on May 15th, 2012 by GALE A. NELSON and NOLA L. KAZEBEE.

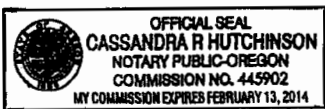

Cassandra R Hutchinson
(Notary Public for OREGON)

My commission expires February 13, 2014

G-17587

RECEIVED BY OWRD

SEP 27 2012

SALEM, OR

RECEIVED BY OWRD

SEP 17 2012

SALEM, OR

