

Indian Head #1

Well is located ~~1300~~<sup>1302</sup> feet South and ~~1300~~<sup>1302</sup> feet West of the NE corner of Section 9

1302'

Indian Head #3 (ID #105480)

Well is located ~~1300~~<sup>505</sup> feet North and ~~300~~<sup>750</sup> feet West of the SE corner of Section 9

750'

S1/2 SE1/4 Section 9 in T27S R34E W.M.

Tax Lot 400: 80.0 acres (requested)  
1" = 880 feet

Current Water Rights =

Proposed Water Rights =

RECEIVED BY OWRD

SEP 17 2012

SALEM, OR

RECEIVED BY OWRD

RECEIVED BY OWRD

SEP 27 2012

OCT 24 2012

SALEM, OR

SALEM, OR

"Revised" *JP*

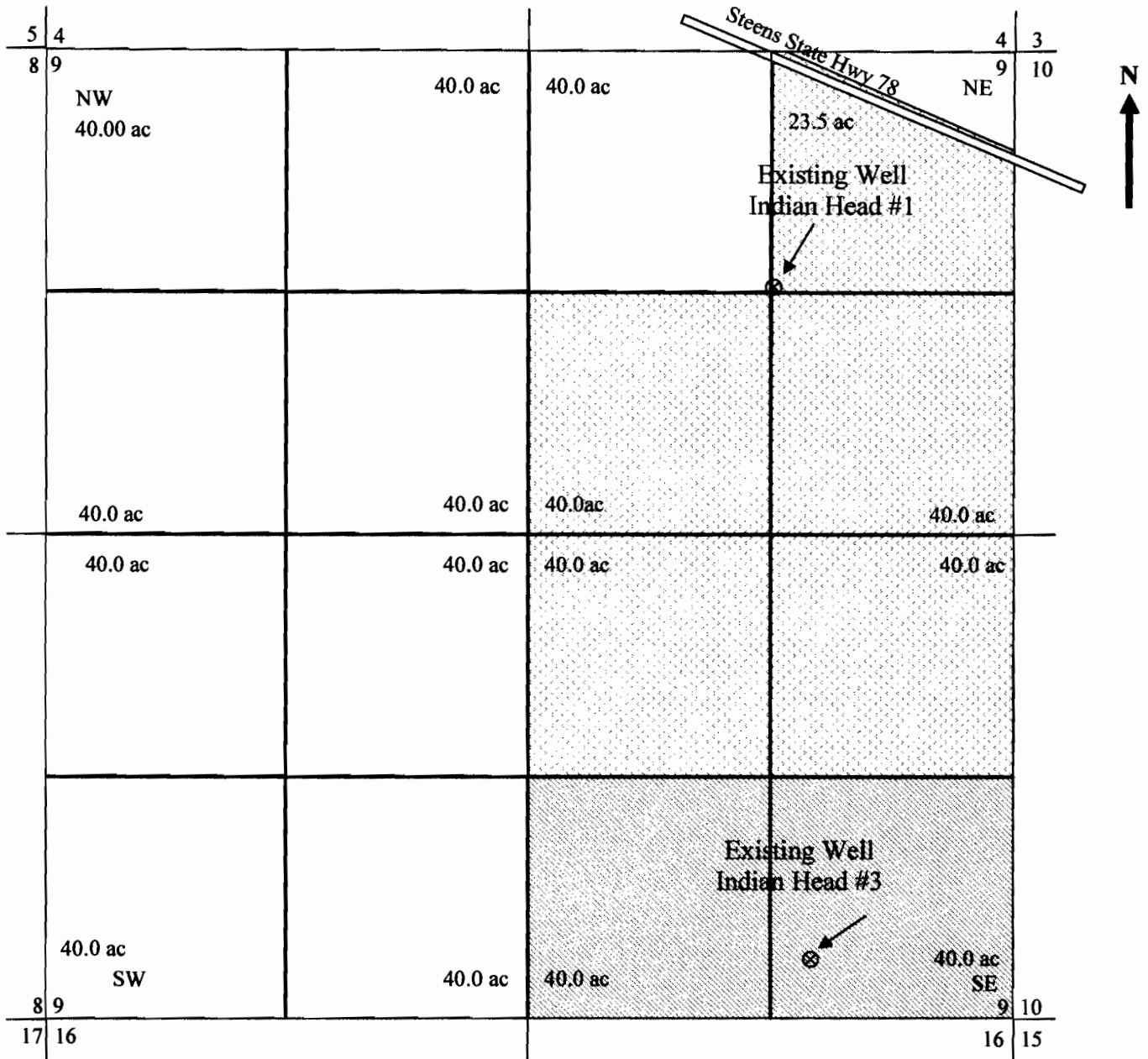

Indian Head #1



Well is located 1,320 feet South and 1,320 feet West of the NE corner of Section 9

Indian Head #3 (ID #105480)

Well is located 1,250 feet North and 300 feet West of the SE corner of Section 9

S1/2 SE1/4 Section 9 in T27S R34E W.M.

Tax Lot 400: 80.0 acres (requested)  
1" = 880 feet

Current Water Rights =   
Proposed Water Rights = 

RECEIVED BY OWRD

SEP 17 2012

SALEM, OR

RECEIVED BY OWRD

SEP 27 2012

SALEM, OR