

TOWNSHIP 33 SOUTH, RANGE 7 1/2 EAST, W. M

Owner # 15A, Property # 1

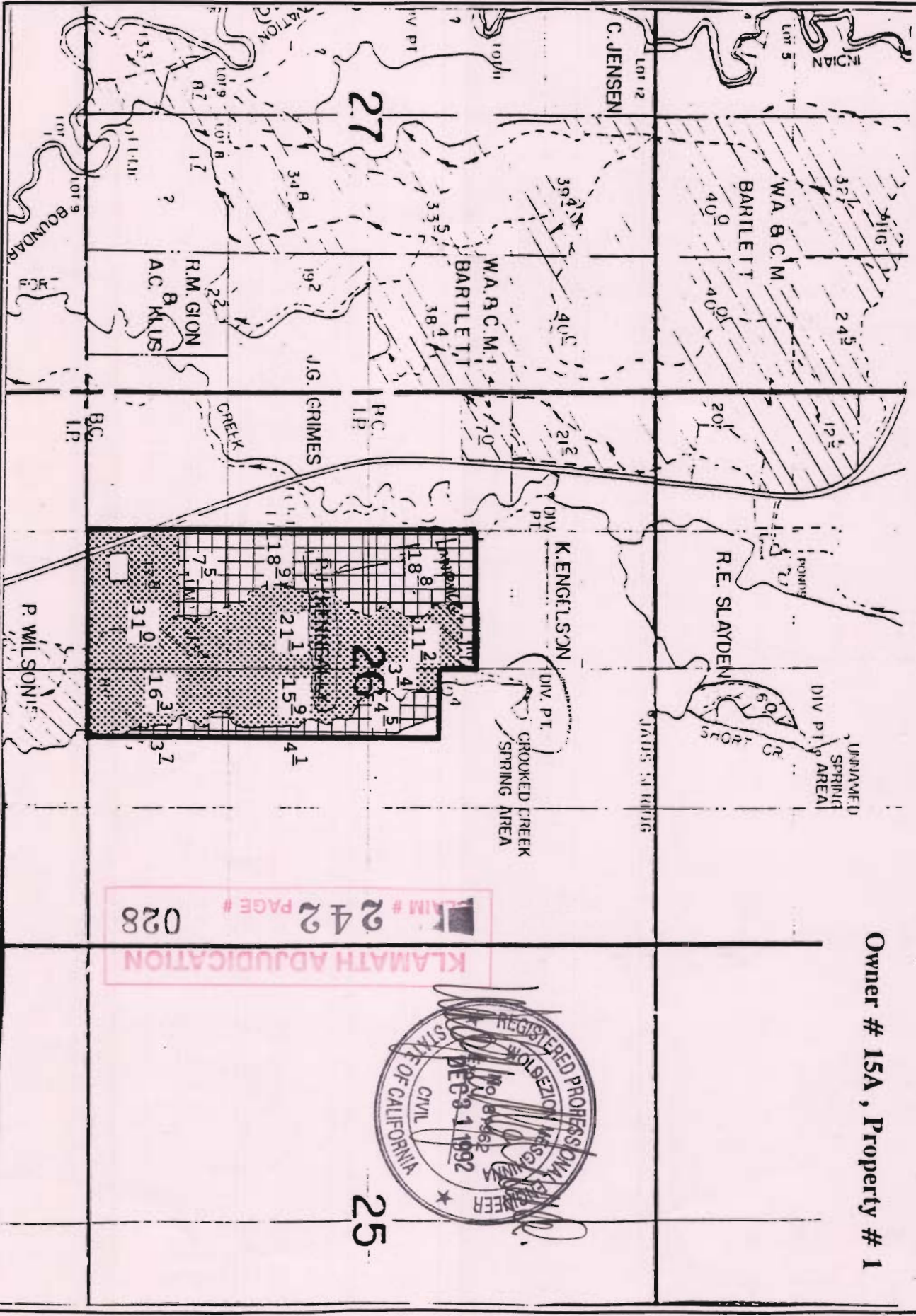

Presently Irrigated Land

Practically Irrigable Acreage

CLAIM # 242 PAGE # 028
KLAMATH ADJUDICATION



By: Natural Resources Consulting Engineers Inc.
1250 Addison St., Suite 204
Berkeley, Ca. 94702
Berkeley (510)841-7814

