

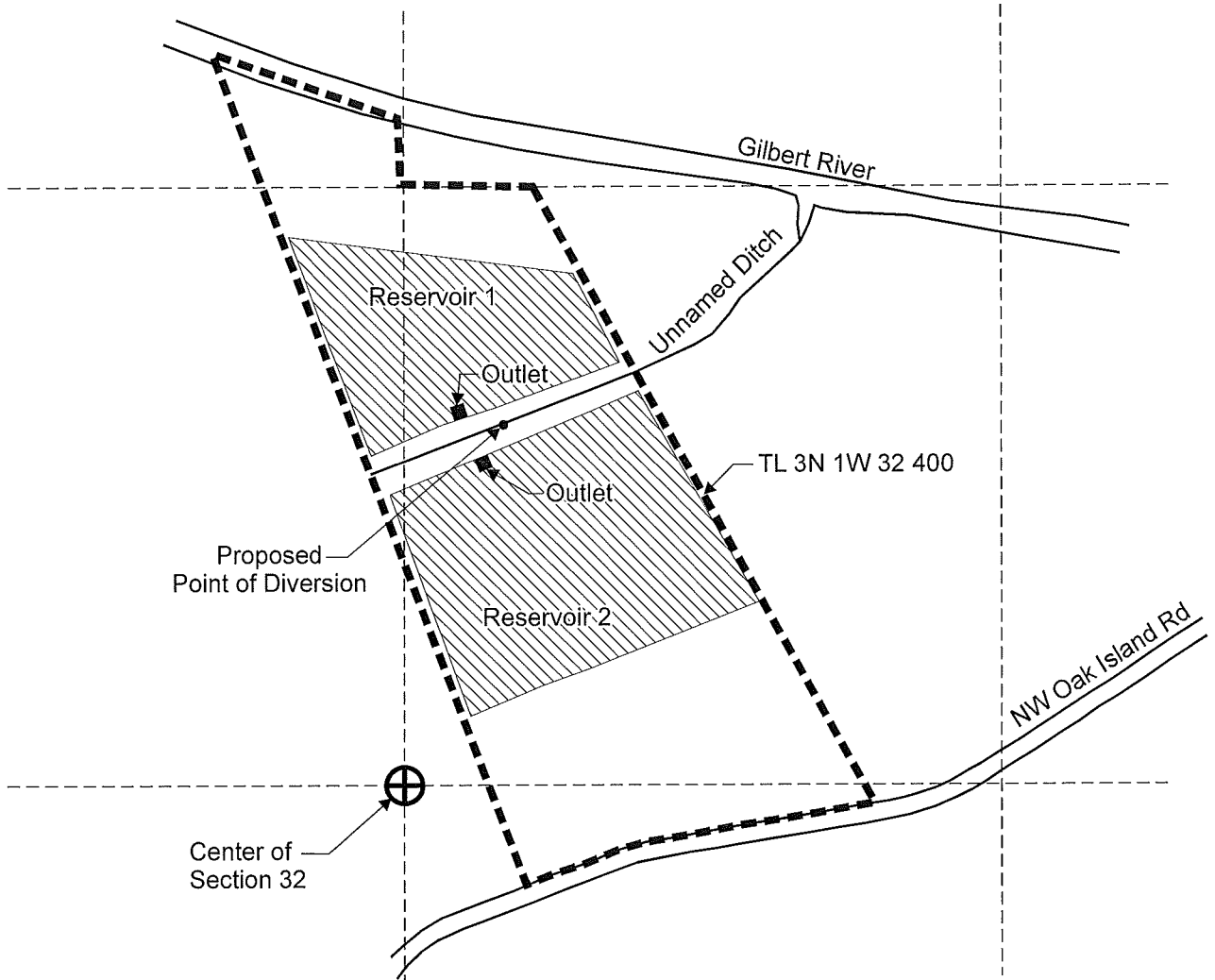

T.3N. R.1W. Section 32, W.M.



Reservoir 1 outlet is located 810 feet north and 120 feet east from the center of Section 32.
 Reservoir 2 outlet is located 720 feet north and 170 feet east from the center of Section 32.
 Proposed Point of Diversion is located 800 feet north and 220 feet east from the center of Section 32.

-  Proposed area to be impounded
-  Tax Lot Boundary

RECEIVED BY OWRD

OCT 11 2012

SALEM, OR

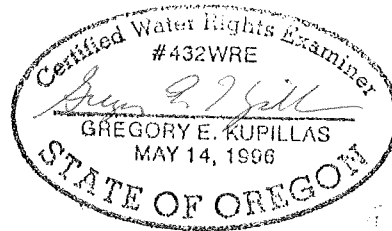

EXPIRATION DATE: 6/30/2013

Scale: 1" = 400'

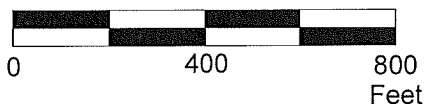

This map was prepared for the purpose of identifying the location of a water right only and is not intended to provide legal dimensions or location of property ownership lines.



Water Right Application Map

Hollow Goose Farm LLC
 T.3N. R.1W. Section 32, W.M.

Pacific Hydro-Geology Inc.

Amended 10/2012