

TOWNSHIP 34 SOUTH, RANGE 7 EAST, W. M.

Owner # 24A, Property # 1  
 OWRD Claim # 252

KLAMATH ADJUDICATION  
 CLAIM # 252 PAGE 8 72



RECEIVED  
 OCT 01 '99  
 WATER RESOURCES DEPT.  
 SALEM, OREGON

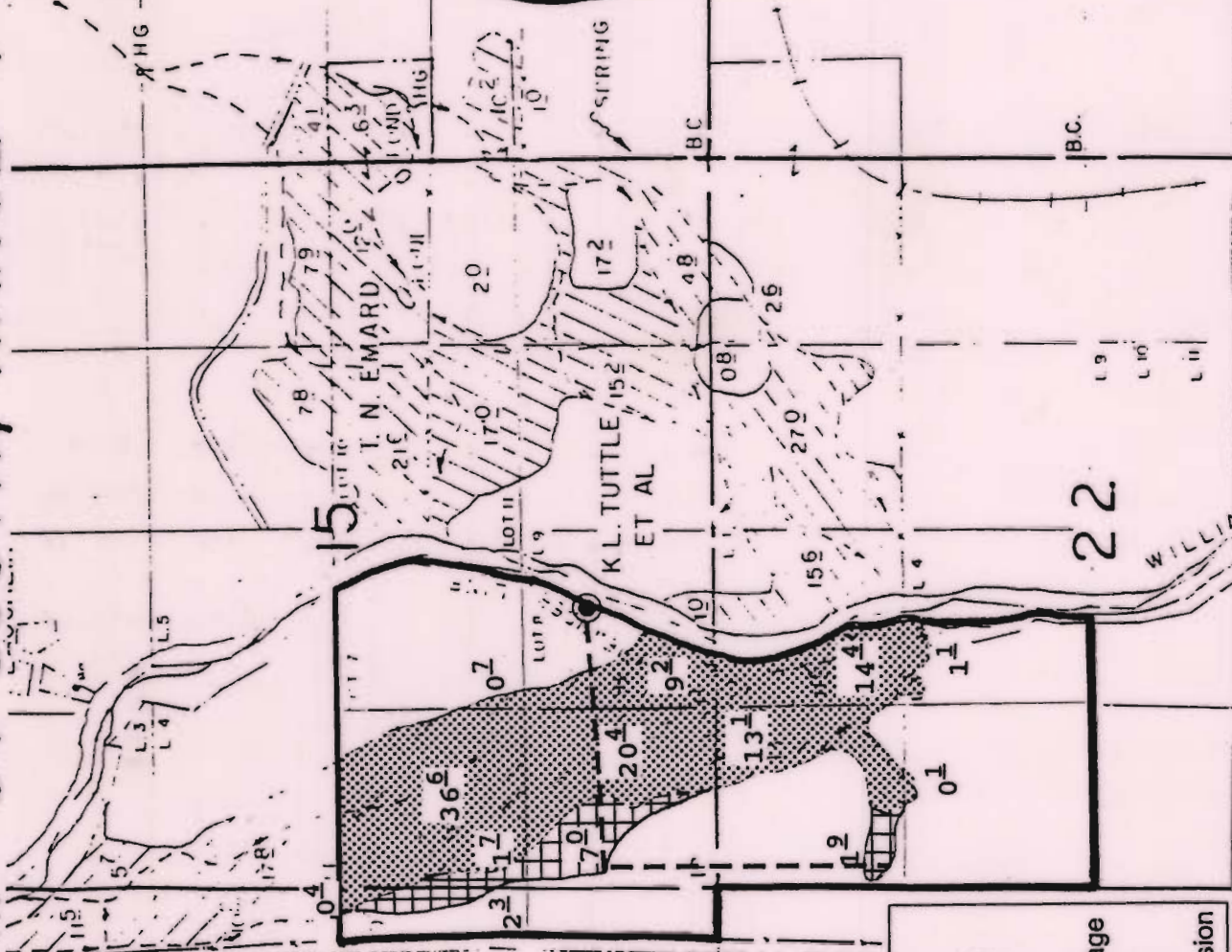

Legend:

- Presently Irrigated Land (stippled pattern)
- Practically Irrigable Acreage (grid pattern)
- Header Pipe (dashed line)
- Point of Diversion (circle with dot)