

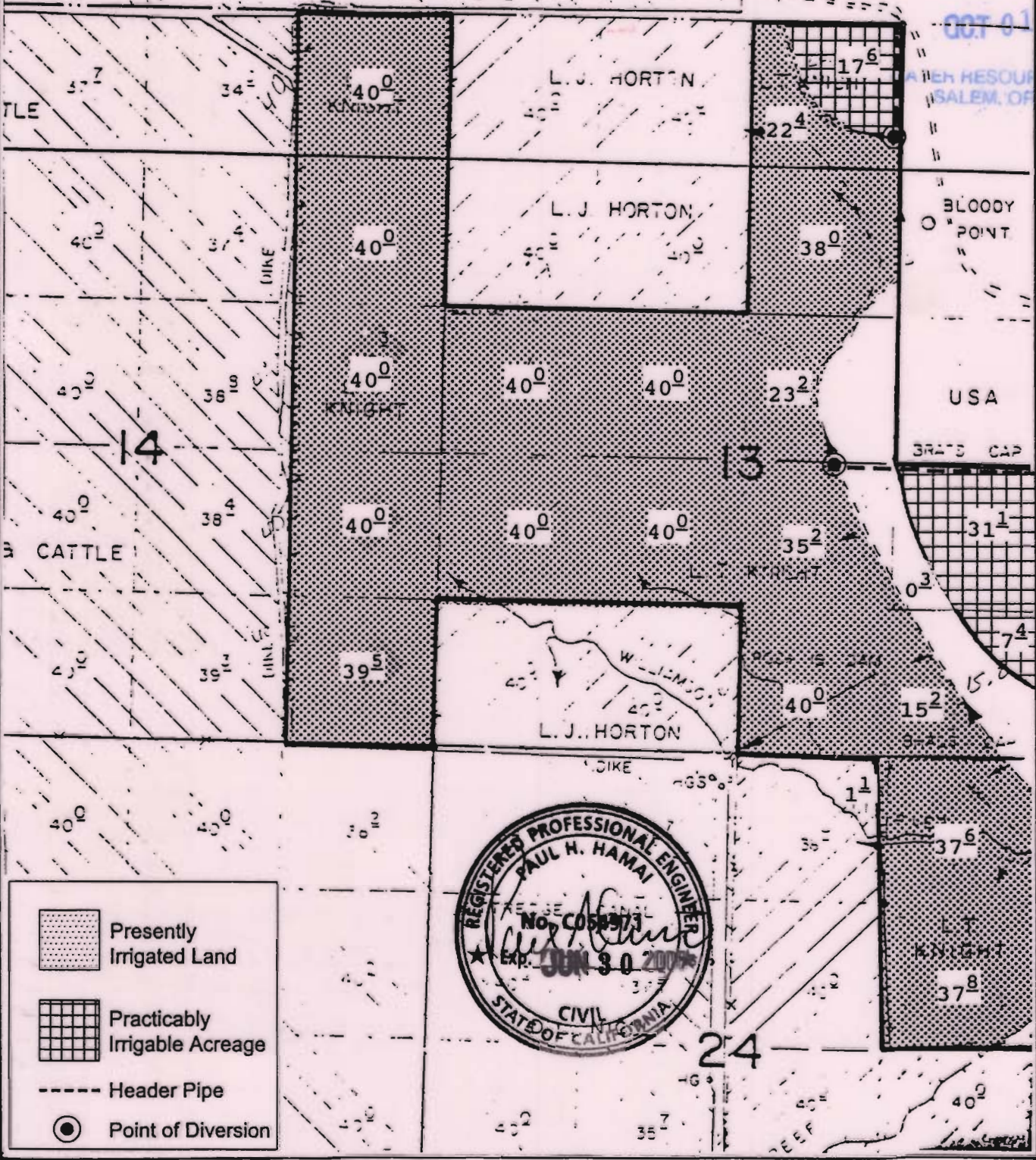



# TOWNSHIP 30 SOUTH, RANGE 9 EAST, W. M.

Owner # 31, Property # 1  
 OWRD Claim # 259

KLAMATH ADMINISTRATION  
 OWRD CLAIM # 259  
 PROPERTY # 114

RECEIVED  
 OCT 01 1999  
 NATHAN RESOURCES DEPT.  
 SALEM, OREGON



	Presently Irrigated Land
	Practically Irrigable Acreage
	Header Pipe
	Point of Diversion



By: Natural Resources Consulting Engineers Inc.  
 1250 Addison St., Suite 204  
 Berkeley, Ca. 94702  
 Berkeley (510)841-7814

