

TOWNSHIP 35 SOUTH, RANGE 9 EAST, W.

Owner # 45, Property # 1

OWRD Claim # 272

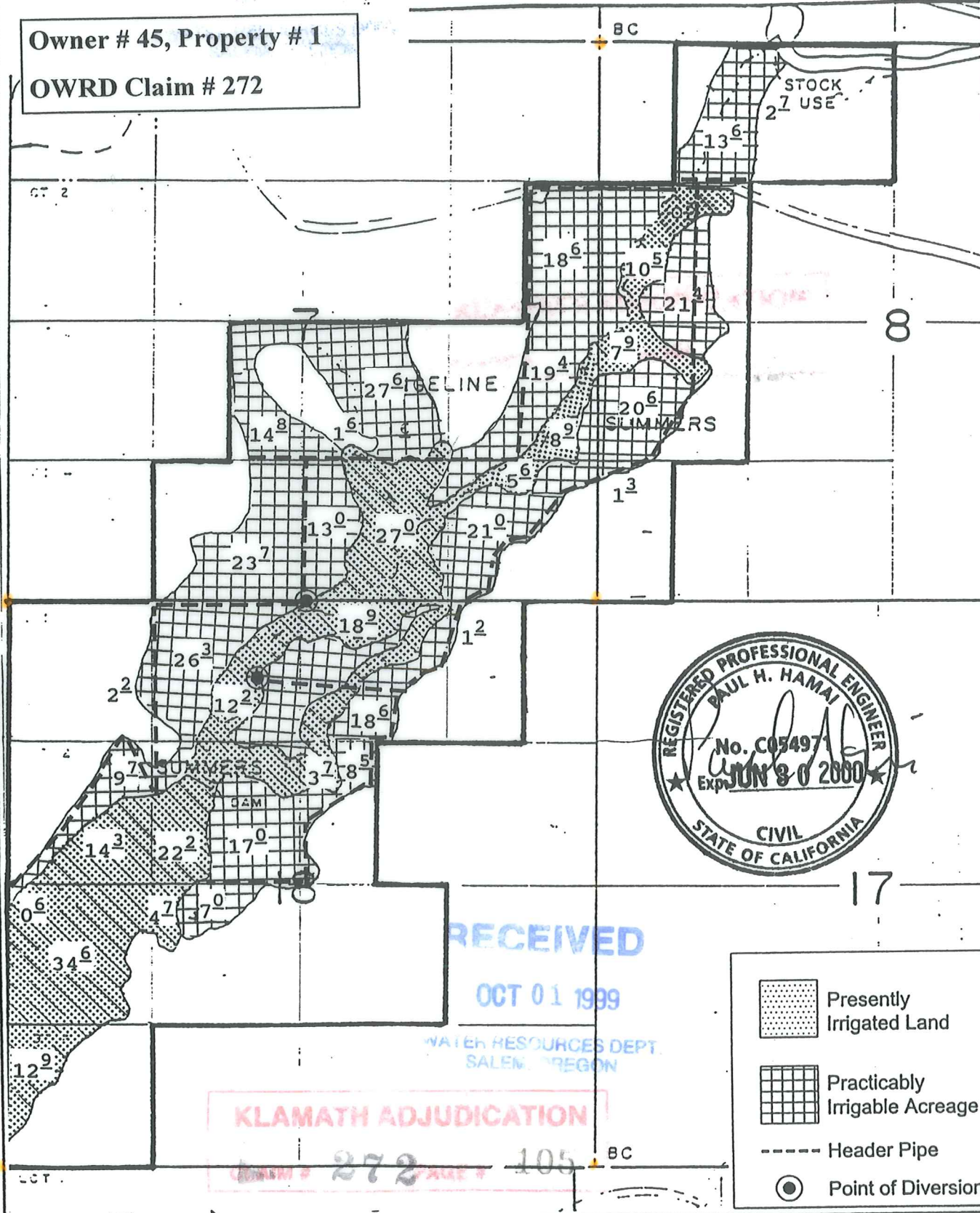





RECEIVED

OCT 01 1999

WATER RESOURCES DEPT.
SALEM, OREGON

KLAMATH ADJUDICATION
OWNER # 272 AREA # 105

-  Presently Irrigated Land
-  Practically Irrigable Acreage
-  Header Pipe
-  Point of Diversion

By: Natural Resources Consulting Engineers Inc.
1250 Addison St., Suite 204
Berkeley, Ca. 94702
Berkeley (510)841-7814

