

KLAMATH ADJUDICATION

PLAN 685

77

# TOWNSHIP 36 SOUTH, RANGE 12 EAST, W. M.

SEE ALSO T36S, R12E

	Presently Irrigated Land
	Practically Irrigable Acreage
	Header Pipe
	Point of Diversion

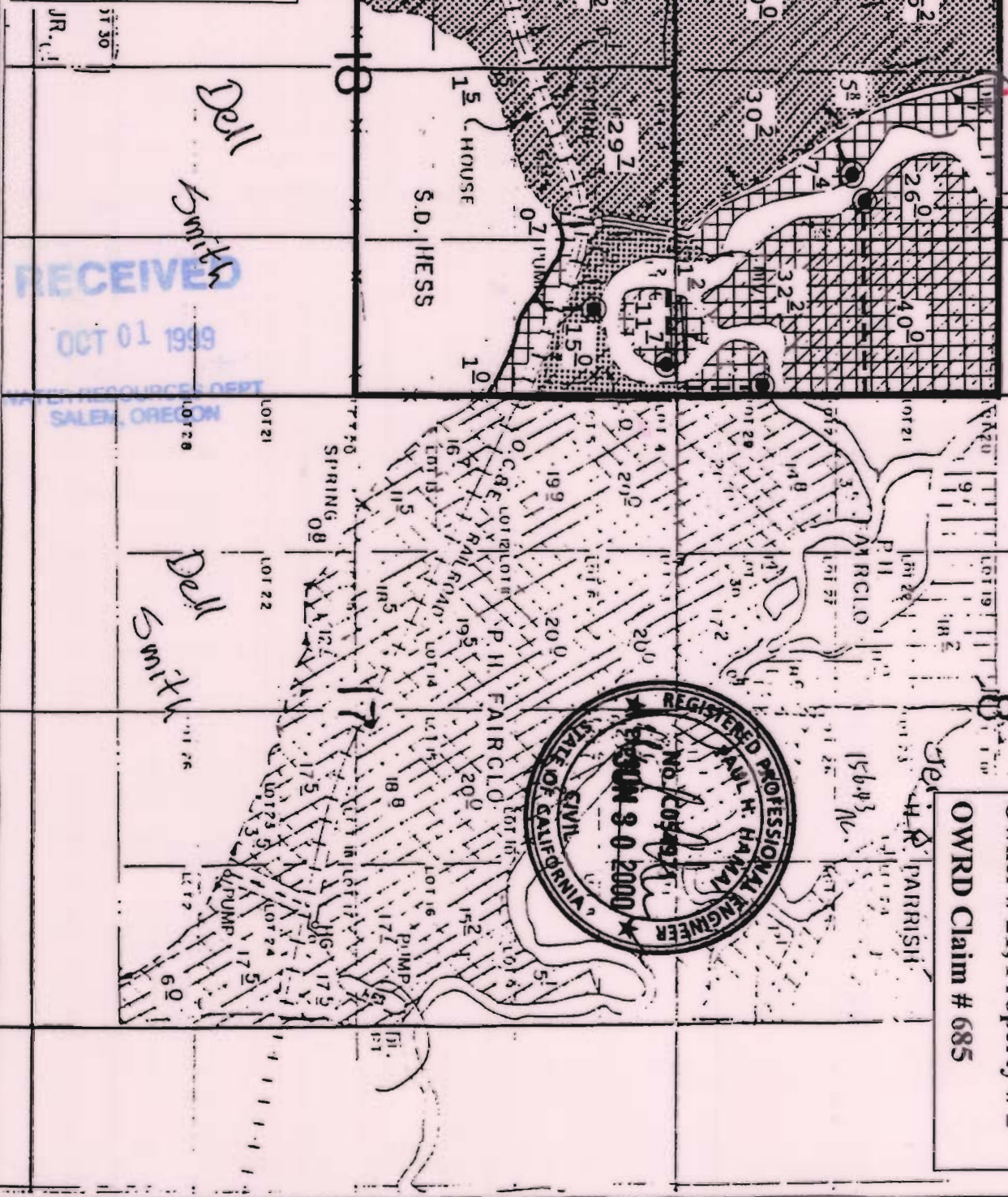

Owner # 21, Property # 2  
OWRD Claim # 685

By: Natural Resources Consulting Engineers Inc.  
1250 Addison St., Suite 204  
Berkeley, Ca. 94702  
Berkeley (510)841-7814

