

TOWNSHIP 36 SOUTH, RANGE 12 EAST, W. M.

Owner # 27, Property # 3
 OWRD Claim # 691





KLAMATH ADJUDICATION

CLAIM # 691 PAGE # 66

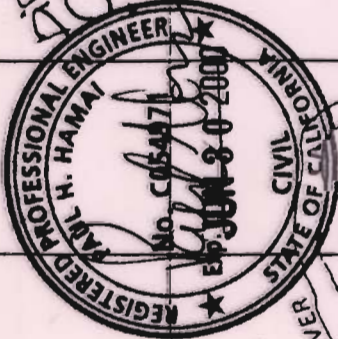
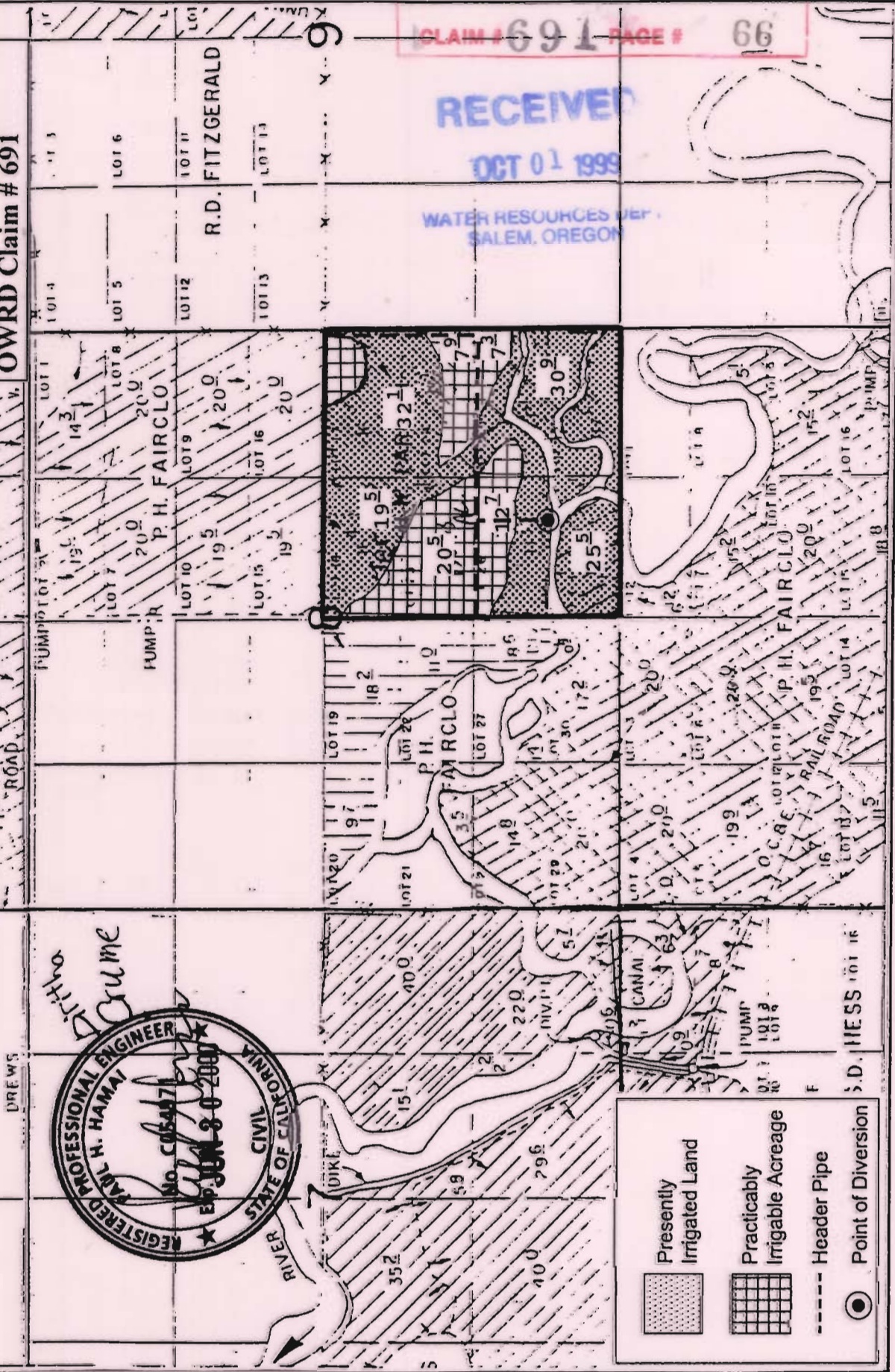
RECEIVED
 OCT 01 1999

WATER RESOURCES DIV.
 SALEM, OREGON



-  Presently Irrigated Land
-  Practicably Irrigable Acreage
-  Header Pipe
-  Point of Diversion



By: Natural Resources Consulting Engineers Inc.
 1250 Addison St., Suite 204
 Berkeley, Ca. 94702
 Berkeley (510)841-7814