

TOWNSHIP 39 SOUTH, RANGE 8 EAST, W. M.

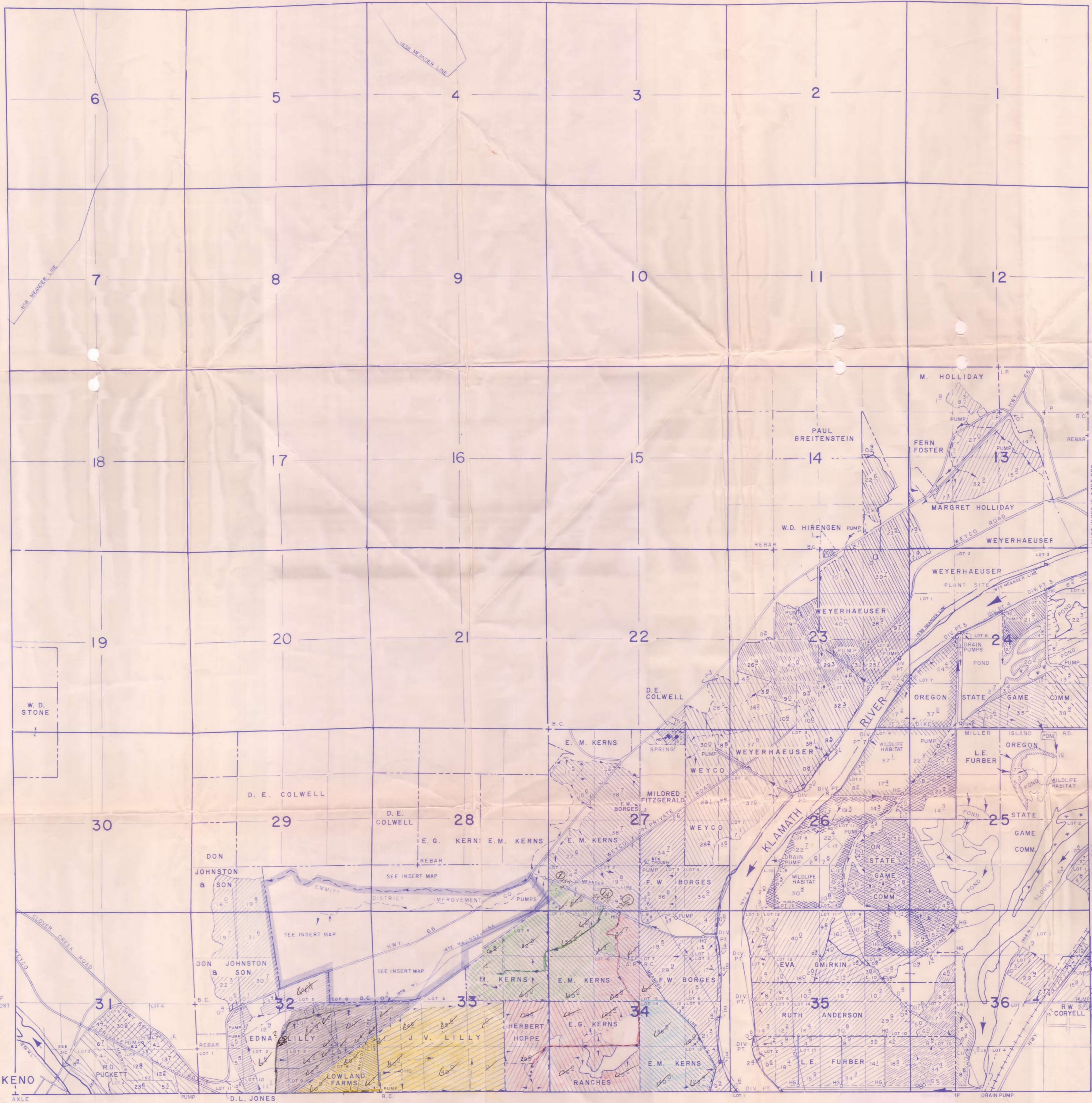

D.V. PTS.  
 E.G. KERNS - 212.5 } 291.7 } 24" (2)  
 HOPPE - 79.2 }  
 E. LILLY - 114.2 } 30" (18)  
 J.V. LILLY - 218.2 } 265.9 } 30" (16)  
 LOWLAND FARMS - 47.7 }  
 E.M. KERNS - 220 } 24" + 18" + 45" (14A)  
 E.M. KERNS - 105.9 } 244'8" (3)

TOTAL 997.7 AC