

TOWNSHIP 40 SOUTH, RANGE 8 EAST, W. M.

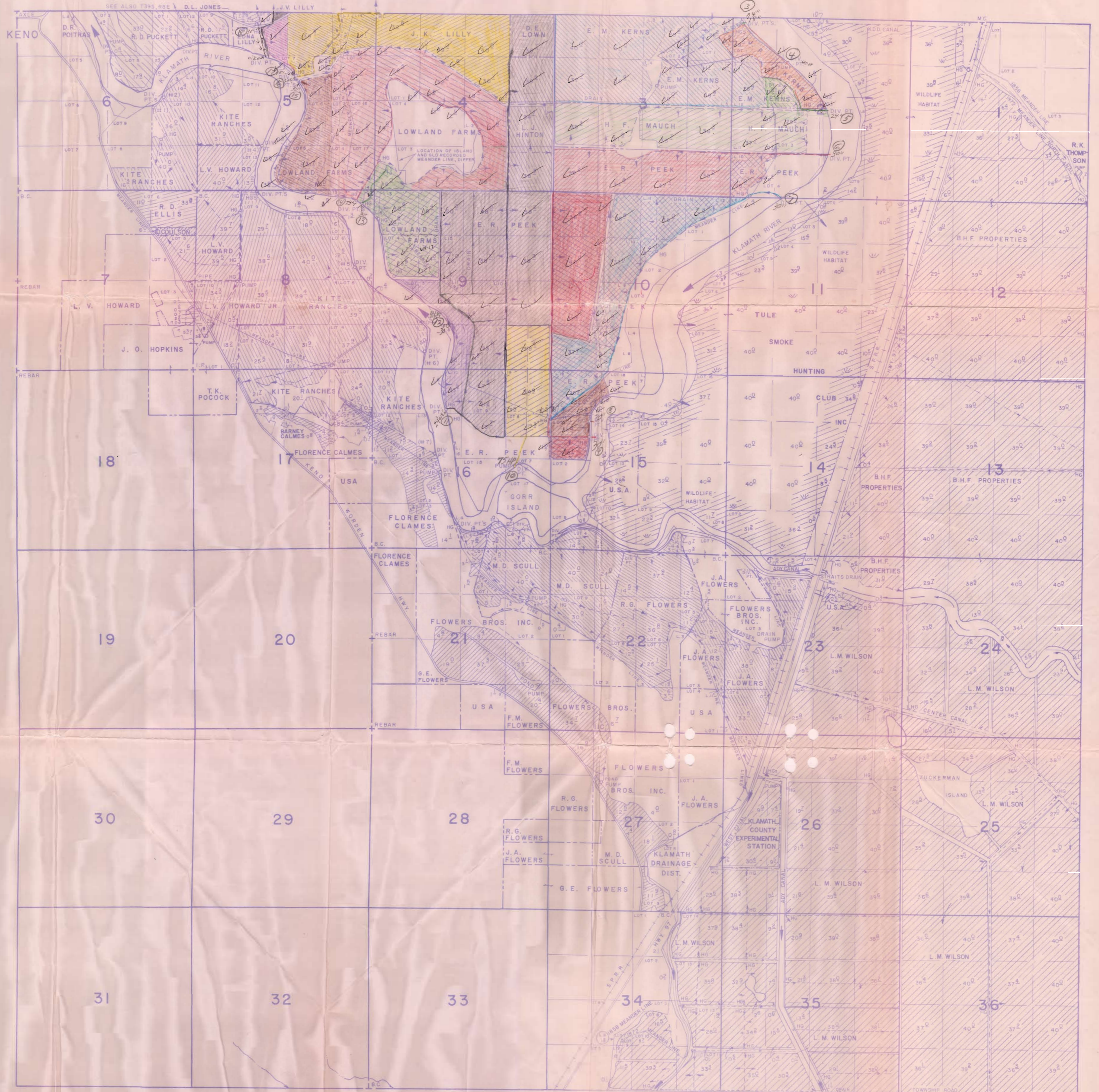

- D.V. PTS.
- J.K. LILLY - 149.4 } 232.4 } 30" (16)
 - LOWLAND FARMS - 83
 - LOWLAND FARMS - 14.5 } 18" (17)
 - LOWLAND FARMS - 302.3 } 24" (14)
 - LOWLAND FARMS - 89.9 } 30" (15)
 - LOWLAND FARMS - 119.8 } 30" (13)
 - DE. LOWN - 38.7 } 513.7 } 24" + 18" (11)
 - L.J. HINTON - 111.6
 - E.R. PEEK - 363.4
 - H.F. MAUCH - 200.8 } 219.2 } 24" (5)
 - E.M. KERNS - 18.4
 - E.M. KERNS - 329.7 } 24" + 18" (3)
 - J.P. KERNS - 50 } 40 HP (4)
 - ER. PEEK - 47.3 } 30" (12)
 - ER PEEK - 97 } 75 HP (10)
 - ER PEEK - 147.1 } 30" (7)
 - ER PEEK - 32.8 } 30" (8)
 - ER PEEK - 238 } 30" (1)
 - ER PEEK - 175.9 } 30" (6)
- TOTAL 2609.6 AC