

RECEIVED

JAN 22 2013

WATER RESOURCES DEPT
SALEM, OREGON

Kemmer T 8S R 24E Section 5 & 6 Tax Lot 700

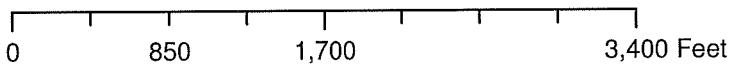
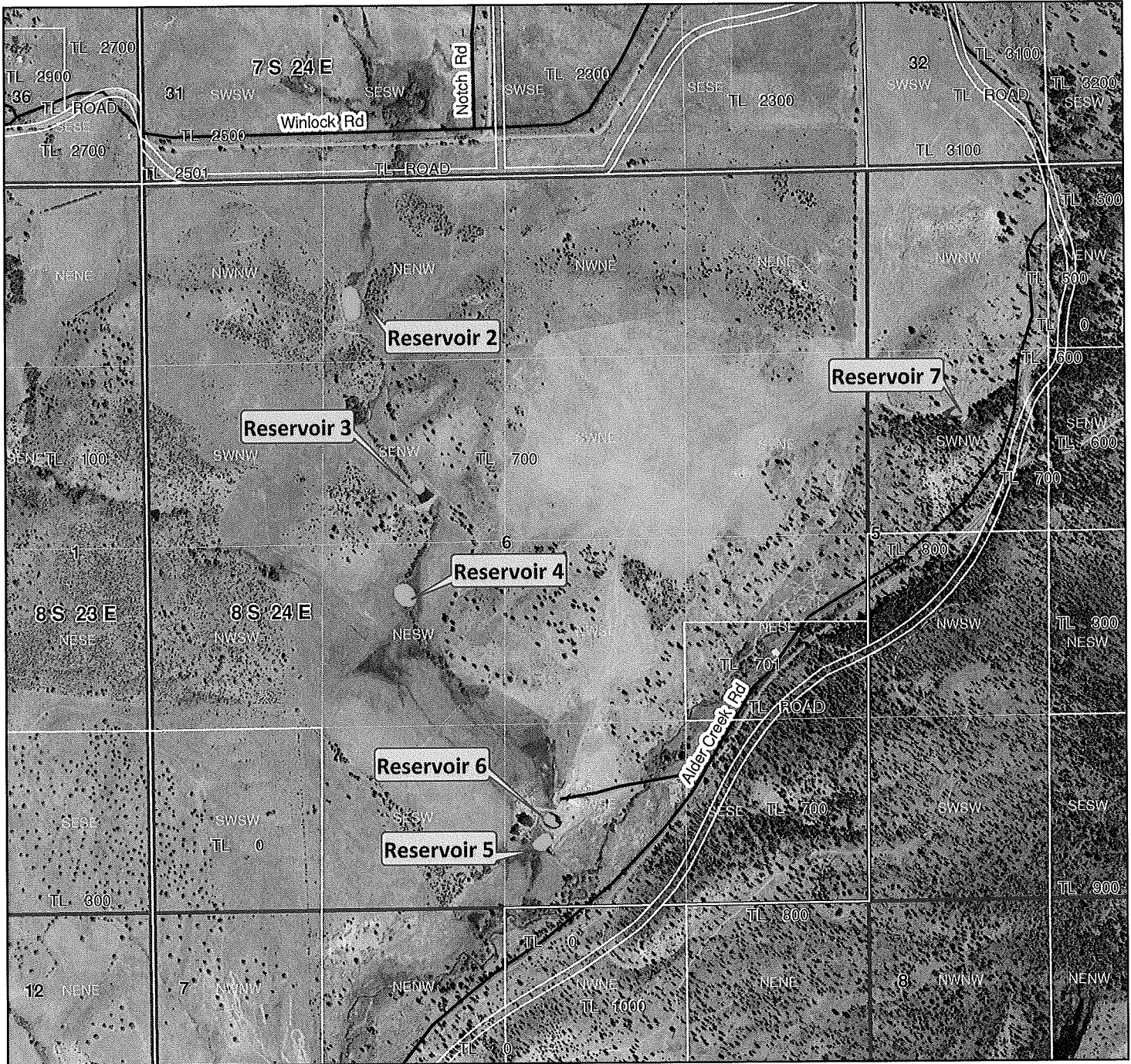

1 inch = 1,000 feet

This product is for informational purposes and may not have been prepared for, or be suitable for legal, engineering, or surveying purposes. Users of this information should review or consult the primary data and information sources to ascertain the usability of the information.



- = Reservoir 5: SWSE of Section 6 T8S R24E WM; Center of Reservoir- 455 feet North and 2300 feet West from the SE corner of Section 6
- = Reservoir 6: SWSE of Section 6 T8S R24E WM; Center of Reservoir- 610 feet North and 2250 feet West from the SE corner of Section 6
- = Reservoir 7: SWNW of Section 5 T8S R24E WM; Center of Reservoir- 1710 feet South and 655 feet East from the NE corner of Section 6

App R-87284

Kerry Kavanagh

From: Ken Thiemann <kenneth.c.thiemann@state.or.us>
Sent: Tuesday, January 22, 2013 9:21 AM
To: Kerry L Kavanagh
Subject: alt res apps R-87282 (Reservoir 5) and R-87284 (Reservoir 7) - James Kemmer -- wrong coordinates
Attachments: Revised Kemmer_080826d.pdf

Good morning Kerry,

I hope this clears things up. It was Joel Clark who was working with Mr. Kemmer. I will give you a call to follow up.

Ken Thiemann

Watermaster, District #21
Oregon Water Resources Department
PO Box 427
Condon, OR 97823
Ph: (541) 384-4207
Fax: (541) 384-2166
Gilliam Court House
221 S. Oregon St., Suite 221
Condon, OR 97823

RECEIVED

JAN 22 2013

WATER RESOURCES DEPT
SALEM, OREGON