

RECEIVED

NOV 18 1975

WATER RESOURCES DEPT.
SALEM, OREGONSTATE OF OREGON
COUNTY OF WALLOWA

Proof of Appropriation of Water

JAMES D. TIPPETT

of ¹⁴¹ Route 1, Box ~~2~~, Joseph, State of ⁹⁷⁸⁴⁶ Oregon,
has applied beneficially the waters of
Wallowa Lake

a tributary of **Wallowa River** for the purpose of
irrigation of 34.5 acres

under Permit No. **31280** of the State Engineer, and that the use of said waters has been
completed under the terms of said permit; that the priority of the
right dates from **March 7, 1966**

that the amount of water for the purposes aforesaid, has been actually beneficially used in the
amount of
0.86 cubic foot per second

or its equivalent in case of rotation, measured at the point of diversion from the stream.
The point of diversion is located in the **Lot 5 (NW $\frac{1}{4}$ NW $\frac{1}{4}$), Section 5, T. 3 S., R. 45 E., W. M.,
620 feet South and 600 feet East from NW Corner, Section 5.**

The amount of water used for irrigation, together with the amount secured under any other
right existing for the same lands, shall be limited to **one-fortieth** of one cubic foot per second
per acre, or its equivalent for each acre irrigated and shall be further limited to
a diversion of not to exceed **3 $\frac{1}{4}$ acre feet per acre for each acre irrigated during
the irrigation season of each year;**

and shall
conform to such reasonable rotation system as may be ordered by the proper state officer.

A description of the place of use under the right, and to which such right is appurtenant, is
as follows:

**6.0 acres SE $\frac{1}{4}$ SE $\frac{1}{4}$
Section 23**
**28.5 acres NE $\frac{1}{4}$ NE $\frac{1}{4}$
Section 26**
T. 2 S., R. 45 E., W. M.

I have read the above and foregoing proof of appropriation of water; I know the contents
thereof, and that the facts therein stated are true.

IN WITNESS WHEREOF, I have hereunto set my hand this 17 day of Nov.,

1975.

James D. Tippett

5M-
RECEIVED
MAR 7 1966
STATE ENGINEER
SALEM OREGON

Permit No.

***APPLICATION FOR PERMIT**

To Appropriate the Public Waters of the State of Oregon

I, James D. Tippet
(Name of applicant)

of Rt. 1 Box 62 Joseph
(Mailing address)

State of Oregon, do hereby make application for a permit to appropriate the following described public waters of the State of Oregon, **SUBJECT TO EXISTING RIGHTS:**

If the applicant is a corporation, give date and place of incorporation

1. The source of the proposed appropriation is Wallowa Lake Silver Lake Ditch Co.
(Name of stream)

via Silver Lake Ditch Co., a tributary of Comes from Wallowa Lake

2. The amount of water which the applicant intends to apply to beneficial use is
cubic feet per second. 1.5 (1 5/10)
(If water is to be used from more than one source, give quantity from each)

**3. The use to which the water is to be applied is Irrigation
(Irrigation, power, mining, manufacturing, domestic supplies, etc.)

4. The point of diversion is located 2180 ft. N and 1320 ft. E from the SW
corner of Sec. 25
(N. or S.) (E. or W.)
(Section or subdivision)

(If preferable, give distance and bearing to section corner)

(If there is more than one point of diversion, each must be described. Use separate sheet if necessary)

being within the SE 1/4 of the SE 1/4 of Sec. 25, Tp. 2S
(Give smallest legal subdivision) (N. or S.)

R. 45 E, W. M., in the county of Wallowa
(E. or W.)

5. The Pipe to be 1260'
(Main ditch, canal or pipe line) (Miles or feet)

in length, terminating in the SE 1/4 of the SE 1/4 of Sec. 23, Tp. 2S
(Smallest legal subdivision) (N. or S.)

R. 45 E, W. M., the proposed location being shown throughout on the accompanying map.
(E. or W.)

DESCRIPTION OF WORKS

Diversion Works—

6. (a) Height of dam None feet, length on top feet, length at bottom

..... feet; material to be used and character of construction
(Loose rock, concrete, masonry, rock and brush, timber crib, etc., wasteway over or around dam)

(b) Description of headgate
(Timber, concrete, etc., number and size of openings)

(c) If water is to be pumped give general description 3x4-11 Single Stage
(Size and type of pump)

Close Coupled, End Suction Centrifugal 50hp Electric
(Size and type of engine or motor to be used, total head water is to be lifted, etc.)

GPM 675 @ 214 T.D.H.

*A different form of application is provided where storage works are contemplated.

**Application for permits to appropriate water for the generation of electricity, with the exception of municipalities, must be made to the Hydroelectric Commission. Either of the above forms may be secured, without cost, together with instructions by addressing the State Engineer, Salem, Oregon.

Canal System or Pipe Line—

7. (a) Give dimensions at each point of canal where materially changed in size, stating miles from headgate. At headgate: width on top (at water line) feet; width on bottom feet; depth of water feet; grade feet fall per one thousand feet.

(b) At miles from headgate: width on top (at water line) feet; width on bottom feet; depth of water feet; grade feet fall per one thousand feet.

(c) Length of pipe, 1260' ft.; size at intake, 8" in.; size at 660' ft. from intake 6" in.; size at place of use 8" + 6" in.; difference in elevation between intake and place of use, 758' to 12' ft. Is grade uniform? No Estimated capacity, 1.5 (5/10) sec. ft.

8. Location of area to be irrigated, or place of use

Township North or South	Range E. or W. of Willamette Meridian	Section	Forty-acre Tract	Number Acres To Be Irrigated
2S	45 E	23	SE 1/4 of the SE 1/4	10
2S	45 E	26	NE 1/4 of the NE 1/4	23

(If more space required, attach separate sheet)

(a) Character of soil Loam

(b) Kind of crops raised Pasture - alfalfa - Grass - Wheat

Power or Mining Purposes—

9. (a) Total amount of power to be developed theoretical horsepower.

(b) Quantity of water to be used for power sec. ft.

(c) Total fall to be utilized feet.
(Head)

(d) The nature of the works by means of which the power is to be developed

(e) Such works to be located in of Sec.
(Legal subdivision)

Tp., R., W. M.
(No. N. or S.) (No. E. or W.)

(f) Is water to be returned to any stream? No
(Yes or No)

(g) If so, name stream and locate point of return

....., Sec., Tp., R., W. M.
(No. N. or S.) (No. E. or W.)

(h) The use to which power is to be applied is

(i) The nature of the mines to be served

Municipal or Domestic Supply—

10. (a) To supply the city of

..... County, having a present population of
(Name of)

and an estimated population of in 19.....

(b) If for domestic use state number of families to be supplied

(Answer questions 11, 12, 13, and 14 in all cases)

11. Estimated cost of proposed works, \$ 4,880

12. Construction work will begin on or before 1 Oct. 65

13. Construction work will be completed on or before 1 June 66

14. The water will be completely applied to the proposed use on or before 1 July 66

James D. Trappell
(Signature of applicant)

Remarks:

STATE OF OREGON, }
County of Marion, } ss.

This is to certify that I have examined the foregoing application, together with the accompanying maps and data, and return the same for completion

In order to retain its priority, this application must be returned to the State Engineer, with corrections on or before May 11, 1966

WITNESS my hand this 11th day of March, 1966

RECEIVED
APR 12 1966
STATE ENGINEER
SALEM OREGON

CHRIS L. WHEELER
STATE ENGINEER
By Larry W. [Signature]
ASSISTANT

PERMIT

STATE OF OREGON, }
County of Marion, } ss.

This is to certify that I have examined the foregoing application and do hereby grant the same, SUBJECT TO EXISTING RIGHTS and the following limitations and conditions:

The right herein granted is limited to the amount of water which can be applied to beneficial use and shall not exceed cubic feet per second measured at the point of diversion from the stream, or its equivalent in case of rotation with other water users, from

The use to which this water is to be applied is

If for irrigation, this appropriation shall be limited to of one cubic foot per second or its equivalent for each acre irrigated

and shall be subject to such reasonable rotation system as may be ordered by the proper state officer.

The priority date of this permit is

Actual construction work shall begin on or before and shall thereafter be prosecuted with reasonable diligence and be completed on or before October 1, 19.....

Complete application of the water to the proposed use shall be made on or before October 1, 19.....

WITNESS my hand this day of, 19.....

STATE ENGINEER

Application No. 41741

Permit No.

PERMIT

TO APPROPRIATE THE PUBLIC WATERS OF THE STATE OF OREGON

This instrument was first received in the office of the State Engineer at Salem, Oregon, on the 7th day of March, 1966, at 8 o'clock P. M.

Returned to applicant:

Signature

Approved:

Recorded in book No. of

Permits on page

STATE ENGINEER

Drainage Basin No. 8 page 38A

Fees

41741
41742

February 15, 1967

James D. Tippet
Route 1, Box 62
Joseph, Oregon

Dear Mr. Tippet:

This will acknowledge receipt of your letter dated February 13, 1967, in regards to water right permits numbered 31280 and 31281.

I am sorry that we overlooked acknowledging your notice of complete application of water for permit number 31281, although you had previously indicated this project was complete when you filed your application.

Both of your permits are scheduled for the customary final proof survey to be made at a later date.

Very truly yours,

CHRIS L. WHEELER
State Engineer

By
Myron V. Bish
Assistant

MVB:pju

James D. Tippet
Joseph, Oregon
13 Feb. 67

Chris L. Wheeler
State Engineer
Salem, Oregon

RECEIVED
FEB 14 1967
STATE ENGINEER
SALEM OREGON

Dear Sir;

In reference to file No. 41741 and permit No. 31280, which you have approved to inspectors I also included application No. 41742 & permit No. 31281 but only the first No. 41741 & 31280 has been approved.

I wrote a letter with form C, but apparently it was over looked, asking if I should file a separate form C. I did not hear back concerning this matter and want to get the second application & permit finalized.

I would appreciate an answer concerning this matter

Very truly yours,

James D. Tippet

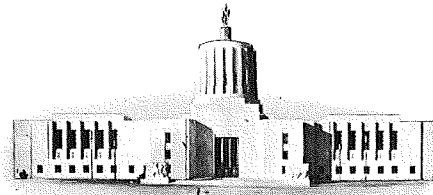

STATE OF OREGON
STATE ENGINEER
516 PUBLIC SERVICE BUILDING
SALEM 10

REFER TO
FILE NO. 41741

February 6, 1967

James D. Tippet
Route 1, Box 62
Joseph, Oregon

Gentlemen:

This will acknowledge receipt of your notice to the effect that complete application of water has been made under permit No. 31280

Pursuant to your report and in line with the general practice of this office, a survey will be made at a later date.

After this survey, proof may be made and certificate issued covering the actual use of water as found by the engineer. In case of irrigation, any lands described in the permit that have not been irrigated will be automatically eliminated from the water right.

In the meantime, the permit which you hold will be valid evidence of the water right in question so long as you continue to use the water.

Very truly yours,

CHRIS L. WHEELER
State Engineer

Form 128

ks

41741
41742

November 17, 1966

James D. Tippet
Route 1, Box 62
Joseph, Oregon

Dear Mr. Tippet:

41741, Permit No. 31280, Application
No. 41742, Permit No. 31281 with blueprints and our refund check No. 1344 in the amount
of \$5.25.

41741

May 18, 1966

Mr. James D. Tippett
Rt. 1, Box 62
Joseph, Oregon

Dear Mr. Tippett:

This will acknowledge receipt of your letter of
May 11, 1966 authorizing the amendment of item No. 4.
This has been done.

Your application is now in satisfactory form for
approval by issuance of a permit.

Very truly yours,

CHRIS L. WHEELER
State Engineer

By
Larry W. Jebousek
Assistant

LWJ:dly

James D. Trippett

Rt. 1 Box 62

Joseph, Oregon

RECEIVED
MAY 11 1906
STATE ENGINEER
SALEM OREGON

State Engineer
Salem, Oregon

Dear Sir;

In reference to application No. 41741 concerning amending item four (4) to show the actual point of division to be 1320 feet south and 1320 feet east from the NW¹/₄ corner of Section 5 being within lot 5 (NW¹/₄ NW¹/₄ of Section 5, Township 3 S, Range 45 E).

I hereby give you my permission to make this amendment.

Very truly yours,

James D. Trippett

May 5, 1966

James D. Tippet
Route 1, Box 62
Joseph, Oregon

Dear Mr. Tippet:

We have confirmed your right to carrying capacity in the Silver Lake Ditch Company for this application.

Item No. 4 must now be amended to show the actual point of diversion of the Silver Lake Ditch Company. Our records indicate this to be 1320 feet South and 1320 feet East from the NW $\frac{1}{4}$ corner of Section 5 being within Lot 5 (NW $\frac{1}{4}$ NW $\frac{1}{4}$ of Section 5, Township 3 S, Range 45 E).

If you would give us written authorization to make this amendment to Item No. 4, your application would then be in satisfactory form.

Very truly yours,

CHRIS L. WHITMAN
State Engineer

By
Larry W. Jebousek
Assistant

LWJ:hls

WILSON & WILSON
ATTORNEYS AT LAW
JOSEPH, OREGON

April 29, 1966

MAX WILSON
M. KEITH WILSON

RECEIVED
MAY 3 1966
STATE ENGINEER
SALEM OREGON

State Engineer,
Water Resources Department,
Salem 10, Oregon.

Gentlemen,

In a telephone conversation the matter of the application of J. D. Tippet for supplemental water was discussed. As previously advised he owns two shares of stock in the Silver Lake Ditch Company. The stock has no relation to the amount of water, to which he is entitled, only giving him a right to be heard in ditch company business.

The company has approved this application for excess water, and Mr. Tippet has sufficient interest in the ditch and the company to warrant the application.

Yours very truly,

Max Wilson.
Secretary

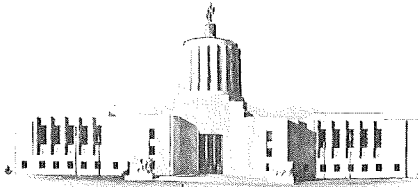

STATE OF OREGON
STATE ENGINEER
WATER RESOURCES DEPARTMENT
516 PUBLIC SERVICE BUILDING
SALEM 97310

REFER TO
FILE NO. 41741

April 14, 1966

RECEIVED
APR 25 1966
STATE ENGINEER
SALEM OREGON

Mr. Max Wilson
Attorney at Law
Joseph, Oregon

Dear Mr. Wilson:

Would you please confirm the number of shares owned and the number of acres to be irrigated in the Silver Lake Ditch Company by James D. Tippett?

Very truly yours,

CHRIS L. WHEELER
State Engineer

By 
Larry W. Jebousek
Assistant

LWJ:dly

85.5 acres to be irrigated
Owns 2 shares of stock.

James D. Tippetts
Joseph, Oregon
22 Apr. 1966

RECEIVED
APR 25 1966
STATE ENGINEER
SALEM OREGON

State Engineer
516 Public Service Bldg.
Salem, Oregon

No 41741

Dear Sir;

In answer to your letter of 14 Apr. I did not know what you meant by a legal description.

I checked with the county water master and went over his ~~actions~~ records and found the exact acreage.

In section 23, T. 28 R. 45 E there are already water rights on 32 acres and my application applies for water rights on the remaining 8 acres.

In section 26 T. 28, R. 45 E there are already water rights on 13.5 acres and my application applies for water rights on the remaining 26.5 acres.

I hope this will be the information you want, if not please be more specific as to what you would like in the way of a legal description.

I am enclosing a new application form to comply with the exact acreage

April 14, 1966

Mr. Max Wilson
Attorney at Law
Joseph, Oregon

Dear Mr. Wilson:

Would you please confirm the number of shares owned and the number of acres to be irrigated in the Silver Lake Ditch Company by James D. Tippet?

Very truly yours,

CHRIS L. WHEELER
State Engineer

By
Larry W. Jebousek
Assistant

LWJ:dly

April 14, 1966

Mr. James D. Tippet
Route 1, Box 62
Joseph, Oregon

Dear Mr. Tippet:

This will acknowledge your returned superseding application No. 41741, amending item No. 1 to show the source of appropriation as Wallowa Lake.

This application has received a new priority date of March 7, 1966.

It is difficult to check this application for adjoining water rights. Would you please send us a copy of the legal description for the land on which you are applying to assist us in this matter.

Very truly yours,

CHRIS L. WHEELER
State Engineer

By
Larry W. Jebousek
Assistant

LWJ:dly

41741
41741

March 11, 1966

James D. Tippet
Route 1, Box 62
Joseph, Oregon

Dear Sir:

This will acknowledge the receipt of a superseding application and map.

The original application form must be returned to this office on or before April 19, 1966, in order for it to retain its date of priority.

Item 1 on the superseding application indicates the source as Silver Lake Ditch Company, which is not as such subject to appropriation. Item 1 must clearly define the actual source of the water you wish to appropriate.

I am returning the superseding application and map for completion. The application is endorsed so that in order to retain its date of priority it must be returned to this office on or before May 11, 1966.

Very truly yours,

CHRIS L. WHEELER
State Engineer

By
Larry W. Jebousek
Assistant

LWJ;bs
Enclosures

41741
41742

February 18, 1966

Mr. James D. Tippet
Route 1, Box 62
Joseph, Oregon

Dear Mr. Tippet:

This will acknowledge receipt of returned Application Nos. 41741 and 41742 and the accompanying map.

Your Application No. 41742 is in satisfactory form for approval by issuance of a permit.

If I understand the letter from Mr. Wilson correctly, your source of appropriation in Application No. 41741 is actually waste water from the Silver Lake Ditch Company. If this is so, you should so indicate on Item 1 of the application.

You should file only on the new land on this application. The number of acres to be irrigated in each forty must be shown on the map and their location described in Item 8 of the application.

I am returning your Application No. 41741 and map for completion. The application is endorsed so that in order to retain its date of priority it must be returned to this office on or before April 18, 1966.

Very truly yours,

CHRIS L. WHEELER
State Engineer

By
Larry W. Jebousek
Assistant

LWJ:jb

Enclosures

James D. Tippels
Rt. 1 Box 62
Joseph, Oregon
7 Feb. 1966

State Engineer
516 Public Service Bldg.
Salem, Oregon 97310

RECEIVED
FEB. 9 1966
STATE ENGINEER
SALEM OREGON

Dear Sir;

Enclosed please find my application for water rights with the changes and additions you asked for.

In the letter from Max Wilson, secretary of the Silver Lake Ditch Co., he states that I will have a total of 158.5 acres that the ditch Co. will furnish water for. Actually I only have 120 total acres, less county road and will only bring 33 new acres under irrigation.

Perhaps I have made out my application No 41741 incorrectly to begin with. I have water rights on the acres previously irrigated and only need water rights on the 33 new acres which have never been irrigated. This I have shown on the map. If this correction is necessary, or any other correction or addition, please notify me.

Very truly yours,

James D. Tippels

WILSON & WILSON
ATTORNEYS AT LAW
JOSEPH, OREGON

MAX WILSON
M. KEITH WILSON

RECEIVED
FEB 9 1966
STATE ENGINEER
SALEM OREGON

Jan 31, 1966

Mr. J. D. Tippet
Joseph
Oregon

Dear Sir:

In regard to your application to sprinkle 70 acres of your lands with water carried by the Silver Lake Ditch Company, I will advise that the company has not adopted any fixed policy as to sprinkling additional lands lying adjacent to its ditch. In practice, however, it has been the custom to carry water for this purpose, so long as the additional lands do not require any enlargement of the ditch facilities. In line with this practice the company will permit the use of its ditch for you to carry the additional water unless it should appear that some enlargement of the ditch would be necessary. This does not appear to be the case here, since the additional water is, as I understand the matter, waste water, and is not carried in the ditch for a long distance. You have two shares of stock in this company which means that you are entitled to ditch space for carrying the water. It also means that you have a proportionate share of the storage waters in Wallowa Lake. Your lands have been adjudicated this storage right and the right is not determined by stock ownership. You will have, when this right has been established 155.5 acres irrigated under this ditch. The rate for the additional acreage is the same per acre as the flooded lands.

Yours very truly,

Max Wilson

Secy.

41741
41742

January 11, 1966

James D. Tippet
Route 1, Box 62
Joseph, Oregon

Dear Sir:

This will acknowledge your application for a permit to appropriate 1.5 cubic feet of water per second from the Silver Lake Ditch Co. for the irrigation of 70.0 acres, the accompanying map, and fees of \$21 for which our receipt No. 7988 is enclosed. The application has been filed and numbered 41741.

Also acknowledged is your application for a permit to appropriate 1.1 cubic feet of water per second from the Snake River for the irrigation of 25.0 acres, the accompanying map, and fees of \$15 for which our receipt No. 7989 is enclosed. The application has been filed and numbered 41742.

Item 1 on application No. 41741 must state the actual source of water. If the water is to be carried in the Silver Lake Ditch Co. ditch, a letter from the Co. stating their permission for you to carry this water in the ditch is required. If it is to be stored water in Wallowa Lake, sufficient interest in the reservoir will have to be shown before we can approve the application.

The actual point of diversion from its source must be shown on the map and described in Item 4 on the application in reference to a government survey corner.

The map must show which area within the forties is to be irrigated. This may be done by cross hatching the land to be irrigated on the map.

The land to be irrigated as applied for in application No. 41742 must be clearly shown on the map indicating the number of acres in each forty and correspond to Item 8 on the application.

Your applications and maps are returned for completion. The applications have been endorsed so that in order to retain their dates of priority they must be returned to this office on or before March 11, 1966.

Very truly yours,

CHRIS L. WHEELER
State Engineer

By
Larry W. Jebousek, Assistant

LWJ:bs
Enclosures

December 17, 1965

James D. Tippet
Route 1, Box 62
Joseph, Oregon

Dear Sir:

This will acknowledge your application for a permit to appropriate 1.5 cubic feet of water per second from Prairie Creek for the irrigation of 70.0 acres.

Also acknowledged is your application for a permit to appropriate 1.1 cubic feet of water per second from the Snake River for the irrigation of 25.0 acres.

These applications cannot be filed because the required fees were not submitted. The application to appropriate water from the Snake River requires a fee of \$15. The application to appropriate water from Prairie Creek requires a fee of \$21.

Item 4 on the Prairie Creek application must show to which corner of Section 23 the diversion point is referenced.

A map prepared on tracing paper or cloth is required for each application so they may be easily reproduced. They must be drawn to a scale of not less than four inches equal to the mile.

The applications must be completed in ink. New forms are enclosed for your convenience.

Very truly yours,

CHRIS L. WHEELER
State Engineer

By
Larry W. Jebousek, Assistant

LWJ:bjs
Enclosures

James D. Tippetts
Rt. 1 Box 62

Joseph, Oregon 99846

2 Feb. 1967

State Engineer
Salem, Oregon

RECEIVED
FEB 3 1967
STATE ENGINEER
SALEM OREGON

Dear Sir;

Since you only sent one form C to be filled out
& put both permits on the one form.

I have finished all construction and water has
been applied to all the land under each permit.

Should you want a form C for each permit,
please send me two forms & I will fill
out one for each.

Very truly yours,

James D. Tippetts

[Redacted]

James D. Tippetts
Rt. 1 Box 62
Joseph, Oregon

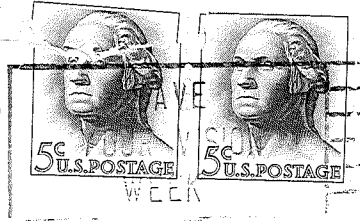

James D. Tippetts

State Engineer
516 Public Service Bldg.
Salem, Oregon

97310

T. 2 S. R. 45 E. W.M

Wallowa County

1" = 1/4 mi.

Application No 41741

Application No. 41741
Permit No. 31280

Application No. 41741
Permit No. 31280

23

24

Direction of mainline ←

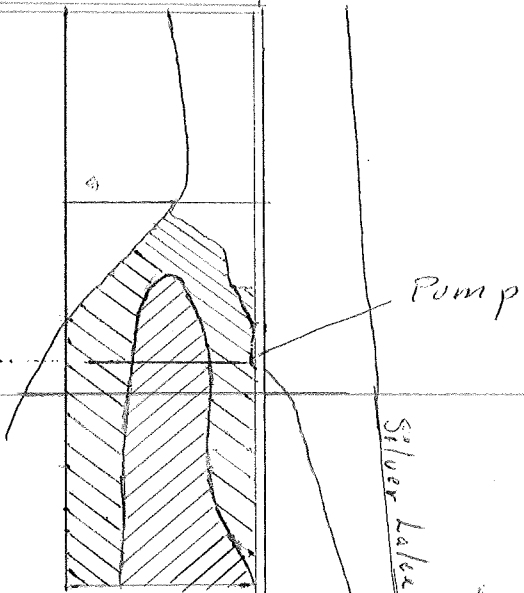

RECEIVED
APR 12 1966
STATE ENGINEER
SALEM OREGON

26

25

Under sprinkler
prior water rights 37 Acres

Point of diversion from
Silver Lake Ditch

new land to be irrigated (sprinkler)
prior water rights 33 Acres

RECEIVED
FEB 9 1966
STATE ENGINEER
SALEM OREGON

RECEIVED
MAR 7 1966
STATE ENGINEER
SALEM OREGON

BBA-3MM-98
 B-4-73
 R.G.M.

6 8

23340

2519

00 402

Abstract of Permit No. 31220

Application No. 41741 Certificate No.

Name James D. Tippet
 Address Rt. 1, Box 62 Joseph, Oregon ~~97846~~ 2644
 Source of water supply Wallowa Lake Trib Wallowa Riv.
 Use Irrigation of 34⁵ AC
 Point of diversion ~~1320' S. & 1320' E. from NW cor. Sec. 5, being within Lot 5 (NW1/4); Sec. 5, T. 3 S., R. 45 E., N.H., county of Wallowa~~
 Number of acres ~~24.5~~ 620' S & 600' E from NW Cor., Sec. 5.

DESCRIPTION OF LAND TO BE IRRIGATED OR PLACE OF USE

Twp.	Range	Sec.	NE ¹ / ₄				NW ¹ / ₄				SW ¹ / ₄				SE ¹ / ₄			
			NE ¹ / ₄	NW ¹ / ₄	SW ¹ / ₄	SE ¹ / ₄	NE ¹ / ₄	NW ¹ / ₄	SW ¹ / ₄	SE ¹ / ₄	NE ¹ / ₄	NW ¹ / ₄	SW ¹ / ₄	SE ¹ / ₄	NE ¹ / ₄	NW ¹ / ₄	SW ¹ / ₄	SE ¹ / ₄
25	45E	23										Found	Existing Rights				Allowed	
		23	SE ¹ / ₄	SE ¹ / ₄						36 ⁴		27 ⁶					6 ⁹	
		26	NE ¹ / ₄	NE ¹ / ₄						42 ⁹		13 ⁵					28 ⁵	
																	34 ⁵	

Priority date March 7, 1966
 Amount of water 0.86 c.f.s.
 Time limit to begin construction ~~October 25, 1967~~
 Time limit to complete construction ~~10-1-68~~ extended to extended to
 Time limit to completely apply water ~~10-1-69~~ extended to extended to

Remarks: This appropriation shall be limited to 1/40th of one cubic foot per second or its equivalent for each acre irrigated and shall be further limited to a diversion of not to exceed 3/4 acre feet per acre for each acre irrigated during the irrigation season of each year, and shall be subject to such reasonable rotation system as may be ordered by the proper state officials.

Basin 3, Vol.

Info James TIPPETT



All land is irrigated. This filing is on the land above the old ditch, which he now irrigates by sprinkler. We surveyed all the land in. by in area of filing, N.E. area is irr. by an old ditch.

Divert from Silver Lake Ditch via a 12" corr. pipe & the pump. Have a wooden conduit under rd.

RE-DIV. - A 44" x 46" wood bridge in side of ditch

Div. - See old survey for Silver Lake Ditch Div. $\frac{(6.6)(50)}{115} = 2.87 cfs$

Pump - Goulds D.D. Cent 3" x 4" Rated @ 660 gpm @ 230' Head
1000 cfs

Motor - Westinghouse 50 HP @ 3550 R.P.M. P=115

Pipe 1/8 mi buried 8" MAIN & 1/8 MILE 6" BURIED MAIN f—
h—

Heads $3" \times 4" \rightarrow .67 \rightarrow 1.55 cfs$
 $\frac{7}{32} \times 0 \rightarrow .67$
 $\frac{7}{32} \times \frac{1}{8} \rightarrow .67$
 $9" \times 3" = 12" \rightarrow .88 ALL MAX.$
} 65 TOTAL RUNS APPROX 1/2 & 1/2"

L. ft - 0 TO +30'

Crop - alfalfa & pasture & potatoes

TIE - BBA - 3M4 - 98

NOTE How more pipe & head & runs more than 65 runs, but only that many by 1969.

8-4-73

F.E.

R.G. Musher

T. 2 S. R. 45 E. W.M

Wallowa County

1" = 1/4 mi.

Application No 41741

Application No.
Permit No.

Application No. 41741
Permit No 31280

23

24

Direction of mainline ←

Pump

Silver Lake Ditch

County Road

Point of diversion from
Silver Lake Ditch

26

25

 Under sprinkler
prior water rights 37 Acres

 New land to be irrigated (sprinkler)
No prior water rights 33 Acres

RECEIVED
APR 12 1966
STATE ENGINEER
SALEM OREGON

RECEIVED
FEB 9 1966
STATE ENGINEER
SALEM OREGON

RECEIVED
MAR 7 1966
STATE ENGINEER
SALEM OREGON