

Water Right Conditions Tracking Slip

Groundwater/Hydrology Section

FILE # # G-17586

ROUTED TO: Water Rights - Jenna

TOWNSHIP/
RANGE-SECTION: 10S/3W-1766

CONDITIONS ATTACHED?: [] yes [] no

REMARKS OR FURTHER INSTRUCTIONS:

Reviewer: Mike Zwart

WATER RESOURCES DEPARTMENT

MEMO

February 6, 2003

TO: Application G- 17586
FROM: GW: Mike Zwart (Reviewer's Name)
SUBJECT: Scenic Waterway Interference Evaluation

YES
The source of appropriation is within or above a Scenic Waterway
Checked NO

YES
Use the Scenic Waterway condition (Condition 7J)
Checked NO

Per ORS 390.835, the Ground Water Section is able to calculate ground water interference with surface water that contributes to a Scenic Waterway. The calculated interference is distributed below.

Per ORS 390.835, the Ground Water Section is unable to calculate ground water interference with surface water that contributes to a scenic waterway; therefore, the Department is unable to find that there is a preponderance of evidence that the proposed use will measurably reduce the surface water flows necessary to maintain the free-flowing character of a scenic waterway.

DISTRIBUTION OF INTERFERENCE

Calculate the percentage of consumptive use by month and fill in the table below. If interference cannot be calculated, per criteria in 390.835, do not fill in the table but check the "unable" option above, thus informing Water Rights that the Department is unable to make a Preponderance of Evidence finding.

Exercise of this permit is calculated to reduce monthly flows in Scenic Waterway by the following amounts expressed as a proportion of the consumptive use by which surface water flow is reduced.

Table with 12 columns: Jan, Feb, Mar, Apr, May, Jun, Jul, Aug, Sep, Oct, Nov, Dec. All cells are empty.

PUBLIC INTEREST REVIEW FOR GROUND WATER APPLICATIONS

TO: Water Rights Section Date February 6, 2013

FROM: Ground Water/Hydrology Section Michael Zwart
Reviewer's Name

SUBJECT: Application G- 17586 Supersedes review of _____
Date of Review(s)

PUBLIC INTEREST PRESUMPTION; GROUNDWATER

OAR 690-310-130 (1) *The Department shall presume that a proposed groundwater use will ensure the preservation of the public welfare, safety and health as described in ORS 537.525.* Department staff review ground water applications under OAR 690-310-140 to determine whether the presumption is established. OAR 690-310-140 allows the proposed use be modified or conditioned to meet the presumption criteria. **This review is based upon available information and agency policies in place at the time of evaluation.**

A. GENERAL INFORMATION: Applicant's Name: Cliff Machugh County: Linn

A1. Applicant(s) seek(s) 2.228 cfs from one well(s) in the Willamette Basin,
 _____ subbasin Quad Map: Albany

A2. Proposed use: Agriculture, 160 acres Seasonality: March 1 to November 30

A3. Well and aquifer data (attach and number logs for existing wells; mark proposed wells as such under logid):

Well	Logid	Applicant's Well #	Proposed Aquifer*	Proposed Rate(cfs)	Location (T/R-S QQ-Q)	Location, metes and bounds, e.g. 2250' N, 1200' E fr NW cor S 36
1	Proposed	1	Alluvium	2.228	10S/3W-17 NW-NW	150' S, 1320' E fr NW cor S 17
2						
3						
4						
5						

* Alluvium, CRB, Bedrock

Well	Well Elev ft msl	First Water ft bls	SWL ft bls	SWL Date	Well Depth (ft)	Seal Interval (ft)	Casing Intervals (ft)	Liner Intervals (ft)	Perforations Or Screens (ft)	Well Yield (gpm)	Draw Down (ft)	Test Type
1	200				60	?	0-20		20' screen			

Use data from application for proposed wells.

A4. **Comments:** Seal depth not stated, so I will presume 18 feet minimum legal depth.

A5. **Provisions of the Willamette** _____ Basin rules relative to the development, classification and/or management of ground water hydraulically connected to surface water are, or are not, activated by this application. (Not all basin rules contain such provisions.)
 Comments: _____

A6. **Well(s) #** _____, _____, _____, _____, _____, tap(s) an aquifer limited by an administrative restriction.
 Name of administrative area: _____
 Comments: _____

C. GROUND WATER/SURFACE WATER CONSIDERATIONS, OAR 690-09-040

C1. **690-09-040 (1):** Evaluation of aquifer confinement:

Well	Aquifer or Proposed Aquifer	Confined	Unconfined
1	Sand and gravel, likely Quaternary alluvium	<input type="checkbox"/>	<input checked="" type="checkbox"/>
		<input type="checkbox"/>	<input type="checkbox"/>
		<input type="checkbox"/>	<input type="checkbox"/>
		<input type="checkbox"/>	<input type="checkbox"/>
		<input type="checkbox"/>	<input type="checkbox"/>

Basis for aquifer confinement evaluation: The application proposes a shallow well with minimal casing and seal. Nearby wells similarly constructed have static water levels at or near the depth where groundwater was first encountered.

C2. **690-09-040 (2) (3):** Evaluation of distance to, and hydraulic connection with, surface water sources. All wells located a horizontal distance less than ¼ mile from a surface water source that produce water from an unconfined aquifer shall be assumed to be hydraulically connected to the surface water source. Include in this table any streams located beyond one mile that are evaluated for PSI.

Well	SW #	Surface Water Name	GW Elev ft msl	SW Elev ft msl	Distance (ft)	Hydraulically Connected?			Potential for Subst. Interfer. Assumed?	
						YES	NO	ASSUMED	YES	NO
1	1	Crooks Creek	180±	190	4100	<input checked="" type="checkbox"/>	<input type="checkbox"/>	<input type="checkbox"/>	<input type="checkbox"/>	<input checked="" type="checkbox"/>
1	2	Willamette River	180±	165±	10700	<input checked="" type="checkbox"/>	<input type="checkbox"/>	<input type="checkbox"/>	<input type="checkbox"/>	<input checked="" type="checkbox"/>
						<input type="checkbox"/>	<input type="checkbox"/>	<input type="checkbox"/>	<input type="checkbox"/>	<input type="checkbox"/>
						<input type="checkbox"/>	<input type="checkbox"/>	<input type="checkbox"/>	<input type="checkbox"/>	<input type="checkbox"/>
						<input type="checkbox"/>	<input type="checkbox"/>	<input type="checkbox"/>	<input type="checkbox"/>	<input type="checkbox"/>
						<input type="checkbox"/>	<input type="checkbox"/>	<input type="checkbox"/>	<input type="checkbox"/>	<input type="checkbox"/>
						<input type="checkbox"/>	<input type="checkbox"/>	<input type="checkbox"/>	<input type="checkbox"/>	<input type="checkbox"/>
						<input type="checkbox"/>	<input type="checkbox"/>	<input type="checkbox"/>	<input type="checkbox"/>	<input type="checkbox"/>
						<input type="checkbox"/>	<input type="checkbox"/>	<input type="checkbox"/>	<input type="checkbox"/>	<input type="checkbox"/>

Basis for aquifer hydraulic connection evaluation: The shallow aquifer is undoubtedly in hydraulic connection with local surface water sources and likely receives recharge from or discharges to those sources, depending on the seasonal head relationship.

Water Availability Basin the well(s) are located within: Willamette R > Columbia R ab Mill Cr at gage 14191000 (183).

C3a. **690-09-040 (4):** Evaluation of stream impacts for each well that has been determined or assumed to be hydraulically connected and less than 1 mile from a surface water source. Limit evaluation to instream rights and minimum stream flows that are pertinent to that surface water source, and not lower SW sources to which the stream under evaluation is tributary. Compare the requested rate against the 1% of 80% natural flow for the pertinent Water Availability Basin (WAB). If Q is not distributed by well, use full rate for each well. Any checked box indicates the well is assumed to have the potential to cause PSI.

Well	SW #	Well < ¼ mile?	Qw > 5 cfs?	Instream Water Right ID	Instream Water Right Q (cfs)	Qw > 1% ISWR?	80% Natural Flow (cfs)	Qw > 1% of 80% Natural Flow?	Interference @ 30 days (%)	Potential for Subst. Interfer. Assumed?
1	1	<input type="checkbox"/>	<input type="checkbox"/>	183	1300	<input type="checkbox"/>	3620	<input type="checkbox"/>	<25%	<input type="checkbox"/>
		<input type="checkbox"/>	<input type="checkbox"/>			<input type="checkbox"/>		<input type="checkbox"/>		<input type="checkbox"/>
		<input type="checkbox"/>	<input type="checkbox"/>			<input type="checkbox"/>		<input type="checkbox"/>		<input type="checkbox"/>
		<input type="checkbox"/>	<input type="checkbox"/>			<input type="checkbox"/>		<input type="checkbox"/>		<input type="checkbox"/>
		<input type="checkbox"/>	<input type="checkbox"/>			<input type="checkbox"/>		<input type="checkbox"/>		<input type="checkbox"/>
		<input type="checkbox"/>	<input type="checkbox"/>			<input type="checkbox"/>		<input type="checkbox"/>		<input type="checkbox"/>
		<input type="checkbox"/>	<input type="checkbox"/>			<input type="checkbox"/>		<input type="checkbox"/>		<input type="checkbox"/>
		<input type="checkbox"/>	<input type="checkbox"/>			<input type="checkbox"/>		<input type="checkbox"/>		<input type="checkbox"/>

C3b. **690-09-040 (4):** Evaluation of stream impacts by total appropriation for all wells determined or assumed to be **hydraulically connected and less than 1 mile** from a surface water source. **Complete only if Q is distributed among wells.** Otherwise same evaluation and limitations apply as in C3a above.

	SW #		Qw > 5 cfs?	Instream Water Right ID	Instream Water Right Q (cfs)	Qw > 1% ISWR?	80% Natural Flow (cfs)	Qw > 1% of 80% Natural Flow?	Interference @ 30 days (%)	Potential for Subst. Interfer. Assumed?
			<input type="checkbox"/>			<input type="checkbox"/>		<input type="checkbox"/>		<input type="checkbox"/>
			<input type="checkbox"/>			<input type="checkbox"/>		<input type="checkbox"/>		<input type="checkbox"/>
			<input type="checkbox"/>			<input type="checkbox"/>		<input type="checkbox"/>		<input type="checkbox"/>
			<input type="checkbox"/>			<input type="checkbox"/>		<input type="checkbox"/>		<input type="checkbox"/>

Comments: _____

C4a. **690-09-040 (5):** Estimated impacts on **hydraulically connected surface water sources greater than one mile** as a percentage of the proposed pumping rate. Limit evaluation to the effects that will occur up to one year after pumping begins. This table encompasses the considerations required by 09-040 (5)(a), (b), (c) and (d), which are not included on this form. Use additional sheets if calculated flows from more than one WAB are required.

Non-Distributed Wells													
Well	SW#	Jan	Feb	Mar	Apr	May	Jun	Jul	Aug	Sep	Oct	Nov	Dec
		%	%	%	%	%	%	%	%	%	%	%	%
Well Q as CFS													
Interference CFS													
Distributed Wells													
Well	SW#	Jan	Feb	Mar	Apr	May	Jun	Jul	Aug	Sep	Oct	Nov	Dec
		%	%	%	%	%	%	%	%	%	%	%	%
Well Q as CFS													
Interference CFS													
		%	%	%	%	%	%	%	%	%	%	%	%
Well Q as CFS													
Interference CFS													
		%	%	%	%	%	%	%	%	%	%	%	%
Well Q as CFS													
Interference CFS													
		%	%	%	%	%	%	%	%	%	%	%	%
Well Q as CFS													
Interference CFS													
		%	%	%	%	%	%	%	%	%	%	%	%
Well Q as CFS													
Interference CFS													
(A) = Total Interf.													
(B) = 80 % Nat. Q													
(C) = 1 % Nat. Q													
(D) = (A) > (C)													
(E) = (A / B) x 100		%	%	%	%	%	%	%	%	%	%	%	%

(A) = total interference as CFS; (B) = WAB calculated natural flow at 80% exceed. as CFS; (C) = 1% of calculated natural flow at 80% exceed. as CFS; (D) = highlight the checkmark for each month where (A) is greater than (C); (E) = total interference divided by 80% flow as percentage.

Basis for impact evaluation: _____

C4b. **690-09-040 (5) (b) The potential to impair or detrimentally affect the public interest is to be determined by the Water Rights Section.**

C5. **If properly conditioned**, the surface water source(s) can be adequately protected from interference, and/or ground water use under this permit can be regulated if it is found to substantially interfere with surface water:
i. The permit should contain condition #(s) _____;
ii. The permit should contain special condition(s) as indicated in "Remarks" below;

C6. **SW / GW Remarks and Conditions** _____

References Used: Gannett, Marshall W., and Caldwell, Rodney R., 1998, Geologic Framework of the Willamette Lowland Aquifer System, Oregon and Washington: U. S. Geological Survey Professional Paper 1424-A, 32p, 8 plates.

Conlon and others, 2005, Ground-water hydrology of the Willamette Basin, Oregon: U.S Geological Survey Scientific Investigations Report 2005-5168.

Woodward and others, 1998, Hydrogeologic framework of the Willamette lowland aquifer system, Oregon and Washington: U.S. Geological Survey Professional Paper 1424-B,

D. WELL CONSTRUCTION, OAR 690-200

D1. Well #: _____ Logid: _____

D2. **THE WELL does not meet current well construction standards based upon:**

- a. review of the well log;
- b. field inspection by _____;
- c. report of CWRE _____;
- d. other: (specify) _____

D3. **THE WELL construction deficiency:**

- a. constitutes a health threat under Division 200 rules;
- b. commingles water from more than one ground water reservoir;
- c. permits the loss of artesian head;
- d. permits the de-watering of one or more ground water reservoirs;
- e. other: (specify) _____

D4. **THE WELL construction deficiency is described as follows:** _____

D5. **THE WELL** a. was, or was not constructed according to the standards in effect at the time of original construction or most recent modification.

b. I don't know if it met standards at the time of construction.

D6. **Route to the Enforcement Section.** I recommend withholding issuance of the permit until evidence of well reconstruction is filed with the Department and approved by the Enforcement Section and the Ground Water Section.

THIS SECTION TO BE COMPLETED BY ENFORCEMENT PERSONNEL

D7. Well construction deficiency has been corrected by the following actions: _____

_____, 200_____
(Enforcement Section Signature)

D8. **Route to Water Rights Section (attach well reconstruction logs to this page).**

Application G-17586, Cliff MacHugh

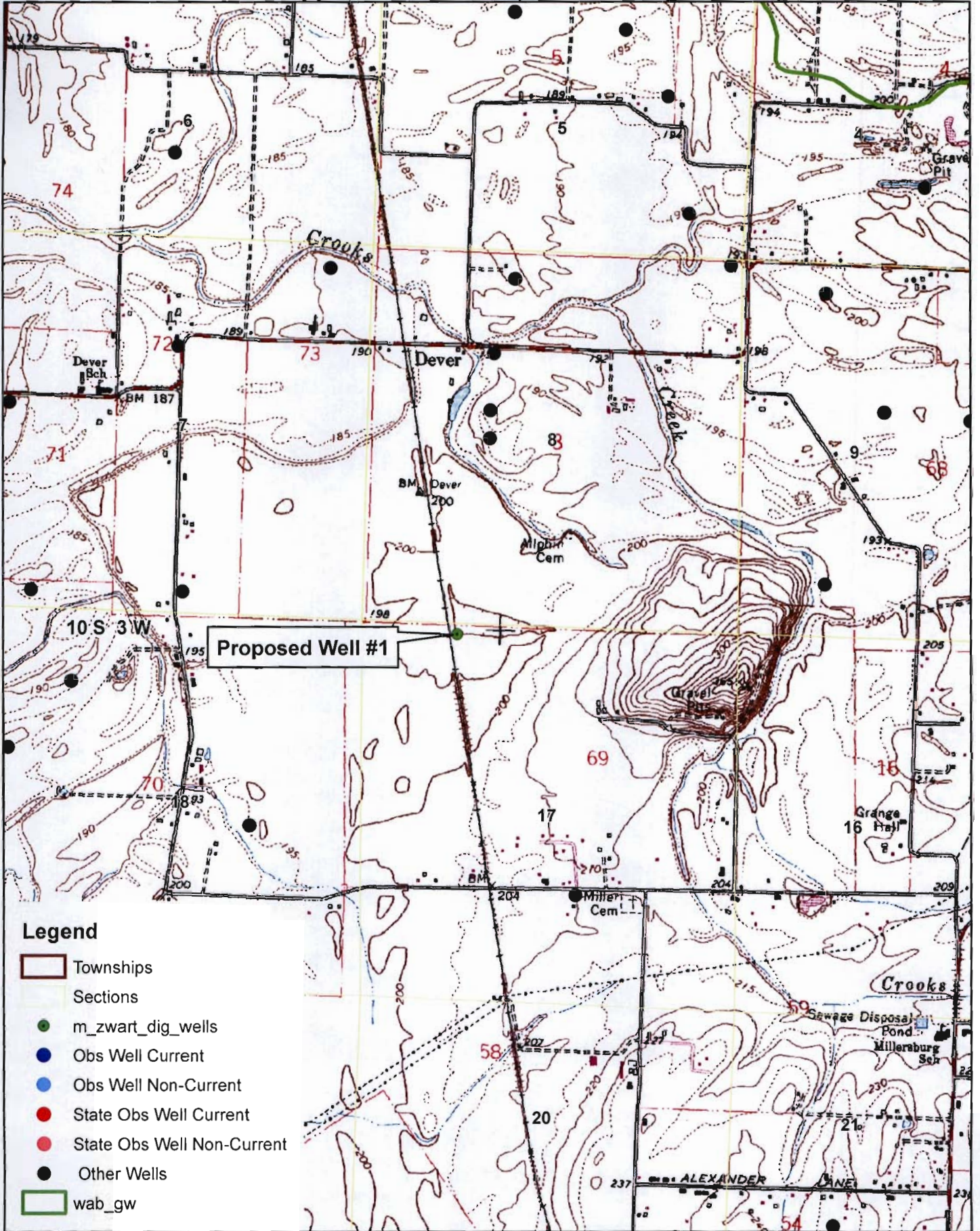

Legend

- Townships
- Sections
- m_zwart_dig_wells
- Obs Well Current
- Obs Well Non-Current
- State Obs Well Current
- State Obs Well Non-Current
- Other Wells
- wab_gw

