

# T.5S. R.3W. Sections 3, 4, 9, and 10, W.M.

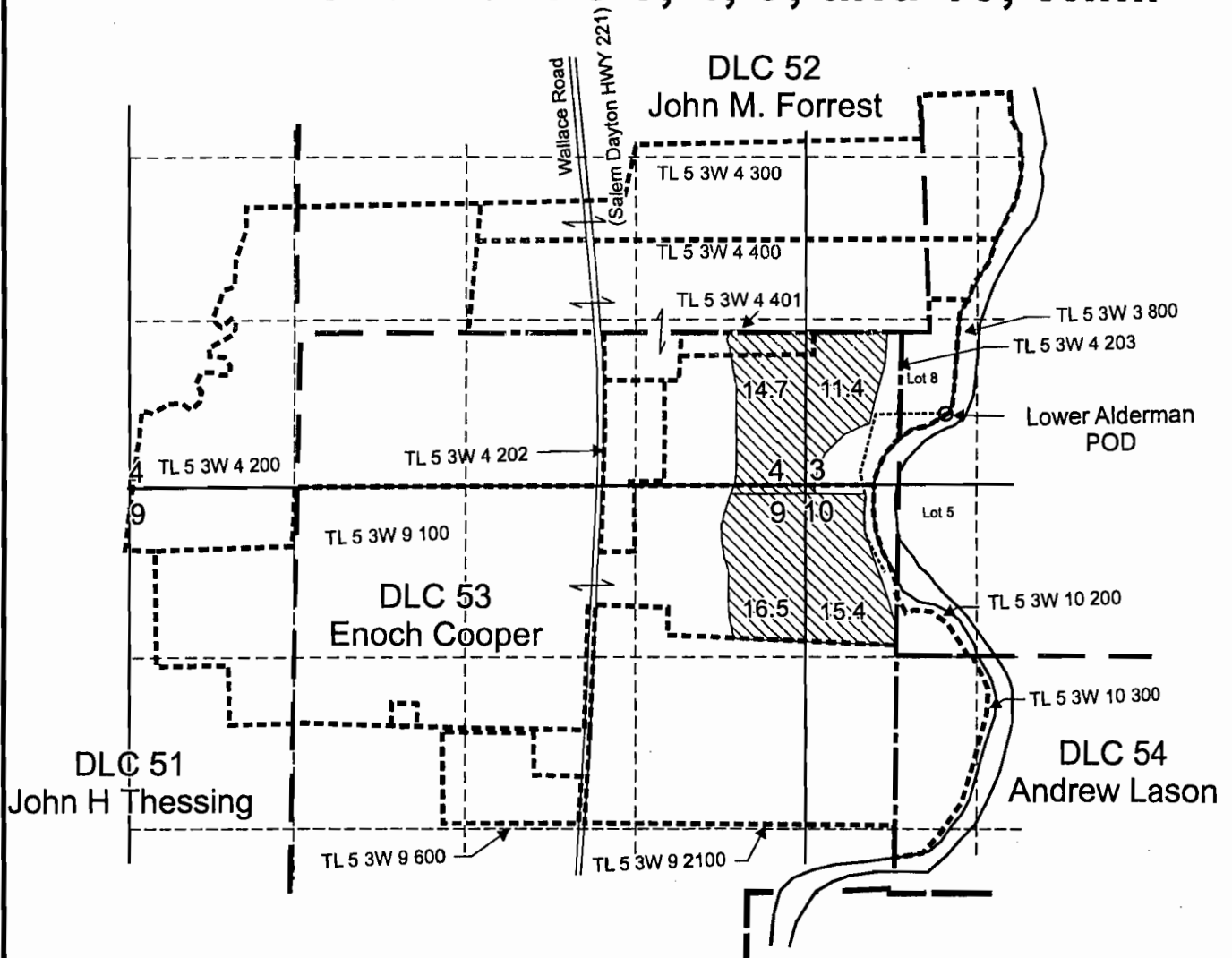

○ Lower Alderman Point of Diversion (POD) is located 520 feet north and 1140 feet east from SW corner of Sec. 3

Area (58 Acres) proposed irrigation use.

--- Tax lot boundary

..... Irrigation mainline

**RECEIVED**

MAR 01 2013

WATER RESOURCES DEPT  
SALEM, OREGON

Scale: 1" = 1,320'

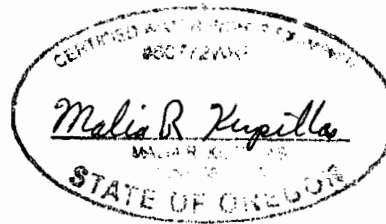
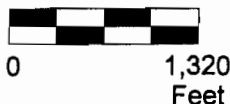

EXPIRATION DATE 6/30/13

This map was prepared for the purpose of identifying the location of a water right only and is not intended to provide legal dimensions or location of property ownership lines.



Water Right Application Map

Pacific Hydro-Geology Inc.

Carlton Nursery Co., LLC  
T.5S. R.3W. Sections 3, 4, 9, and 10 W.M.

LowerAlderman.cdr

S-87875