

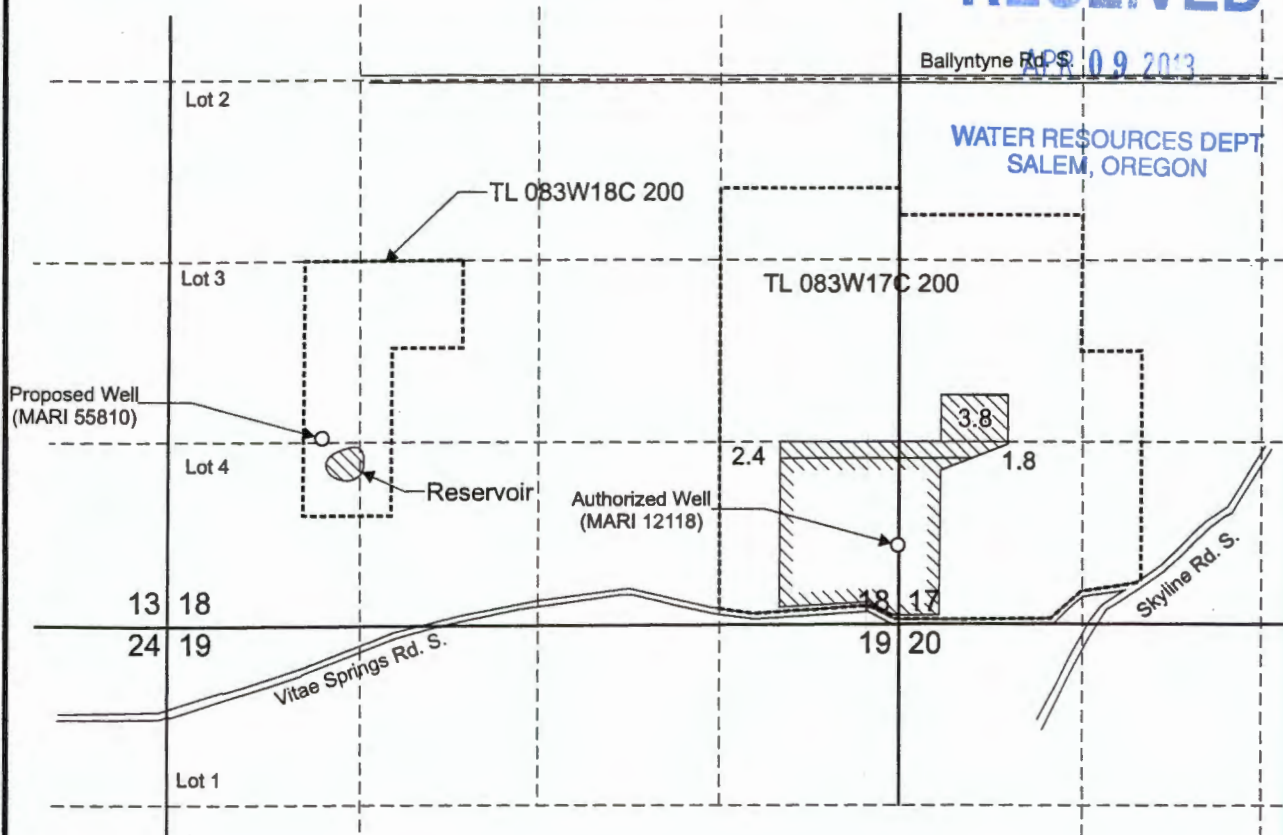

# T.8S. R.3W. Sec. 17 & 18, W.M.

RECEIVED

APR 09 2013



Authorized Well (MARI 12118) is located 580 feet north and 10 feet west from the SE corner of Section 18.

Proposed Well (MARI 55810) is located 1,390 feet north and 1,130 feet east from the SW corner of Section 18.

 "From" area (8.0 Acres) under GR-1455 affected by a GR modification application submitted concurrently with this Request for Assignment.

 Remaining area (29.91 acres) under GR-1455 to be assigned to Larry Lassen.

 Reservoir completed under Certificate 86477 affected by a GR modification application submitted concurrently with this assignment which represents the portion of GR 1455 to be assigned to Jeff Zeeb.

----- Tax lot boundary

Scale: 1" = 1,320'

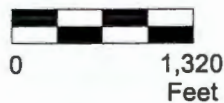

This map was prepared for the purpose of identifying the location of a water right only and is not intended to provide legal dimensions or location of property ownership lines.



## Map to Accompany Requests for Assignment GR-1455

Larry Lassen and Jeff Zeeb  
T.8S. R.3W. Sec. 17 & 18, W.M.

Pacific Hydro-Geology Inc.

02/2013