

**Overview Map for Claim of Beneficial Use, T-10233  
T14S, R14E, Sections 22, 23 & 24**

**NOTES**

1. This map was prepared for the purpose of identifying the location of water rights only and is not intended to provide legal dimensions or locations of property ownership lines.
2. Water volume equivalent to the duty from 29.0 acres for pond maintenance.
3. This map shows entire area for certification. See additional maps for detail.

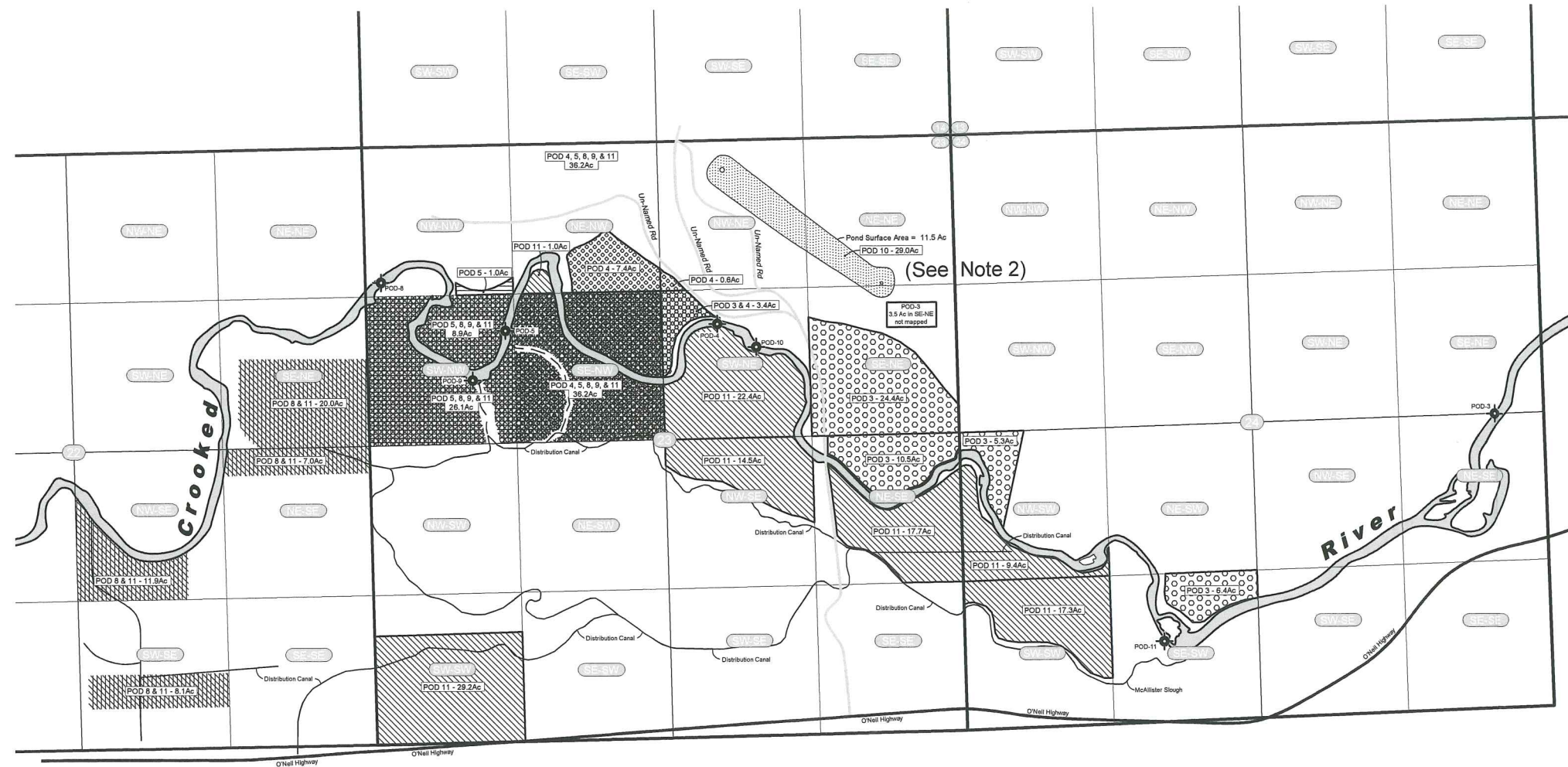

**EXPLANATION**

Irrigated Acres by Diversion, Primary and Supplemental

- POD 3
- POD 4
- POD 5
- POD 8
- POD 9
- POD 10
- POD 11

POD-1 Approximate Location of Existing Points of Diversion

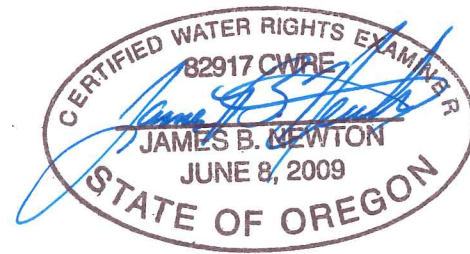

EXPIRES: 12-31-2010  
RENEWS: 12-31-2010

RECEIVED

OCT 04 2010

WATER RESOURCES DEPT  
SALEM, OREGON

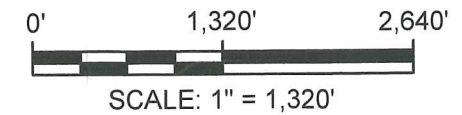

**NEWTON**  
CONSULTANTS INC.  
Earth, Water and Rock Specialists  
Ph: 541 504-9960  
Fax: 541 504-9961

DESIGNED BY: K. Turner

DRAWN BY: S. Schenck



DATE: Oct 2010

PROJECT NO. 1018-102

FIGURE 2

**Overall Map - Claim of Beneficial Use, T-10233  
River Run Ranch  
Crook County, Oregon**



**EXPLANATION**  
 Primary Acres  
 **POD-01** Approximate Location of Existing Points of Diversion

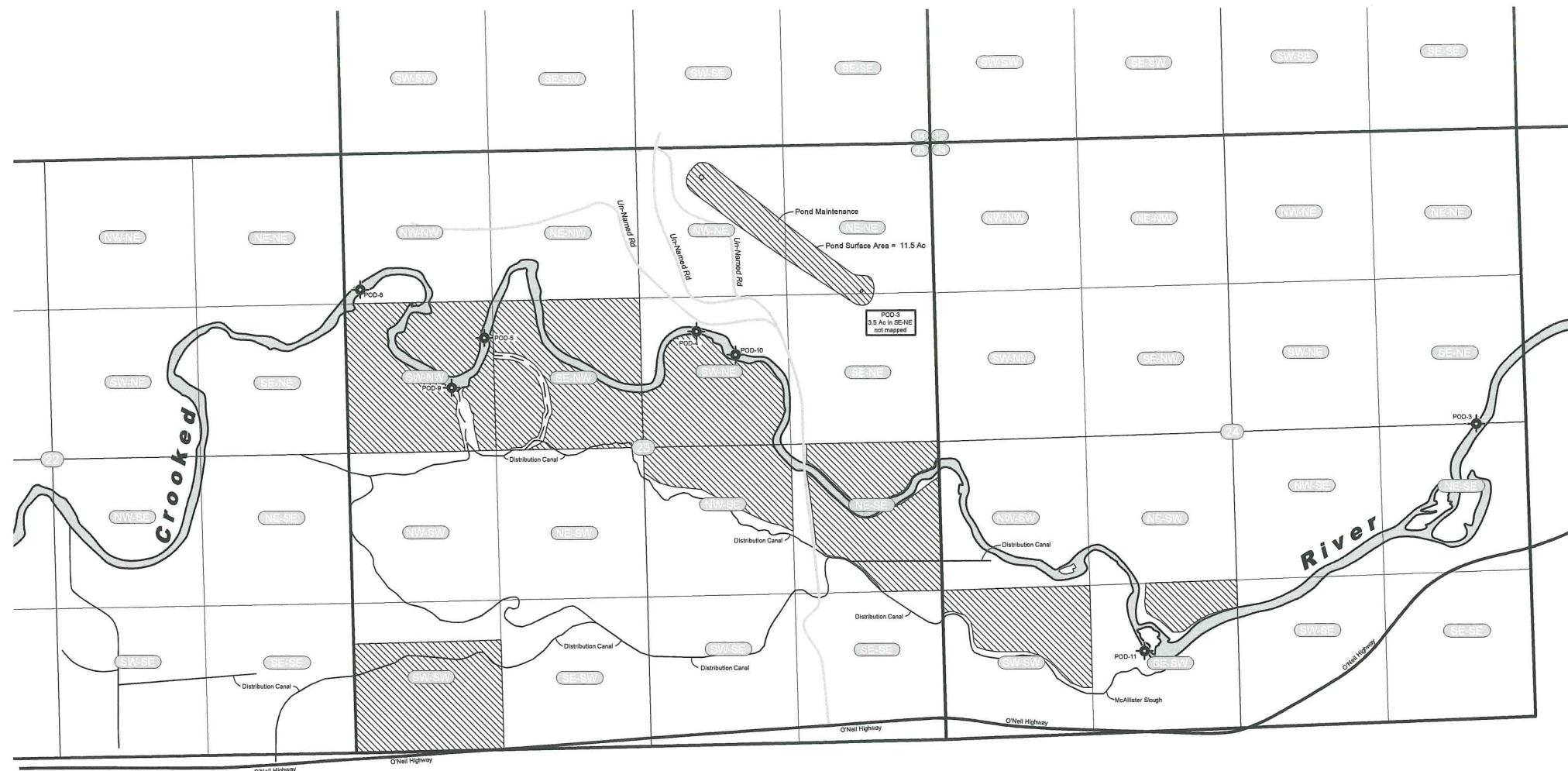

**Overall Map - Primary Irrigation Acres, T-10233**  
 River Run Ranch  
 Crook County, Oregon

PROJECT NO. 1018-102  
 DATE: Oct 2010  
 FIGURE 3

**Overall Map Primary Irrigation Acres, T-10233**  
**T14S, R14E, Sections 22, 23 & 24**

**NOTES**

1. This map was prepared for the purpose of identifying the location of water rights only and is not intended to provide legal dimensions or locations of property ownership lines.

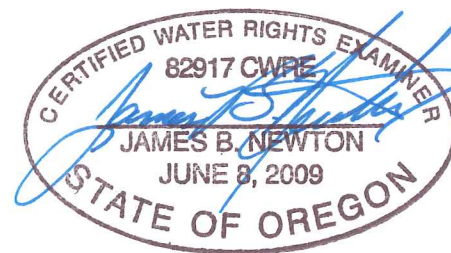

EXPIRES:  
 RENEWS: 12-31-2010

RECEIVED

OCT 04 2010

WATER RESOURCES DEPT  
 SALEM, OREGON

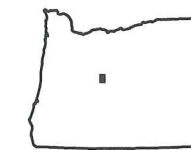
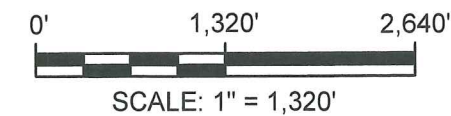

Base Map:



**NEWTON**  
**CONSULTANTS INC.**  
 Earth, Water and Rock Specialists  
 Ph: 541 504-9980  
 Fax: 541 504-9981

DESIGNED BY: K. Turner  
 DRAWN BY: S. Schenck





**EXPLANATION**  
 Supplemental Acres  
 Approximate Location of Existing Points of Diversion

**Overall Map - Supplemental Irrigation Acres, T-10233**  
 River Run Ranch  
 Crook County, Oregon

PROJECT NO. 1018-102  
 DATE: Oct 2010  
 FIGURE 4

**Overall Map Supplemental Irrigation Acres, T-10233**  
**T14S, R14E, Sections 22, 23 & 24**

**NOTES**

1. This map was prepared for the purpose of identifying the location of water rights only and is not intended to provide legal dimensions or locations of property ownership lines.

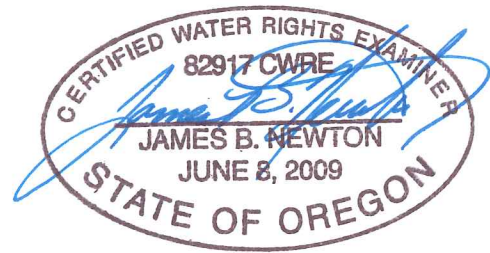

EXPIRES:  
 RENEWS: 12-31-2010

RECEIVED

OCT 04 2010

WATER RESOURCES DEPT  
 SALEM, OREGON



SCALE: 1" = 1,320'

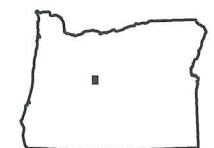

Base Map:



**NEWTON**  
**CONSULTANTS INC.**  
 Earth, Water and Rock Specialists  
 Ph: 541 504-9960 Fax: 541 504-9961

DRAWN BY: S. Schenck

DESIGNED BY: K. Turner

EXPLANATION

- POD-01 Approximate Location of Existing Points of Diversion
- Tax Lot Boundary
- Tax Lot ID Number

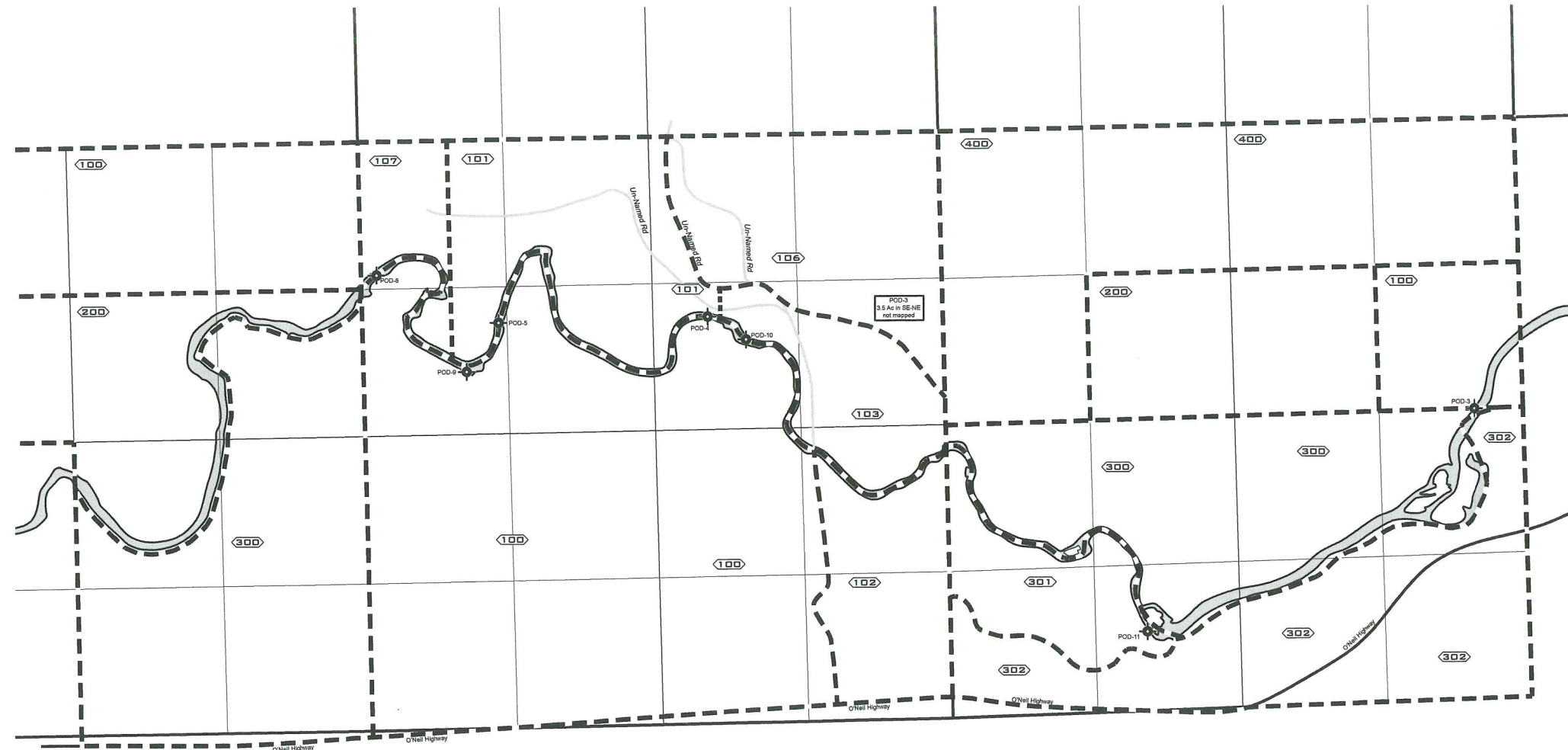

Overall Map - Tax Lot Map, T-10233  
River Run Ranch  
Crook County, Oregon

DESIGNED BY: K. Turner  
DRAWN BY: S. Schenck  
DATE: Oct 2010  
PROJECT NO: 1018-102  
FIGURE 5

**Overall Map Tax Lot Map, T-10233  
T14S, R14E, Sections 22, 23 & 24**

**NOTES**

1. This map was prepared for the purpose of identifying the location of water rights only and is not intended to provide legal dimensions or locations of property ownership lines.
2. Information based on tax lot maps from Crook County revised 6/22/2006.

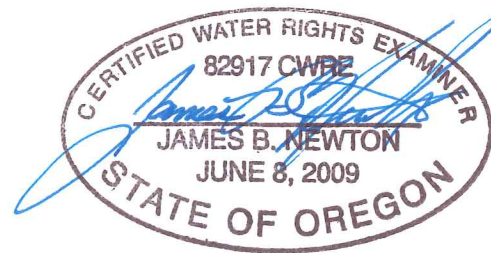

EXPIRES:  
RENEWS: 12-31-2010

RECEIVED

OCT 04 2010

WATER RESOURCES DEPT  
SALEM, OREGON

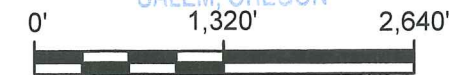

SCALE: 1" = 1,320'

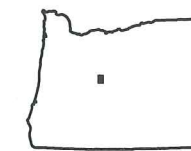

Base Map:



**NEWTON**  
CONSULTANTS INC.  
Earth, Water and Rock Specialists  
Ph: 541 504-9960 Fax: 541 504-9961



0540  
1 of 5

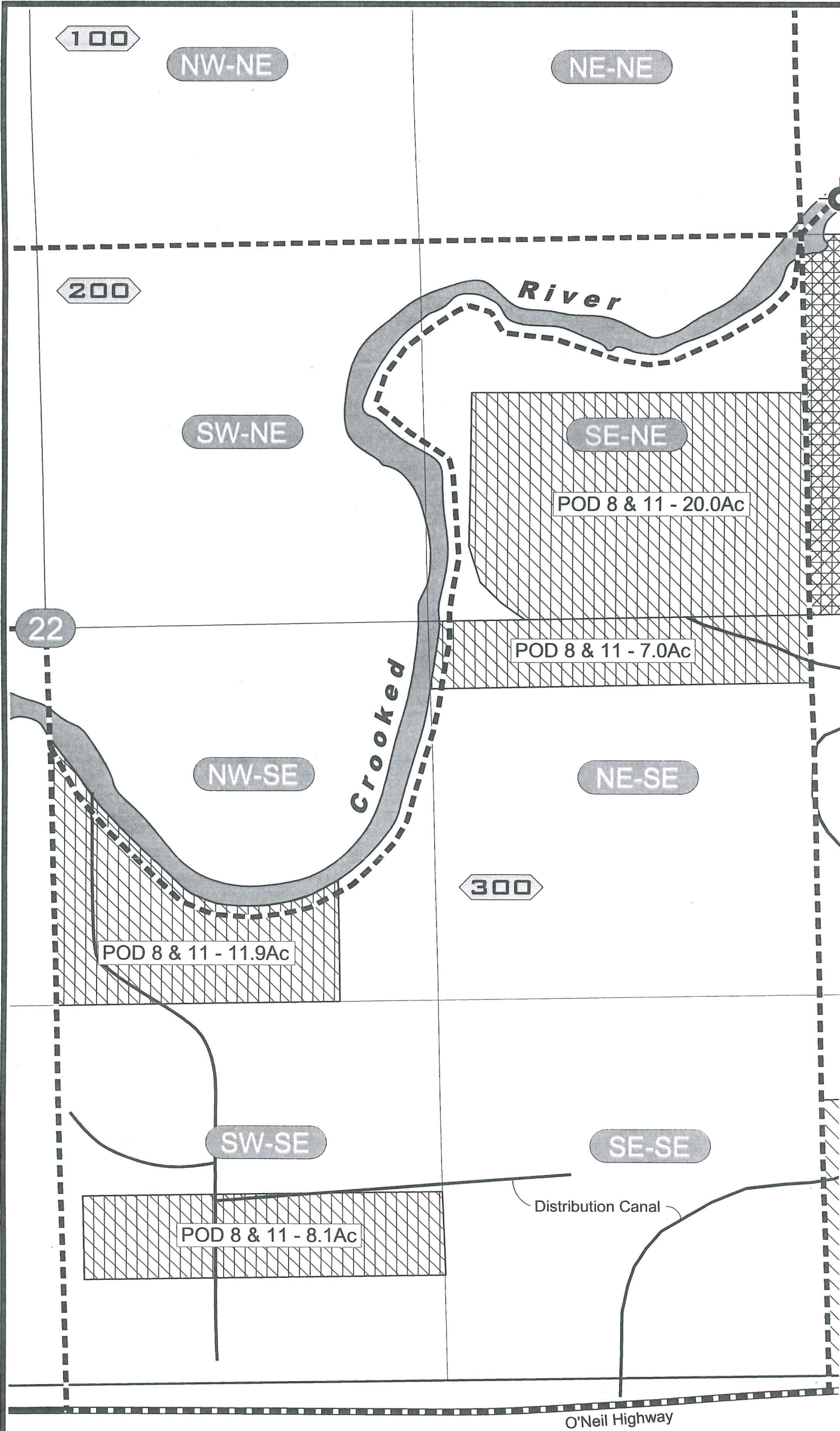

### EXPLANATION

Irrigated Acres by Diversion, Primary and Supplemental

- POD 3
- POD 4
- POD 5
- POD 8
- POD 9
- POD 10
- POD 11

- Tax Lot Boundary
- Tax Lot ID Number

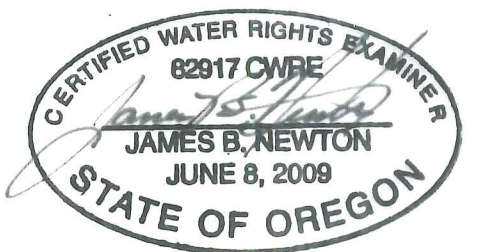

EXPIRES: 12-31-2010  
RENEWS: 12-31-2010

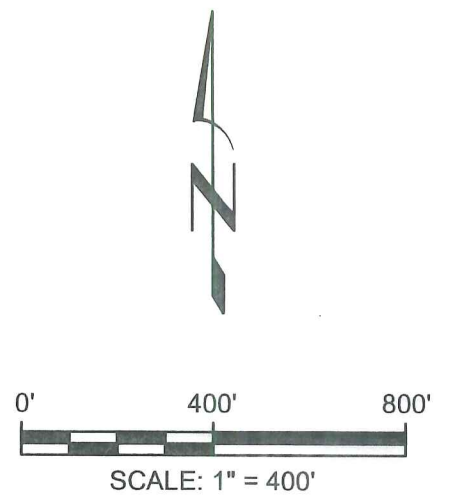

### T14S, R14E, Section 22 - Supplemental Rights

#### NOTES

THIS MAP WAS PREPARED FOR THE PURPOSE OF IDENTIFYING THE LOCATION OF WATER RIGHTS ONLY AND IS NOT INTENDED TO PROVIDE LEGAL DIMENSIONS OR LOCATIONS OF PROPERTY OWNERSHIP LINES.

**NEWTON**  
CONSULTANTS INC.  
Earth, Water and Rock Specialists  
Ph: 541 504-9960 Fax: 541 504-9961

Claim of Beneficial Use, T-10233, Section 22 (E $\frac{1}{2}$ )  
River Run Ranch  
Crook County, Oregon

DESIGNED BY: K. Turner	DRAWN BY: S. Schenck	DATE: Oct 2010	PROJECT NO. 1018-102	FIGURE 6
---------------------------	-------------------------	-------------------	-------------------------	-------------

COBU MAP 0540



0540  
2 of 5

G:\1000\1018\102\Cad\Water\W1018102\_F2\_C06U\_A 14:55 09/30/2010 SS

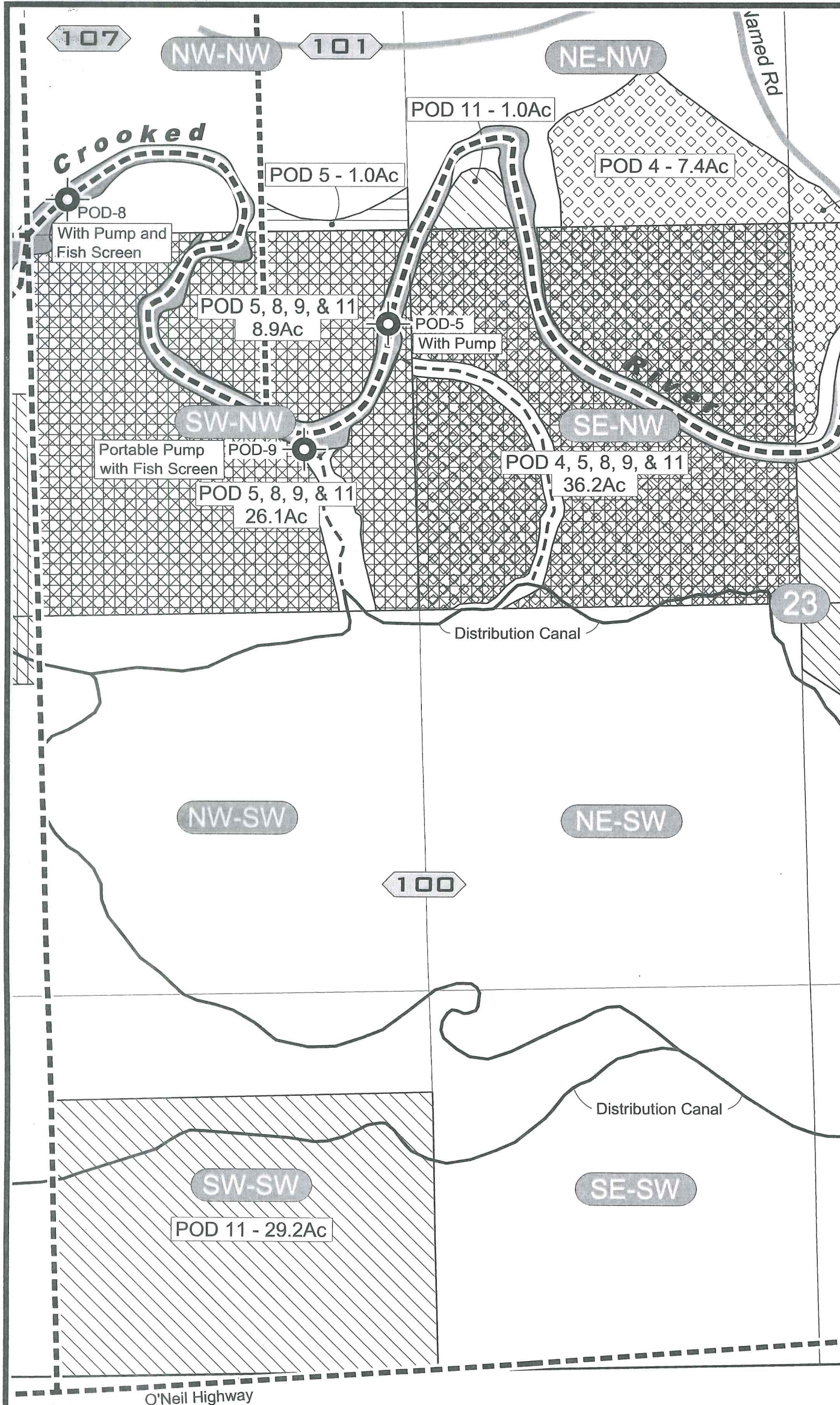

**EXPLANATION**

Irrigated Acres by Diversion, Primary and Supplemental

- POD 3
- POD 4
- POD 5
- POD 8
- POD 9
- POD 10
- POD 11

- Tax Lot Boundary
- Tax Lot ID Number

**POD Location**

- POD-5** - Existing Diversion  
1,000 ft North and 1,400 ft West of Center 1/4 Corner of Section 23.
- POD-8** - Existing Diversion  
1,450 ft North and 2,500 ft West of the Center of Section 23.
- POD-9** - Existing Diversion  
565 ft North and 1,700 ft West of the Center of Section 23.

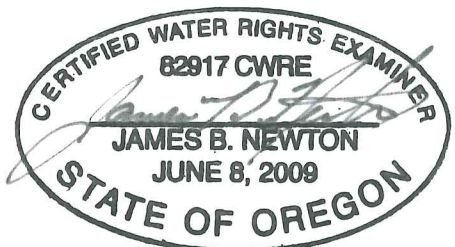

EXPIRES: 12-31-2010  
RENEWS:

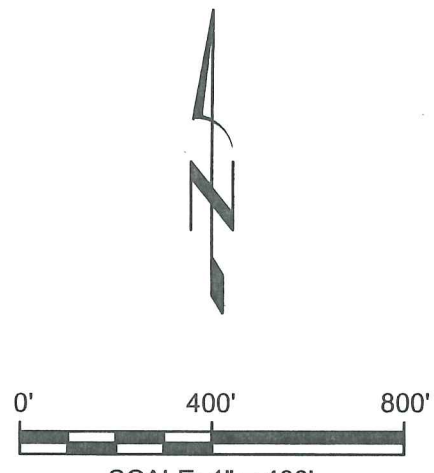

**T14S, R14E, Section 23 - Primary & Supplemental Rights**

**NOTES**

THIS MAP WAS PREPARED FOR THE PURPOSE OF IDENTIFYING THE LOCATION OF WATER RIGHTS ONLY AND IS NOT INTENDED TO PROVIDE LEGAL DIMENSIONS OR LOCATIONS OF PROPERTY OWNERSHIP LINES.

RECEIVED  
OCT 04 2010



**NEWTON**  
CONSULTANTS INC.  
Earth, Water and Rock Specialists  
Ph: 541 504-9960 Fax: 541 504-9961

Claim of Beneficial Use, T-10233, Section 23 (W $\frac{1}{2}$ )  
River Run Ranch  
Crook County, Oregon

DESIGNED BY: K. Turner	DRAWN BY: S. Schenck	DATE: Oct 2010	PROJECT NO. 1018-102	FIGURE 7
---------------------------	-------------------------	-------------------	-------------------------	-------------

CORBU MAP 0540



0540  
30F5

G:\1000\1018\102\Cad\Water\W018102\_F2\_C09J.A 14:55 09/30/2010 55

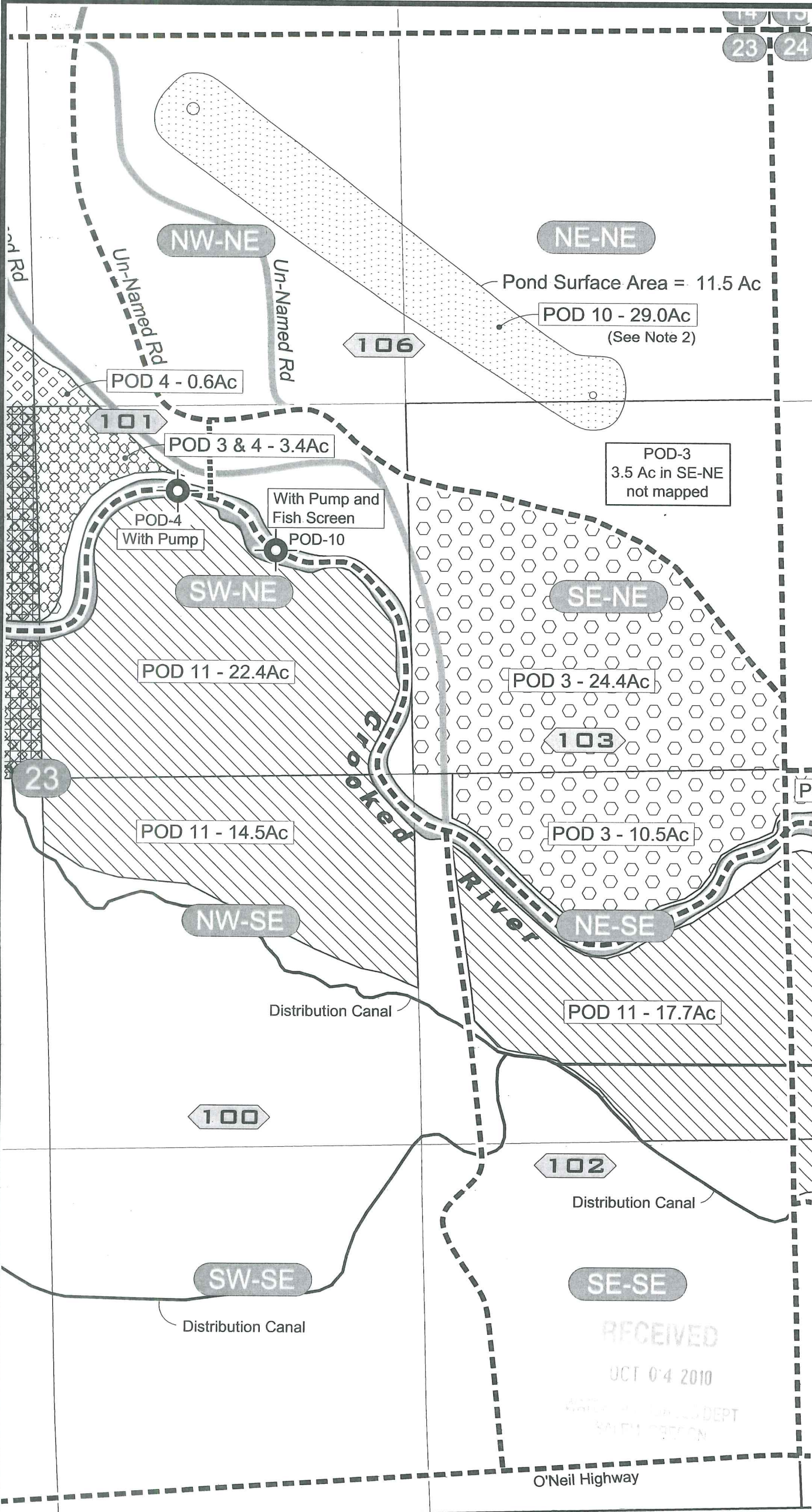

**EXPLANATION**

- Irrigated Acres by Diversion, Primary and Supplemental
- POD 3
  - POD 4
  - POD 5
  - POD 8
  - POD 9
  - POD 10
  - POD 11
- Tax Lot Boundary
- Tax Lot ID Number

**POD Location**

- POD-4** - Existing Diversion 1,020 ft North and 500 ft East of Center 1/4 Corner of Section 23.
- POD-10** - Existing Diversion 805 ft North and 845 ft East of the Center of Section 23.

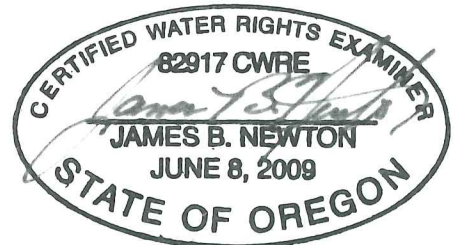

EXPIRES: 12-31-2010  
RENEWS:

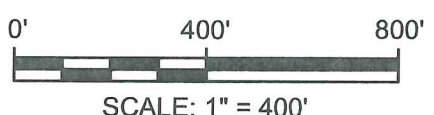
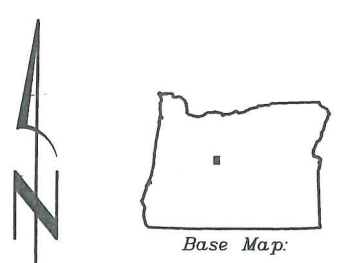

**NOTES**

1. This map was prepared for the purpose of identifying the location of water rights only and is not intended to provide legal dimensions or locations of property ownership lines.
2. Water volume equivalent to the duty from 29.0 acres for pond maintenance.

**T14S, R14E, Section 23, Primary & Supplemental Rights**

**NEWTON CONSULTANTS INC.**  
Earth, Water and Rock Specialists  
Ph: 541 504-9960 Fax: 541 504-9961

Claim of Beneficial Use, T-10233, Section 23 (E½)  
River Run Ranch  
Crook County, Oregon

DESIGNED BY: K. Turner	DRAWN BY: S. Schenck	DATE: Oct 2010	PROJECT NO. 1018-102	FIGURE 8
---------------------------	-------------------------	-------------------	-------------------------	-------------

COBUC MAP 0540



0540  
4 of 5

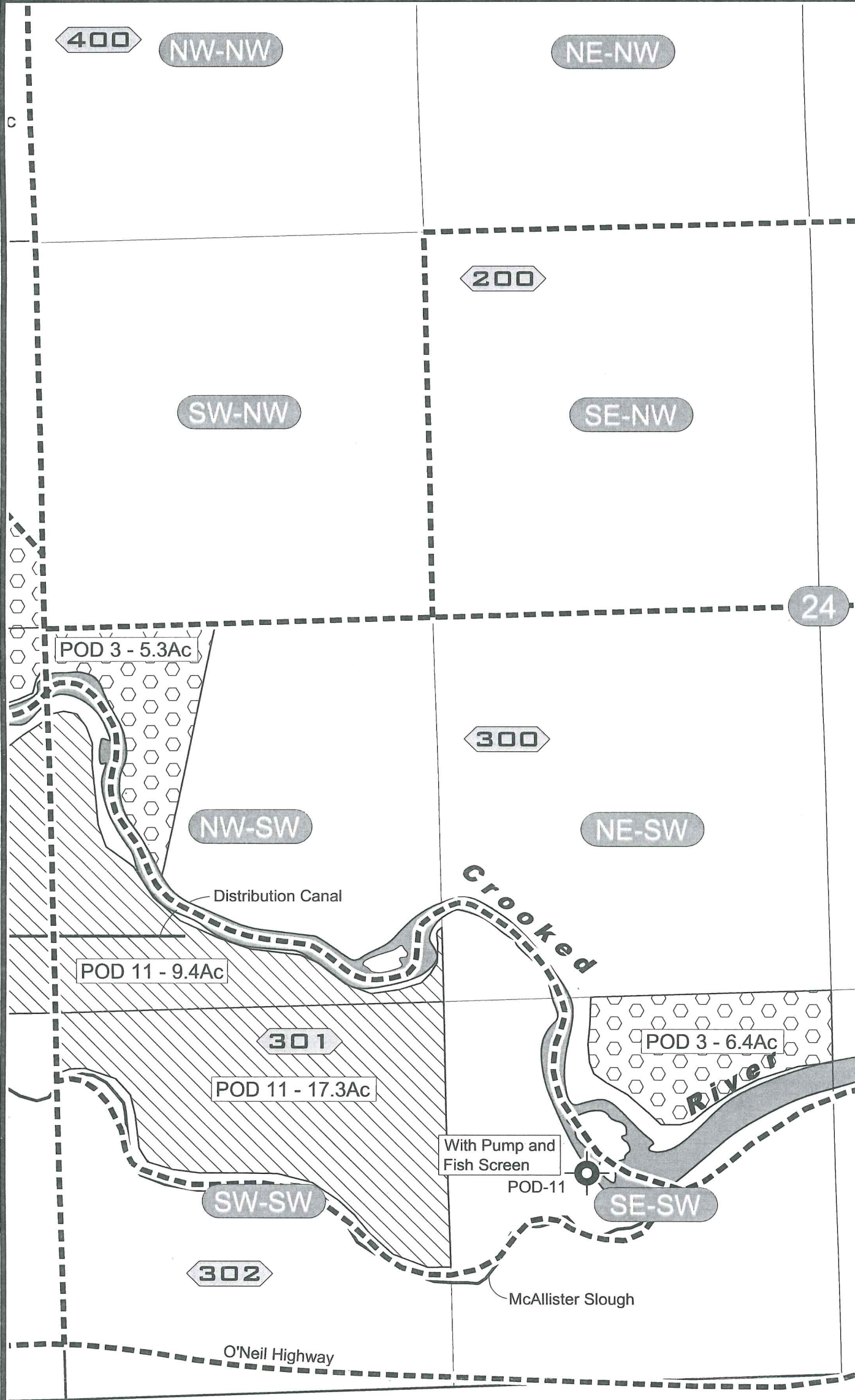

### EXPLANATION

Irrigated Acres by Diversion, Primary and Supplemental

- POD 3
- POD 4
- POD 5
- POD 8
- POD 9
- POD 10
- POD 11

Tax Lot Boundary

Tax Lot ID Number

### POD Location

**POD-11** - Existing Diversion  
1,915 ft South and 845 ft West  
of the Center of Section 24.



EXPIRES: 12-31-2010  
RENEWS:

## T14S, R14E, Section 24, Primary & Supplemental Rights

### NOTES

THIS MAP WAS PREPARED FOR THE PURPOSE OF IDENTIFYING THE LOCATION OF WATER RIGHTS ONLY AND IS NOT INTENDED TO PROVIDE LEGAL DIMENSIONS OR LOCATIONS OF PROPERTY OWNERSHIP LINES.

RECEIVED  
OCT 04 2010



**NEWTON**  
CONSULTANTS INC.  
Earth, Water and Rock Specialists  
Ph: 541 504-9960 Fax: 541 504-9961

Claim of Beneficial Use, T-10233, Section 24 (W<sup>1</sup>/<sub>2</sub>)  
River Run Ranch  
Crook County, Oregon

DESIGNED BY: K. Turner	DRAWN BY: S. Schenck	DATE: Oct 2010	PROJECT NO. 1018-102	FIGURE 9
---------------------------	-------------------------	-------------------	-------------------------	-------------

COBU MAP 0540



0540  
50FS

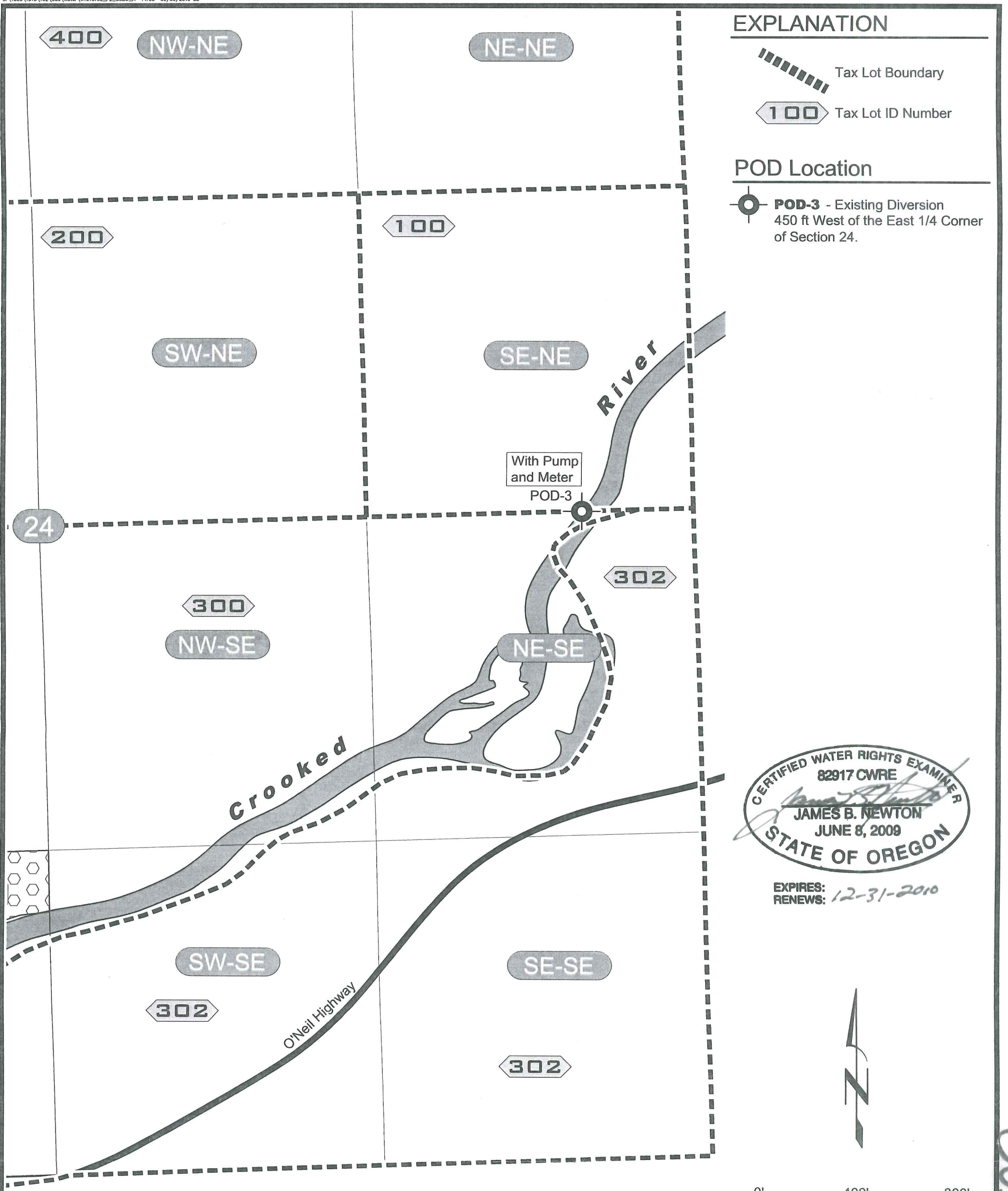

**EXPLANATION**

- Tax Lot Boundary
- Tax Lot ID Number

**POD Location**

- POD-3** - Existing Diversion  
450 ft West of the East 1/4 Corner  
of Section 24.

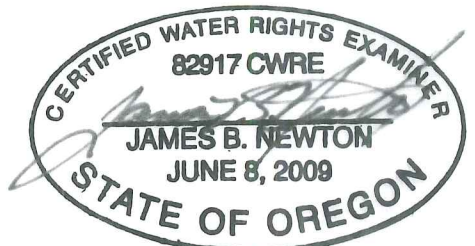

EXPIRES:  
RENEWS: 12-31-2010

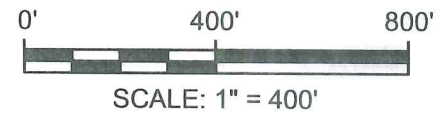

**T14S, R14E, Section 24, POD #3**

**NOTES**

THIS MAP WAS PREPARED FOR THE PURPOSE OF IDENTIFYING THE LOCATION OF WATER RIGHTS ONLY AND IS NOT INTENDED TO PROVIDE LEGAL DIMENSIONS OR LOCATIONS OF PROPERTY OWNERSHIP LINES.

RECEIVED

OCT 04 2010

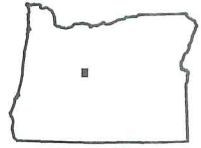

Base Map:

**NEWTON**  
CONSULTANTS INC.  
Earth, Water and Rock Specialists  
Ph: 541 504-9960 Fax: 541 504-9961

POD #3 - Claim of Beneficial Use, T-10233, Section 24 (E $\frac{1}{2}$ )  
River Run Ranch  
Crook County, Oregon

DESIGNED BY: K.Turner	DRAWN BY: S.Schenck	DATE: Oct 2010	PROJECT NO. 1018-102	FIGURE 10
--------------------------	------------------------	-------------------	-------------------------	--------------

COBUL MAP 0540