

PORT OF MORROW
Water Rights Proof Map for
Municipal Service Area, POA's & POD's

Morrow County
Scale 1" = 1320 Ft.

POA MAP for Municipal Use for:
Application #G-17678

RECEIVED
MAY 21 2015
OWRD

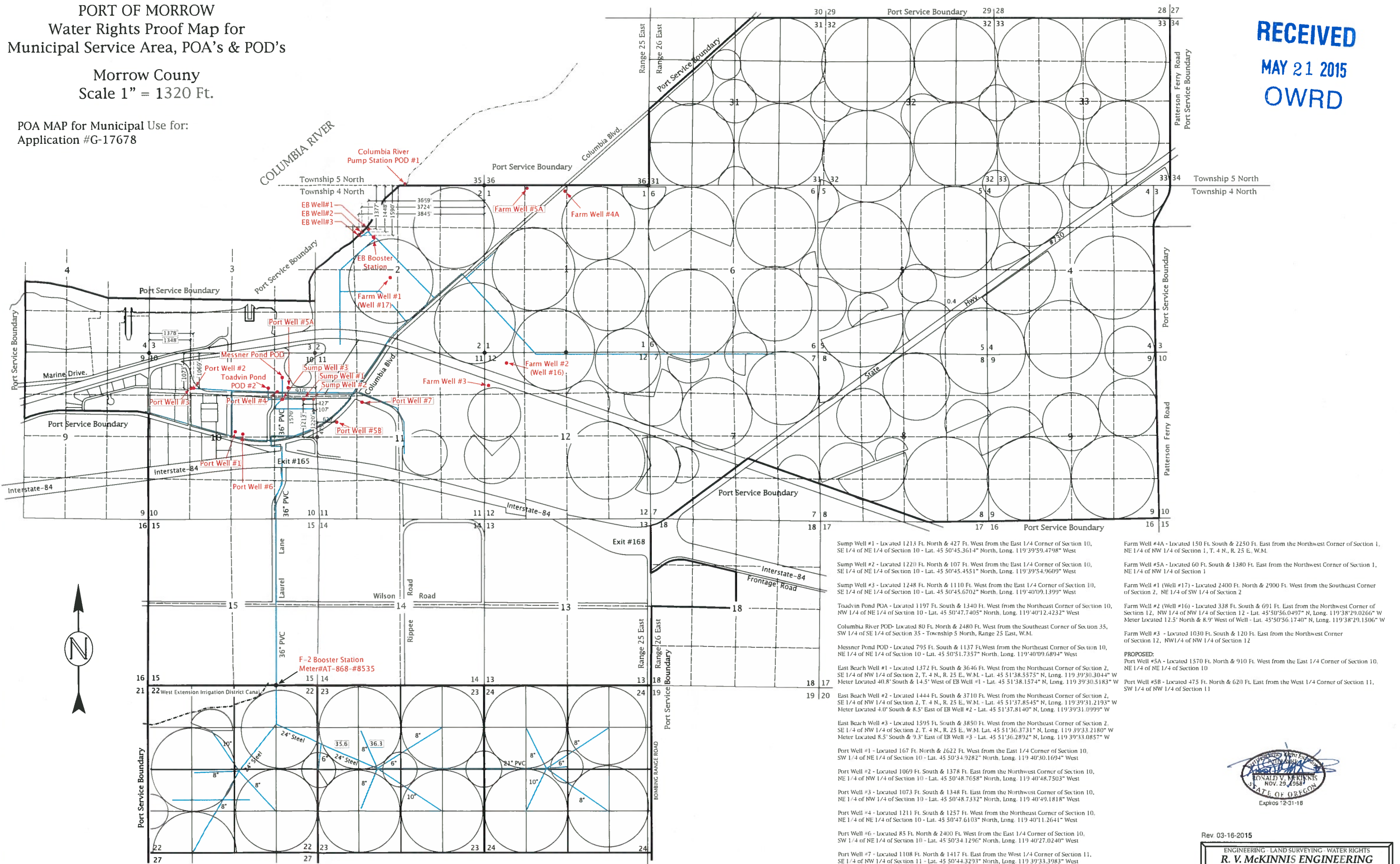

- Sump Well #1 - Located 1213 Ft. North & 427 Ft. West from the East 1/4 Corner of Section 10, SE 1/4 of NE 1/4 of Section 10 - Lat. 45 50'45.3614" North, Long. 119 39'59.4798" West
 - Sump Well #2 - Located 1220 Ft. North & 107 Ft. West from the East 1/4 Corner of Section 10, SE 1/4 of NE 1/4 of Section 10 - Lat. 45 50'45.4551" North, Long. 119 39'54.9609" West
 - Sump Well #3 - Located 1248 Ft. North & 1110 Ft. West from the East 1/4 Corner of Section 10, SE 1/4 of NE 1/4 of Section 10 - Lat. 45 50'45.6702" North, Long. 119 40'09.1399" West
 - Toadvin Pond POA - Located 1197 Ft. South & 1340 Ft. West from the Northeast Corner of Section 10, NW 1/4 of NE 1/4 of Section 10 - Lat. 45 50'47.7405" North, Long. 119 40'12.4232" West
 - Columbia River POD - Located 80 Ft. North & 2480 Ft. West from the Southeast Corner of Section 35, SW 1/4 of SE 1/4 of Section 35 - Township 5 North, Range 25 East, W.M.
 - Messner Pond POD - Located 795 Ft. South & 1137 Ft. West from the Northeast Corner of Section 10, NE 1/4 of NE 1/4 of Section 10 - Lat. 45 50'51.7357" North, Long. 119 40'09.6894" West
 - East Beach Well #1 - Located 1372 Ft. South & 3646 Ft. West from the Northeast Corner of Section 2, SE 1/4 of NW 1/4 of Section 2, T. 4 N., R. 25 E., W.M. - Lat. 45 51'38.5575" N, Long. 119 39'30.3044" W Meter Located 4.0" South & 8.5" East of EB Well #2 - Lat. 45 51'37.8140" N, Long. 119 39'31.0999" W
 - East Beach Well #2 - Located 1444 Ft. South & 3710 Ft. West from the Northeast Corner of Section 2, SE 1/4 of NW 1/4 of Section 2, T. 4 N., R. 25 E., W.M. - Lat. 45 51'37.8545" N, Long. 119 39'31.2193" W Meter Located 4.0" South & 8.5" East of EB Well #2 - Lat. 45 51'37.8140" N, Long. 119 39'31.0999" W
 - East Beach Well #3 - Located 1595 Ft. South & 3850 Ft. West from the Northeast Corner of Section 2, SE 1/4 of NW 1/4 of Section 2, T. 4 N., R. 25 E., W.M. - Lat. 45 51'36.3731" N, Long. 119 39'33.2180" W Meter Located 8.5" South & 9.3" East of EB Well #3 - Lat. 45 51'36.2892" N, Long. 119 39'33.0857" W
 - Port Well #1 - Located 167 Ft. North & 2622 Ft. West from the East 1/4 Corner of Section 10, SW 1/4 of NE 1/4 of Section 10 - Lat. 45 50'34.9282" North, Long. 119 40'30.1694" West
 - Port Well #2 - Located 1069 Ft. South & 1378 Ft. East from the Northwest Corner of Section 10, NE 1/4 of NW 1/4 of Section 10 - Lat. 45 50'48.7658" North, Long. 119 40'48.7503" West
 - Port Well #3 - Located 1073 Ft. South & 1348 Ft. East from the Northwest Corner of Section 10, NE 1/4 of NW 1/4 of Section 10 - Lat. 45 50'48.7332" North, Long. 119 40'49.1818" West
 - Port Well #4 - Located 1211 Ft. South & 1257 Ft. West from the Northeast Corner of Section 10, NE 1/4 of NE 1/4 of Section 10 - Lat. 45 50'47.6103" North, Long. 119 40'11.2641" West
 - Port Well #6 - Located 85 Ft. North & 2400 Ft. West from the East 1/4 Corner of Section 10, SW 1/4 of NE 1/4 of Section 10 - Lat. 45 50'34.1296" North, Long. 119 40'27.0240" West
 - Port Well #7 - Located 1108 Ft. North & 1417 Ft. East from the West 1/4 Corner of Section 11, SE 1/4 of NW 1/4 of Section 11 - Lat. 45 50'44.3293" North, Long. 119 39'33.3983" West
 - Farm Well #4A - Located 150 Ft. South & 2250 Ft. East from the Northwest Corner of Section 1, NE 1/4 of NW 1/4 of Section 1, T. 4 N., R. 25 E., W.M.
 - Farm Well #5A - Located 60 Ft. South & 1380 Ft. East from the Northwest Corner of Section 1, NE 1/4 of NW 1/4 of Section 1
 - Farm Well #1 (Well #17) - Located 2400 Ft. North & 2900 Ft. West from the Southeast Corner of Section 2, NE 1/4 of SW 1/4 of Section 2
 - Farm Well #2 (Well #16) - Located 338 Ft. South & 691 Ft. East from the Northwest Corner of Section 12, NW 1/4 of NW 1/4 of Section 12 - Lat. 45 50'56.0497" N, Long. 119 38'29.0266" W Meter Located 12.5' North & 8.9' West of Well - Lat. 45 50'56.1740" N, Long. 119 38'29.1506" W
 - Farm Well #3 - Located 1030 Ft. South & 120 Ft. East from the Northwest Corner of Section 12, NW 1/4 of NW 1/4 of Section 12
- PROPOSED:
Port Well #5A - Located 1570 Ft. North & 910 Ft. West from the East 1/4 Corner of Section 10, NE 1/4 of NE 1/4 of Section 10
Port Well #5B - Located 475 Ft. North & 620 Ft. East from the West 1/4 Corner of Section 11, SW 1/4 of NW 1/4 of Section 11



Rev 03-16-2015

ENGINEERING - LAND SURVEYING - WATER RIGHTS
R. V. MCKINNIS ENGINEERING
79980 Prindle Loop Road
Hermiston, Oregon 97838
(541) 567-2017