

ROUND BUTTE

121° 37' 30"

43° 07' 30"

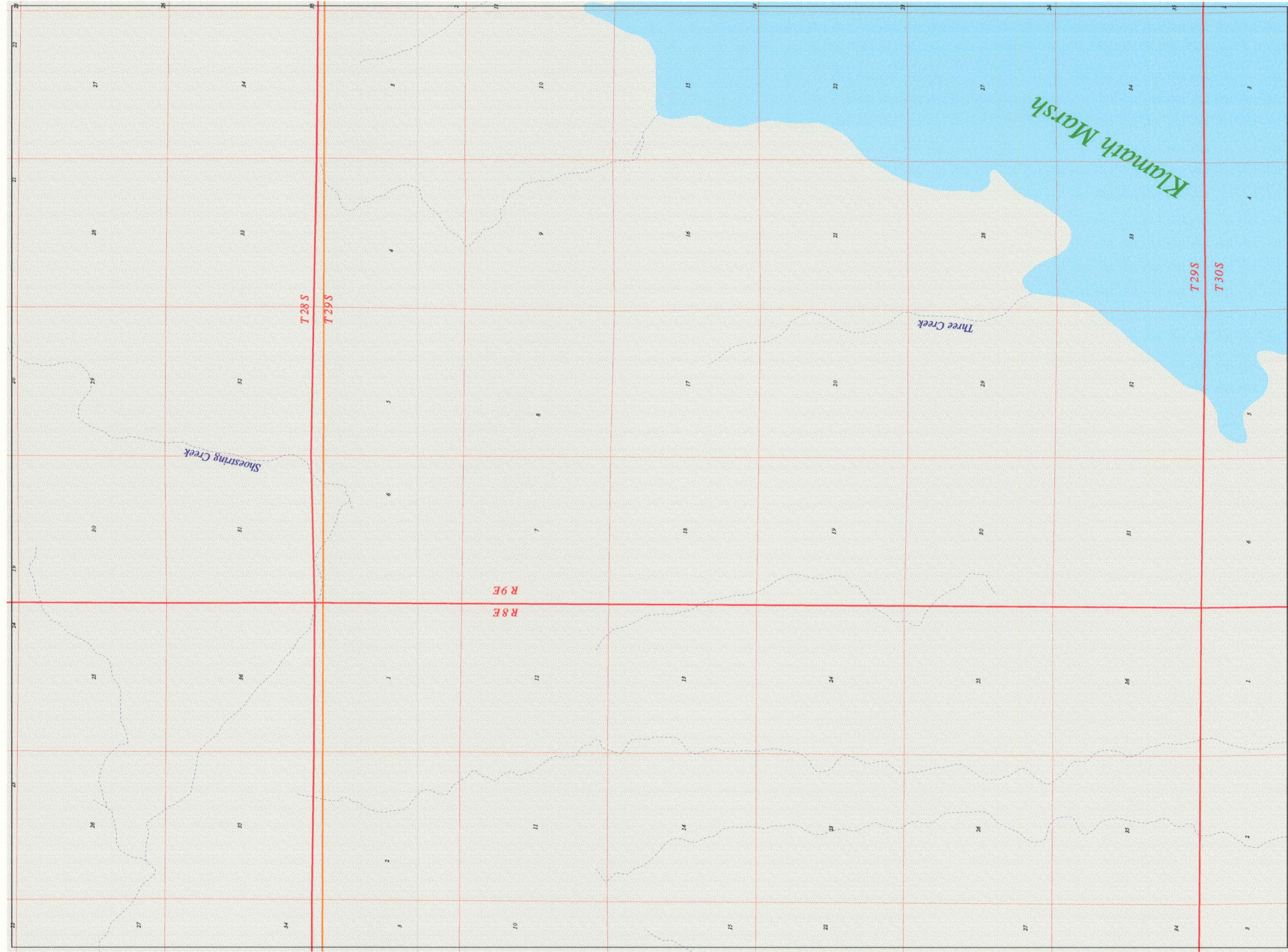

RECEIVED
MAR 01 1999
WATER RESOURCES DEPT
SALEM, OREGON

121° 37' 30"

43° 00'

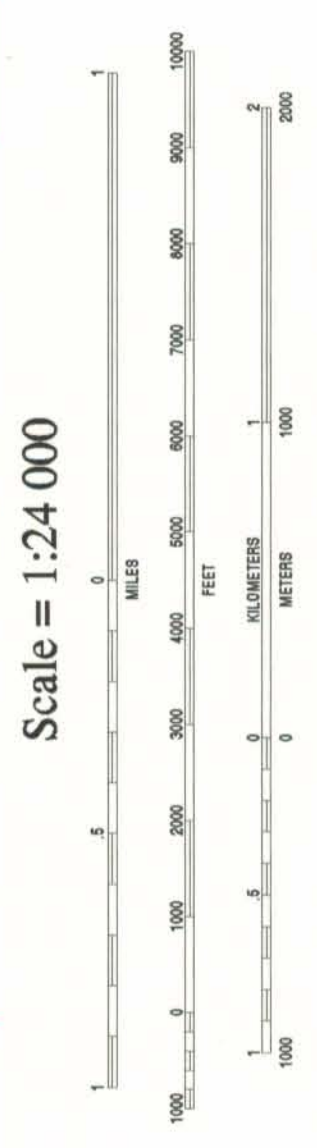

- LEGEND
- Major River
 - Minor stream/Tributary
 - Lake, Pond or Marsh Boundary
 - U.S. Highway
 - State Highway
 - County Road
 - NF Arterial Road
 - Flow Gage
 - Treaty boundary
 - Major Road