

AMENDED LENZ CLAIM MAP
AMENDED CLAIM #623

121° 45' 43" 00"

121° 52' 30" 43" 00"

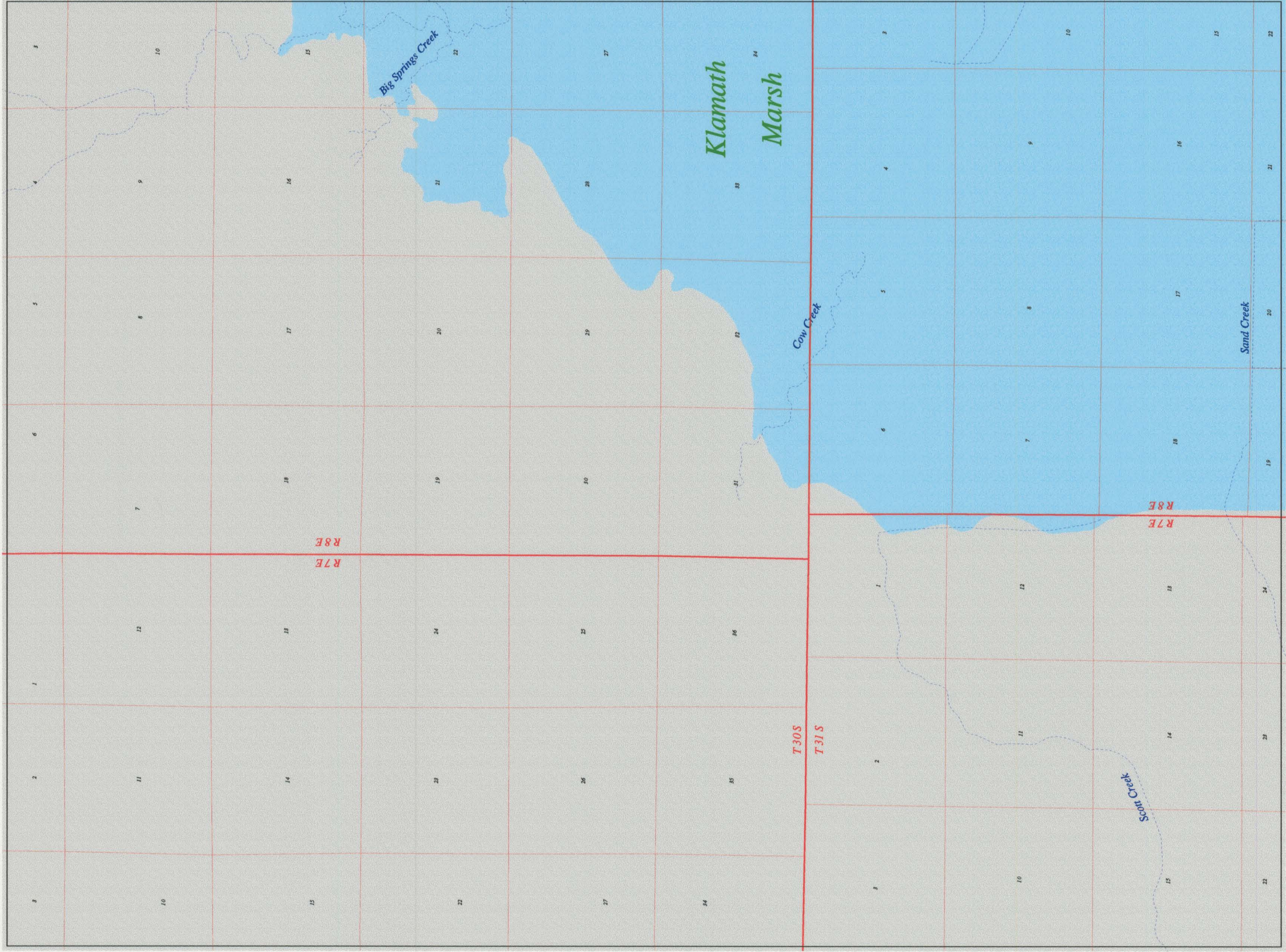

42° 52' 30" 121° 52' 30"

42° 52' 30" 121° 45'

Scale = 1:24 000



LEGEND

Major River	Treaty boundary
Minor stream/Tributary	Major Road
Lake, Pond or Marsh Boundary	County Road
U.S. Highway	State Highway
	NF Arterial Road
	Flow Gauge

RECEIVED
OCT 0 1 1999
WATER RESOURCES DEPT.
SALEM, OREGON