

AMENDED BUTTES OF THE GODS CLAIM MAP  
AMENDED CLAIM #624

121° 37' 30"  
42° 37' 30"

121° 30'  
42° 37' 30"

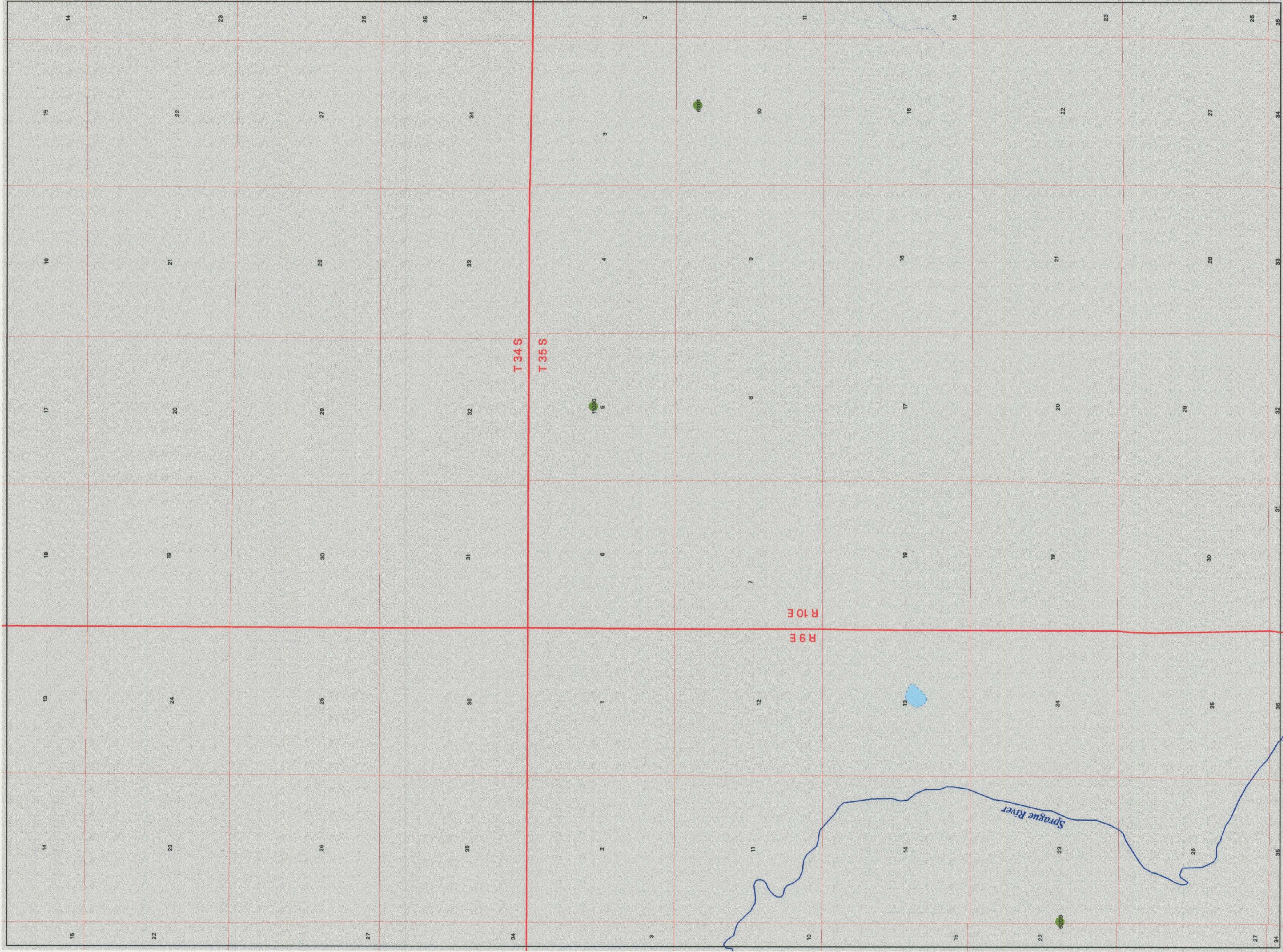

RECEIVED  
OCT 01 1999  
WASHINGTON STATE DEPT.  
SALEM, OREGON

Scale = 1:24 000



KLAMATH ADJUDICATION  
CLAIM # 624 PAGE # 121

**LEGEND**

- Major River
- Minor stream/Tributary
- Lake, Pond or Marsh Boundary
- U.S. Highway
- State Highway
- Seep-Spring Site
- Treaty boundary
- Major Road
- County Road
- NF Arterial Road
- Flow Gage