

AMENDED FERGUSON MOUNTAIN CLAIM MAP

AMENDED CLAIM #624

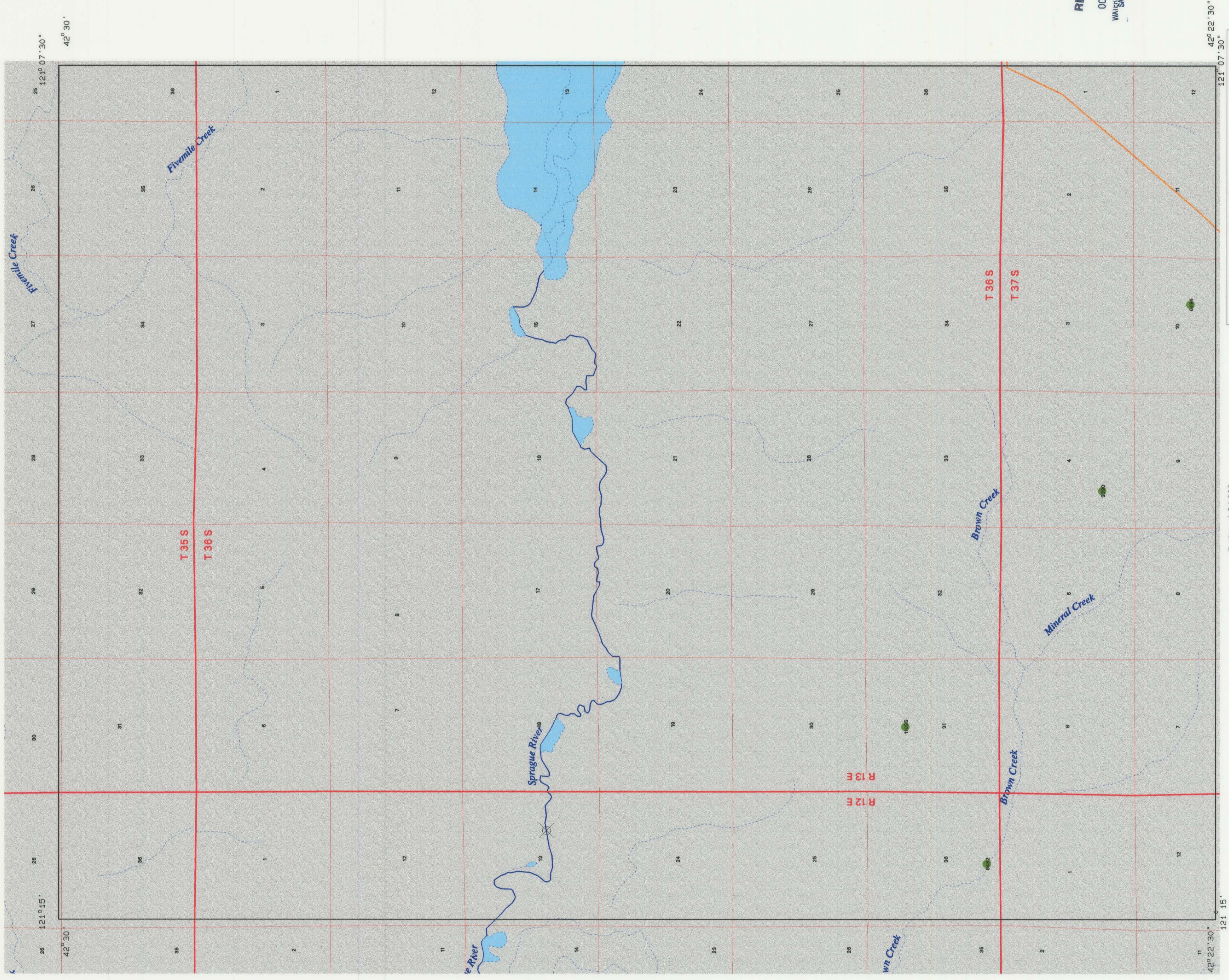

RECEIVED  
OCT 01 1999  
WATER RESOURCES DEPT.  
SALEM, OREGON

**LEGEND**

- Major River
- Minor stream/Tributary
- Lake, Pond or Marsh Boundary
- U.S. Highway
- State Highway
- Seep-Spring Site
- Treaty boundary
- Major Road
- County Road
- NF Arterial Road
- Flow Gage

Scale = 1:24,000

1 0 1000 2000 3000 4000 5000 6000 7000 8000 9000 10000

FEET

0 1000 2000 3000 4000 5000 6000 7000 8000 9000 10000

METERS

To convert feet to meters multiply by .3048  
To convert meters to feet multiply by 3.2808

SOURCE: USGS 7.5 MINUTE QUAD



KLAMATH ADJUDICATION  
CLAIM # 624 PAGE # 126