

PUBLIC INTEREST REVIEW FOR GROUND WATER APPLICATIONS

TO: Water Rights Section Date July 9, 2013

FROM: Ground Water/Hydrology Section Michael Zwart
Reviewer's Name

SUBJECT: Application G- 17663 Supersedes review of _____
Date of Review(s)

PUBLIC INTEREST PRESUMPTION; GROUNDWATER

OAR 690-310-130 (1) *The Department shall presume that a proposed groundwater use will ensure the preservation of the public welfare, safety and health as described in ORS 537.525.* Department staff review ground water applications under OAR 690-310-140 to determine whether the presumption is established. OAR 690-310-140 allows the proposed use be modified or conditioned to meet the presumption criteria. **This review is based upon available information and agency policies in place at the time of evaluation.**

A. GENERAL INFORMATION: Applicant's Name: Phillip and Lorissa Singhose County: Harney

- A1. Applicant(s) seek(s) 2.5 cfs from one well(s) in the Malheur Lake Basin,
Silver Creek subbasin Quad Map: Moon Reservoir
- A2. Proposed use: Irrigation, 160 acres Seasonality: March 1 to October 31
- A3. Well and aquifer data (attach and number logs for existing wells; mark proposed wells as such under logid):

Well	Logid	Applicant's Well #	Proposed Aquifer*	Proposed Rate(cfs)	Location (T/R-S QQ-Q)	Location, metes and bounds, e.g. 2250' N, 1200' E fr NW cor S 36
1	Proposed	17	Alluv./bedrock	2.5	24S/27E-12 SW-SW	50' N, 20' E fr SW cor S 12
2						
3						
4						
5						

* Alluvium, CRB, Bedrock

Well	Well Elev ft msl	First Water ft bls	SWL ft bls	SWL Date	Well Depth (ft)	Seal Interval (ft)	Casing Intervals (ft)	Liner Intervals (ft)	Perforations Or Screens (ft)	Well Yield (gpm)	Draw Down (ft)	Test Type
1	4210		50±		400	0-20	100±					

Use data from application for proposed wells.

A4. **Comments: Based on Enforcement staff requirements for deeper well seals at several nearby wells in 2002 (file G-15168), it is likely that the proposed well here will need to be sealed somewhat deeper than is proposed.**

A5. **Provisions of the Malheur Lake** Basin rules relative to the development, classification and/or management of ground water hydraulically connected to surface water are, or are not, activated by this application. (Not all basin rules contain such provisions.)
 Comments: _____

A6. **Well(s) #** _____, _____, _____, _____, _____, tap(s) an aquifer limited by an administrative restriction.
 Name of administrative area: _____
 Comments: _____

B. GROUND WATER AVAILABILITY CONSIDERATIONS, OAR 690-310-130, 400-010, 410-0070

B1. **Based upon available data**, I have determined that ground water* for the proposed use:

- a. is over appropriated, is not over appropriated, or **cannot be determined to be** over appropriated during any period of the proposed use. * This finding is limited to the ground water portion of the over-appropriation determination as prescribed in OAR 690-310-130;
- b. **will not** or **will likely** be available in the amounts requested without injury to prior water rights. * This finding is limited to the ground water portion of the injury determination as prescribed in OAR 690-310-130;
- c. **will not** or **will likely** to be available within the capacity of the ground water resource; or
- d. **will, if properly conditioned**, avoid injury to existing ground water rights or to the ground water resource:
 - i. The permit should contain condition #(s) 7N, 7K (60 feet, shallower sands and gravels) _____;
 - ii. The permit should be conditioned as indicated in item 2 below.
 - iii. The permit should contain special condition(s) as indicated in item 3 below;

- B2. a. **Condition** to allow ground water production from no deeper than _____ ft. below land surface;
- b. **Condition** to allow ground water production from no shallower than _____ ft. below land surface;
- c. **Condition** to allow ground water production only from the _____ ground water reservoir between approximately _____ ft. and _____ ft. below land surface;
- d. **Well reconstruction** is necessary to accomplish one or more of the above conditions. The problems that are likely to occur with this use and without reconstructing are cited below. Without reconstruction, I recommend withholding issuance of the permit until evidence of well reconstruction is filed with the Department and approved by the Ground Water Section.

Describe injury –as related to water availability– that is likely to occur without well reconstruction (interference w/ senior water rights, not within the capacity of the resource, etc): _____

B3. **Ground water availability remarks:** There are no current or non-current State Observation Wells nearby with long-term water-level records. There are also no other water-level data on file for the local area. However, water-level data being collected in the Weaver Springs area to the southeast and in other parts of the Malheur Lake Basin have disclosed groundwater level declines in areas that have experienced significant development of groundwater for irrigation. The Weaver Springs area is noteworthy because it is a local example of over-appropriation of the groundwater resource and it has a similar climate, underlying geology and recharge as the area here. Review of local well logs and the November 2012 draft Harney Basin Groundwater Study indicates that the regional groundwater flow direction in this area is to the southeast toward Malheur and Harney lakes. Therefore, this area is likely upgradient of the Weaver Springs area. This is significant, given the documented water-level declines there and the fact that many existing groundwater rights there are yet to be developed. Thus, the documented water-level declines are likely to increase in time as these rights are more fully developed. At this time, I am not prepared to find that the groundwater resource is over-appropriated in this area.

C. GROUND WATER/SURFACE WATER CONSIDERATIONS, OAR 690-09-040

C1. **690-09-040 (1):** Evaluation of aquifer confinement:

Well	Aquifer or Proposed Aquifer	Confined	Unconfined
1	Interbedded volcanic, sedimentary and volcanoclastic rocks	<input checked="" type="checkbox"/>	<input type="checkbox"/>
		<input type="checkbox"/>	<input type="checkbox"/>
		<input type="checkbox"/>	<input type="checkbox"/>
		<input type="checkbox"/>	<input type="checkbox"/>
		<input type="checkbox"/>	<input type="checkbox"/>

Basis for aquifer confinement evaluation: Local well logs typically report static water levels that are somewhat above the depth that groundwater was first encountered. The regional aquifer is likely unconfined to poorly confined.

C2. **690-09-040 (2) (3):** Evaluation of distance to, and hydraulic connection with, surface water sources. All wells located a horizontal distance less than ¼ mile from a surface water source that produce water from an unconfined aquifer shall be assumed to be hydraulically connected to the surface water source. Include in this table any streams located beyond one mile that are evaluated for PSI.

Well	SW #	Surface Water Name	GW Elev ft msl	SW Elev ft msl	Distance (ft)	Hydraulically Connected?			Potential for Subst. Interfer. Assumed?	
						YES	NO	ASSUMED	YES	NO
1	1	Silver Creek	4160±	4178	1800	<input type="checkbox"/>	<input checked="" type="checkbox"/>	<input type="checkbox"/>	<input type="checkbox"/>	<input checked="" type="checkbox"/>
						<input type="checkbox"/>	<input type="checkbox"/>	<input type="checkbox"/>	<input type="checkbox"/>	<input type="checkbox"/>
						<input type="checkbox"/>	<input type="checkbox"/>	<input type="checkbox"/>	<input type="checkbox"/>	<input type="checkbox"/>
						<input type="checkbox"/>	<input type="checkbox"/>	<input type="checkbox"/>	<input type="checkbox"/>	<input type="checkbox"/>
						<input type="checkbox"/>	<input type="checkbox"/>	<input type="checkbox"/>	<input type="checkbox"/>	<input type="checkbox"/>
						<input type="checkbox"/>	<input type="checkbox"/>	<input type="checkbox"/>	<input type="checkbox"/>	<input type="checkbox"/>
						<input type="checkbox"/>	<input type="checkbox"/>	<input type="checkbox"/>	<input type="checkbox"/>	<input type="checkbox"/>
						<input type="checkbox"/>	<input type="checkbox"/>	<input type="checkbox"/>	<input type="checkbox"/>	<input type="checkbox"/>
						<input type="checkbox"/>	<input type="checkbox"/>	<input type="checkbox"/>	<input type="checkbox"/>	<input type="checkbox"/>

Basis for aquifer hydraulic connection evaluation: Groundwater does not appear to provide baseflow to surface water within one mile of the proposed well, based on the likely head relationship.

Water Availability Basin the well(s) are located within: Silver Cr > Harney Lake ab unn stream (31200408)

C3a. **690-09-040 (4):** Evaluation of stream impacts for each well that has been determined or assumed to be **hydraulically connected and less than 1 mile** from a surface water source. Limit evaluation to instream rights and minimum stream flows that are pertinent to that surface water source, and not lower SW sources to which the stream under evaluation is tributary. Compare the requested rate against the 1% of 80% natural flow for the pertinent Water Availability Basin (WAB). If Q is not distributed by well, use full rate for each well. Any checked box indicates the well is assumed to have the potential to cause PSI.

Well	SW #	Well < ¼ mile?	Qw > 5 cfs?	Instream Water Right ID	Instream Water Right Q (cfs)	Qw > 1% ISWR?	80% Natural Flow (cfs)	Qw > 1% of 80% Natural Flow?	Interference @ 30 days (%)	Potential for Subst. Interfer. Assumed?
		<input type="checkbox"/>	<input type="checkbox"/>			<input type="checkbox"/>		<input type="checkbox"/>		<input type="checkbox"/>
		<input type="checkbox"/>	<input type="checkbox"/>			<input type="checkbox"/>		<input type="checkbox"/>		<input type="checkbox"/>
		<input type="checkbox"/>	<input type="checkbox"/>			<input type="checkbox"/>		<input type="checkbox"/>		<input type="checkbox"/>
		<input type="checkbox"/>	<input type="checkbox"/>			<input type="checkbox"/>		<input type="checkbox"/>		<input type="checkbox"/>
		<input type="checkbox"/>	<input type="checkbox"/>			<input type="checkbox"/>		<input type="checkbox"/>		<input type="checkbox"/>
		<input type="checkbox"/>	<input type="checkbox"/>			<input type="checkbox"/>		<input type="checkbox"/>		<input type="checkbox"/>
		<input type="checkbox"/>	<input type="checkbox"/>			<input type="checkbox"/>		<input type="checkbox"/>		<input type="checkbox"/>
		<input type="checkbox"/>	<input type="checkbox"/>			<input type="checkbox"/>		<input type="checkbox"/>		<input type="checkbox"/>
		<input type="checkbox"/>	<input type="checkbox"/>			<input type="checkbox"/>		<input type="checkbox"/>		<input type="checkbox"/>

C3b. **690-09-040 (4):** Evaluation of stream impacts by total appropriation for all wells determined or assumed to be **hydraulically connected and less than 1 mile** from a surface water source. **Complete only if Q is distributed among wells.** Otherwise same evaluation and limitations apply as in C3a above.

SW #	Qw > 5 cfs?	Instream Water Right ID	Instream Water Right Q (cfs)	Qw > 1% ISWR?	80% Natural Flow (cfs)	Qw > 1% of 80% Natural Flow?	Interference @ 30 days (%)	Potential for Subst. Interfer. Assumed?
	<input type="checkbox"/>			<input type="checkbox"/>		<input type="checkbox"/>		<input type="checkbox"/>
	<input type="checkbox"/>			<input type="checkbox"/>		<input type="checkbox"/>		<input type="checkbox"/>
	<input type="checkbox"/>			<input type="checkbox"/>		<input type="checkbox"/>		<input type="checkbox"/>
	<input type="checkbox"/>			<input type="checkbox"/>		<input type="checkbox"/>		<input type="checkbox"/>

Comments: This section does not apply.

C4a. **690-09-040 (5):** Estimated impacts on **hydraulically connected surface water sources greater than one mile** as a percentage of the proposed pumping rate. Limit evaluation to the effects that will occur up to one year after pumping begins. This table encompasses the considerations required by 09-040 (5)(a), (b), (c) and (d), which are not included on this form. Use additional sheets if calculated flows from more than one WAB are required.

Non-Distributed Wells													
Well	SW#	Jan	Feb	Mar	Apr	May	Jun	Jul	Aug	Sep	Oct	Nov	Dec
		%	%	%	%	%	%	%	%	%	%	%	%
Well Q as CFS													
Interference CFS													
Distributed Wells													
Well	SW#	Jan	Feb	Mar	Apr	May	Jun	Jul	Aug	Sep	Oct	Nov	Dec
		%	%	%	%	%	%	%	%	%	%	%	%
Well Q as CFS													
Interference CFS													
		%	%	%	%	%	%	%	%	%	%	%	%
Well Q as CFS													
Interference CFS													
		%	%	%	%	%	%	%	%	%	%	%	%
Well Q as CFS													
Interference CFS													
		%	%	%	%	%	%	%	%	%	%	%	%
Well Q as CFS													
Interference CFS													
		%	%	%	%	%	%	%	%	%	%	%	%
Well Q as CFS													
Interference CFS													
(A) = Total Interf.													
(B) = 80 % Nat. Q													
(C) = 1 % Nat. Q													
(D) = (A) > (C)													
(E) = (A / B) x 100		%	%	%	%	%	%	%	%	%	%	%	%

(A) = total interference as CFS; (B) = WAB calculated natural flow at 80% exceed. as CFS; (C) = 1% of calculated natural flow at 80% exceed. as CFS; (D) = highlight the checkmark for each month where (A) is greater than (C); (E) = total interference divided by 80% flow as percentage.

Basis for impact evaluation: No calculations were performed here, due to the large distance where hydraulic connection likely occurs with surface water. However, it is clear that the proposed use will eventually have a negative impact on downstream flows in Silver Creek and, ultimately, with Harney Lake.

Lined area for additional text or comments.

C4b. **690-09-040 (5) (b) The potential to impair or detrimentally affect the public interest is to be determined by the Water Rights Section.**

- C5. **If properly conditioned**, the surface water source(s) can be adequately protected from interference, and/or ground water use under this permit can be regulated if it is found to substantially interfere with surface water:
 - i. The permit should contain condition #(s) _____;
 - ii. The permit should contain special condition(s) as indicated in "Remarks" below;

C6. **SW / GW Remarks and Conditions**

Lined area for SW / GW Remarks and Conditions.

References Used: Local well logs; local reviews; review of water level data collected at wells in the Weaver Springs area from 2009 to November 2012; GW Report 16, by Leonard, 1970; Greene, Walker, and Corcoran, 1972, Geologic Map of the Burns Quadrangle, Oregon, USGS Miscellaneous Geologic Investigations Map I-680; Harney Basin Groundwater Study, DRAFT Report by Aquaveo, LLC for the Harney County Watershed Council, November 2012; Memo by Ivan Gall, 1/15, 2008: Stream Assessment for Division 9 Review in the Malheur Lakes Basin.

Lined area for additional references or notes.

D. WELL CONSTRUCTION, OAR 690-200

D1. Well #: _____ Logid: _____

D2. **THE WELL does not meet current well construction standards based upon:**

- a. review of the well log;
- b. field inspection by _____;
- c. report of CWRE _____;
- d. other: (specify) _____

D3. **THE WELL construction deficiency:**

- a. constitutes a health threat under Division 200 rules;
- b. commingles water from more than one ground water reservoir;
- c. permits the loss of artesian head;
- d. permits the de-watering of one or more ground water reservoirs;
- e. other: (specify) _____

D4. **THE WELL construction deficiency is described as follows:** _____

D5. **THE WELL** a. was, or was not constructed according to the standards in effect at the time of original construction or most recent modification.

b. I don't know if it met standards at the time of construction.

D6. **Route to the Enforcement Section.** I recommend withholding issuance of the permit until evidence of well reconstruction is filed with the Department and approved by the Enforcement Section and the Ground Water Section.

THIS SECTION TO BE COMPLETED BY ENFORCEMENT PERSONNEL

D7. Well construction deficiency has been corrected by the following actions: _____

_____, 200____.
(Enforcement Section Signature)

D8. **Route to Water Rights Section (attach well reconstruction logs to this page).**

Application G-17663, Phillip and Lorissa Singhose

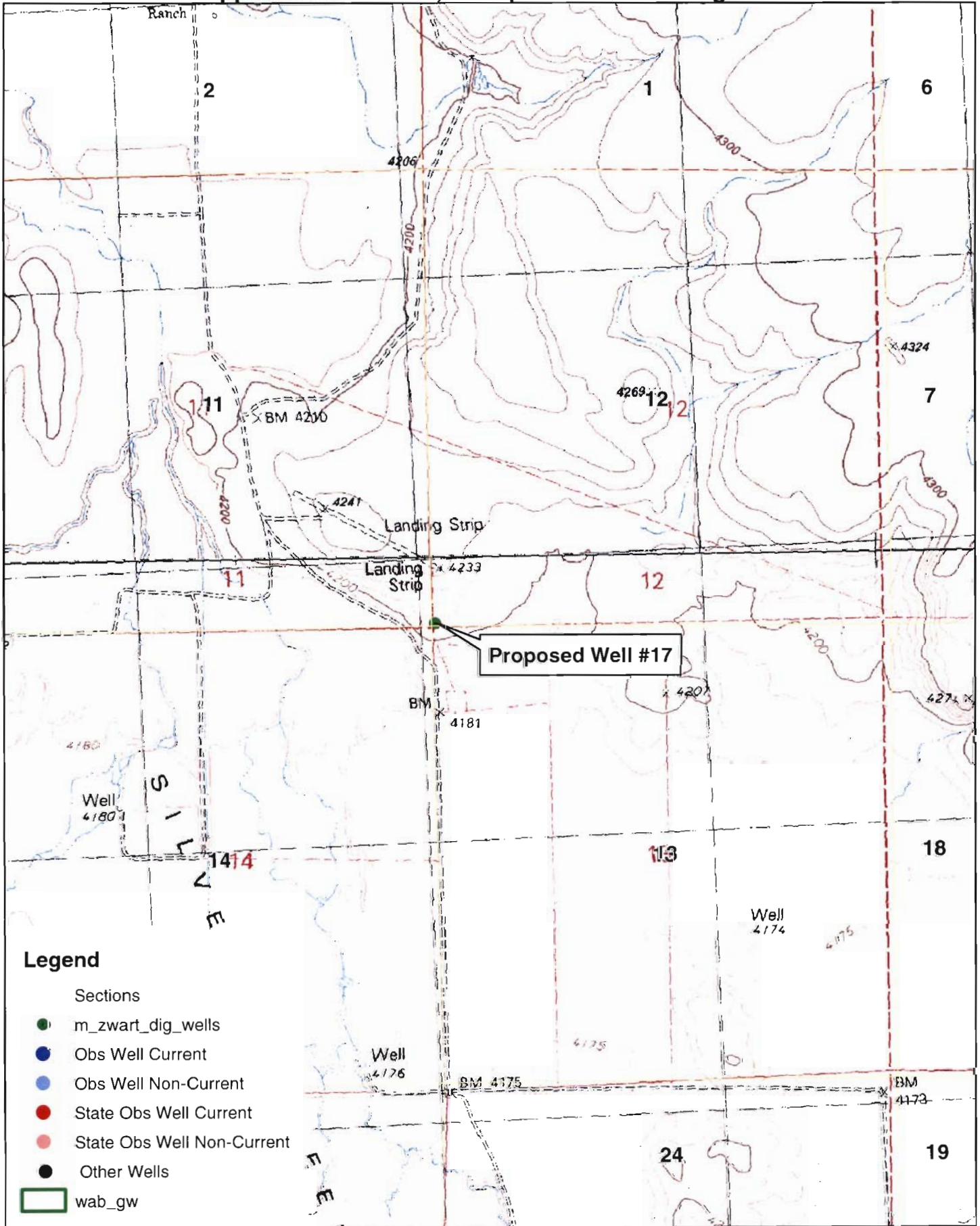

Legend

- Sections
- m_zwart_dig_wells
- Obs Well Current
- Obs Well Non-Current
- State Obs Well Current
- State Obs Well Non-Current
- Other Wells
- ▭ wab_gw



