

  
**PRELIMINARY TITLE REPORT**

RECEIVED  
JAN 03 2007  
WATER RESOURCES DEPT.  
SALEM, OREGON

WELLS FARGO HOME MORTGAGE-HERMISTON  
Attn: MELISA  
130 NE 2ND STREET  
HERMISTON, OR 97838

June 13, 2006  
**Report #1**  
Title Number : HM0057084CG  
Title Officer : Betty Lesko  
Escrow Officer: Chris Gibbs

**Policy or Policies to be issued:**                      Liability                      Premium  
EXTENDED LENDER'S POLICY  
Proposed Insured: WELLS FARGO BANK, N.A.

End. Alta 9, 8.1, 116, Alta 7

We are prepared to issue 1992 ALTA title insurance policy(ies) of CHICAGO TITLE INSURANCE COMPANY OF OREGON, in the usual form insuring the title to the land described as follows:

***Parcel 1, Partition Plat No. 2002-07, located in the Southwest Quarter Section 34, Township 5 North, Range 28, East of the Willamette Meridian, Umatilla County, Oregon, filed February 14, 2002, Instrument No. 2002-4060427, Plat Records, Umatilla County, Oregon.***

and dated as of May 30, 2006 at 8:00 A.M. , title is vested in

***JAMES R. SHELLEY AND MARJORIE SHELLEY,***  
***as tenants by the entirety***

The estate or interest in the land described or referred to in this Commitment and covered herein is:

Fee Simple

Schedule B of the policy(ies) to be issued will contain the following general and special exceptions unless removed prior to issuance:

**GENERAL EXCEPTIONS:**

1. Taxes or assessments which are not shown as existing liens by the records of any taxing authority that levies taxes or assessments on real property or by the public records. Proceedings by a public agency which may result in taxes or assessments, or notices of such proceedings, whether or not shown by the records of such agency or by the public records.
2. Easements, liens, encumbrances, interests or claims thereof which are not shown by the public records. Any facts, rights, interests or claims which are not shown by the public records but which could be ascertained by an inspection of the land or by making inquiry of persons in possession thereof.
3. Discrepancies, conflicts in boundary lines, shortage in area, encroachments, or any other facts which a correct survey would disclose, and which are not shown by the public records.
4. (a) Unpatented mining claims; (b) Reservations or exceptions in patents or in Acts authorizing the issuance thereof; (c) Water rights, claims or title to water whether or not the matters excepted under (a), (b), or (c) are shown by the public records.
5. Any lien or right to a lien, for services, labor or material heretofore or hereafter furnished, imposed by law not shown by the public records.



3 34

CO. RD.

(JOY LANE)

NO. 1256

(NO. 707)

LANE

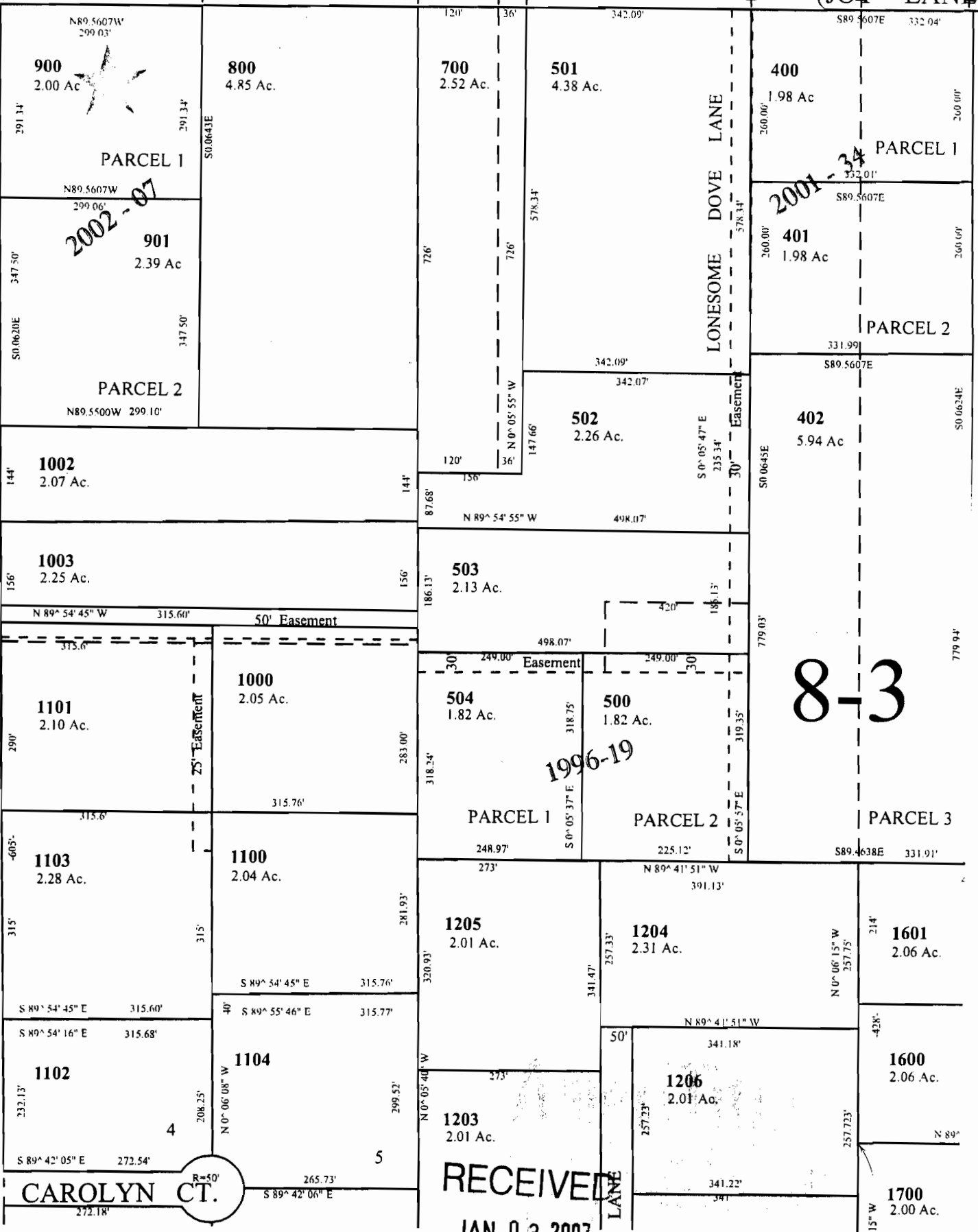

8-3

RECEIVED

JAN 03 2007

WATER RESOURCES DEPT. SALEM, OREGON

See Map 5N 28C