

Water Right Conditions Tracking Slip

Groundwater/Hydrology Section

FILE # # G-17716
ROUTED TO: Water Rights - Kerry
TOWNSHIP/
RANGE-SECTION: 45 / 1W-19

CONDITIONS ATTACHED?: yes no

REMARKS OR FURTHER INSTRUCTIONS:

Reviewer: Mike Zwart

PUBLIC INTEREST REVIEW FOR GROUNDWATER APPLICATIONS

TO: Water Rights Section Date October 14, 2013

FROM: Groundwater Section Mike Zwart
Reviewer's Name

SUBJECT: Application G- 17716 Supersedes review of _____
Date of Review(s)

PUBLIC INTEREST PRESUMPTION; GROUNDWATER

OAR 690-310-130 (1) *The Department shall presume that a proposed groundwater use will ensure the preservation of the public welfare, safety and health as described in ORS 537.525.* Department staff review ground water applications under OAR 690-310-140 to determine whether the presumption is established. OAR 690-310-140 allows the proposed use be modified or conditioned to meet the presumption criteria. **This review is based upon available information and agency policies in place at the time of evaluation.**

A. GENERAL INFORMATION: Applicant's Name: Brian and Bridget DuPont County: Marion

A1. Applicant(s) seek(s) 0.111 cfs from one well(s) in the Willamette Basin,
 _____ subbasin Quad Map: Woodburn

A2. Proposed use Irrigation, 11.49 acres Seasonality: June 1 to August 31
 A3. Well and aquifer data (**attach and number logs for existing wells; mark proposed wells as such under logid**):

Well	Logid	Applicant's Well #	Proposed Aquifer*	Proposed Rate(cfs)	Location (T/R-S QQ-Q)	Location, metes and bounds, e.g. 2250' N, 1200' E fr NW cor S 36
1	Proposed	1	Alluvium	0.111	4S/1W-19 SE-NW	750' N, 1000' E fr SW cor DLC #47
2						
3						
4						
5						

* Alluvium, CRB, Bedrock

Well	Well Elev ft msl	First Water ft bls	SWL ft bls	SWL Date	Well Depth (ft)	Seal Interval (ft)	Casing Intervals (ft)	Liner Intervals (ft)	Perforations Or Screens (ft)	Well Yield (gpm)	Draw Down (ft)	Test Type
1	172				180				170-180?			

Use data from application for proposed wells.

A4. **Comments: Minimal proposed well construction information was provided. The seal interval and perforated interval were not specified. I am assuming that the seal will be the minimum required and the perforated interval will be at the bottom of the well, which could be significantly shallower than 180 feet based on local well logs.**

A5. **Provisions of the Willamette** _____ Basin rules relative to the development, classification and/or management of ground water hydraulically connected to surface water are, or are not, activated by this application. (Not all basin rules contain such provisions.)

Comments: _____

A6. Well(s) # _____, _____, _____, _____, _____, tap(s) an aquifer limited by an administrative restriction. Name of administrative area: _____
 Comments: _____

B. GROUND WATER AVAILABILITY CONSIDERATIONS, OAR 690-310-130, 400-010, 410-0070

B1. **Based upon available data**, I have determined that ground water* for the proposed use:

- a. is over appropriated, is not over appropriated, or **cannot be determined to be** over appropriated during any period of the proposed use. * This finding is limited to the ground water portion of the over-appropriation determination as prescribed in OAR 690-310-130;
- b. **will not** or **will** likely be available in the amounts requested without injury to prior water rights. * This finding is limited to the ground water portion of the injury determination as prescribed in OAR 690-310-130;
- c. **will not** or **will** likely to be available within the capacity of the ground water resource; or
- d. **will, if properly conditioned**, avoid injury to existing ground water rights or to the ground water resource:
 - i. The permit should contain condition #(s) 7C, 7T;
 - ii. The permit should be conditioned as indicated in item 2 below.
 - iii. The permit should contain special condition(s) as indicated in item 3 below;

- B2. a. **Condition** to allow ground water production from no deeper than _____ ft. below land surface;
- b. **Condition** to allow ground water production from no shallower than _____ ft. below land surface;
- c. **Condition** to allow ground water production only from the _____ ground water reservoir between approximately _____ ft. and _____ ft. below land surface;
- d. **Well reconstruction** is necessary to accomplish one or more of the above conditions. The problems that are likely to occur with this use and without reconstructing are cited below. Without reconstruction, I recommend withholding issuance of the permit until evidence of well reconstruction is filed with the Department and approved by the Ground Water Section.

Describe injury –as related to water availability– that is likely to occur without well reconstruction (interference w/ senior water rights, not within the capacity of the resource, etc): _____

B3. **Ground water availability remarks: Nearby observation wells have displayed some long-term declines. However, the requested rate and period of use here is not likely to cause significant impacts to the resource or other groundwater users.**

C. GROUND WATER/SURFACE WATER CONSIDERATIONS, OAR 690-09-040

C1. **690-09-040 (1):** Evaluation of aquifer confinement:

Well	Aquifer or Proposed Aquifer	Confined	Unconfined
1	Sand, gravel, silt and clay, likely the Willamette aquifer	<input checked="" type="checkbox"/>	<input type="checkbox"/>
		<input type="checkbox"/>	<input type="checkbox"/>
		<input type="checkbox"/>	<input type="checkbox"/>
		<input type="checkbox"/>	<input type="checkbox"/>
		<input type="checkbox"/>	<input type="checkbox"/>

Basis for aquifer confinement evaluation: Local well logs indicate that the shallow water-bearing zone is confined to semiconfined below the Willamette silt.

C2. **690-09-040 (2) (3):** Evaluation of distance to, and hydraulic connection with, surface water sources. All wells located a horizontal distance less than ¼ mile from a surface water source that produce water from an unconfined aquifer shall be assumed to be hydraulically connected to the surface water source. Include in this table any streams located beyond one mile that are evaluated for PSI.

Well	SW #	Surface Water Name	GW Elev ft msl	SW Elev ft msl	Distance (ft)	Hydraulically Connected?			Potential for Subst. Interfer. Assumed?	
						YES	NO	ASSUMED	YES	NO
1	1	Case Creek	140±	115	5250	<input checked="" type="checkbox"/>	<input type="checkbox"/>	<input type="checkbox"/>	<input type="checkbox"/>	<input checked="" type="checkbox"/>
						<input type="checkbox"/>	<input type="checkbox"/>	<input type="checkbox"/>	<input type="checkbox"/>	<input type="checkbox"/>
						<input type="checkbox"/>	<input type="checkbox"/>	<input type="checkbox"/>	<input type="checkbox"/>	<input type="checkbox"/>
						<input type="checkbox"/>	<input type="checkbox"/>	<input type="checkbox"/>	<input type="checkbox"/>	<input type="checkbox"/>
						<input type="checkbox"/>	<input type="checkbox"/>	<input type="checkbox"/>	<input type="checkbox"/>	<input type="checkbox"/>
						<input type="checkbox"/>	<input type="checkbox"/>	<input type="checkbox"/>	<input type="checkbox"/>	<input type="checkbox"/>
						<input type="checkbox"/>	<input type="checkbox"/>	<input type="checkbox"/>	<input type="checkbox"/>	<input type="checkbox"/>
						<input type="checkbox"/>	<input type="checkbox"/>	<input type="checkbox"/>	<input type="checkbox"/>	<input type="checkbox"/>

Basis for aquifer hydraulic connection evaluation: The head relationship suggests that groundwater discharges to the nearby reaches of surface water sources. Case Creek is also likely incised through the Willamette Silt, allowing shallow water-bearing zones to have a relatively efficient hydraulic connection.

Water Availability Basin the well(s) are located within: Willamette R > Columbia R ab Molalla R (182).

C3a. **690-09-040 (4):** Evaluation of stream impacts for each well that has been determined or assumed to be **hydraulically connected and less than 1 mile** from a surface water source. Limit evaluation to instream rights and minimum stream flows that are pertinent to that surface water source, and not lower SW sources to which the stream under evaluation is tributary. Compare the requested rate against the 1% of 80% natural flow for the pertinent Water Availability Basin (WAB). If Q is not distributed by well, use full rate for each well. Any checked box indicates the well is assumed to have the potential to cause PSI.

Well	SW #	Well < ¼ mile?	Qw > 5 cfs?	Instream Water Right ID	Instream Water Right Q (cfs)	Qw > 1% ISWR?	80% Natural Flow (cfs)	Qw > 1% of 80% Natural Flow?	Interference @ 30 days (%)	Potential for Subst. Interfer. Assumed?
1	1	<input type="checkbox"/>	<input type="checkbox"/>	182	1500	<input type="checkbox"/>	3890	<input type="checkbox"/>	<25%	<input type="checkbox"/>
		<input type="checkbox"/>	<input type="checkbox"/>			<input type="checkbox"/>		<input type="checkbox"/>		<input type="checkbox"/>
		<input type="checkbox"/>	<input type="checkbox"/>			<input type="checkbox"/>		<input type="checkbox"/>		<input type="checkbox"/>
		<input type="checkbox"/>	<input type="checkbox"/>			<input type="checkbox"/>		<input type="checkbox"/>		<input type="checkbox"/>
		<input type="checkbox"/>	<input type="checkbox"/>			<input type="checkbox"/>		<input type="checkbox"/>		<input type="checkbox"/>
		<input type="checkbox"/>	<input type="checkbox"/>			<input type="checkbox"/>		<input type="checkbox"/>		<input type="checkbox"/>
		<input type="checkbox"/>	<input type="checkbox"/>			<input type="checkbox"/>		<input type="checkbox"/>		<input type="checkbox"/>

C3b. **690-09-040 (4):** Evaluation of stream impacts by total appropriation for all wells determined or assumed to be **hydraulically connected and less than 1 mile** from a surface water source. **Complete only if Q is distributed among wells.** Otherwise same evaluation and limitations apply as in C3a above.

	SW #		Qw > 5 cfs?	Instream Water Right ID	Instream Water Right Q (cfs)	Qw > 1% ISWR?	80% Natural Flow (cfs)	Qw > 1% of 80% Natural Flow?	Interference @ 30 days (%)	Potential for Subst. Interfer. Assumed?
			<input type="checkbox"/>			<input type="checkbox"/>		<input type="checkbox"/>		<input type="checkbox"/>
			<input type="checkbox"/>			<input type="checkbox"/>		<input type="checkbox"/>		<input type="checkbox"/>
			<input type="checkbox"/>			<input type="checkbox"/>		<input type="checkbox"/>		<input type="checkbox"/>
			<input type="checkbox"/>			<input type="checkbox"/>		<input type="checkbox"/>		<input type="checkbox"/>

Comments: _____

C4a. **690-09-040 (5):** Estimated impacts on **hydraulically connected surface water sources greater than one mile** as a percentage of the proposed pumping rate. Limit evaluation to the effects that will occur up to one year after pumping begins. This table encompasses the considerations required by 09-040 (5)(a), (b), (c) and (d), which are not included on this form. Use additional sheets if calculated flows from more than one WAB are required.

Non-Distributed Wells													
Well	SW#	Jan	Feb	Mar	Apr	May	Jun	Jul	Aug	Sep	Oct	Nov	Dec
		%	%	%	%	%	%	%	%	%	%	%	%
Well Q as CFS													
Interference CFS													
Distributed Wells													
Well	SW#	Jan	Feb	Mar	Apr	May	Jun	Jul	Aug	Sep	Oct	Nov	Dec
		%	%	%	%	%	%	%	%	%	%	%	%
Well Q as CFS													
Interference CFS													
		%	%	%	%	%	%	%	%	%	%	%	%
Well Q as CFS													
Interference CFS													
		%	%	%	%	%	%	%	%	%	%	%	%
Well Q as CFS													
Interference CFS													
		%	%	%	%	%	%	%	%	%	%	%	%
Well Q as CFS													
Interference CFS													
		%	%	%	%	%	%	%	%	%	%	%	%
Well Q as CFS													
Interference CFS													
(A) = Total Interf.													
(B) = 80 % Nat. Q													
(C) = 1 % Nat. Q													
(D) = (A) > (C)		✓	✓	✓	✓	✓	✓	✓	✓	✓	✓	✓	✓
(E) = (A / B) x 100		%	%	%	%	%	%	%	%	%	%	%	%

(A) = total interference as CFS; (B) = WAB calculated natural flow at 80% exceed. as CFS; (C) = 1% of calculated natural flow at 80% exceed. as CFS; (D) = highlight the checkmark for each month where (A) is greater than (C); (E) = total interference divided by 80% flow as percentage.

Basis for impact evaluation: _____

C4b. **690-09-040 (5) (b) The potential to impair or detrimentally affect the public interest is to be determined by the Water Rights Section.**

C5. **If properly conditioned**, the surface water source(s) can be adequately protected from interference, and/or ground water use under this permit can be regulated if it is found to substantially interfere with surface water:
i. The permit should contain condition #(s) _____;
ii. The permit should contain special condition(s) as indicated in "Remarks" below;

C6. **SW / GW Remarks and Conditions** _____

References Used: Gannett, Marshall W., and Caldwell, Rodney R., 1998, Geologic Framework of the Willamette Lowland Aquifer System, Oregon and Washington: U. S. Geological Survey Professional Paper 1424-A, 32p, 8 plates.

Conlon and others, 2005, Ground-water hydrology of the Willamette Basin, Oregon: U.S Geological Survey Scientific Investigations Report 2005-5168.

Woodward and others, 1998, Hydrogeologic framework of the Willamette lowland aquifer system, Oregon and Washington: U.S. Geological Survey Professional Paper 1424-B,

Nearby well logs and application reviews, especially T-9545 and G-15879.

D. WELL CONSTRUCTION, OAR 690-200

D1. Well #: _____ Logid: _____

D2. **THE WELL does not appear to meet current well construction standards based upon:**

- a. review of the well log;
- b. field inspection by _____;
- c. report of CWRE _____;
- d. other: (specify) _____

D3. **THE WELL construction deficiency or other comment is described as follows:** _____

D4. **Route to the Well Construction and Compliance Section for a review of existing well construction.**

Water Availability Tables

Application G-17716, Brian and Bridget DuPont

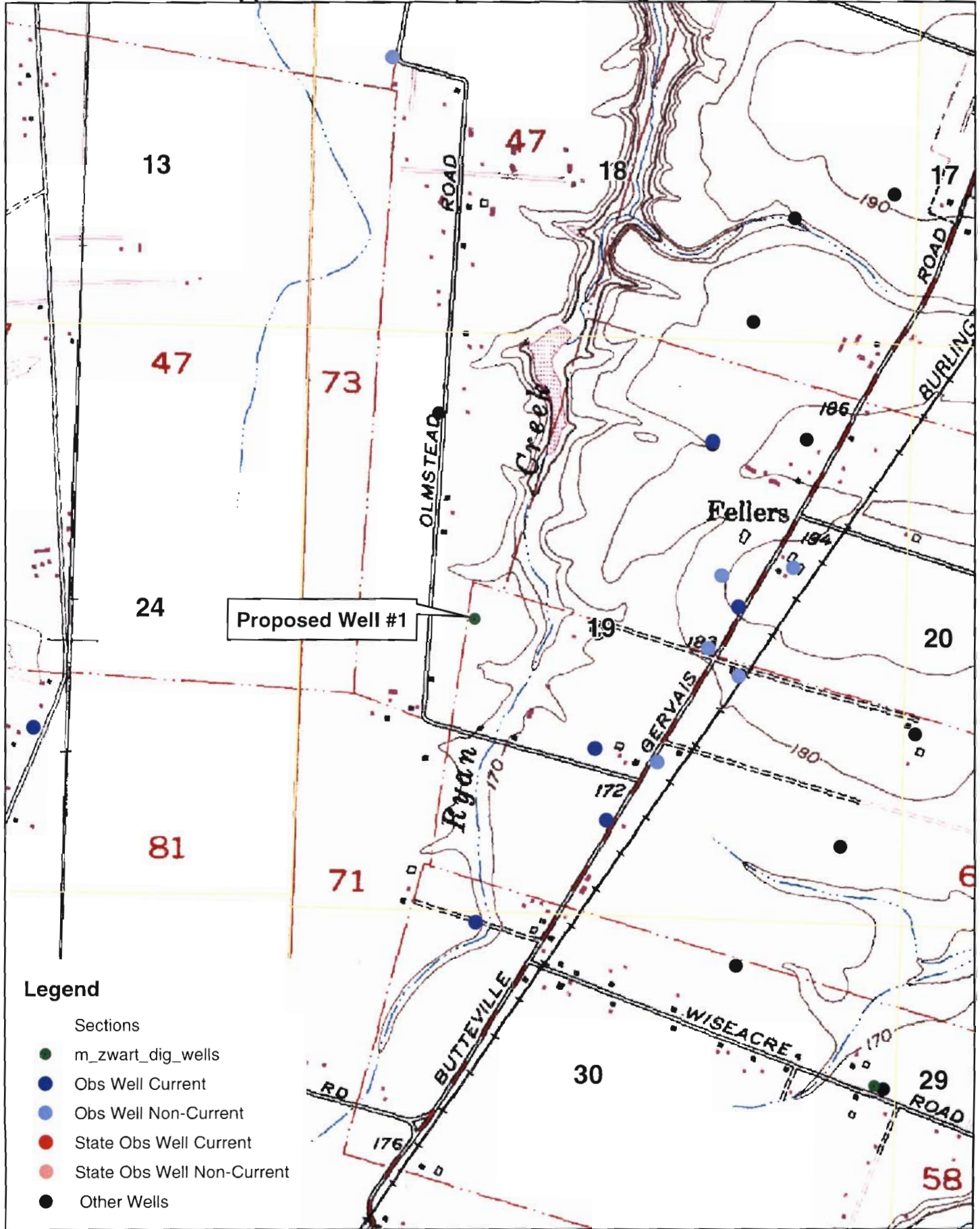

Legend

Sections

- m_zwart_dig_wells
- Obs Well Current
- Obs Well Non-Current
- State Obs Well Current
- State Obs Well Non-Current
- Other Wells

