

0 660 1,320 2,640 3,960 5,280 Feet

1" = 1320'

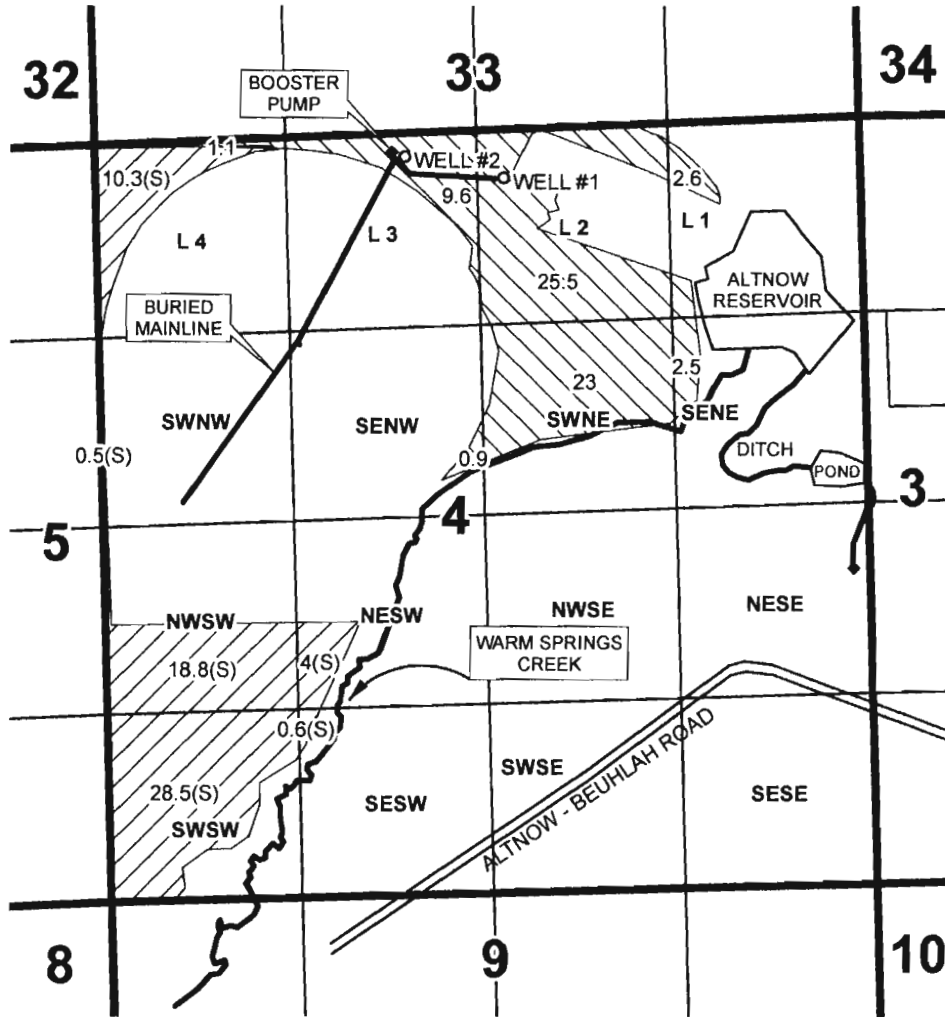

# T 20 S, R 36 E, WM SECTION 4, TL 500 HARNEY COUNTY, OREGON





WELL #1 - 375' S, 200' E FROM SECTION 4 N 1/4 CORNER  
 WELL #2 - 180' S, 500' W FROM SECTION 4 N 1/4 CORNER  
 TL 500 EXCEEDS 3,000 ACRES INCLUDING ALL OF SEC. 4

RECEIVED BY OWRD

OCT 21 2013

SALEM, OR

-  PROPOSED GROUND WATER PRIMARY
-  PROPOSED GROUND WATER SUPPLEMENTAL (S)

**GROUND WATER APPLICATION MAP  
for COTTONWOOD CREEK RANCH**

PROJECT # 13061      AUG 27, 2013

This map is not intended to provide legal dimensions or locations of property ownership lines.

**WATER RIGHT SERVICES, LLC**  
 PO BOX 1830, BEND, OR 97709  
**WWW.OREGONWATER.US 541-389-2837**

johnshort@usa.com

617728