

RECEIVED BY OWRD

GROUND WATER APPLICATION MAP FOR HAT ROCK WATER CO. INC. T5N, R29E, WM

APR 24 2015

SALEM, OR

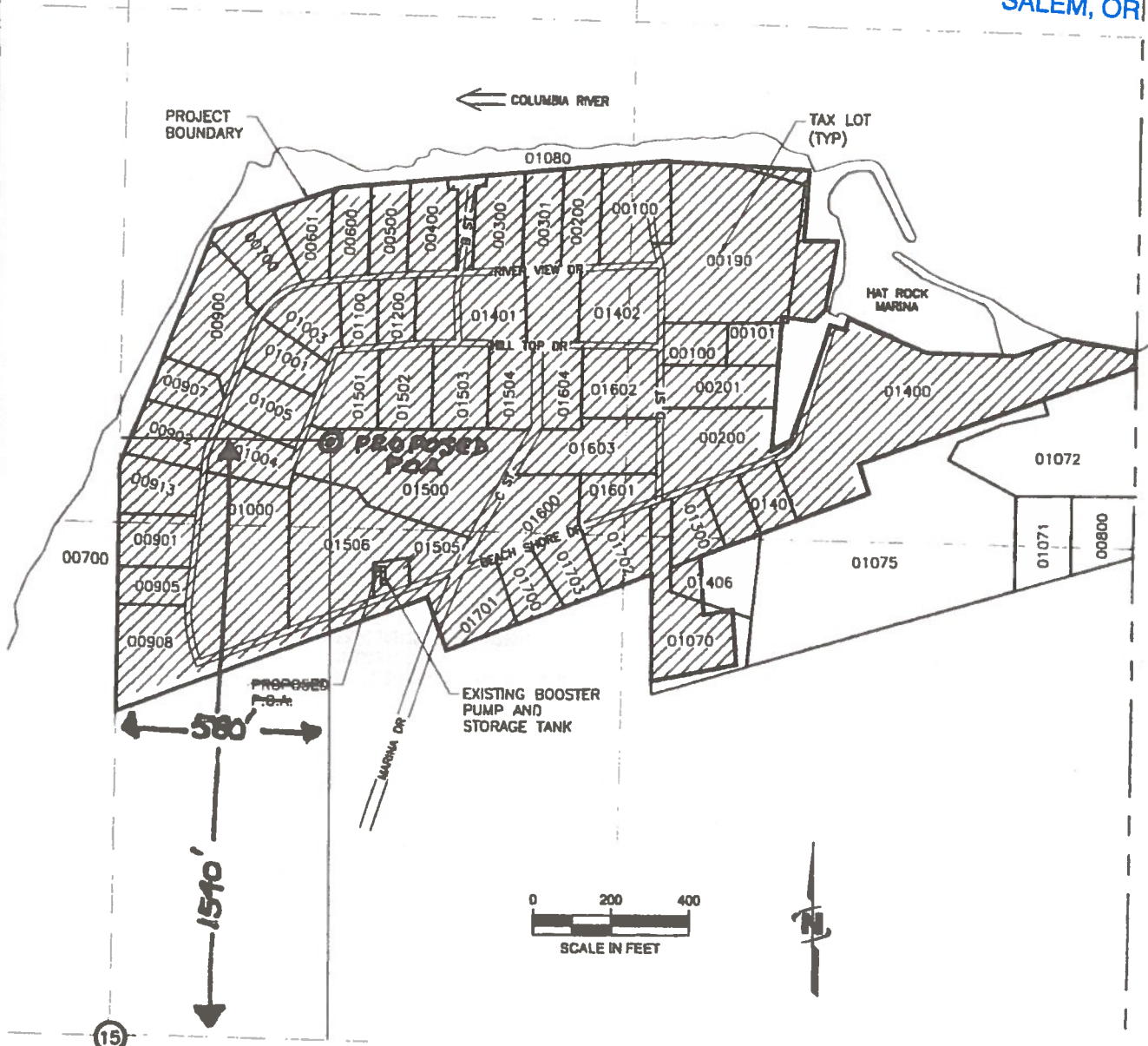

15 - C 1/4 CORNER SEC 15

QUASI MUNICIPAL USE FOR 62 HOUSEHOLDS

PROPOSED P.O.A. 1540' 580'
WELL LOCATED 1220' N AND 885' E FROM
THE CENTER OF SEC 15, T5N., R29E, WM.

RECEIVED BY OWRD

FEB 24 2014

SALEM, OR

Wayne A Credit - Pres. HRWC
4-21-15

NOTE:
THE PURPOSE OF THIS MAP IS TO IDENTIFY THE APPROXIMATE LOCATION
OF THE WATER RIGHT. IT IS NOT INTENDED TO PROVIDE INFORMATION
RELATIVE TO THE LOCATION OF PROPERTY OWNERSHIP BOUNDARY LINES

DRAWING: F:\Project\30-08-016 - Parfly Water Rights Consulting\--00 Misc Engineering\Cad\HAT ROCK\3522 HAT ROCK WATER CO.dwg
PRINTED BY: rwillard on 02/19/14 05 05 AM

G-17794