



I, L. E. Lucas, of John Day, Oregon do hereby certify that this map was made from notes taken during an actual survey made by me on January 15, 1911, and that it correctly represents the works described in the accompanying application together with the location of streams and other ditches in the immediate vicinity and has written thereon the area in each smallest legal subdivision in which it is proposed to irrigate.

*L. E. Lucas*  
Surveyor

Length of Ditch --- 30,360 feet  
 Width of Ditch --- 7 feet  
 Height of Dam --- 5 feet  
 Length of Dam --- 35 feet on top  
 Dam to be of logs, straw, brush & earth  
 Power Head --- 15 feet

Wasteway, through and over  
 Average grade --- 6 ft. per mile  
 Amount of water diverted --- 17.5 acre ft.  
 Area to be irrigated --- 7,100 acres

Enlargement of the old McKernan ditch at present diverting 4 second feet and irrigating 2.3 acres shown by tinting on under side 12.5 second feet to be used for irrigation, balance in connection with Beach Creek waters to be used for developing power for lighting purposes, also for operating a pump to elevate water into a lateral 25 feet above main ditch.

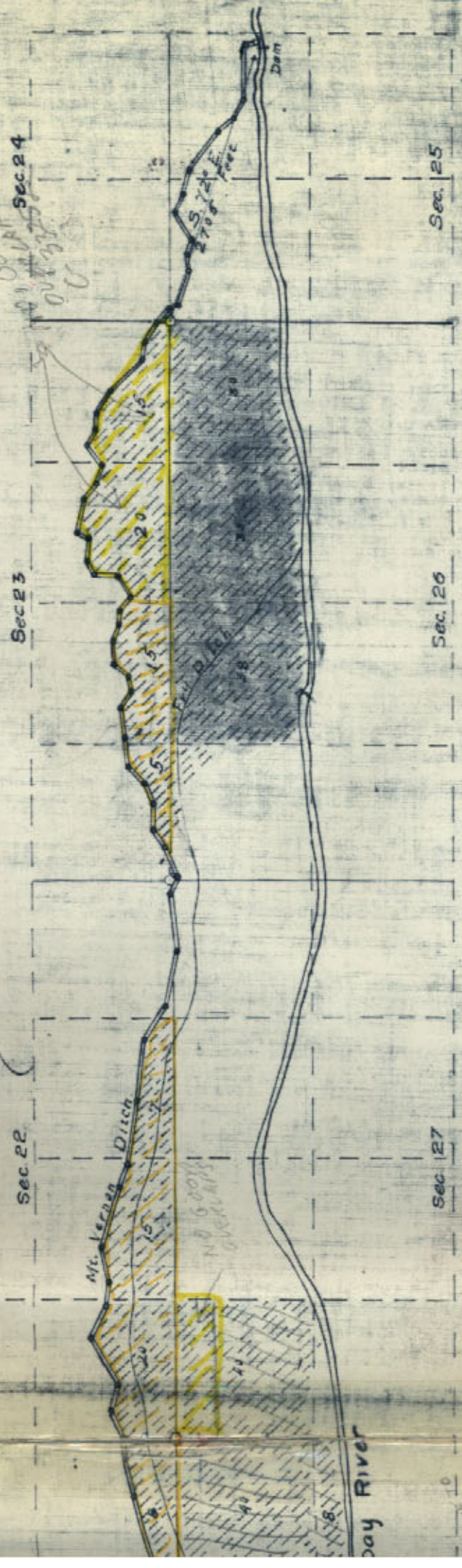

# MT. VERNON DITCH

Irrigation Power  
 Mt. Vernon Ditch Co., Incorporated.  
 Appropriator.



Scale.

