

T9S, R39E, Sections 2 and 11, Willamette Meridian

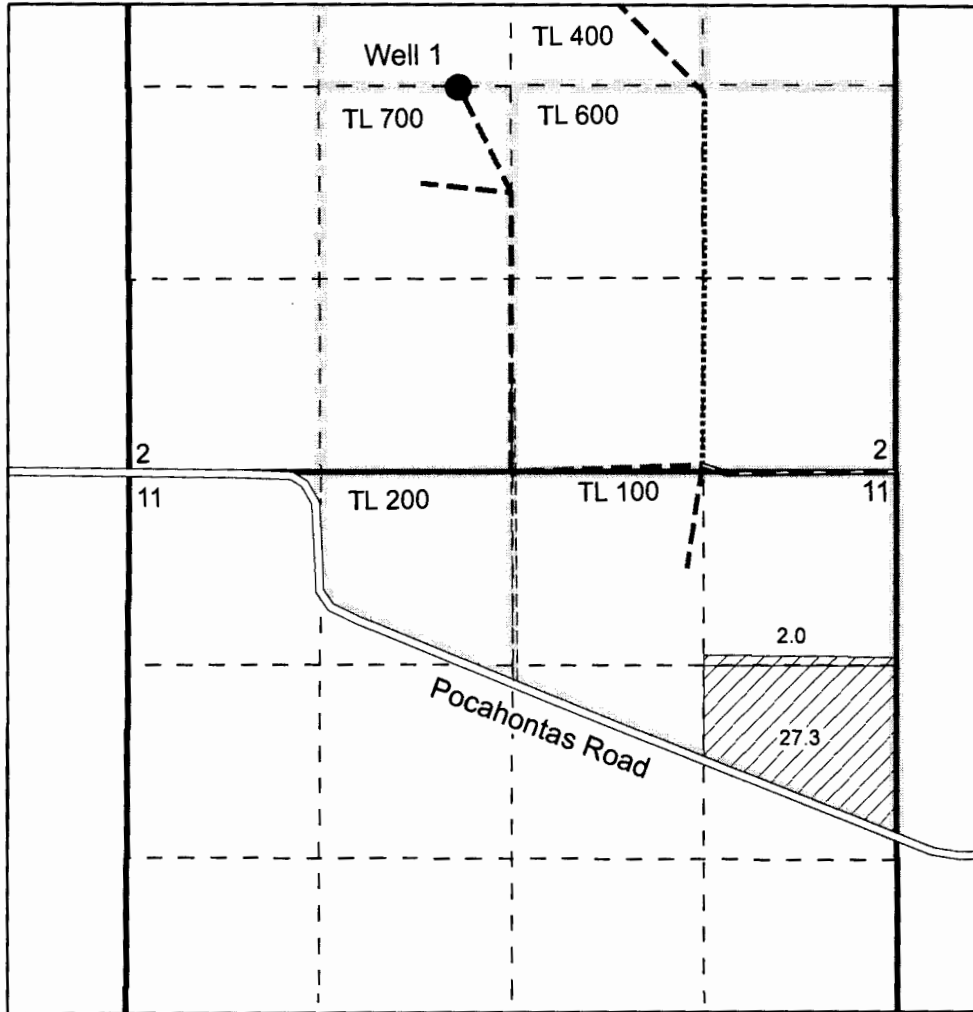

- Existing Well
- ==== Dirt Road
- ==== Paved road
- ..... 12" PVC Mainline
- - - 8" PVC Mainline
- 6" PVC Mainline
- Tax lot lines
- - - Quarter quarter line
- Section line
- ▨ Proposed primary water right



*Expires 12/31/2014*

RECEIVED BY OWRD

MAR 06 2014

SALEM, OR

This map is not intended to provide legal dimensions or locations of property ownership lines

Well 1 (original well log 51383 and repair well log 51614) is located 2,305 feet east and 2,680 feet north of the southwest corner of Section 2, T9S, R39E.

0 660 1,320  
  
 Feet  
 1 inch = 1,320 feet



Nancy Rorick Consulting  
541-519-3644

Groundwater Permit Application  
Tax Lots 200 and 700  
John A. and Kathryn M. Rohner

G-17787