

MAP TO ACCOMPANY CLAIM OF BENEFICIAL USE

SECTIONS 17, 18, 19, 20, 21, 28 & 29
TOWNSHIP 35 SOUTH, RANGE 21 EAST, W.M.
LAKE COUNTY, OREGON

APPLICATION NO. **R-70484**
PERMIT NO. **R-11347**

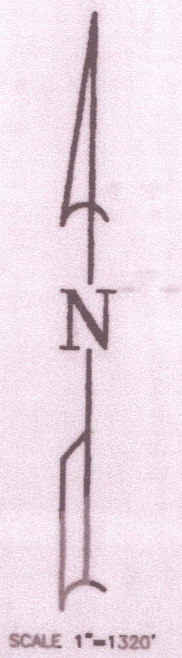

CHEWAUCAN RIVER

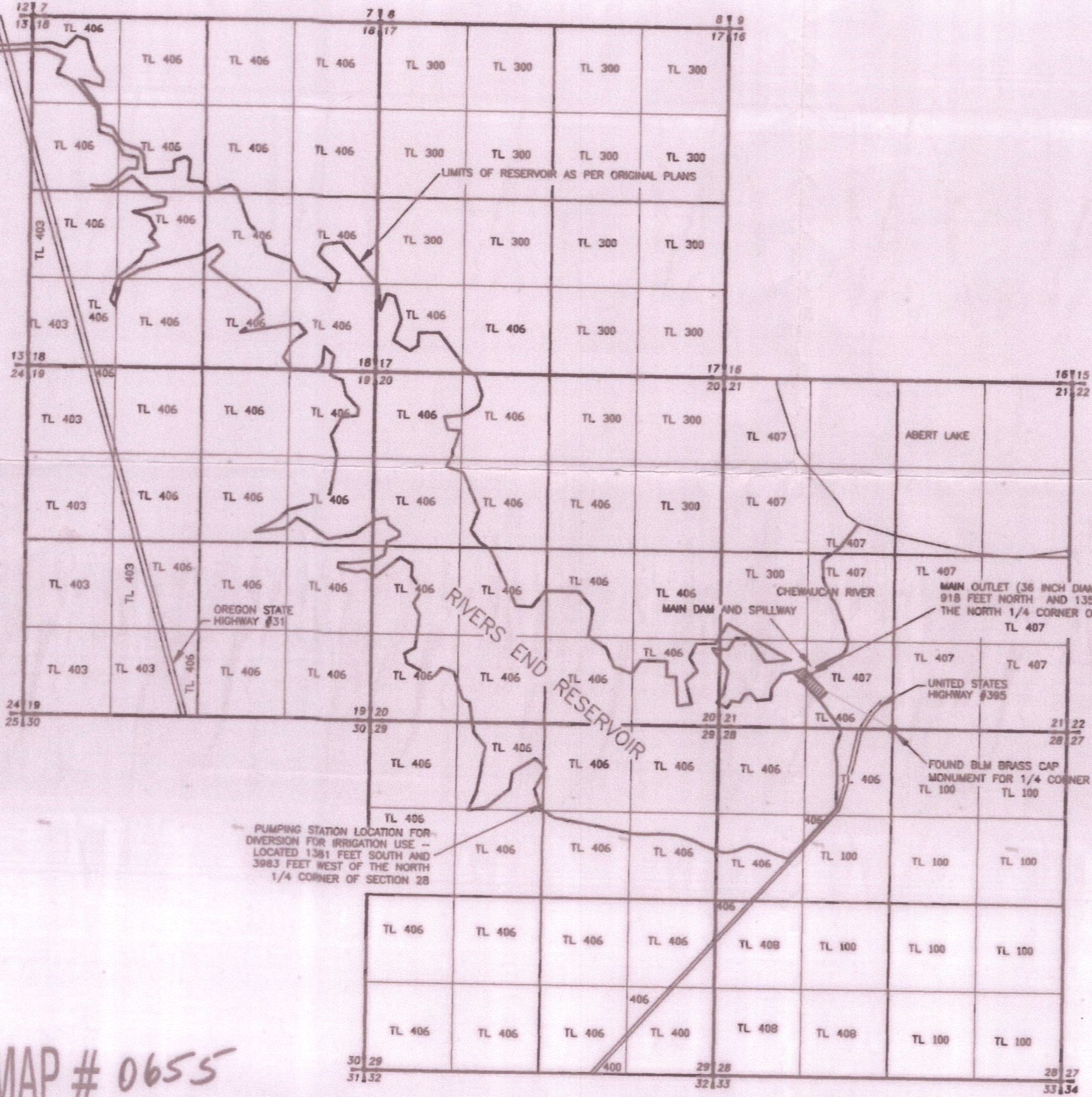

SPILLWAY CREST OF RESERVOIR AT ELEVATION 4280
RESERVOIR CAPACITY 1839 ACRE-FEET
RESERVOIR AREA (FULL) 650 ACRES

CREST ELEVATION VERIFIED IN FIELD
CAPACITY AND AREA AS PER CONSTRUCTION PLANS

RECEIVED
FEB 10 2012
WATER RESOURCES DEPT
SALEM, OREGON

LEGEND
— SECTION LINE
— 1/4 SECTION LINE
— 1/16 SECTION LINE

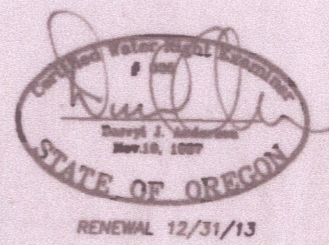

NOTE: PREPARATION OF THIS MAP IS FOR IDENTIFYING PROPOSED WATER RIGHTS ONLY. IT HAS NO INTENT TO PROVIDE LOCATIONS OR DIMENSIONS OF PROPERTY BOUNDARIES.

PUMPING STATION LOCATION FOR DIVERSION FOR IRRIGATION USE -- LOCATED 1381 FEET SOUTH AND 3983 FEET WEST OF THE NORTH 1/4 CORNER OF SECTION 28

COBU MAP # 0655

PREPARED FOR: WAYNE CLARK 66 LEVERONI COURT SUITE 200 NOVATO, CA 94949	
PREPARED BY: ANDERSON ENGINEERING & SURVEYING, INC. P.O. BOX 28 LAKEVIEW, OREGON 97630 (541) 947-4407 FAX 947-2321	
DATE: SEPT 2011	DWG. FILE: 2009-081
JOB NO.: 2009-081	SHEET 1 OF 1