

T8S, R3W, WM

MARION COUNTY

TAX LOT:
083W34 01000

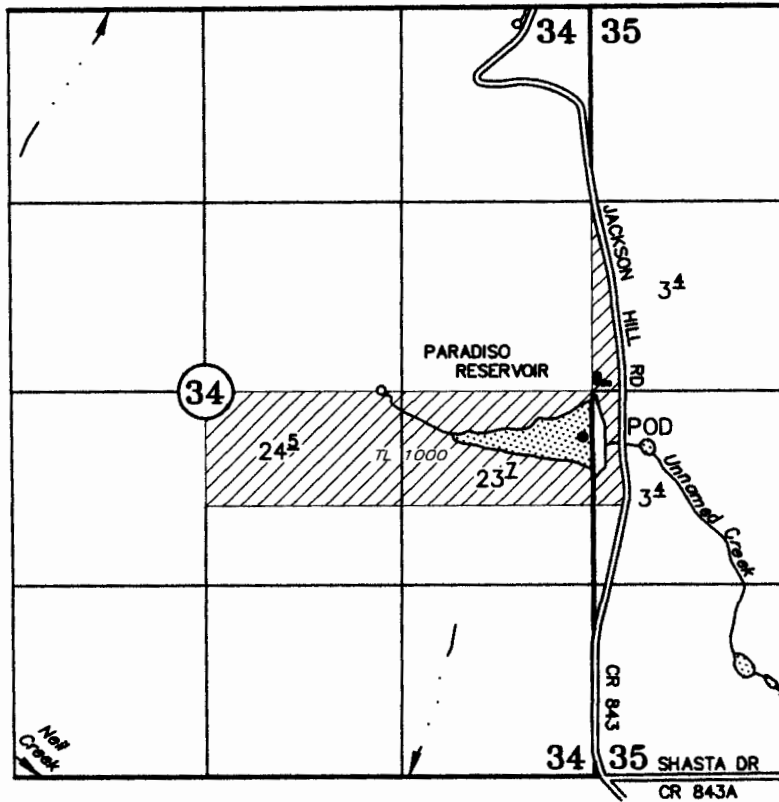

POD: 315' S & 70' W OF E 1/4 COR SEC 34

APPLICATION TO APPROPRIATE SURFACE WATER UNDER

Application No. _____ Permit No. _____

IN THE NAME OF

Meduri Farms, Inc.

FEBRUARY 28, 2014

SCALE: 1" = 1320'

RECEIVED

MAR 13 2014

WATER RESOURCES DEPT
SALEM, OREGON

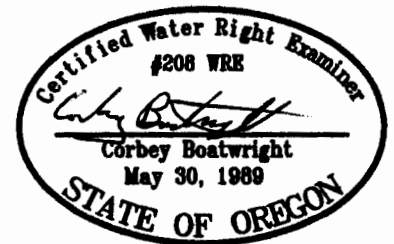

NOTE: This map is not intended to provide legal dimensions or locations of property ownership lines.

EXPIRES 12-31-15

S-87766