

MAP TO ACCOMPANY APPLICATION TO
APPROPRIATE SURFACE WATER
FOR
RIVERS END RANCH

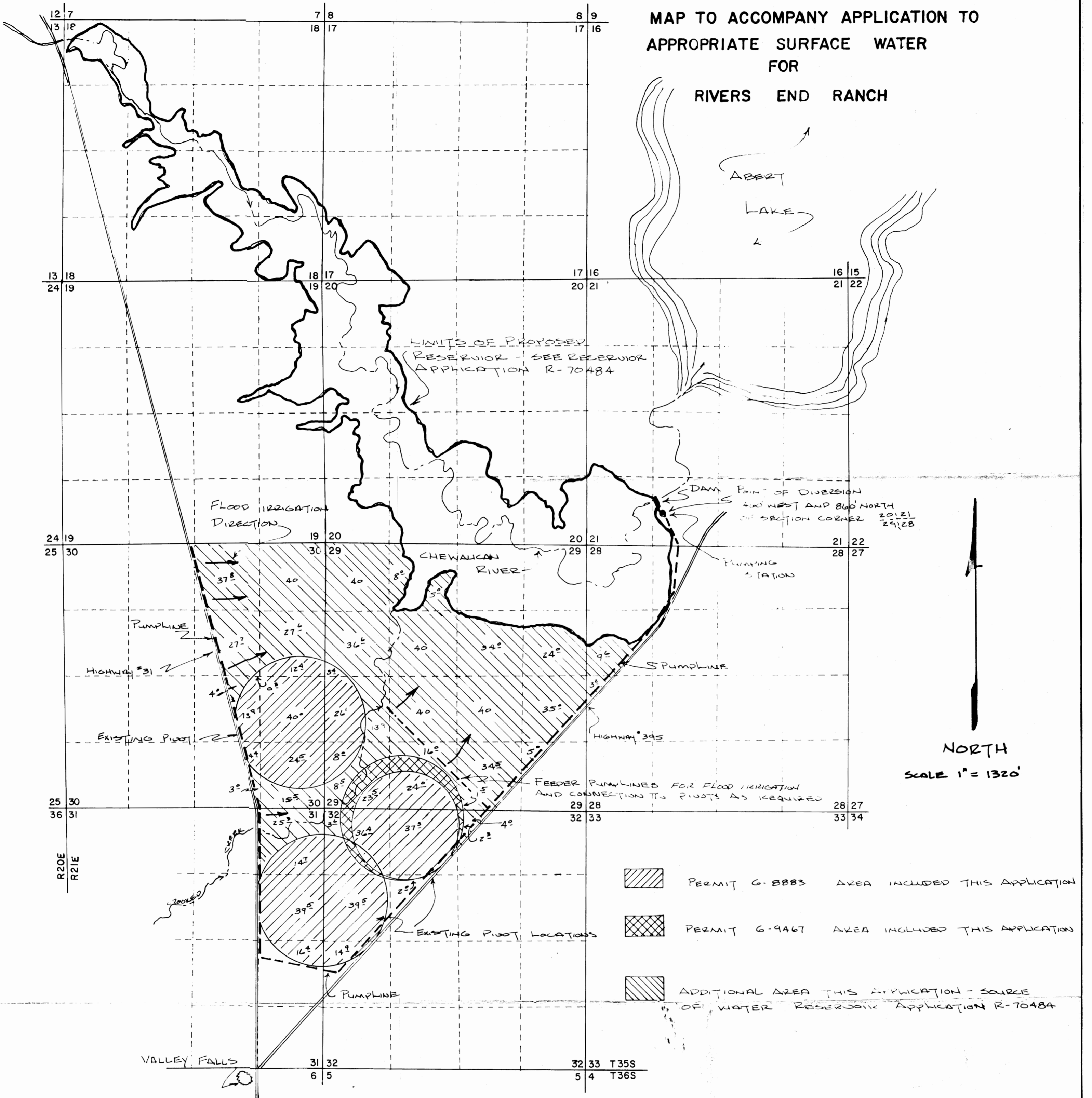

THIS APPLICATION TO INCLUDE AREAS OF
GROUND WATER PERMITS G-8883 AND G-9467,
SURFACE WATER FROM THE PROPOSED RESERVOIR
TO BE THE PRIMARY SOURCE

Application No. 70921 & R-70484
Permit No. 51164 & R-11347

APPLICANT

RIVERS END RANCH
C/O JAMES STEWART
HC 60 BOX 1800
LAKEVIEW, OREGON 97630

THIS MAP PREPARED FOR APPLICATION
PURPOSES ONLY AND DOES NOT
DEPICT OWNERSHIP OR EXACT LOCATION
OF PROPOSED USES.

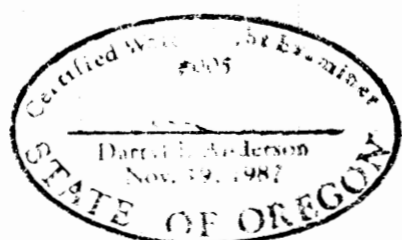



ANDERSON ENGINEERING & SURVEYING
615 SOUTH STREET
PO BOX 21
LAKEVIEW, OREGON 97630
503-942-2400

NOVEMBER 1990

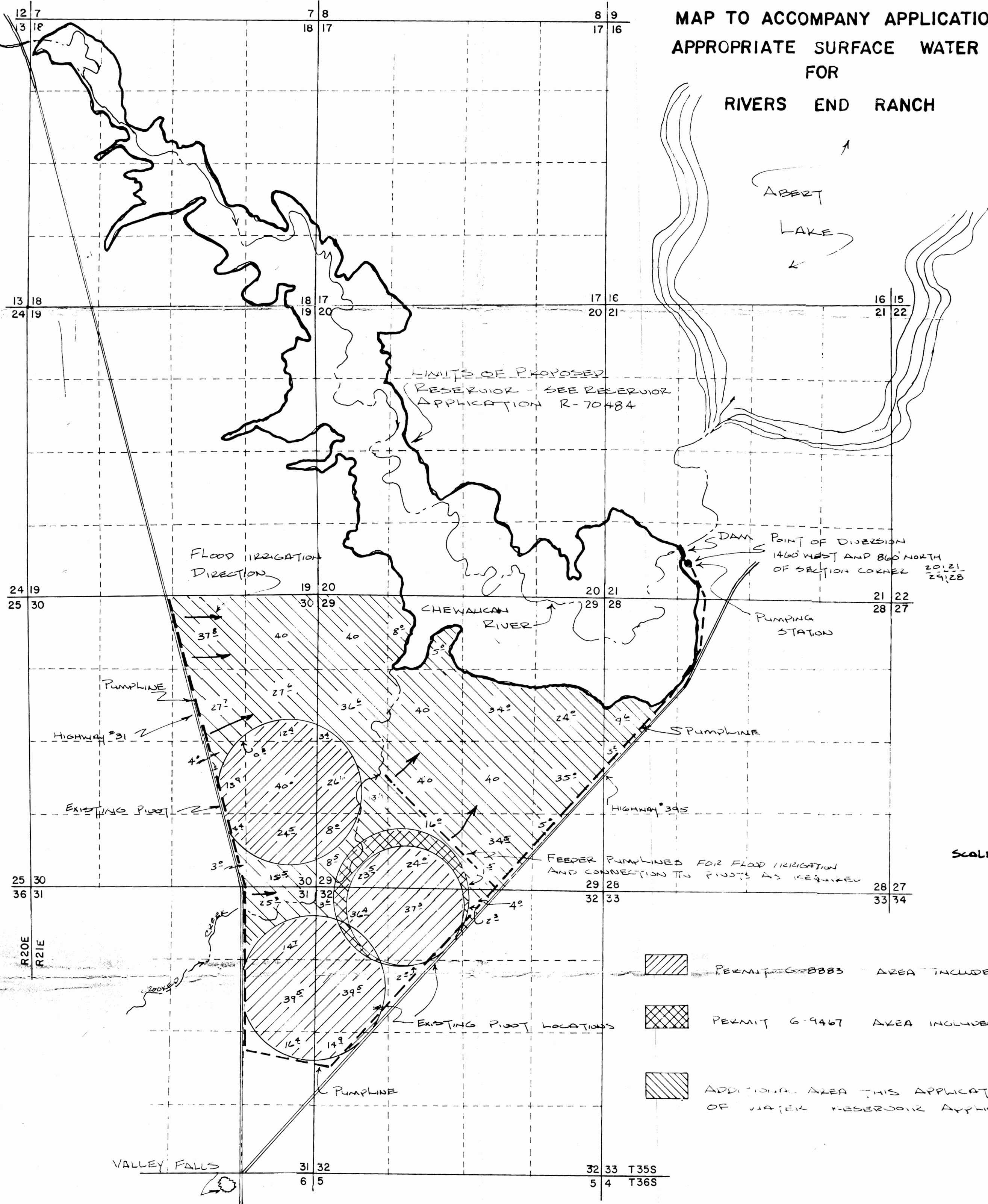
MAP TO ACCOMPANY APPLICATION TO
APPROPRIATE SURFACE WATER
FOR
RIVERS END RANCH

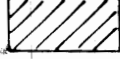

-  PERMIT G-8883 AREA INCLUDED THIS APPLICATION
-  PERMIT G-9467 AREA INCLUDED THIS APPLICATION
-  ADDITIONAL AREA THIS APPLICATION - SOURCE OF WATER RESERVOIR APPLICATION R-70484

THIS APPLICATION TO INCLUDE AREAS OF GROUND WATER PERMITS G-8883 AND G-9467. SURFACE WATER FROM THE PROPOSED RESERVOIR TO BE THE PRIMARY SOURCE

Application No. 70921 & R-70424
Permit No. 51164 & R-11347

APPLICANT

RIVERS END RANCH
C/O JAMES STEWART
HC 40 BOX 1800
LAKEVIEW, OREGON 97630

THIS MAP PREPARED FOR APPLICATION PURPOSES ONLY AND DOES NOT DEPICT OWNERSHIP OR EXACT LOCATION OF PROPOSED USES.

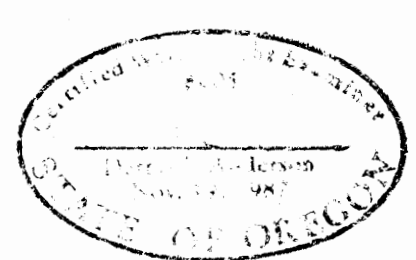

NOVEMBER 1990

MAP TO ACCOMPANY APPLICATION FOR
A PERMIT TO CONSTRUCT A RESERVOIR

APPLICATION NO. R-70484

PERMIT NO. _____



SCALE 1" = 1320'

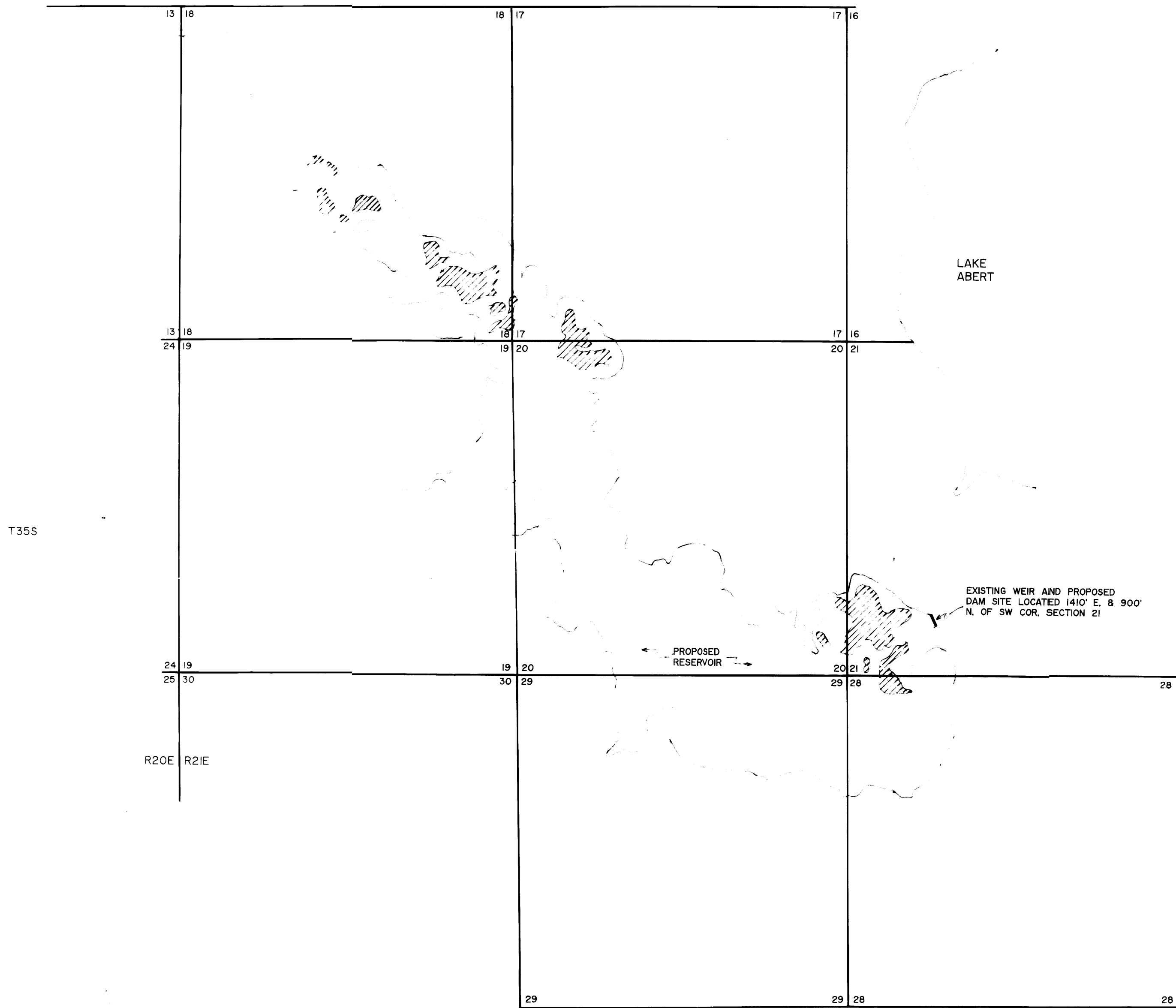

LEGEND

- SECTION LINE
- ISLAND FORMED BY RESERVOIR

NOTE: PREPARATION OF THIS MAP IS FOR IDENTIFYING PROPOSED WATER RIGHTS ONLY. IT HAS NO INTENT TO PROVIDE LOCATIONS OR DIMENSIONS OF PROPERTY BOUNDARIES.

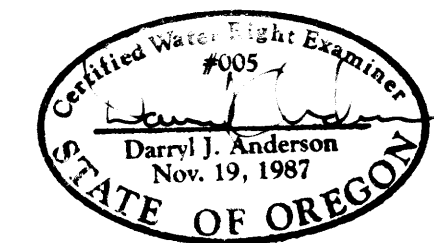

PREPARED FOR:

JAMES R. STEWART
H.C. 60 BOX 1800
LAKEVIEW, OREGON 97630

PREPARED BY:

ANDERSON ENGINEERING & SURVEYING
P.O. BOX 28
618 SOUTH FIRST STREET
LAKEVIEW, OREGON 97630
(503) 947-4407

JULY, 1990

SHEET 1 OF 1

MAP TO AVOID ANY CLAIM OF BENEFICIAL USE

APPLICATION NO: R-70484

PERMIT NO: R-11347

CHEWALCAN RIVER

TOWNSHIP 35 SOUTH
RANGE 21 EAST



SCALE: 1"=1320'

SPILLWAY CREST OF RESERVOIR AT ELEVATION 4280
RESERVOIR CAPACITY 1639 ACRE FEET
RESERVOIR AREA (FILL) 650 ACRES

CREST ELEVATION VERIFIED IN FIELD
CAPACITY AND AREA AS PER CONSTRUCTION PLANS

LIMITS OF RESERVOIR AS PER ORIGINAL PLANS

LEGEND

- SECTION LINE
- - - - - 1/4 - 1/4 SECTION LINE

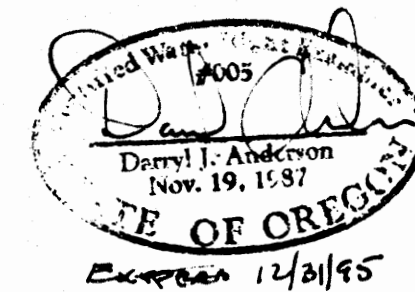

NOTE: PREPARATION OF THIS MAP IS FOR IDENTIFYING PROPOSED WATER RIGHTS ONLY. IT HAS NO INTENT TO PROVIDE LOCATIONS OR DIMENSIONS OF PROPERTY BOUNDARIES.

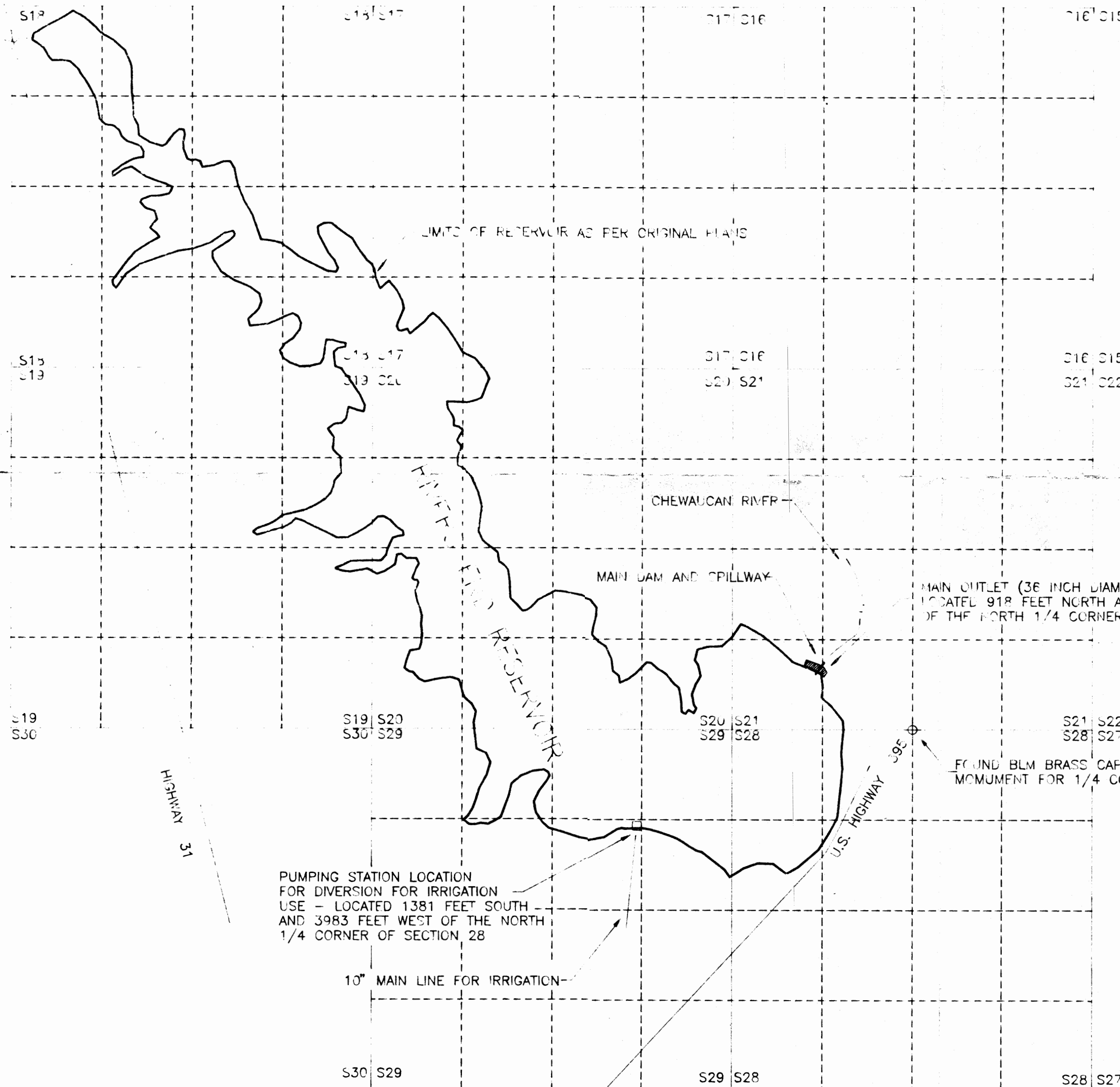

PREPARED FOR: RIVERS END RANCH
OLIVER SPIRES
P.O. BOX 790
LAKEVIEW, OREGON 97630
(541) 947-5021

PREPARED BY:
ANDERSON ENGINEERING AND SURVEYING
P.O. BOX 28 LAKEVIEW, OREGON 97630
(503) 947-4407 FAX 947-2321
P.O. BOX 419 REDMOND, OREGON 97756
(503) 923-4307 FAX 923-4308

DATE: NOVEMBER 1995 DWG. FILE: RIVEREFP
JOB NO.: 95120 SHEET 1 OF 1