

(Arms 92-73)

Place into: No. of acres under permit
Permit: covered by part of W.R. W.V. Act.
Blue pencil: " " individual permits

Following land included in part not covered by permit (9 ac. in SW SW - Sec. 35, T. 1 S., R. 12 E. (Catharine M. Coaster)
3 ac. NW SE see. 34, T. 1 S., R. 12 E. (James M. Baker)
5 ac. SW NW see. 36, T. 1 S., R. 12 E. (Baltimore-Edwards-Opdycke)
5 ac. SE NW see. 21, T. 1 S., R. 12 E. (Baltimore-Edwards-Opdycke)

91'
100'
120'
140'
160'
180'
200'

200'

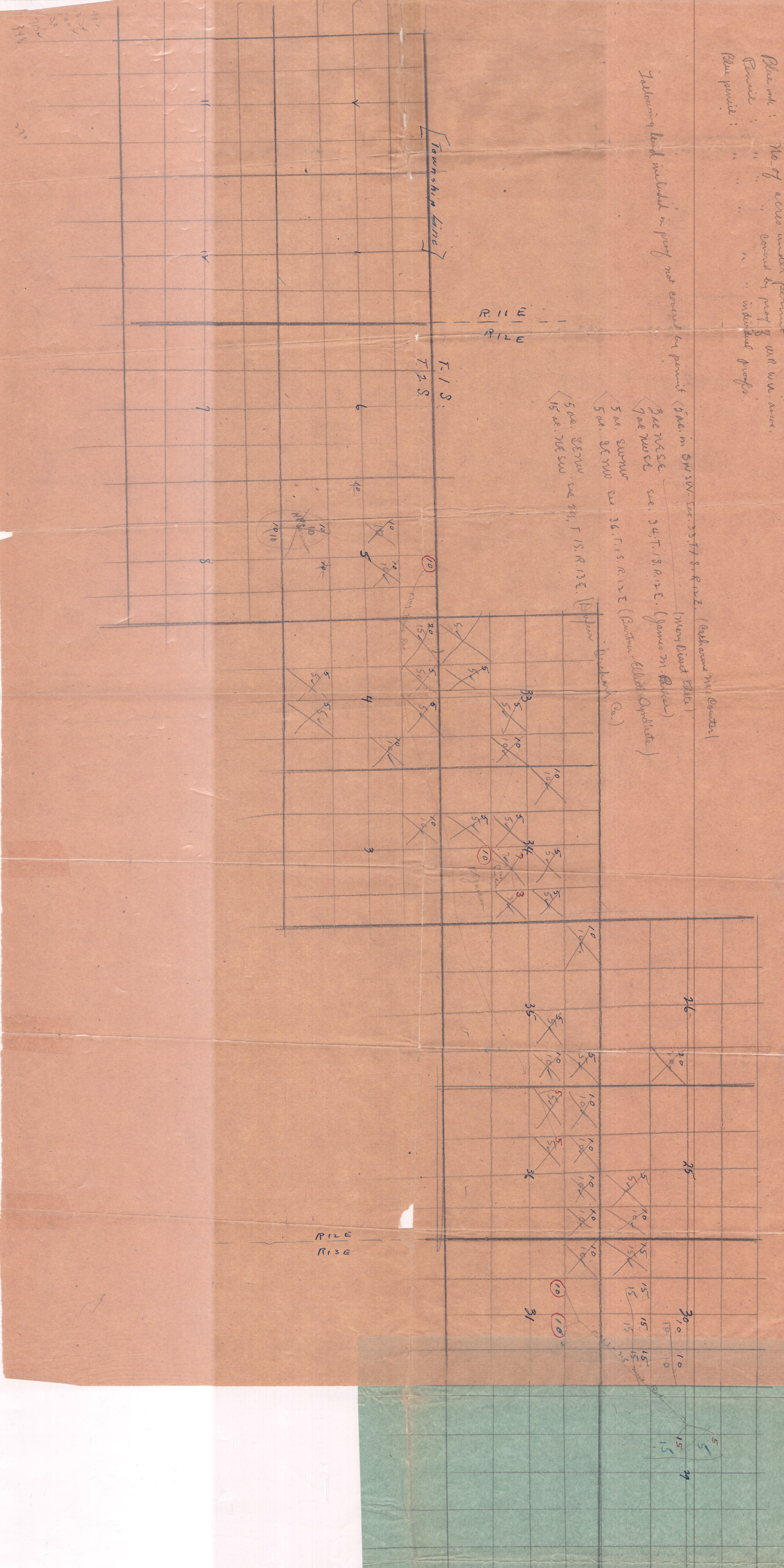

R 12 E
R 13 E

(Books 92-93)

Place into: No. of acres under permit
Permit: covered by part of U.S. W.V. Act.
Base permit: " " individual permits.

Following land included in part not covered by permit (5 ac. in SW 1/4 Sec. 33, T. 1 S., R. 12 E. (Catharine M. Central)
(Mary Elizabeth Birk)

5 ac. SE 1/4 SW 1/4 see 34, T. 1 S., R. 12 E. (James M. Baker)
5 ac. SE 1/4 SW 1/4 see 36, T. 1 S., R. 12 E. (Barbara Alice Ordville)
5 ac. SE 1/4 SW 1/4 see 21, T. 1 S., R. 13 E. (Purton Dudley Co.)
15 ac. NE 1/4 SW 1/4

411
200
100
50
25
10
5
2

